



PASUN PATHAN/ THAILAND

FISH MARKET. (THESIS)
House and restaurant junya ishigami (CSD)
Alternative school.
Phuket museum.

Siam Yamato Steel. (SYS)
THE EVERYDAY HERITAGE (ASA)
Asia young design award 2020. (AYDA)
NEW BANGKOK BUS STOP (MAYDAY)
Arctic hotel. (YAC)

Pocket garden design.
Sufferer shelter.
Missing hill.
Childhood study base.

ARCHITECTURE PORTFOLIO





PASUN PATHAN/TIME

Bo phut, Koh samui
Suratthani, Thailand
+66 91 8241438
pasun.design@gmail.com

RESUME

Name	Pasun Pathan
Born in	Koh Samui
Date of birth	December 4, 1998
Address	190/2, Moo 6, Bo phut District Koh Samui, Suratthani, Thailand
Telephone	+66 91 8241438
E-mail	pasun.design@gmail.com
Nationality	Thai

BACKGROUND

Most of my life, from childhood to pre-college. I grew up in a family where my parents were hotel staff on Koh Samui, thanks to the growing environment I was able to see and experience a variety of architecture, and most of architecture was designed by many famous architects. These things gradually formed into tastes, preferences, and became the inspiration of my works.

After attending a university in the Faculty of Architecture, I learned how to design and work. It also expands my world of architecture that I have seen in Samui. More and more methods and designs of architecture have made me try to develop my skills.

EDUCATION

Primary school (2004-2010)
1084640106 / Banhadngam School
077-414 549 / Bo Phut sub district, Ko Samui district, Surat Thani.

Middle school - High school (2011-2016)
1084640553 / Theeparatpittaya School
077-425 053 / Mae Nam sub district, Ko Samui district, Surat Thani.

University (2017-2022)
Architecture and Design / Walailak University
075-673 000 / Tha Sala District, Nakhon si Thammarat.

PROJECT SCHOOL /COMPETITION /SKETCH DESIGN

SCHOOL	(1)
FISH MARKET. (THESIS) / Mueang District, Songkha.	(2,3,4,5,6)
House and restaurant junya ishigami case study project. / Yamaguchi, Japan.	(7)
Alternative school. / Walailak University.	(8,9)
Phuket museum. / Mueang District, Phuket.	(10,11)

COMPETITION	(12)
Siam Yamato Steel. (SYS) / Laem Samila, Songkhla.	(13)
THE EVERYDAY HERITAGE (ASA) / Hua Sai District, Nakhon si Thammarat.	(14,15)
Asia young design award 2020. (AYDA) / Khlong Toei, Bangkok.	(16,17)
NEW BANGKOK BUS STOP (MAYDAY) / Siam, Bangkok.	(18,19)
Arctic hotel. (YAC) / Rovaniemi, Finland.	(20)

SKETCH DESIGN	(21)
Pocket garden design. / Walailak University.	(22)
Sufferer shelter. / Galaxy, far far away.	(23)
Missing hill. / Janglone Mountain, Nakhon si Thammarat.	(24)
Childhood study base. / Backyard.	(25)

SKILLS

Modelling	Revit
Drafting	Revit / AutoCAD
Rendering	Enscape
Postproduction	Adobe photoshop
Presentation	Adobe photoshop

FISH MARKET. (THESIS) / Mueang District, Songkha.
House and restaurant junya ishigami case study project. / Yamaguchi, Japan.
Alternative school. / Walailak University.
Phuket museum. / Mueang District, Phuket.

SCHOOL PROJECTS.



FISHERY INDUSTRY

THE FISHING INDUSTRY IS VERY IMPORTANT IN THAILAND'S BUSINESS SECTOR AND IS A MAJOR SOURCE OF INCOME FOR THE COUNTRY. THEREFORE, THE FISHING INDUSTRY IS INVOLVED IN MANY LEVELS OF BUSINESS, FROM COMMUNITY-BASED INDUSTRIES THAT INVOLVE MULTIPLE FAMILIES TO LARGE-SCALE INDUSTRIES AND MANY PROCESSING FACTORIES. THERE IS A LARGE NUMBER OF WORKERS INVOLVED IN THIS BUSINESS SECTOR, BOTH DIRECTLY AND INDIRECTLY. IT ALSO SHOWS THAT THERE ARE MANY TIES AND RELATIONSHIPS WITH A WIDE RANGE OF BUSINESSES, SUCH AS LOGISTICS, PROCESSING, PACKAGING, WHOLESALE OR MASS RETAIL. AND THERE ARE ALSO A NUMBER OF SUPPORTING BUSINESSES INVOLVED IN THE PRODUCTION AND SALES PROCESS. THUS, THE OVERALL INDUSTRY OUTLOOK AFFECTS MANY PEOPLE AND WORKERS, SHOWING THAT THE FISHING INDUSTRY IS AN IMPORTANT COMPONENT OF MANY PEOPLE IN THE COUN-

FISHERY PRODUCTS/MARINE POPULATIONS

MORE AND MORE PEOPLE TODAY CONSUME SEAFOOD AND MARINE-BASED PRODUCTS AND STATISTICS SHOW THAT THE VOLUME GROWTH RATE IS INCREASING YEAR BY YEAR IN CONTRAST TO MARINE LIFE. SIGNIFICANTLY REDUCED, THUS SHOWING THAT THE CURRENT ENORMOUS CONSUMPTION OF HUMAN BEINGS HAS A HUGE IMPACT ON THE CURRENT NUCLEAR SYSTEM, RESULTING IN GREAT PROBLEMS BOTH WAY. ENVIRONMENTAL ILLEGAL FISHING ILLEGAL FISHING IN OTHER COUNTRY'S WATERS ILLEGAL USE OF WORK TO REDUCE COSTS AND MANY OTHER PROBLEMS THAT RESULT FROM FEWER CATCHES EVERY YEAR AND THE EVER-GROWING DEMAND. THIS MAY RESULT IN THE PRICE OF FISHERY PRODUCTS RISING ALONG THE TREND OF GROWING THE SELLING BUSINESS AS WELL

THE QUANTITY AND VALUE OF FISHERY PRODUCTS WERE SURVEYED. COMPARISON BETWEEN COMMERCIAL FISHERIES AND LOCAL FISHERIES IT WAS FOUND THAT COMMERCIAL FISHERIES HAD HIGHER QUANTITY AND

PANDEMIC

IN THE MIDST OF THE EPIDEMIC, FISHING IS ONE OF THOSE BUSINESSES THAT ARE AFFECTED AND NEED TO ADAPT TO SURVIVE. ALTHOUGH THERE ARE MANY FISHERMEN WHO CANNOT ADAPT OR FACE THE CRISIS AND HAVE TO FALL. THE CURRENT MAJOR PROBLEM RESULTING FROM THE EPIDEMIC CRISIS IS THAI FISHERIES RELY ON FOREIGN FISHERMEN. MAINLY IN FISHING AND DUE TO STRICT INTERNATIONAL TRAVEL POLICIES, THAI FISHERIES ARE FACING A HUGE LABOR SHORTAGE. THIS EVENT WILL BE ONE OF THE DETERMINANTS OF THE ROLE AND DIRECTION OF THE OVERALL PICTURE OF THAI FISHERIES IN THE FUTURE. AND ALL RELEVANT SECTORS NEED TO ADAPT TO ADAPT TO THE CHANGES FOR THE EFFICIENCY OF THAI FISHERIES THAT WILL TRANSITION INTO THE MODERN ERA.

IN THE FACE OF THE CRISIS, FISHERIES SECTOR HAS BEEN IMPACTED QUITE EARLY DURING THE SPREADING OF COVID-19 PANDEMIC FROM THE RESTRICTIONS AND CLOSURES OF SEAFOOD SUPPLY CHAINS IN BOTH GLOBAL AND DOMESTIC MARKETS.

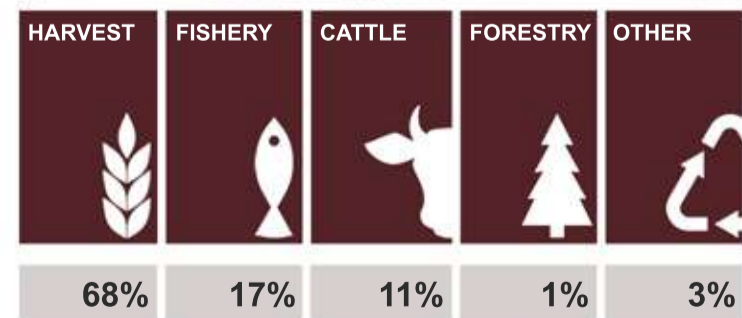

FISHERY INDUSTRY ARE 17% OF AGRICULTURAL SECTOR



THE OCEAN FIRST STARTED SHOWING SIGNS OF ITS DEPLETION IN THE LATE 1890'S, BUT IT HAS ALWAYS BEEN IGNORED BY FISHERMEN. AS LONG AS FISHERMEN ARE ABLE TO MAKE A CATCH, THEY RESIST THE FACT THAT THE POPULATIONS ARE RAPIDLY DECLINING, BUT THEY ARE NOW FINDING THEMSELVES AT THE END OF THEIR FISHING SPREE. JUST LIKE THE HUGE FACTORY FARMING CORPORATIONS, THE FISHERMEN THAT MAKE THE CATCHES TO BE SOLD WORLDWIDE.

THAILAND HAS BEEN ONE OF THE TOP SEAFOOD EXPORTERS FOR OVER DECADES, WHICH ITS SECTOR HAS HEAVILY RELIED ON MIGRANT LABOURS FROM NEIGHBORING COUNTRIES. THROUGHOUT 2010S, THAILAND HAD BEEN WATCHED ON SITUATIONS OF LABOUR EXPLOITATIONS IN SEAFOOD INDUSTRIES. ALTHOUGH THE SITUATIONS HAVE BEEN IMPROVED, HOWEVER, IT WAS STATED IN 2020 TRAFFICKING IN PERSONS REPORT THAT MIGRANTS WORKING IN FISHERIES ARE STILL IN VULNERABLE SITUATIONS. MOREOVER, SINCE 1960, THE THAI GOVERNMENT HAS EMPHASIZED ON SUPPORTING COMMERCIAL FISHERIES. THUS, MAKES SMALL-SCALE FISHERS HAVE LACKED OF SUFFICIENT SUPPORT.





**BACKGROUND SYSTEM
USERS BEHAVIOR**

SHOPPING CENTER PROJECT TO PROMOTE INTEGRATED FISHING INDUSTRY IT WILL BE A BUSINESS AREA FOR THE COMMUNITY THROUGH EFFICIENT FISHING, HIGH-QUALITY AND EQUITABLE OUTPUT THAT RELIES ON KNOWLEDGE, SKILLS AND COOPERATION FOR A SUSTAINABLE ENVIRONMENT AND ECONOMY. THIS PROJECT WILL BE AN INTERMEDIARY BETWEEN ENTREPRENEURS, LABOR AND CONSUMERS FOR THE BENEFIT OF ALL PARTIES FAIRLY. THE PROJECT CONSISTS OF A LOADING AND UNLOADING AREA.

PRODUCTION MANAGEMENT AREA STORAGE AREA SALES AND TRANSPORTATION AREA INCLUDING PROJECT SUPPORT AREA, VOCATIONAL TRAINING SECTION, MAINTENANCE SECTION AND SUPPORT OFFICE

**CUSTOMER SERVICE
AREA USERS BEHAVIOR**

THE ROLES AND FUNCTIONS OF THE PROJECT ACT AS AN INTERMEDIARY BETWEEN THE WATER SOURCE AREA OR ENVIRONMENTAL AREA AND THE COMMUNITY AND SOCIAL AREA. THE PROJECT ACTS AS A MIDDLEMAN BETWEEN THE PRODUCTION SECTOR AND THE CONSUMER, WITH THE PROJECT RESPONSIBLE FOR THE FISHERIES, STORAGE, TRANSPORT, MANAGEMENT AND DISTRIBUTION OF FISHERIES PRODUCTS.

CONSUMERS ARE TIGHT TO THE WHOLESALE CONSUMER GROUPS WITHIN THE COUNTRY. RESTAURANT OPERATORS WHO WANT HIGH QUALITY PRODUCE INCLUDING LOCAL RETAIL CUSTOMERS AND TOURISTS.

**PUBLIC COMMON
AREA USERS BEHAVIOR**

CONSUMER AREA THIS PROJECT WILL BE A SOURCE OF MANY ENTREPRENEURS. SO THAT CONSUMERS DO NOT NEED TO FIND SUPPLIERS WHO SOMETIMES HAVE TO BE ACQUAINTED WITH OR HAVE CONNECTIONS OR MOST OPERATORS ARE UNKNOWN, SO IT IS DIFFICULT TO CONTACT. MERGING OPERATORS TOGETHER GIVES CONSUMERS MORE OPTIONS TO FIND OPERATORS ACCORDING TO THEIR NEEDS. HOWEVER, CONSUMERS CAN EXPECT THE QUALITY OF THE PRODUCT.

WHERE GOODS WILL BE HANDLED ACCORDING TO THE SAME STANDARDS IN STORAGE OR TRANSPORTATION THAT THE PROJECT HAS PREPARED

BACKGROUND

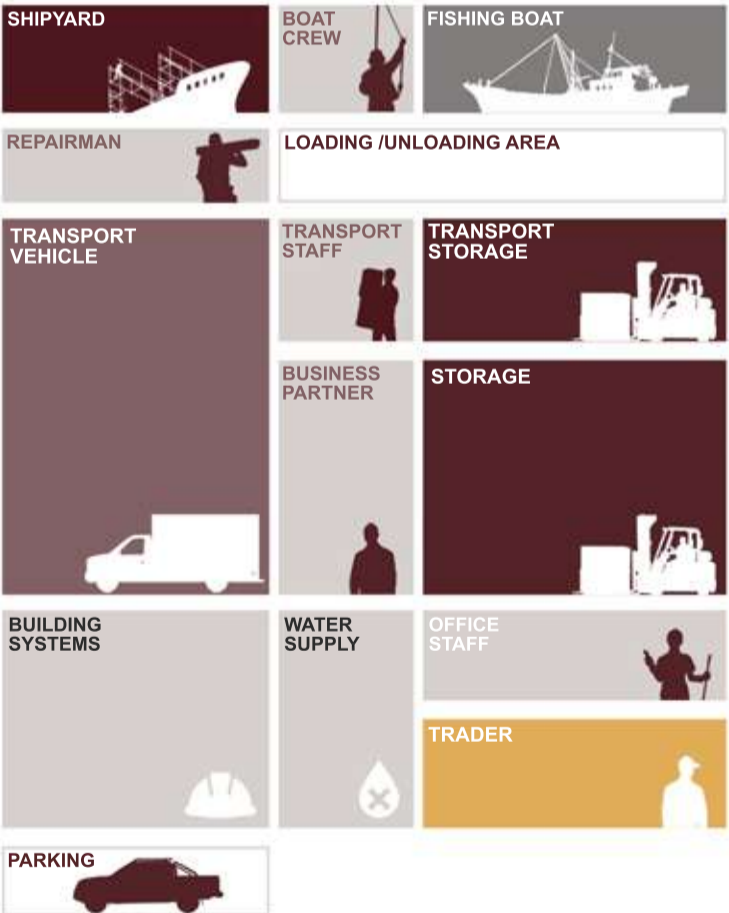

CUSTOMER

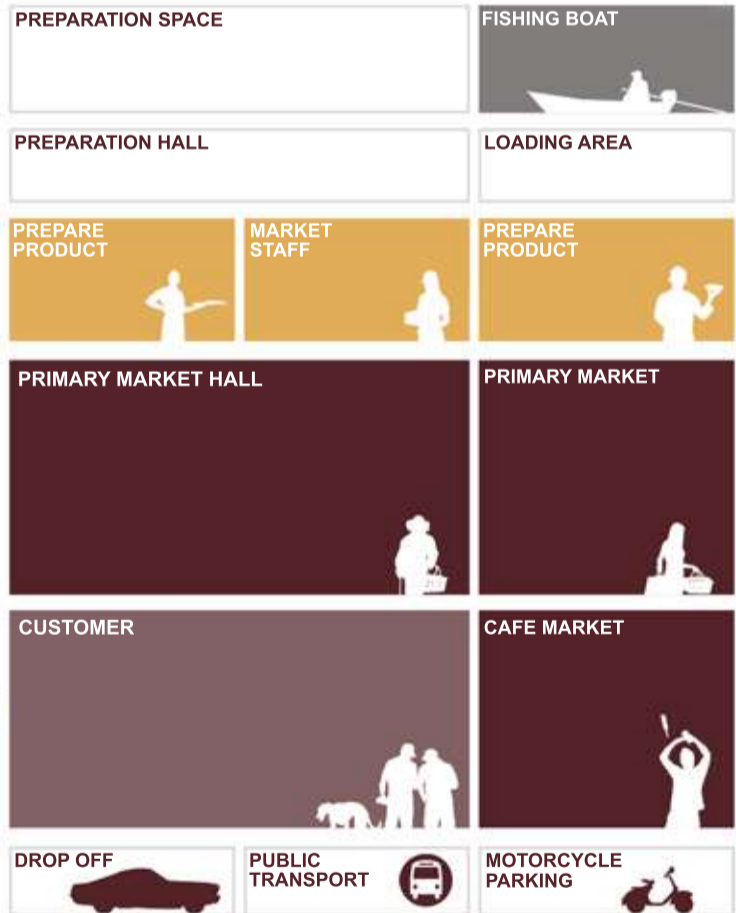

PUBLIC /COMMON AREA

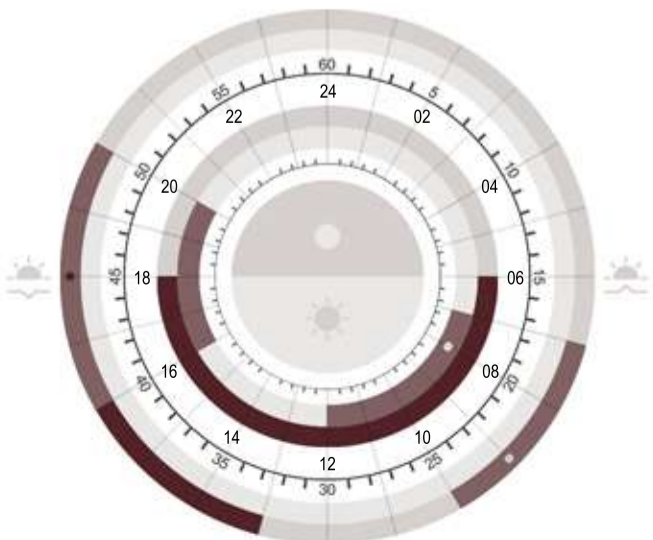
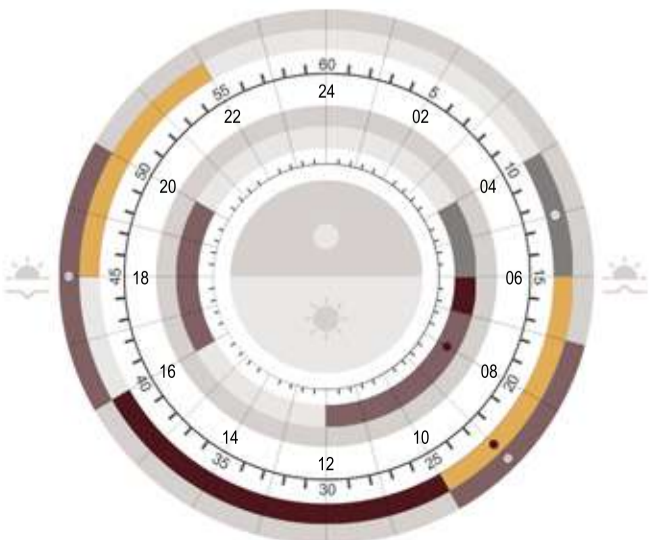
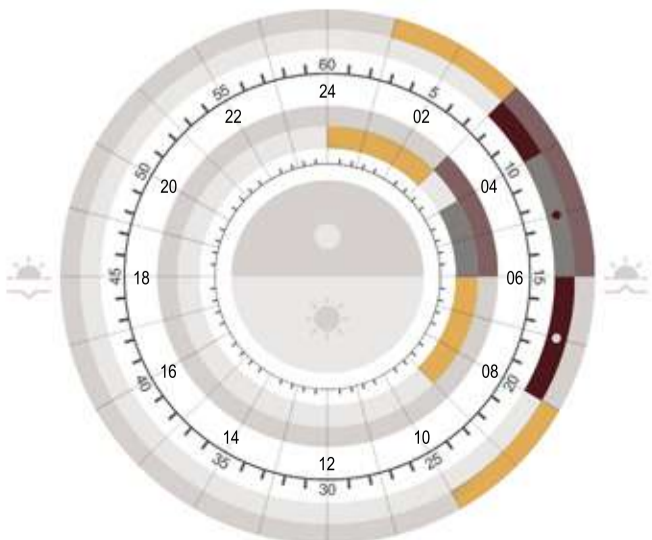
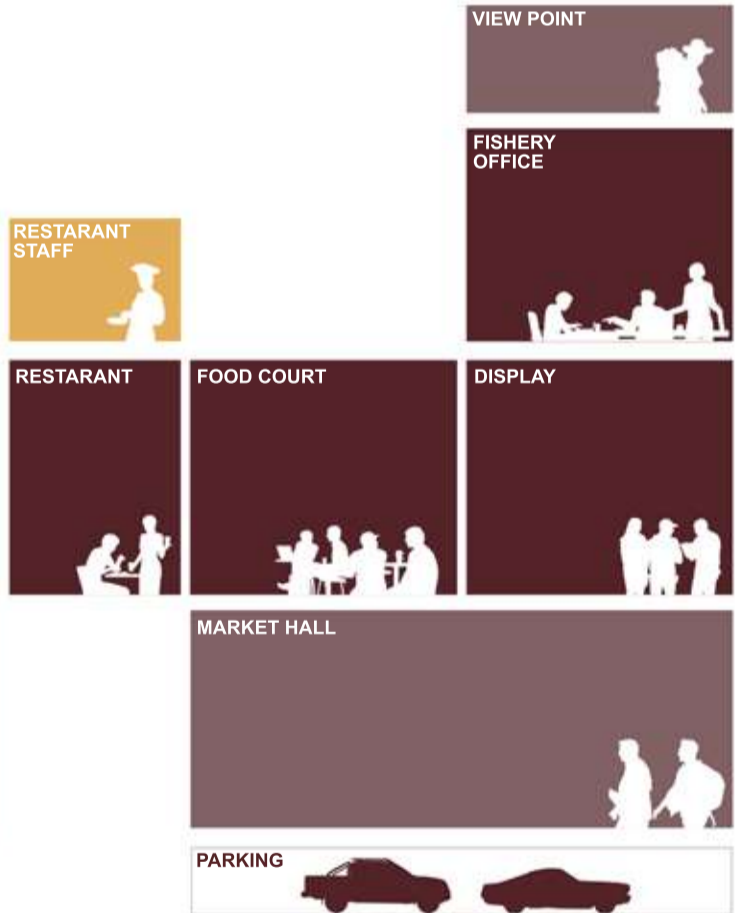

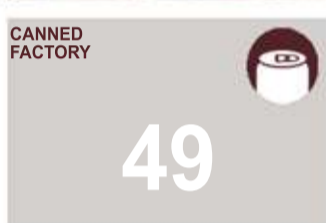

DOMESTIC MARKET SITUATION

MIDSTREAM TO DOWNSTREAM IS PART OF MANY INDUSTRIES THAT ARE DERIVED FROM THE UPSTREAM. SUCH AS PROCESSING PLANTS PACKAGING PLANT OR TRANSPORTATION BUSINESS THERE IS A LARGE NUMBER OF WORKERS INVOLVED IN THE FACTORY AND THERE ARE ALSO RETAILERS THAT BRING PRODUCTS TO THE CITY COMMUNITY, SHOPS, DEPARTMENT STORES. FOR MANY CONSUMERS IN THE DOWNSTREAM SEGMENT AND ALSO EXPORTING PRODUCTS TO FOREIGN COUNTRIES IN BOTH PROCESSED AND FRESH FORM TO FOREIGN MARKETS AND MANY COUNTRIES HAVE THAILAND AS A COUNTRY TO DELIVER PRODUCTS TO THE DOMESTIC MARKET. THE FACT THAT THAILAND HAS ENOUGH POWER AND PRODUCTION CAPACITY TO ENTER THE WORLD MARKET AND BUSINESS OPPORTUNITIES AND POSSIBILITIES

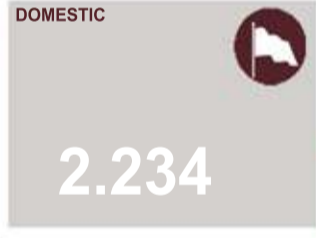
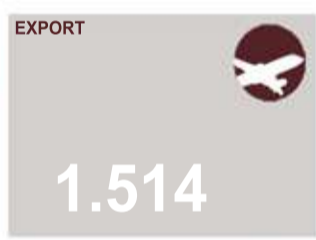
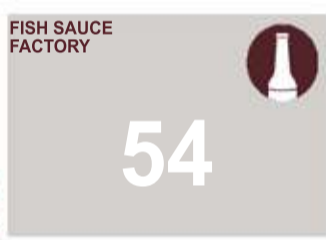
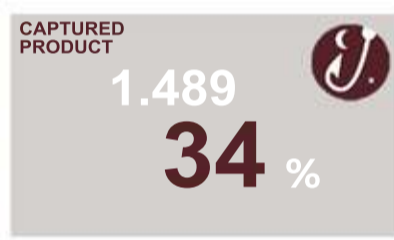

THE FISHING INDUSTRY IS DIVIDED INTO SEVERAL PARTS. SUCH AS THE UPSTREAM, MIDSTREAM, AND DOWNSTREAM SECTIONS. THE UPSTREAM SECTION CONSISTS OF VARIOUS TYPES OF PORTS, FISH BRIDGES, FISH MARKETS AND DOCKYARDS, WHICH ARE THE FIRST PARTS TO SELL PRODUCE AT THE FIRST LEVEL. THIS SECTION IS LIKE THE ORIGIN OF THE FISHERY MARKET. AND THERE ARE MANY WORKERS WORKING DIRECTLY IN THE FISHING INDUSTRY.

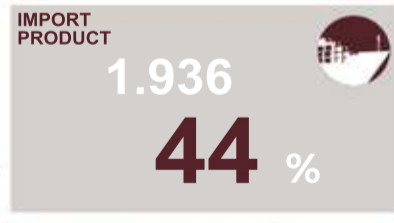
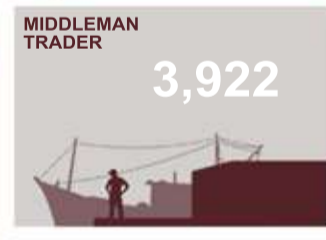

THAILAND'S ROLE IN APEC OVER THE PAST 20 YEARS, THAILAND HAS BENEFITED GREATLY FROM APEC MEMBERSHIP. BY PARTICIPATING IN MEETINGS AT ALL LEVELS FROM THE LEADERSHIP, MINISTERS, SENIOR OFFICIALS AS WELL AS MEETINGS BETWEEN EXPERTS IN THE FRAMEWORK OF COOPERATION IN VARIOUS FIELDS, WHICH ARE ALL OPPORTUNITIES FOR THAILAND TO PUSH FORWARD AND JOINTLY DETERMINE THE DIRECTION OF COOPERATION. OF APEC IN ACCORDANCE WITH THAI POLICY. IN ADDITION, THAILAND HAS RECEIVED FINANCIAL SUPPORT FROM APEC IN IMPLEMENTING VARIOUS COOPERATION PROJECTS, WHICH WILL NOT ONLY BENEFIT THAILAND. IT ALSO BENEFITS THE ASIA-PACIFIC REGION AS A WHOLE. IN THE PAST, THAILAND RECEIVED FUNDING FOR SUCH PROJECTS FROM APEC. AVERAGE ANNUALLY ABOUT 300,000.- US DOLLARS. WHILE THAILAND HAS TO PAY A MEMBERSHIP FEE TO APEC OF \$75,000 PER YEAR.

THE ROLE OF THE DEPARTMENT OF FISHERIES IN COOPERATING IN DATA COORDINATION NATIONAL FISHERIES OPINIONS AT BOTH POLICY AND OPERATIONAL LEVELS AND SEND REPRESENTATIVES TO ATTEND THE ANNUAL MEETING FISHERIES WORKING GROUP, WHICH PLAYED A ROLE IN THE STUDY. RESEARCH ON CONSERVATION OF MARINE RESOURCES AND AQUACULTURE IN THE APEC REGION

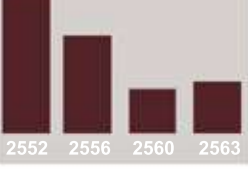
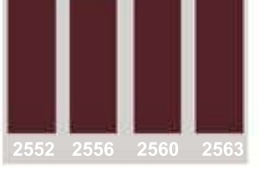
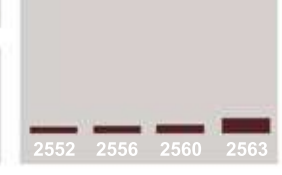
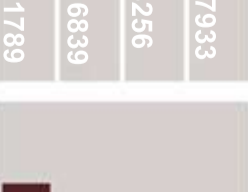
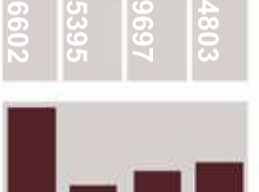
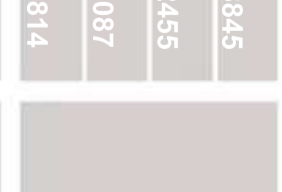
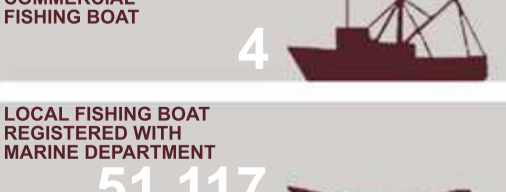
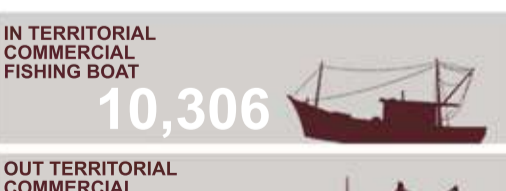
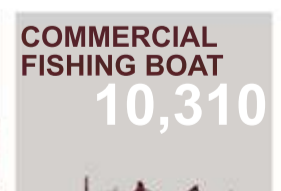



SONGKHA ANALYSIS



SITE ANALYSIS

IN SELECTING A PROJECT SITE, IT IS NECESSARY TO SELECT A POTENTIAL SITE FOR THE PROJECT SITE, AND THE SITE OPTIONS NEED TO HAVE THE SAME LEVEL OF CONDITIONS AND CONSTRAINTS, AND THE SITE SELECTION IS SELECTED USING STATISTICAL DATA AT THE LEVEL. PROVINCES TO DIFFERENTIATE THE CHOICE OF THE REGION ON A LARGE SCALE AND THE VARIETY OF POSSIBILITIES OF SITE SELECTION, THEREFORE, THE OPTION THAT MEETS THE CONDITIONS IS NAKHON SI THAMMARAT PROVINCE, SONGKHA PROVINCE AND PATTANI PROVINCE WITH THE SAME LEVEL AND POTENTIAL

A COMPREHENSIVE SITE AND ENVIRONMENTAL ANALYSIS IS THE FOUNDATION OF GOOD DESIGN. THIS IS ESPECIALLY TRUE IN THE TWENTY-FIRST CENTURY, WHEN ENERGY SCARCITY AND THE TRANSITION TO ALTERNATIVE ENERGY SOURCES OFFER PRIME DESIGN OPPORTUNITIES. SITE DESIGN BEGINS WITH THE ANALYSIS OF THE SITE AND ENVIRONMENTAL CONDITIONS, WHICH YIELD INFORMATION THE ARCHITECT CAN INTEGRATE INTO THE PROJECT PROGRAM AND DESIGN SOLUTION. IN MANY CASES, WHEN THE NATURAL ATTRIBUTES OF A SITE ARE CONSIDERED, THE ENERGY CONSUMPTION OF A BUILDING CAN BE REDUCED CONSIDERABLY, THE LONGEVITY OF THE BUILDING INCREASED, AND SHORT-TERM AND LONGTERM FACILITY MAINTENANCE COSTS REDUCED. ACHIEVING SUCH DESIRABLE OUTCOMES ARE CRITICAL TO SUSTAINABILITY IN DESIGN. IT IS ESSENTIAL FOR THE ARCHITECT TO INCORPORATE CONSIDERATIONS OF THE NATURAL PLACE INTO THE DESIGN PROCESS, DESIGN SOLUTIONS AND CONSTRUCTION METHODS.

AN IMPORTANT STEP IN THE FIRST PHASE OF DESIGN IS TO UNDERSTAND THE PROJECT'S BACKGROUND IN TERMS OF LIVING, CULTURAL, ENVIRONMENTAL, SOCIAL, POLITICAL OR ECONOMIC CONDITIONS, ETC., WITH AN INCREASED AWARENESS OF ENVIRONMENTAL ISSUES, FOR EXAMPLE: TRAFFIC, NOISE, SEWAGE, SCARCITY OF PUBLIC SPACES, CONGESTION, DEGRADATION AND UGLINESS OF A BUILDING OR MAN-MADE ENVIRONMENT BECAUSE OF THE RAPID GROWTH OF THE CITY OR COMMUNITY CAUSING CONFUSION AND MENTAL INSTABILITY MANY OF THE RESIDENTS IN THOSE ENVIRONMENTS HAVE THESE PROBLEMS. PARTLY DUE TO ARCHITECTURAL DESIGN WORKS

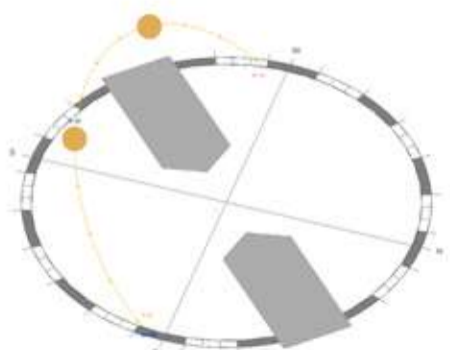

CONCEPT OF BUILDING POSITIONING AND PROJECT PLANNING IN THIS AREA MUST TAKE INTO ACCOUNT THE AREA OF USE THIS PROJECT WILL BE DIVIDED INTO THE WATER PORT THAT WILL BE THE WORKING AREA FOR THE FISHERY INDUSTRY WHICH WILL BE THE DEEP PART AND THE MAIN PART. AND THE MARKET AREA WILL BE LIKE A CENTRAL AREA WHERE WORKERS WILL COME TOGETHER, BOTH EMPLOYEES WITHIN THE PROJECT OR WILL BE A GROUP OF CUSTOMERS WHO WANT TO ACCESS SERVICES WITHIN THE PROJECT. THEN THERE WILL BE AN ARCHITECTURAL DESIGN TO ATTRACT PEOPLE TO USE THE PROJECT. AND MAKE IT INTERESTING FOR THE COMMUNITY HOWEVER, THIS TYPE OF BUILDING HAS A DIVERSE GROUP OF USERS THAT COME IN AND OUT OF THE PROJECT ALL THE TIME.

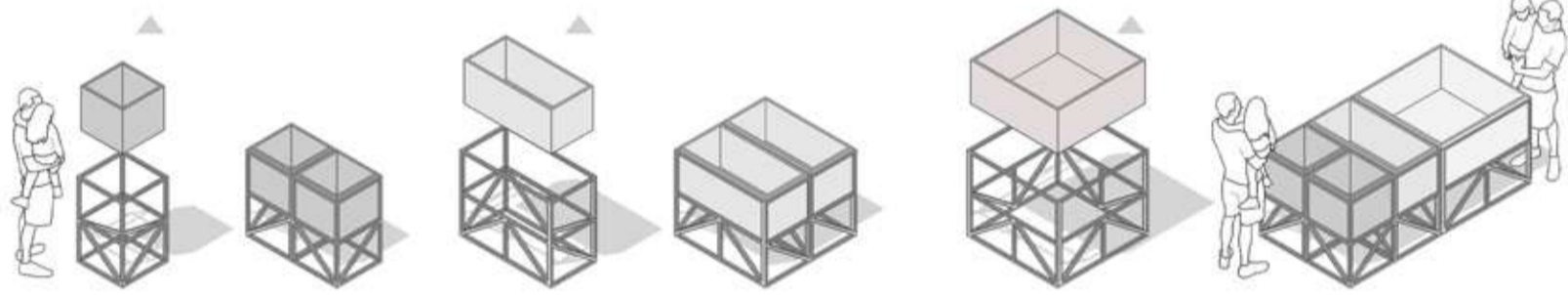

MARKET FURNITURE

THE GOODS OR FISHERY RAW MATERIALS ARE DELIVERED FROM THE SHIPS THAT COME IN ON THE DAY AND ARE THEN PACKED INTO SPECIALLY DESIGNED BOXES ACCORDING TO THE SIZE OF THE CARGO. THIS ALLOWS FOR EASY SORTING OF PRODUCTS AND EASY HANDLING. FROM TRANSPORTATION, SORTING, SLAUGHTERING, PROCESSING AND MERCHANDISING PROCESSES. THE BOX IS DESIGNED SO THAT IT CAN FIT INTO THE STALL ACCORDING TO THE SIZE OF THE BOX, MAKING IT EASY TO MOVE THE PRODUCT AROUND. AND USERS CAN MANAGE THE STALLS ACCORDING TO THEIR NEEDS, THE SIZE OF THE PANELS AND THE NUMBER OF PANELS CAN BE CUSTOMIZED, ALLOWING THE MARKET TO CHANGE AT ANY TIME TO SUPPORT A WIDE RANGE OF MERCHANDISING ACTIVITIES.

FUNCTIONS DESCRIPTION

SETTING UP THE FUNCTIONS AND DEFINING THE USABLE SPACE WILL DIVIDE THE PROJECT INTO A SYSTEMATIC ORDER FOR EFFICIENT SPACE MANAGEMENT AND USE. HOWEVER, PROJECTS THAT ARE LARGE AND HAVE A LOT OF FUNCTIONS NEED TO GROUP THE FUNCTIONS INTO CLEAR CATEGORIES ACCORDING TO USAGE OR BE DIVIDED ACCORDING TO THE NUMBER OF USERS. ACCORDING TO EACH TYPE OF USER GROUP.

THE PRINCIPLE OF PLACING THE FUNCTIONALITY IN THIS PROJECT IS TO THINK ABOUT ATTRACTING PEOPLE TO USE AND HAVING ACCESS TO A VARIETY OF FUNCTIONS. SUPPORT FUNCTIONS WILL BE GROUPED TO BE MAINTAINED AND ACCESSIBLE IN THE UNIQUE ROUTE AND INDOOR USAGE ARE ALSO DIVIDED ACCORDING TO THE TIME PERIOD AND NUMBER OF PEOPLE IN USE AND THE USER REQUIREMENTS. EVERY AREA WILL HAVE A FEELING OF CONNECTION WITH EACH OTHER. IN THE FORM OF ACCESS OR PERSPECTIVE WITHIN THE PROJECT, THERE WILL BE IMPORTANT AREAS THAT PROVIDE A GOOD VIEW OF THE OUTSIDE, ALLOWING YOU TO CHOOSE FUNCTIONS THAT PROMOTE AND BLEND IN WELL IN THOSE AREAS FOR EFFICIENT USE OF THE SPACE.

THE MAIN FOCUS OF THE DESIGNERS IS TO ALLOCATE SPACE TO DIFFERENT USER GROUPS AND DIFFERENT NEEDS AS THE FISHING INDUSTRY USERS HAVE THEIR OWN UNIQUE SPACES. FOR EXAMPLE IN THE GROUP OF WORKERS AT THE PIER NEED TO BE DESIGNED TO BE ABLE TO USE HEAVY EQUIPMENT TO HELP WITH WORK OR ENTREPRENEURS WHO NEED OFFICE AND SPACE FOR BUSINESS MEETINGS.

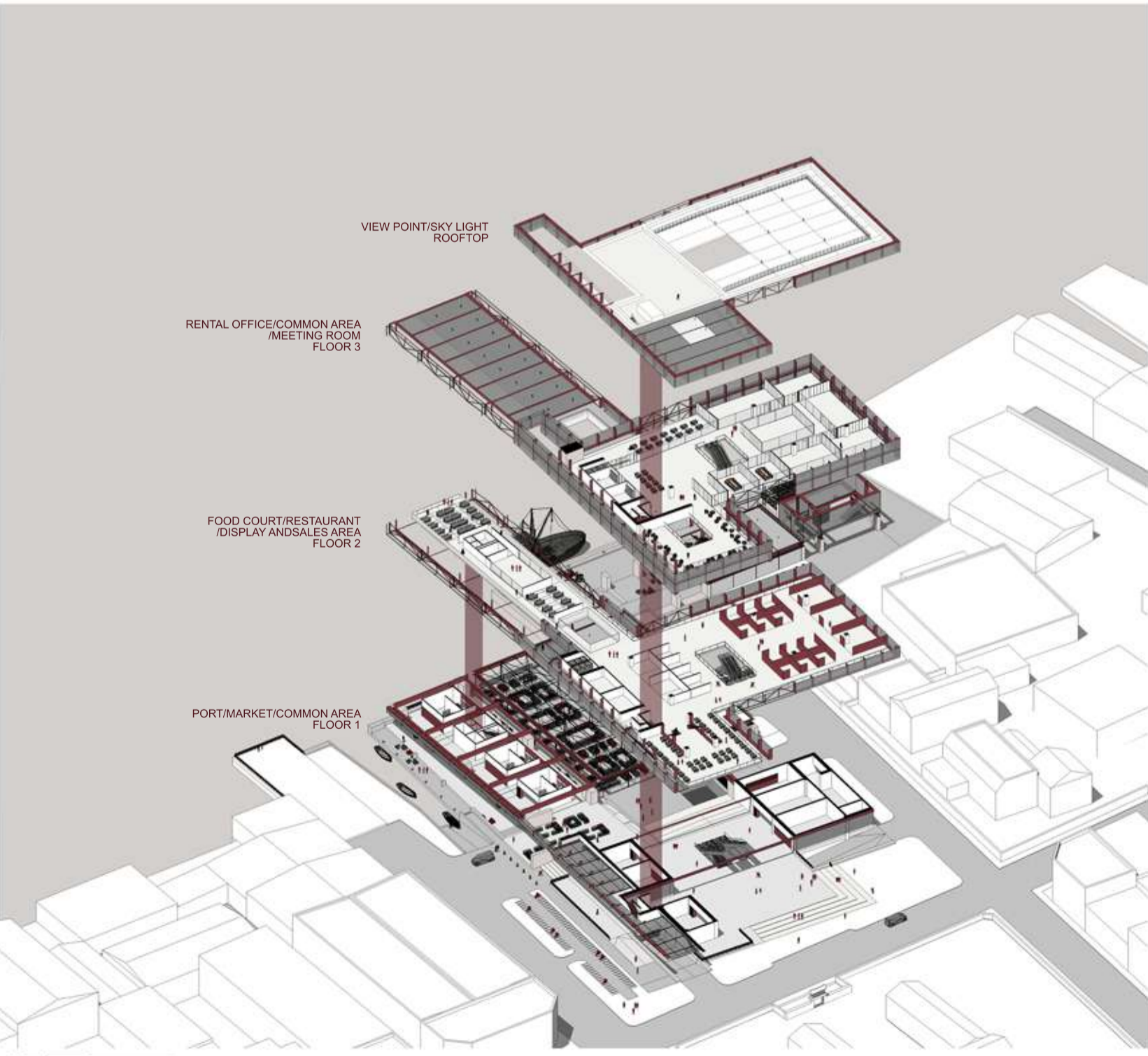

GUIDELINES FOR SOCIAL RESPONSIBILITY PRACTICES THAT ARE IMPORTANT INTERNATIONAL STANDARDS FOR SOLVING THAI FISHING BUSINESS PROBLEMS CONSIST OF 5 ISSUES, NAMELY CONSERVATION AND ENVIRONMENTAL PROTECTION, RESPECT FOR HUMAN RIGHTS FAIR TREATMENT OF LABOR CONSUMER PROTECTION ANTI CORRUPTION SOCIAL RESPONSIBILITY INTERNATIONAL STANDARD

IN ORDER FOR THE FISHERY INDUSTRY TO GROW, DESIGNERS CURRENTLY CONSIDER TWO MAIN APPROACHES THAT CAN BE SOLVED USING THE ARCHITECTURE. ANSWERING THE NEED AND SELLING LARGE QUANTITIES OF COMMODITIES IN ORDER TO MAKE THE MARKET GROW EVERY YEAR, AND THE ONLY THING THAT ARCHITECTURE CAN HELP WITH IS TO BUILD SOMETHING THAT CATER TO LARGE-SCALE FISHERIES SUCH AS MASS DEEP-SEA FISHING PORTS OR IT WILL BE A FACTORY BUILDING THAT CAN STORE HUGE AMOUNTS OF ASSETS. WITH THIS KIND OF FISHERY, IT WILL AFFECT THE ENVIRONMENT IN THE LONG TERM, SO IT IS AN OPTION THAT WILL CREATE PROBLEMS IN THE FUTURE. AND WITH STRICT REGULATIONS AND LAWS, ONLY THOSE WHO HAVE THE READINESS AND THE FINANCIAL RESOURCES CAN DO THIS.

HOUSE AND RESTAURANT

JUNYA ISHIGAMI

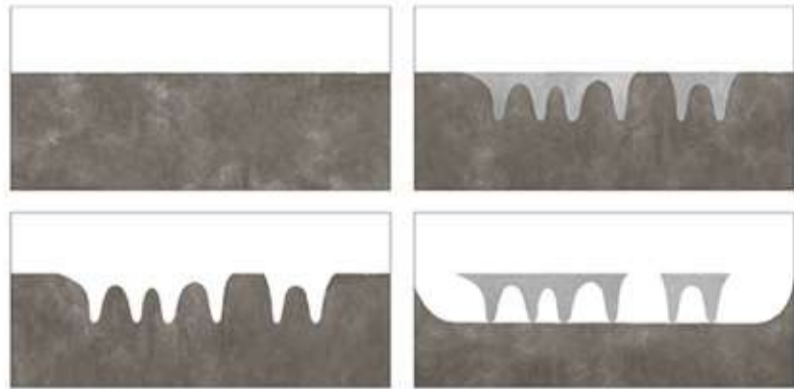

Many architects are fond of using nature metaphors, of attempting to blur the inside and out, but Ishigami is determined to create another nature altogether: by designing buildings that are as primitive and strange as natural phenomena.

So when his client requested something subterranean - 'a cave-like space', he jumped at the opportunity to create something truly archaic.

His project, named 'House and Restaurant' designed for a chef in Southern Japan, opening soon under the name 'Restaurant Noel' takes us below ground into a labyrinth space seemingly tunnelled by giant earthworms.

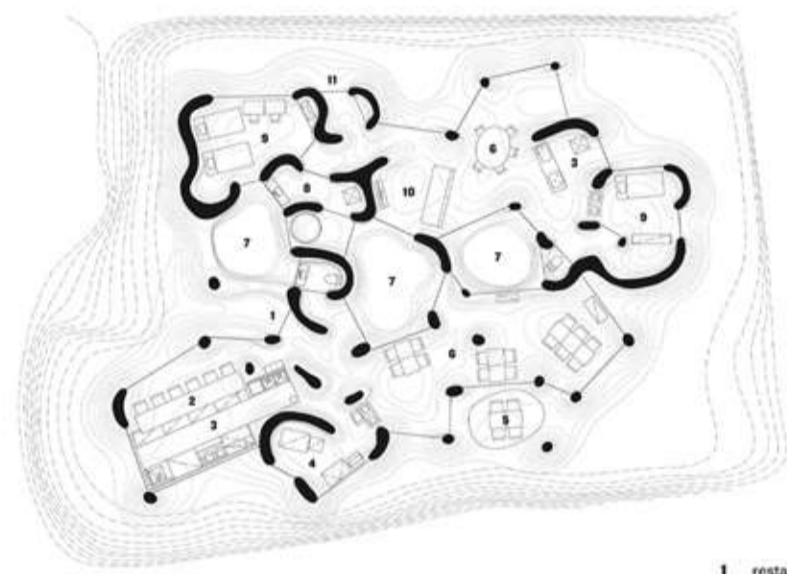
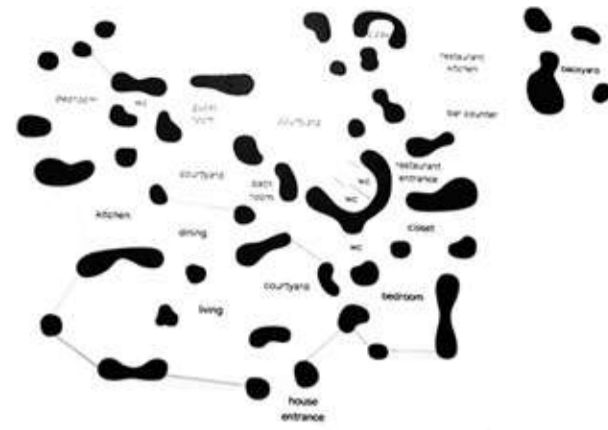

plan

- 1 restaurant entrance
- 2 bar
- 3 kitchen
- 4 back of house
- 5 terrace
- 6 dining room
- 7 courtyard
- 8 bathroom
- 9 bedroom
- 10 living room
- 11 house entrance

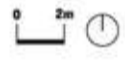

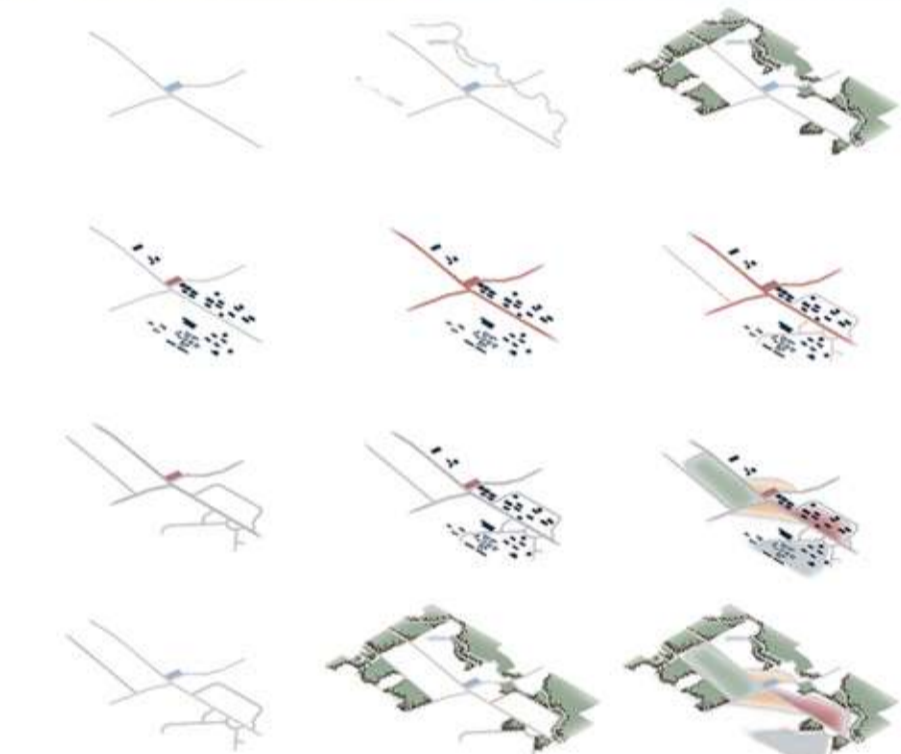

ALTERNATIVE SCHOOL.

PROJECT APPROACH IS LEARNING THAT FOCUSES ON ENGAGING CHILDREN AND ENCOURAGING THEM TO LEARN ON THEIR OWN. IT PROVIDES OPPORTUNITIES FOR CHILDREN TO LEARN WHAT THEY ARE INTERESTED IN ABOUT THE ENVIRONMENT AROUND THEM AND TO RESPOND TO THE DIVERSE NEEDS OF CHILDREN THROUGH A PRACTICAL ACTIVITY THAT FOCUSES ON CHILDREN TO DO IT THEMSELVES.

THIS PROJECT-BASED TEACHING IS A GREAT TEACHING TOOL FOR TEACHERS. BECAUSE IT SHOWS THINGS FROM THE CONCEPT OF REALITY. ASKING QUESTIONS FROM GENUINE INTEREST AND THE CHILD'S IN-DEPTH SEARCH FOR ANSWERS ON A TOPIC OR SUBJECT OF INTEREST TO THE CHILD. IT ALSO FOSTERS SCIENTIFIC SKILLS AND PROCESSES THROUGH EXPLORATION, DISCOVERY, NOTE-TAKING, AND CRITICAL THINKING. TO OBTAIN INFORMATION AND KNOWLEDGE IN ACCORDANCE WITH THE INTERESTS OF CHILDREN THROUGH A VARIETY OF DIRECT EXPERIENCES AS WELL AS THE USE OF ARTISTIC CREATIVITY THAT IS SUMMARIZED INTO PIECES. PROJECT APPROACH SCHOOL IS AN INFORMATION-BASED LEARNING. CHILDREN ARE

SITE ANALYSIS / ELEMENTARY SCHOOLS ARE SCHOOLS THAT ARE PART OF THE UNIVERSITY AND ARE IN CLOSE PROXIMITY TO EACH OTHER, AND BEING IN A RELATED EDUCATION SYSTEM WILL ENABLE SHARING OF FACILITIES SUCH AS SPORTS FIELDS, ELECTRICITY SYSTEMS, TRANSPORTATION, AS WELL AS TRAVEL ROUTES. AND THE GROWTH OR EXPANSION OF THE UNIVERSITY WILL AFFECT THE SCHOOL AS WELL. AND THE CONDITION OF THE SURROUNDING TERRAIN IN THIS AREA, WHETHER IT IS A BROAD CAPITAL OR GRASSLAND, IS WHAT DETERMINES THE NATURE OF THE BUILDING AND ITS DESIGN APPROACH.

PROJECT-BASED LEARNING (PBL) OR PROJECT-BASED INSTRUCTION IS AN INSTRUCTIONAL APPROACH DESIGNED TO GIVE STUDENTS THE OPPORTUNITY TO DEVELOP KNOWLEDGE AND SKILLS THROUGH ENGAGING PROJECTS SET AROUND CHALLENGES AND PROBLEMS THEY MAY FACE IN THE REAL WORLD.

THE ONES WHO FIND ANSWERS ON THEIR OWN. THROUGH LEARNING TOPICS THAT CHILDREN HELP EACH OTHER CHOOSE AND PAY ATTENTION. IT IS LEARNING IN THE MANNER OF INTEGRATING VARIOUS SUBJECTS TOGETHER. THUS ENABLING CHILDREN TO ADD A VARIETY OF SKILLS IT IS WITH THIS INTEREST-BASED LEARNING THAT ENTHUSIASM IS BORN. IF UTILISED EFFECTIVELY, POSSIBLE CHARACTERISTICS MAY INCLUDE: ACTIVE, AGENTIC, COLLABORATIVE, EXPLICIT, LEARNER-FOCUSED, RESPONSIVE, SCAFFOLDED, PLAYFUL, LANGUAGE-RICH AND DIALOGIC.



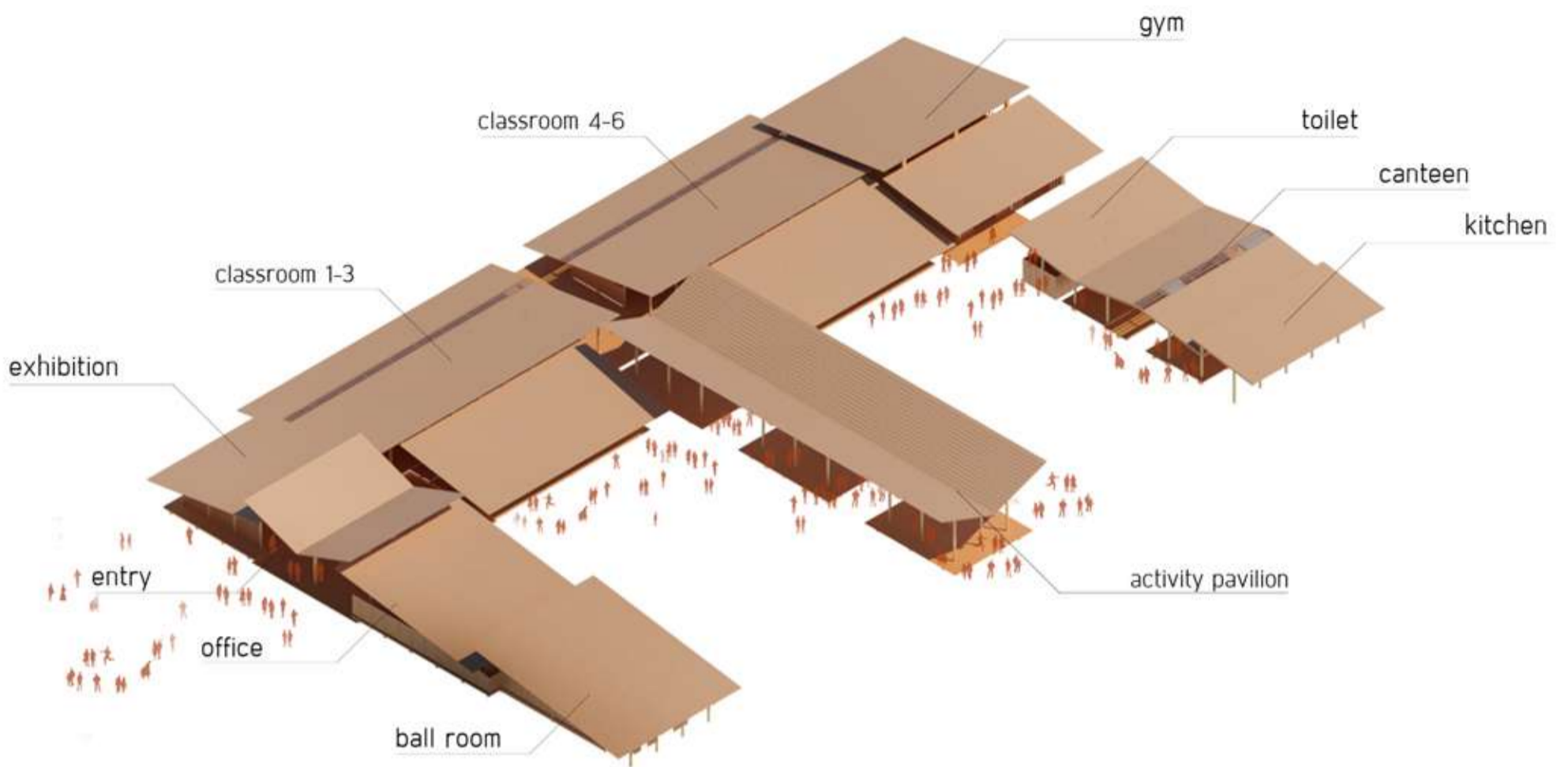

THIS IS A CLASS THAT WILL ALLOW CHILDREN TO INVESTIGATE THE TOPIC THEY ARE STUDYING AT AN INTENSE LEVEL. BY INVESTIGATING CLUES ACCORDING TO THE INTERESTS OF CHILDREN

1. IN THE FIRST STEP, THE CHILD CHOOSES A TOPIC TO STUDY AND DETAILS HOW WE WILL STUDY IT.

IT IS IMPORTANT TO PROVIDE A TOPIC TO FIND THE ANSWER TO. THE CHILD MUST BE INTERESTED AND THE MORE THE CHILD IS INTERESTED, THE MORE EFFECTIVE THE LEARNING WILL BE.

2. IN THE SECOND STEP, THE CHILD WILL CONDUCT A SURVEY AND INVESTIGATE.

AND EXPERTS WILL COME IN TO SHARE WHAT THEY KNOW ABOUT THE TOPICS THE KIDS ARE INTERESTED IN. AND AT THIS STAGE, VARIOUS SCIENCES SUCH AS SCIENCE AND ART ARE GATHERED AND EXPLAINED, RELATED TO THE TOPIC BEING STUDIED.

3. IN THE THIRD STAGE, THE CHILD HAS THE OPPORTUNITY TO QUESTION WHAT HAS BEEN STUDIED. TELL THEM WHAT YOU UNDERSTAND AND EXPLAIN TO OTHERS.

TOPIC PRESENTATION OR CONSIDERATION IN SELECTING A TOPIC MUST TAKE INTO ACCOUNT THE AVAILABILITY OF THE TEACHER, THE PLACE OF LEARNING, AND THE PARENTS TO COOPERATE WITH THE TOPIC.

DISCUSSION /PRESENTATION OF PREVIOUS EXPERIENCES

THERE MUST BE A SPACE TO TALK AND AGREE TO TELL STORIES. IT MUST BE A ROOM WHERE THE CHILDREN SPEAK AND EVERYONE CAN HEAR. THEY CAN BE DIVIDED INTO TWO TYPES: MEDIUM-SIZED GROUPS AND LARGE GROUPS.

FIELD WORK

PROVIDE A FIELD FLOOR THAT CAN BE DONE ON SITE AND A SCHOOL BUS PARKING LOT FOR FIELD TRIPS.

SEARCHING

ROOM FOR VARIOUS KINDS OF SEARCHING, SUCH AS FROM BOOKS, FROM COMPUTERS, OR IS IT THE DESIGN OF THE TEACHER'S ROOM THAT ALLOWS CHILDREN TO ASK QUESTIONS AT ANY TIME.

EXHIBIT

DIVERSE EXHIBITION ZONES TO CATER TO VARIOUS PRESENTATIONS. MAKING A PRESENTATION IS A VERY IMPORTANT ASPECT OF THIS TYPE OF SCHOOL AS IT OUTLINES HOW THE CHILD HAS LEARNED OVER TIME. AND IT NEEDS TO BE DESIGNED TO BE NATURAL AND ACCESSIBLE AS USUAL.



OWN PHUKET

HISTORY REPEATS ITSELF

THE CONCEPT OF THINKING WILL FOCUS ON THE ISSUE OF DESIGNING TO MEET THE NEEDS OF CERTAIN GROUPS AS WELL AS THE CURRENT PRODUCTION OF SERVICES OR EVEN. ARCHITECTURE TO MEET THE NEEDS OF TOURISTS, THEREFORE, THE ISSUE OF DESIGNING TO MEET THE NEEDS OF CERTAIN GROUPS OF PEOPLE IS A TOPIC THAT HAS BEEN PICKED UP TO ASK QUESTIONS AND TRY TO FIND ANSWERS BY USING THE KNOWLEDGE OF THE LEFT AS THE CULPRIT. THE ANSWER CHECK IS LIKE A WORK OF ART BY CHANGING FROM CANVAS TO THE ARCHITECTURE OF THE ANSWER TO THE QUESTION OR EVEN THE QUESTION ITSELF DEPENDS ON THE POINT OF VIEW OF THE PERSON. THIS WORK IS JUST TRYING TO FIND THE ANSWER TO THE QUESTION THAT NO ONE WANTS TO ANSWER OR EVEN COME UP WITH THIS QUESTION.



SINO-PORTUGUESE ARCHITECTURE ABANDONED

SINO-PORTUGUESE ARCHITECTURE IS ABUNDANT IN PHUKET. BY THIS ARCHITECTURE WAS BORN IN 1907 WITH CHARACTERISTICS COMPARABLE TO EUROPEAN ARCHITECTURE OF THAT ERA. BUT IT WAS BUILT BY THE CHINESE, SO IT IS MIXED WITH THE AURA OF CHINESE ARCHITECTURE AND THE CAUSE. THE RESULT OF SINO-PORTUGUESE ARCHITECTURE IS THE ENTRY INTO THE BUSINESS OF THE PEOPLE. WESTERN IN PHUKET, WHERE IN THE PAST WESTERN NATIONS CAME TO SEEK PROFIT FROM THERE ARE MANY TIN MINING OPERATIONS IN PHUKET. RESULTING IN EMPLOYMENT AND THE INFLUX OF PEOPLE INTO PHUKET TOWN AS THE BUSINESS GROWS, THINGS FOLLOW. CAME TO BE THE CREATION OF SINO-PORTUGUESE ARCHITECTURE OR

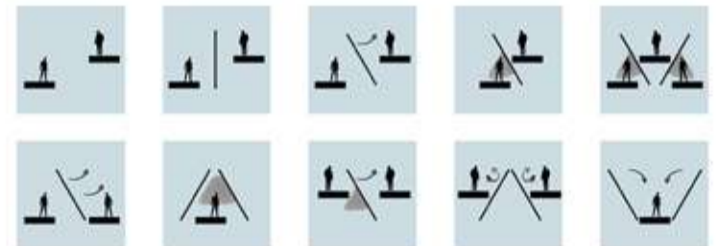

COMPONENT

HOWEVER, I VIEW THAT WHAT IS HAPPENING IN THE PRESENT IS THE SAME AS WHAT HAPPENED IN THE PAST. THAT OUTSIDERS SEE BENEFITS WITHIN PHUKET AND COME TO FIND BENEFITS, ALTHOUGH PHUKET PEOPLE ALSO BENEFIT FROM THIS, BUT IF YOU LOOK BACK, IF WHAT IS HAPPENING NOW ENDS UP LIKE WHAT HAPPENED UP AND THEN IN THE PAST IS THAT WHEN THESE BEAUTIFUL NATURAL RESOURCES ARE DEPLETED, LIKE THE TIN THAT USED TO BE DEPLETED IN WHAT WILL BE LEFT IN THE PAST FOR PHUKET IN THE FUTURE? WHETHER OR NOT THE SAME ARCHITECTURE AS THE SINO-PORTUGUESE REMAINS AS A MONUMENT TO THE PAST IS THE QUESTION THAT RAISED THE IDEA OF DESIGNING AN ART MUSEUM. FOR PHUKET TOWN.

THE ABOVE IDEA INSPIRED THE QUESTION WHETHER THE ARCHITECTURE THAT OCCURRED IN PHUKET TOWN WAS AN ARCHITECTURE CREATED FOR THE PEOPLE OF PHUKET OR FOR THOSE WHO CAME TO SEEK BENEFITS WITHIN THE CITY. PHUKET, FOR EXAMPLE, THE SINO-PORTUGUESE STYLE HOUSES THAT HAPPENED IN THE PAST WERE THE HOMES OF MOST WESTERN BOSSES WHO CAME TO WORK IN PHUKET AND TODAY ALL HOTELS HAVE FOREIGN CUSTOMERS. THE QUESTION IS WHETHER THIS PHUKET TOWN IS BEING BUILT FOR PEOPLE OTHER THAN PHUKET RESIDENTS OR NOT. HARDLY ABLE TO LIVE ON ITS OWN, THIS MAY BE THE RESULT OF PHUKET TOWN NOT DESIGNED FOR PHUKET PEOPLE SO I BRING. THESE STORIES HAVE COME TO DESIGN AN ART MUSEUM FOR PHUKET THAT REFLECTS THE STATE OF PHUKET AND RAISES QUESTIONS ABOUT WHAT IS HAPPENING, WHETHER WHAT IS HAPPENING IS REALLY GOOD OR NOT. THIS SHOULD HAPPEN BECAUSE THERE ARE MANY PEOPLE WHO BENEFIT FROM THESE THINGS, BUT I WOULD LIKE TO INVITE EVERYONE TO QUESTION WHETHER OUR DEPENDENCE IS IT REALLY GOOD FOR FACTORS THAT WE CAN'T CONTROL LIKE EXTERNAL CAPITAL GROUPS, TOURISTS OR WHATEVER, OR SHOULD WE COME BACK TO BE SELF-RELIANT LIKE PHUKET SHOULD HAVE BEEN FOR A LONG TIME,

IN THE EXPERIMENT FROM THE TOPIC DESIGNED TO MEET THE NEEDS OF CERTAIN GROUPS OF PEOPLE, THERE ARE SOME OBSERVATIONS IN THE DESIGN THAT USE LINES INSTEAD. THE BARRIER BETWEEN TWO LEVELS REPRESENTING THE DESIGNED PERSON AND THE NON-DESIGNED PERSON REPRESENTING THE PEOPLE OF SOCIETY. BETWEEN PEOPLE WHO ARE TOURISTS OR CAPITAL GROUPS WITH LOCAL PEOPLE OR MOTHERS, EVEN THOSE WHO COME TO WORK WITHIN THE SOCIETY, WHERE EXPERIMENTS SHOW HOW IT AFFECTS HOW SOMEONE IS DESIGNED OR DELIVERED TO SOMEONE WHO IS NOT DESIGNED FOR THE EXAMPLE OF SPACE. AT IT WAS DESIGNED TO HAVE A SPACE THAT LOOKS LIKE SUPINE TRIANGLE IT REPRESENTS A SPACE THAT IS MORE COMFORTABLE AND SPACIOUS COMPARED TO THOSE THAT WERE NOT DESIGNED TO BE. THE INVERTED TRIANGLE SPACES SHOW MORE PRESSURE AND BLOCKING VIEWS COMPARED TO THE ONES THEY WERE DESIGNED FOR. ANOTHER FACTOR THAT MAKES THE DIFFERENCE BETWEEN THE TWO GROUPS IS THE LEVEL OF SPACE. PEOPLE WHO ARE HIGHER ARE LESS AFFECTED COMPARED TO THOSE WHO ARE LOWER.

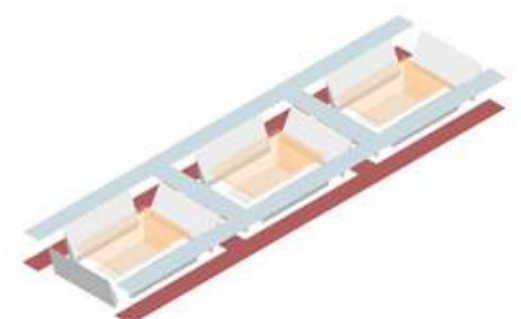

ASSEMBLY

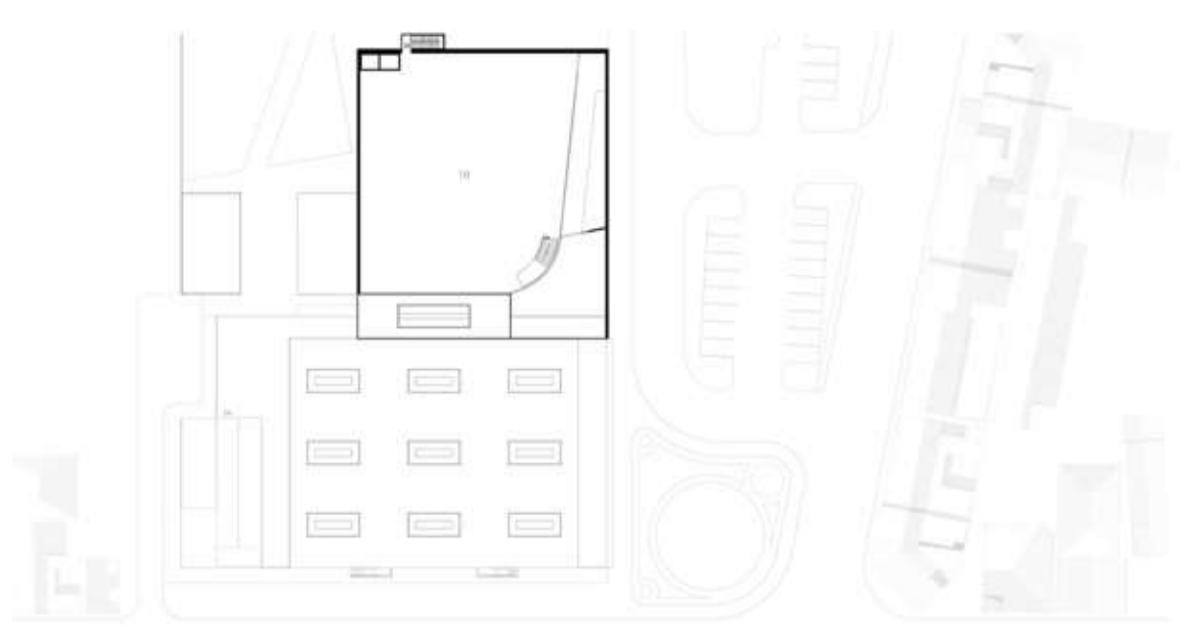

PLAN +6.0



- (1) East
- (2) west
- (3) North
- (4) South



AMONG THE DIVERSITY OF PHUKET, THE VIBRANT AND COLORFUL PHUKET TOWN AND ITS DIVERSE PEOPLE ARE CONSIDERED A GREAT RAW MATERIAL FOR CULTIVATING OR CREATING ART, SO THIS ART MUSEUM IS A CANVAS FOR ARTISTS AND A PLACE FOR PEOPLE. THAT CAN EXPERIENCE A VARIETY OF IDEAS, ALLOWING PEOPLE IN SOCIETY TO ASK QUESTIONS AND TRY TO FIND ANSWERS ABOUT VARIOUS STORIES AS DIVERSE AS A CITY WHERE MANY PEOPLE FROM ALL OVER THE WORLD COME TOGETHER BECAUSE I STRONGLY BELIEVE THAT AMONG ALL THESE DIVERSITY AND COLOURS, THERE ARE MANY STORIES THAT ARE YET TO BE TOLD OR MANY PERSPECTIVES. NOT BEING TOLD, I WANT OUR STORIES TO BE PRESENTED THROUGH PEOPLE'S THOUGHTS AND IMAGINATIONS. ALTHOUGH THE INITIATIVE TO DO THIS PROJECT IS A HEAVY TOPIC OR A SERIOUS SOCIAL COMMENTARY ON WHETHER WHAT HAPPENED IS GOOD OR NOT, SHOULD IT CONTINUE LIKE THIS? THIS IS JUST A POINT OF VIEW FROM A SINGLE PERSON.

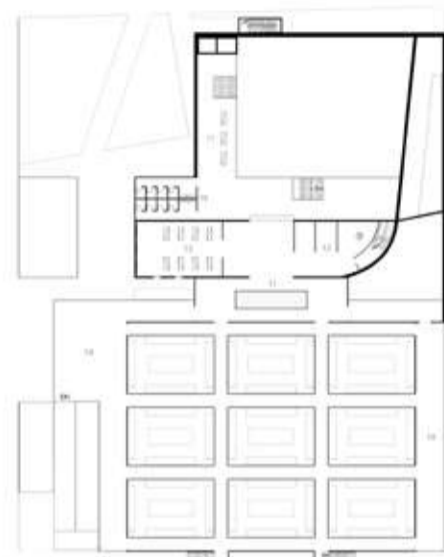

PROGRAM

- | | |
|--------------------------------|-------------------------|
| (1) Entrance hall | (12) Auditory |
| (2) Temporary exhibition | (13) Library |
| (3) Permanent exhibition | (14) Terrace |
| (4) Souvenir shop | (15) Car parking |
| (5) Front office | (16) Motorcycle parking |
| (6) Back office | (17) Bus parking |
| (7) Restaurant | (18) Storage |
| (8) Workshop | (19) W.C. |
| (9) Meeting room | |
| (10) Outdoor multipurpose area | |
| (11) Transition space | |

PLAN +3.0

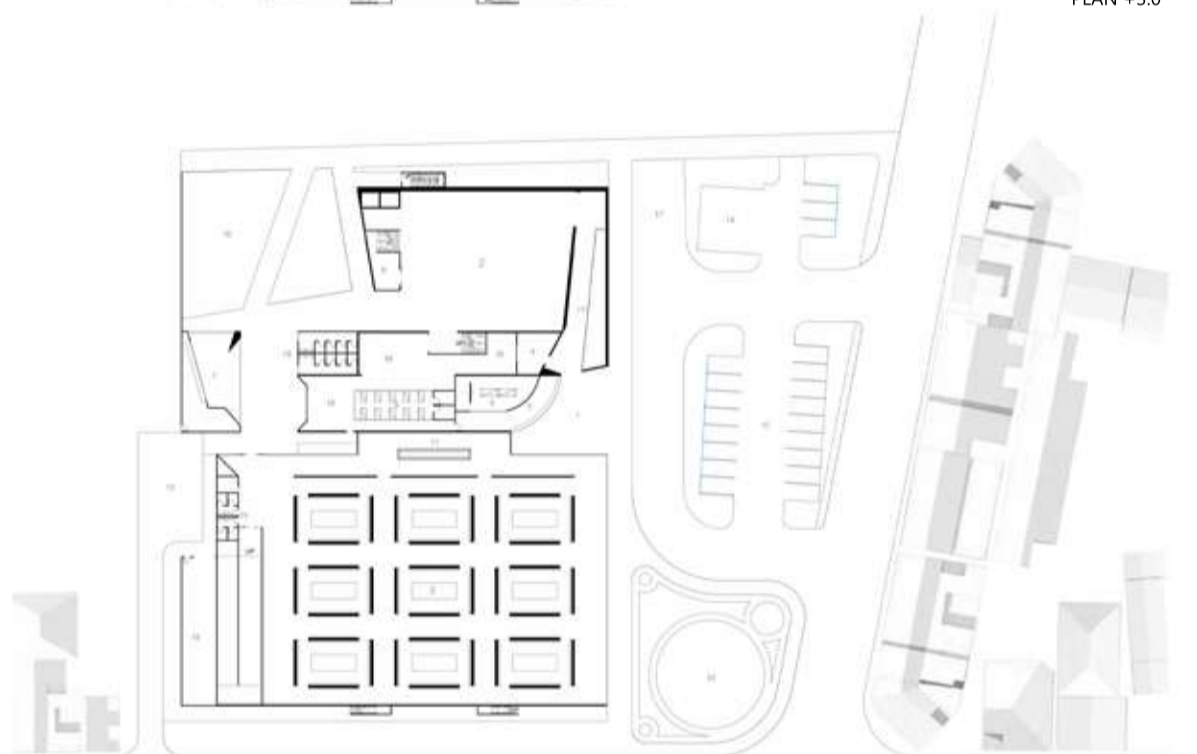

PLAN +0.0

HOWEVER, I STRONGLY BELIEVE THAT NO IDEA IS RIGHT AND NO IDEA IS ALL WRONG. VARIOUS IDEAS ARE IDEAL FOR PHUKET, SO THIS ART MUSEUM WILL BE THE CENTER OF IDEAS THAT DIVERSITY IS TO TALK, EXCHANGE IDEAS AND LISTEN TO EACH OTHER. BECAUSE THESE DIVERSE IDEAS ARE THE BEGINNING OF ENDLESS POSSIBILITIES,

ALL THE STORIES THAT HAVE HAPPENED MAY BE JUST THINKING AND LOOKING FOR OBSERVATIONS, BUT IF YOU LOOK AT IT FROM ANOTHER ANGLE, WHAT IS HAPPENING NOW MAY BE THE BEAUTY OF DIVERSITY. THERE ARE VERY FEW THINGS IN THE WORLD THAT CAN HAPPEN LIKE THIS. THE FACT THAT PEOPLE IN PHUKET WELCOME PEOPLE FROM ALL OVER THE WORLD WHO WANT TO EXPERIENCE THE BEAUTY OF PHUKET FROM A LOCAL PERSPECTIVE. HE REALLY WANTED TO DO IT. BEING ABLE TO WELCOME TOURISTS IN A FRIENDLY WAY MIGHT BE A GOOD THING THAT THE PEOPLE OF PHUKET TOWN WILL TRY TO KEEP IN THE FUTURE.



NOTE THAT THIS PROJECT HAS A CLEAR DESIGN GUIDELINES FOR CREATING EXHIBITION SPACES, HOWEVER, THESE ART SPACES NEED TO HAVE SPACES THAT DO NOT REQUIRE THESE IDEAS. SET A SPACE FOR ARTISTS OR ANYONE TO CREATE CREATIVE WORKS THAT WE DEFINE OR FRAME WILL BLOCK THE CREATIVITY OF THESE PEOPLE, SO WE HAVE PREPARED FOR FREE. A SPACE FOR ARTISTS TO CREATE WORKS THAT REPRESENT THE ARTIST'S IDENTITY.

THE AIM OF THIS PROJECT IS SIMPLY TO RAISE A QUESTION AND ANSWER IT IN ITS OWN WAY AND AFTER THAT, I WOULD LIKE TO INVITE ARTISTS OR PEOPLE IN THE COMMUNITY TO COME UP WITH AN ANSWER TO THIS QUESTION. IF THESE STORIES ARE QUESTIONED AND ANSWERED ENOUGH TO MAKE THIS INTROVERT OUT AND QUESTION HIS SURROUNDINGS AND FIND ANSWERS IN HIS OWN WAY,



Siam Yamato Steel. (SYS) / Laem Samila, Songkhla.
THE EVERYDAY HERITAGE (ASA) / Hua Sai District, Nakhon si Thammarat.
Asia young design award 2020. (AYDA) / Khlong Toei, Bangkok.
NEW BANGKOK BUS STOP (MAYDAY) / Siam, Bangkok.
Arctic hotel. (YAC) / Rovaniemi, Finland.

COMPETITION

UNDULATE PAVILION

EXHIBITION AND AMPHITRATER SPACE



UNDULATE PAVILION

IT IS A PLACE FOR OPPORTUNITIES STUDENTS AND STUDENTS OR TEACHERS IN THE AREA CAN COME AND ORGANIZE. OR TALK SHOW ACTIVITIES OR VARIOUS ACTIVITIES, BUT WILL APPLY BY THIS BUILDING WAS DESIGNED WITH THE CONCEPT OF SPINE IN ADDITION TO THE SPINE IS AN ORGAN. THAT MAKES PEOPLE STAND UP STRAIGHT IT IS ALSO THE CENTER OF TRANSMISSION OF THE NERVOUS SYSTEM IN THE BODY. THEREFORE, WE BRING THE CONCEPT OF TRANSMISSION USED TO CONNECT PEOPLE IN THAT AREA WITH STUDENTS TOGETHER THIS BUILDING IS LIKE A CONNECTION BETWEEN THE CITY AND NATURE. PEOPLE WHO COME TO THE BEACH CAN WALK THROUGH THE BUILDING TO GO OUT TO THE BEACH. ALONG THE WAY, THEY WILL BE ABLE TO WATCH. EXHIBITIONS OR WORKS OF STUDENTS THEY CAN ALSO BE AWARE OF THE ACTIVITIES IN THE AMPHITHEATER AS WELL. AND THE HIGHLIGHT OF THIS BUILDING IS THE BUILDING ACTS LIKE A MOUTHPIECE. WHEN SOMEONE SPEAKS ON THE FLOOR THE SOUND IS REFLECTED TO THE SURROUNDING AREA. TO GIVE A MESSAGE TO THE SPEAKER SENT TO EVERYONE IN THE SURROUNDING AREA CONNECTING THE WHOLE WORLD CAN ONLY BEGIN WITH THE SLIGHTEST SOUND.

SITE

SOI RATCHADAMNOEN, BO YANG SUBDISTRICT, MUEANG SONGKHLA DISTRICT SONGKHLA PROVINCE USED TO BE A LINK TO SAMILA BEACH. SAMILA BEACH IS AN IMPORTANT RESTING PLACE FOR PEOPLE IN MUEANG SONGKHLA DISTRICT AND NEARBY AREAS. IN MUEANG SONGKHLA DISTRICT, THERE ARE MANY EDUCATIONAL INSTITUTIONS, BUT THERE IS NO AREA. FOR GIVING STUDENTS THE OPPORTUNITY TO TRULY EXPRESS THEIR IDEAS AND WORKS WITH THE COMMUNITY.

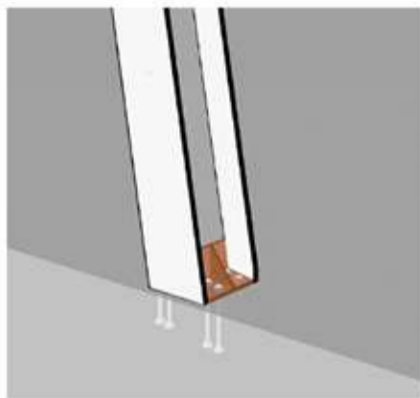

THE BENEFICIAL EFFECTS OF THE UTILITY MODEL ARE: DURING INSTALLATION, BY THE ELIMINATION OF THE SLEEVE BETWEEN STONE BOLT AND THE ANCHOR (BOLT) HOLE INTERMITTENTLY, RESTRICTEDLY FOOT BOLT IS MOBILE, THEREBY HAS PREVENTED THAT STONE BOLT FROM REACHING RUN-OFF THE STRAIGHT AFTERWARDS WHEN GROUTING.

MODULAR ARCH SUPPORTS THE WEIGHT OF THE STRUCTURE TO GET A BEAUTIFUL SHAPE FROM. THE SIZE OF THE STRUCTURE HAS BEEN CUT TO BE THE SAME SIZE FOR EASY ASSEMBLY.

MOST OF THE STRUCTURES ARE DESIGNED SO THAT THEY CAN BE MANUFACTURED IN A FACTORY AND CAN BE ASSEMBLED IN THE PRE-BUILT AREA LATER. AND PARTS ARE COMPOSED OF STEEL AS A LOAD-BEARING STRUCTURE THE OUTER SURFACE IS ACRYLIC AS A BUILDING SURFACE. THAT CAN BE CUT TO THE DESIRED SIZE THE DESIGN OF THE BUILDING WILL BE IN THE MIDDLE BETWEEN THE INDOOR AND OUTDOOR AREAS, SO THE SELECTED MATERIALS MUST BE DURABLE AND WEATHERPROOF, AND ALSO CLOSE TO THE SEA, THUS PREVENTING THE WIND FROM BLOWING, CAUSING THE BUILDING TO RUST. AS WELL

AXONOMETRIC

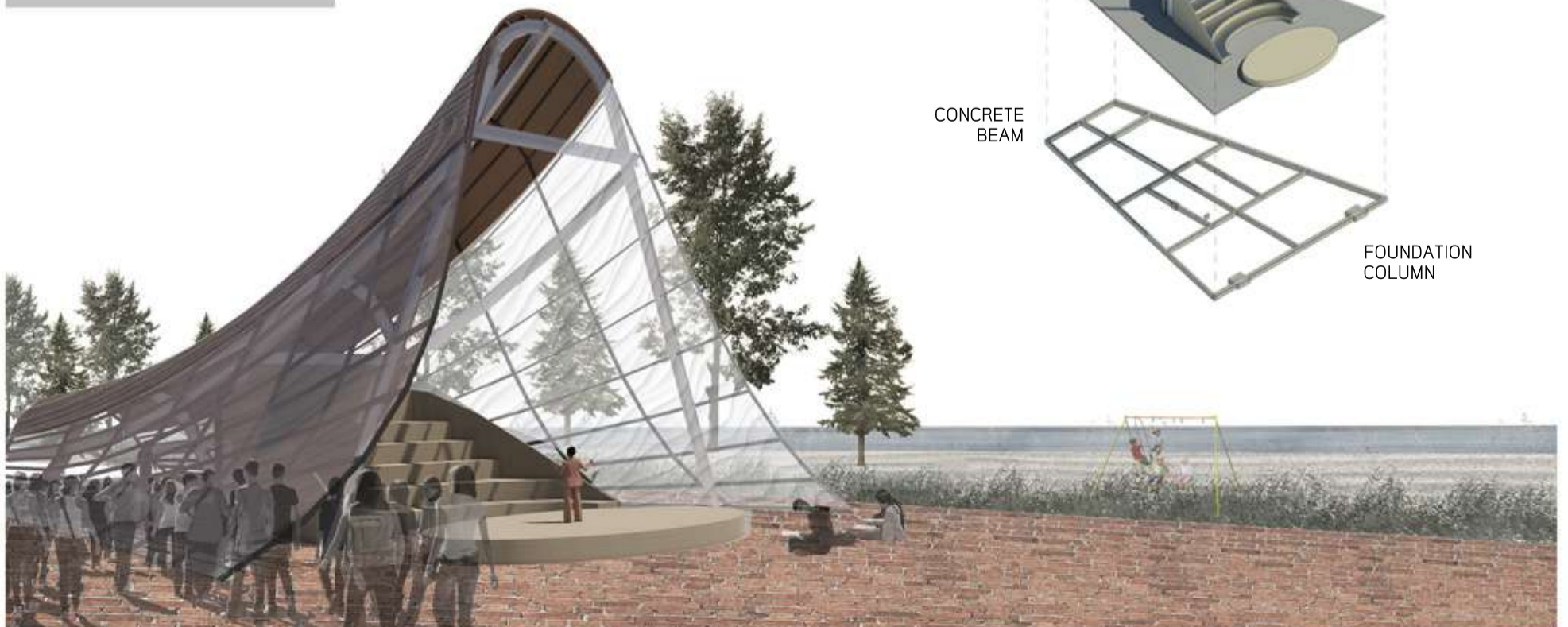
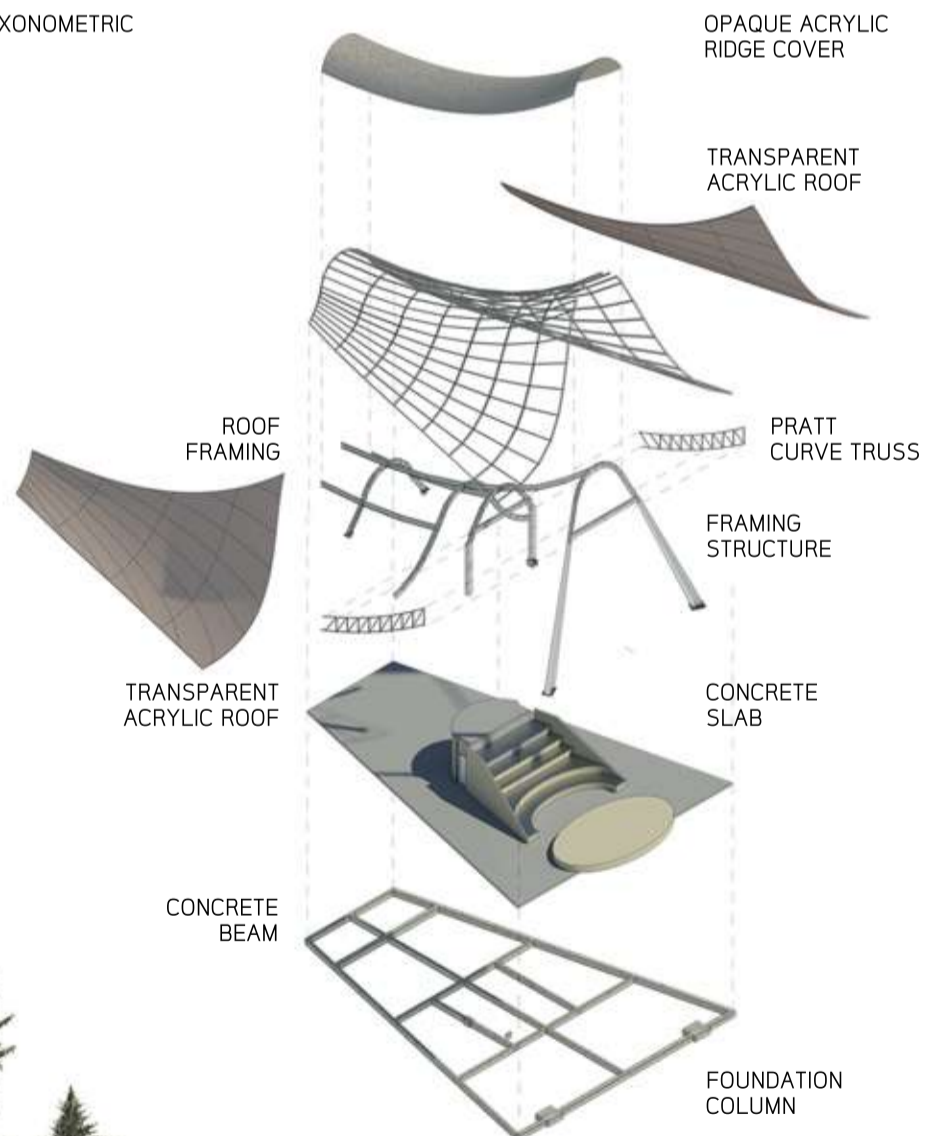

เรือน นายหัว

TRADITIONAL THAI AND CHINESE HOUSES IN THE SOUTHERN STYLE. HUNDREDS OF YEARS OLD AND DETERIORATED WITH TIME AND NO RESTORATION. THE MAIN BUILDING IS IN THE COMMUNITY. I HAVE BEEN AROUND WAT PHATTHASIRI FOR A LONG TIME.

ORIGINALLY, THIS HOUSE WAS A RESIDENCE OF THE KAMNAN, HUA SAI DISTRICT, NAKHON SI THAMMARAT PROVINCE. IN THE PAST, THIS AREA EXPERIENCED FREQUENT SEASONAL FLOODING, CAUSING THE BUILDING TO HAVE A STRUCTURAL CONDITION THAT VERY DILAPIDATED UNTIL THE USE OF PEOPLE IN THE COMMUNITY FOR A LONG TIME.

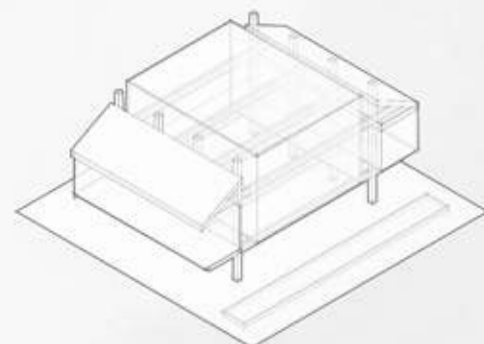
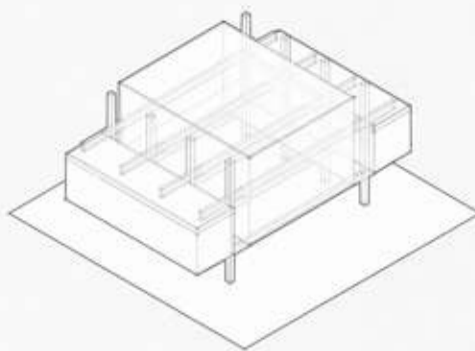
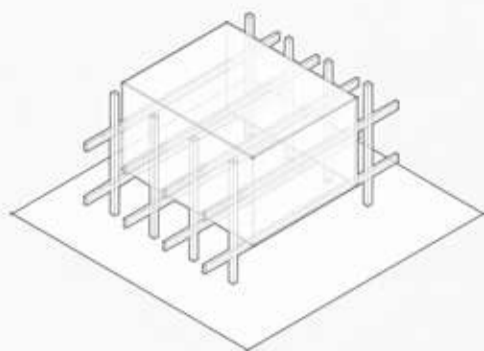
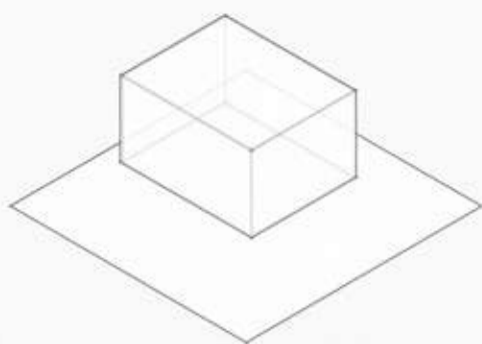

HERITAGE/STORY

ORIGINALLY, THIS HOUSE WAS A RESIDENCE OF THE KAMNAN, HUA SAI DISTRICT, NAKHON SI THAMMARAT PROVINCE. IN THE PAST, THIS AREA EXPERIENCED FREQUENT SEASONAL FLOODING, CAUSING THE BUILDING TO HAVE A STRUCTURAL CONDITION THAT VERY DILAPIDATED UNTIL THE USE OF PEOPLE IN THE COMMUNITY FOR A LONG TIME.

AREA WAT PHATTHASIMA COMMUNITY, HUA SAI DISTRICT, NAKHON SI THAMMARAT PROVINCE A LOWLAND AREA AND FREQUENT FLOODING AND A MEDIUM-SIZED COMMUNITY MOST OF THE ROADS PASS THROUGH THE COMMUNITY. MOST OF THE PEOPLE IN HUA SAI COMMUNITY ARE ENGAGED IN AGRICULTURE, WHETHER IT IS RUBBER PLANTATION, RICE FIELDS, AND SHRIMP PONDS. BY ALLOWING PEOPLE IN THE COMMUNITY TO PARTICIPATE IN USING THE AREA IN THIS AREA, THERE MUST BE AN AREA OF EXCHANGE FOR EACH OTHER. AND IS THE CENTER OF PEOPLE WHO PASS THROUGH THIS AREA FOR THE COMMUNITY TO HAVE INTERACTIONS BETWEEN PEOPLE AND THIS PLACE.

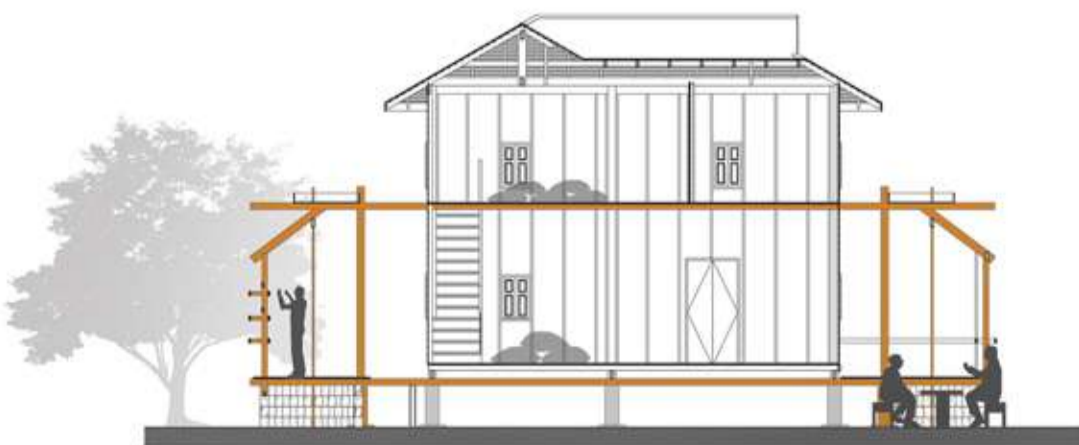
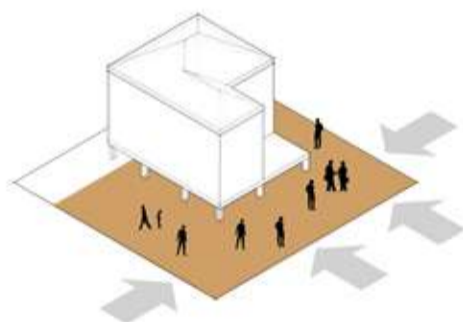
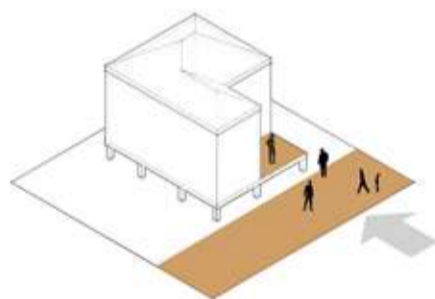

THE AFOREMENTIONED SOUTHERN THAI-CHINESE HOUSE HAS A DETERIORATED STRUCTURE AND IS DAMAGED BY TIME AND FLOODING. THE BEAM STRUCTURE HAS SIGNS OF FRACTURES. SINCE IT IS A TWO-STORY HOUSE, THE WEIGHT LOAD AFFECTS THE SYSTEM. THE CURRENT STRUCTURE IS AT RISK OF COLLAPSE. BY WANTING TO REINFORCE THE STRUCTURE FROM THE ORIGINAL STRUCTURE TO BE STRONG AND ABLE TO SUPPORT THE WEIGHT IN ORDER FOR THE HOUSE TO BE USED BY KEEPING THE MATERIAL CHANGES TO A MINIMUM, THIS HOUSE REFLECTS THE ANTIQUE HOUSE AND THE ORIGINAL MATERIAL WHICH HAS ITS OWN CHARM.

GENERAL ACTIVITIES THAT TAKE PLACE WITHIN THE COMMUNITY MOST OF THEM ARE MAINLY RELATED TO THE WAY OF LIFE AND OCCUPATION. THE DESIGN WORK UNDERSTANDS THIS POINT WELL AND PROVIDES SPACE FOR THOSE ACTIVITIES SUCH AS RICE TERRACES, STORAGE AREAS, OR IS IT AN AREA FOR DRYING RUBBER SHEETS IT IS ALSO A MEETING PLACE FOR PEOPLE.

APPLICATIONS ARE DESIGNED USING THE CONCEPT OF COEXISTENCE WITH NATURE. GENERALLY, HOUSES IN THE SOUTH ARE RAISED IN THE RAINY SEASON WITH FLOODING, THE HOUSE WILL NOT BE DAMAGED, AND THE REINFORCED STRUCTURE TAKES THIS INTO ACCOUNT AS WELL. AT REGULAR INTERVALS, IT WILL BE AT A LEVEL THAT CAN BE EASILY USED. IN THE EVENT OF A FLOOD, THIS WATER STRUCTURE CAN BE ELEVATED.

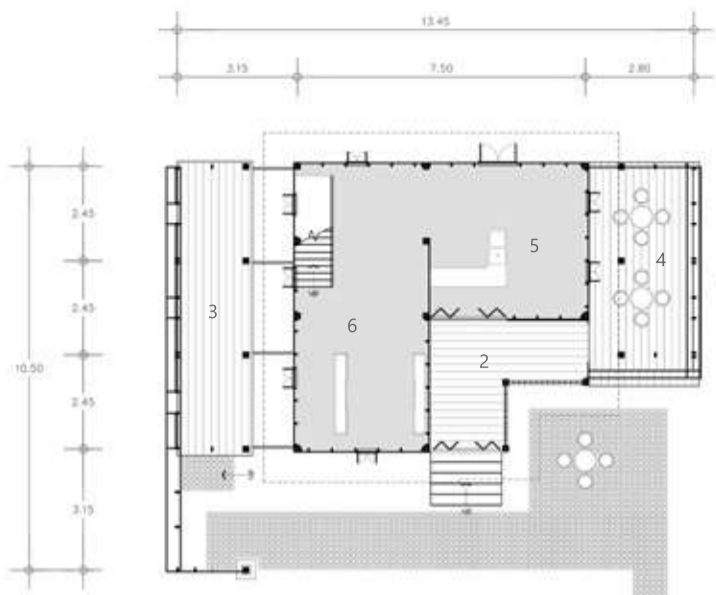

ผังพื้นชั้น 1

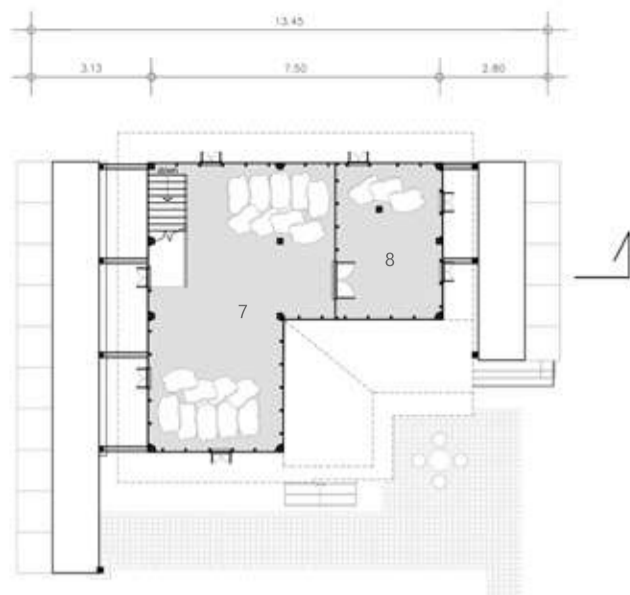

ผังพื้นชั้น 2



PROGRAM

- (1) ลานตากข้าว
- (2) ชาน
- (3) ตากยางแผ่น
- (4) เจริญ, ถิ่นน้ำชา, พุดคุย
- (5) รัานน้ำชา
- (6) เก็บยางแผ่น
- (7) เก็บข้าวเปลือก
- (8) เก็บข้าวเปลือก



รูปด้านทิศเหนือ

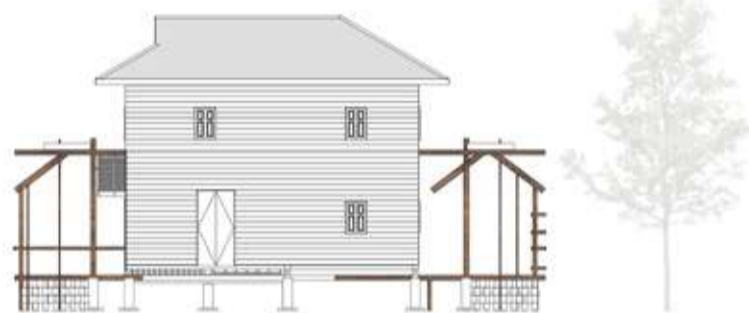

รูปด้านทิศใต้



รูปด้านทิศตะวันตก

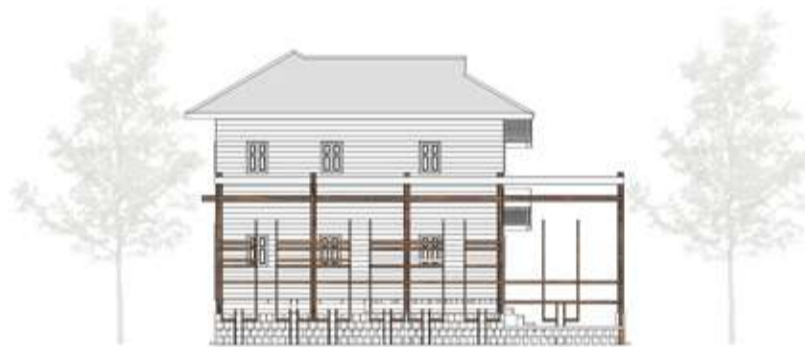

รูปด้านทิศตะวันออก



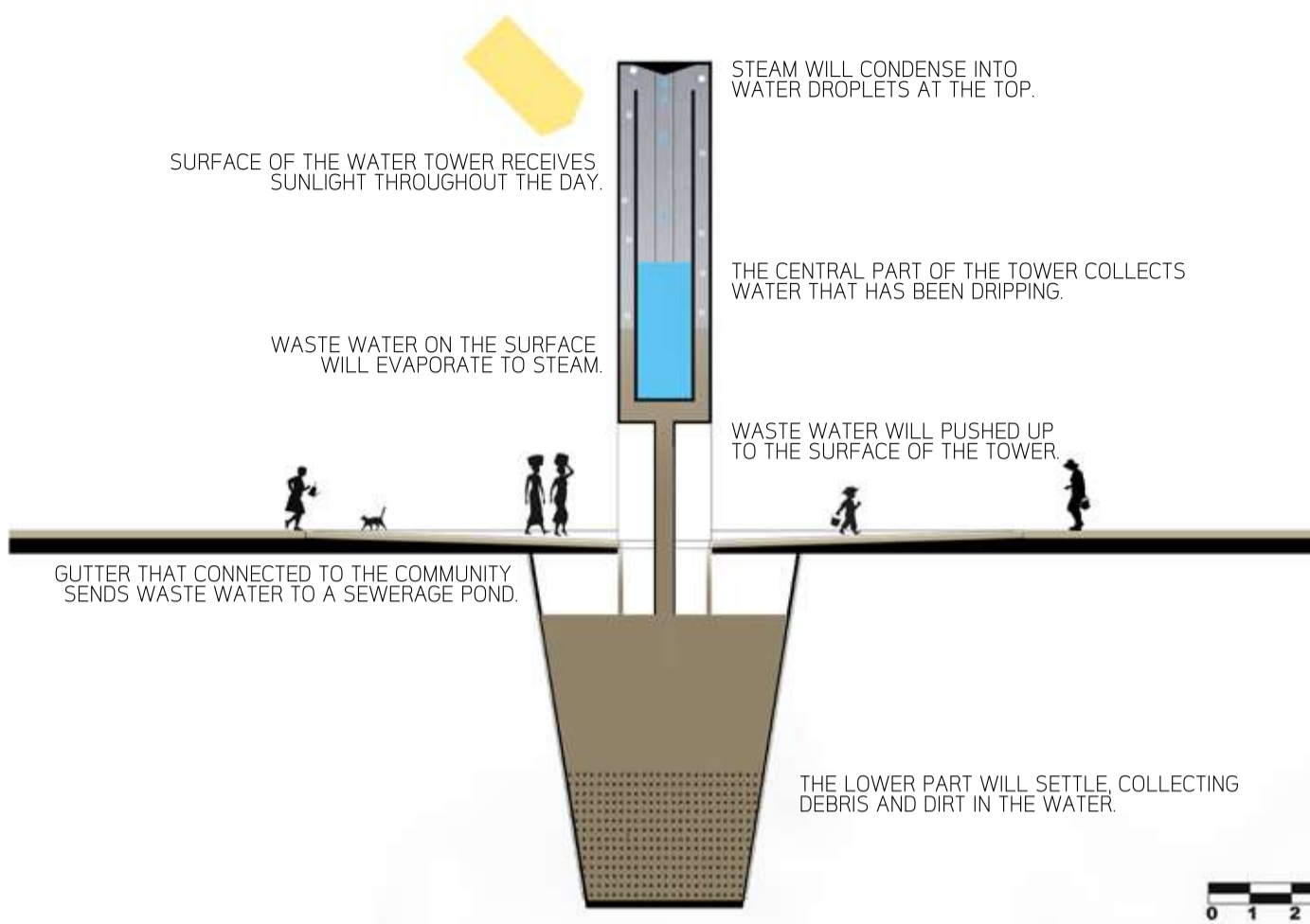

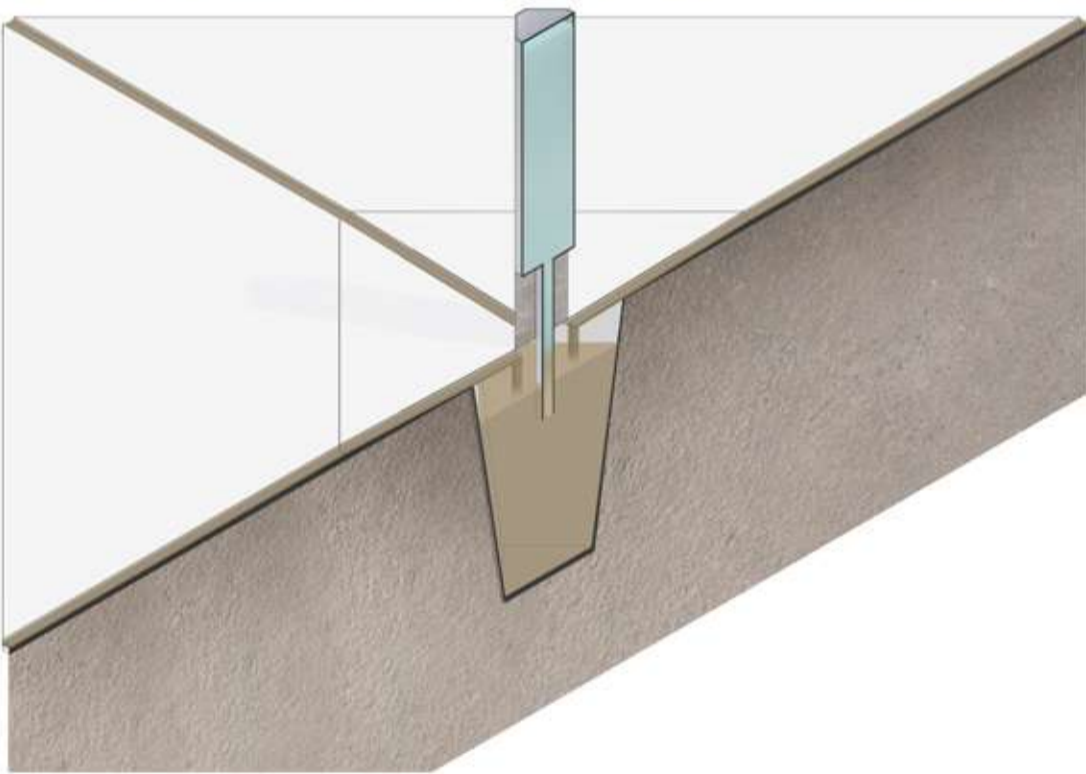

NUMJAI

IN CHOOSING THE LOCATION OF THE PROJECT, IT WILL TAKE INTO ACCOUNT THE SLUM AREAS THAT FACE THE PROBLEM OF LACK OF CLEAN DRINKING WATER FOR CONSUMPTION. KHLONG TOEI NAI SPECIAL COMMUNITY AREA IT IS TAKEN AS AN EXAMPLE AREA IN THE DEVELOPMENT OF THIS PROJECT BECAUSE THE COMMUNITY IS A LARGE SLUM OF BANGKOK AND WITHIN THE COMMUNITY THERE ARE MANY FACTORS WHICH ARE SUITABLE FOR SETTING UP THE PROJECT SUCH AS UNRESOLVED WASTEWATER AND WATER SUPPLY PROBLEMS, THAT CAN'T BE EATEN, SO CHOOSE THE KHLONG TOEI NAI SPECIAL COMMUNITY AS A SAMPLE CASE FOR THE PROJECT.

KHLONG TOEI SUBDISTRICT IS THE LARGEST SUBDISTRICT IN KHLONG TOEI DISTRICT WITH AN AREA OF 6,131 SQ. KM. AND IMPORTANT BUSINESS CENTERS SUCH AS THE PORT AUTHORITY OF THAILAND, TOBACCO PLANT, PETROLEUM DEPOT, CUSTOMS DEPARTMENT, QUEEN SIRIKIT NATIONAL CONVENTION CENTER, AND IS THE LOCATION OF THE OLD COMMUNITY AND THE LARGEST IN THE COUNTRY

ONE OF THE MAIN INSPIRATIONS IS THE HOUSEHOLD SEWAGE SYSTEM, OR DRAINAGE DITCHES IN THE FRONT OR BACK OF THE HOUSE, WHERE THEY CAN BE FOUND. IN GENERAL, WITHIN MANY COMMUNITIES WHERE THESE DRAINAGE DITCHES CAUSE MANY PROBLEMS, INCLUDING DIRT, AND THE BAD SMELL MAKES ME THINK THAT POURING WATER INTO THE DITCH IN FRONT OF THE HOUSE CAUSES PROBLEMS IN THE COMMUNITY. IF WE CHANGE THESE ACTIONS TO BENEFIT RATHER THAN HARM, IT WILL NORMALIZE THE WAY WE LIVE. FROM THE NEGATIVE EFFECTS TO THE BENEFITS SHOULD BE A VERY INTERESTING IDEA. THEREFORE, IT IS THE INTEGRATION OF THESE DRAINAGE CHANNELS TOGETHER AND TREATING THOSE WATERS SO THAT PEOPLE IN THE COMMUNITY CAN USE THESE WASTEWATER TO BE CLEAN WATER FOR CONSUMPTION THAT WILL IMPROVE THE QUALITY OF LIFE.

AREAS THAT ARE IMPORTANT TO THE COMMUNITY IS AN AREA FOR GATHERING OR DOING VARIOUS ACTIVITIES WHICH IS AN OPEN SPACE THAT PROVIDES OPPORTUNITIES FOR PEOPLE WITHIN THE COMMUNITY TO PARTICIPATE, EXPRESS THEIR OPINIONS, SHOW THEIR ABILITIES, DISCUSS VARIOUS MATTERS

THEREFORE, THE SURROUNDING AREA OF THE PROJECT WILL BE OPENED AS A COURTYARD. FOR THESE ACTIVITIES, IT ALSO HELPS PEOPLE IN THE COMMUNITY TO HAVE A SENSE OF BELONGING IN THE COMMUNITY AND ALSO ALLOWS PEOPLE WITHIN THE COMMUNITY TO INTERACT WITH EACH OTHER. I HAVE NOTICED THAT IN MANY SLUMS THERE IS NO CONSIDERATION OF SPACE. OVERALL, FOR ME, I SEE THAT THE COMMUNITY AREA IS IMPORTANT. BECAUSE WHILE THE LIVING SPACE OF PEOPLE IS LIMITED, THE FACT THAT WE HAVE PUBLIC SPACE GIVES PEOPLE THE OPPORTUNITY TO DO ACTIVITIES THAT CANNOT BE DONE IN THE AREA OF THEIR OWN HOME, WHICH I CONSIDER, IT IS AN IMPORTANT DEVELOPMENT OF QUALITY OF LIFE AND WILL RESULT IN PEOPLE IN THE COMMUNITY LOVING THEIR HOMETOWN MORE AND WANTING TO IMPROVE THEIR HOMETOWN.

LIFESTYLES SOMETIMES CAUSE PROBLEMS FOR THE COMMUNITY, SUCH AS DUMPING DIRTY WATER INTO THE WATER SOURCE SOMETIMES IF WE SEE THE POSSIBILITY TO ADJUST. TURNING THESE NORMAL THINGS INTO SOMETHING FOR THE BETTER AND MAKING BEHAVIORS POSITIVE RATHER THAN NEGATIVE IS A KEY IDEA. FOR THE PROJECT SOMETIMES THE IMAGES THAT WE HAVE SEEN UNTIL WE ARE USED TO WHAT WE LOOK AT AND FEEL UNCOMFORTABLE MAY CHANGE TO THE SAME IMAGE THAT WE SEE BUT DO NOT FEEL UNCOMFORTABLE ANYMORE.

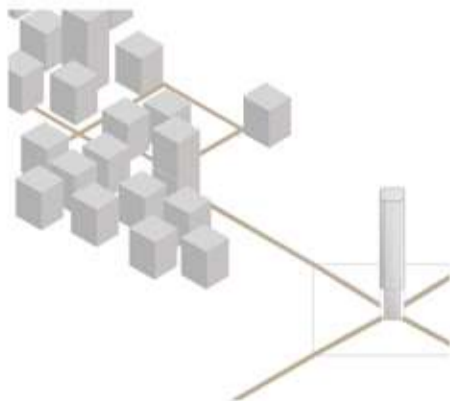
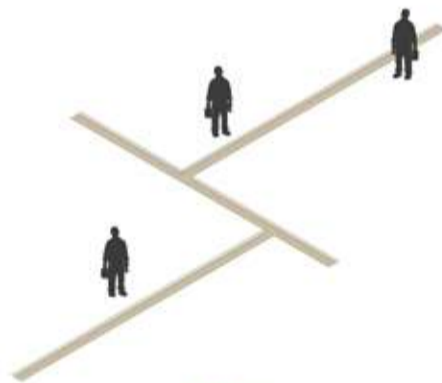

THE SURROUNDING AREA IS CONSIDERED AN IMPORTANT AREA OF THE PROJECT BECAUSE THE AREA USED FOR THE ACTIVITIES OF THE PEOPLE IN THE COMMUNITY IS CONSIDERED A SMALL AREA FOR A RATHER CROWDED COMMUNITY. HAVING A LARGE OPEN SPACE WILL MAKE THE COMMUNITY MORE LIVELY BECAUSE THE PEOPLE IN THE COMMUNITY ARE IN LIMITED PLACES. HAVING A LARGE OPEN AREA ALLOWS FOR OUTDOOR ACTIVITIES SUCH AS TALKING, EXERCISE



THE FIRST STEP OF THE PROJECT IS TO CONNECT THE SEWAGE DISCHARGE SYSTEM AND SEWAGE TREATMENT PLANT TO THE RESIDENTIAL SEWAGE TREATMENT PLANT. THEREFORE, WATER IN COMMUNITIES AND WATER TREATMENT CAN BE OBTAINED FROM NATURAL RAINFALL. STORAGE IN SANDBOX AND OTHER DISINFECTION AND SUPPLEMENTARY ELEMENTS CAN SAFELY PROVIDE BENEFITS. THIS IS A DIRECT CONNECTION TO THE SWIMMING POOL, EVEN IF IT IS DIRTY, BECAUSE CLEAN WATER IS NOT IMPORTANT AND WATER IS GOOD. NO MATTER HOW DIRTY THE CAR IS, IT CAN BE CLEANED THROUGH THE DISINFECTION TOWER, SO PEOPLE IN THE COMMUNITY DON'T HAVE TO WORRY ABOUT US. TAKE YOUR OWN HOUSE. COMMUNITIES CAN LIVE IN A PRIMITIVE WAY WITHOUT WORRYING ABOUT THE INCONVENIENCE THIS DISEASE WILL BRING TO THEIR LIVES.

THE SECOND IS A PLACE WHERE CLEAN WATER GOES BACK TO THE COMMUNITY. I GOT INSPIRATION FROM A MODERN POND. EVERYONE IN THE COMMUNITY LIKES WATER. CONSUMPTION IN ADDITION, REDISTRIBUTION WILL REDUCE THE COST OF DRINKING WATER, WHICH IS A MAJOR FACTOR IN HUMAN LIFE, EVERYONE CAN GET A CLEAN DRINKING WATER, WHICH IS THE BASIS OF A GOOD LIFE. SOCIALIZATION.



DESIGN INSPIRATION

THE INSPIRATION FOR THE DESIGN COMES FROM THE CURRENT EVENTS THAT ARE COVID19 AND MAKES PEOPLE IN SOCIETY TO FOLLOW THE PRINCIPLES OF SOCIAL DISTANCING OR SOCIAL DISTANCING. THIS TOPIC INSPIRED AND BECAME A DESIGN TOPIC, DISTANCING TO CONNECTING, OR SPACING THEM CLOSER TOGETHER.

SOCIAL DISTANCING

MEANING ACCORDING TO PUBLIC HEALTH PRINCIPLES (PUBLIC-HEALTH) SOCIAL DISTANCING MEANS REDUCING CLOSE CONTACT BETWEEN ONESELF AND OTHERS, INCLUDING FAMILY MEMBERS. TO REDUCE THE SPREAD OF VARIOUS COMMUNICABLE DISEASES, ESPECIALLY RESPIRATORY DISEASES SUCH AS FLU, TUBERCULOSIS, INCLUDING THE COVID-19 THAT IS SPREADING NOW, THE LONGER THE DAYS OF THE COVID-19 OUTBREAK (COVID 19) IT WILL CONTINUE TO EXPAND UNTIL THE WHO HAS FINALLY DECLARED COVID-19 A GLOBAL EPIDEMIC (PANDEMIC), SO WHATEVER IT IS DOING THAT WILL HELP US SURVIVE THE CORONAVIRUS SHOULD BE DONE FIRST. ESPECIALLY IF YOU HAVE TO GO OUT AND MEET A LOT OF PEOPLE OR EVEN SOCIALIZING IN EVERYDAY LIFE THERE SHOULD BE SOCIAL DISTANCING. DISTANCING CAN BE AN ACT THAT MAKES PEOPLE FEEL SEPARATED. BUT DUE TO THE NEED FOR PEOPLE TO DISTANCING WITH EACH OTHER IS A NECESSARY ACTION.

CONNECTING

IN A SOCIAL ENVIRONMENT WHERE SOCIAL DISTANCING IS STRESSFUL AND MAKING THE SOCIAL ATMOSPHERE HAZY, IT CAN CAUSE SOCIETY TO FALL INTO A BAD STATE. DISTANCING TO CONNECTING IS THEREFORE A CONCEPT TO BRING PEOPLE BACK TO INTERACTING. MUST BE IN TERMS OF SOCIAL DISTANCING, THEREFORE BECOMING A CONDITION IN THE DESIGN OF THE WORK AND MAKING THE SPACE THAT COMES OUT MUST BE CONNECTED TO THE CONTEXT OF BOTH THIS ALSO HAD TO PROTECT YOURSELF AT THE SAME TIME. THE DESIGN APPROACH IS TO RAISE THE SPACE TO PROTECT FROM THE OUTSIDE AND CHOOSE A PARTITION THAT IS TRANSPARENT MATERIAL TO MAKE THE PEOPLE INSIDE CONNECT THE VIEW TO THE OUTSIDE. WITHIN A SPACE, THE WAITING AREA IS CLEARLY SEPARATED AND THE CIRCULATION FUNCTION IS SEPARATED. ANOTHER FUNCTION BEHIND THE WAITING AREA IS TO MAKE THE WORK WORK AS A PAVILION THAT PEOPLE CAN ENTER AT THE SAME TIME. NOT WAITING FOR THE BUS, AS AT NIGHT, IT WILL BECOME A DESTINATION FOR PEOPLE TO USE AND FEEL SAFE AS WELL.

SEGMENTING PEOPLE APART IN ORDER TO CONTROL AND ORGANIZE THE PEOPLE WHO COME IN. BY DIVIDING PEOPLE ACCORDING TO THE TYPE OF REQUEST FOR USE, SUCH AS COMING ALONE OR AS A GROUP, THE FOLLOWING PROPORTIONS WILL BE DIVIDED IS THE DESIGN BY THINKING FROM CRITERIA TO DESIGN AND MAKE IT IN ACCORDANCE WITH THE SET CONCEPT, FOR EXAMPLE, THE USE OF CLEAR PVC SHEET TO USE AS A PARTITION FOR THE REASON THAT YOU WANT TO OPEN THE VIEW FROM THE OUTSIDE AND INSIDE IN ORDER TO MAKE PEOPLE LOOK CAN SEE THE BUS WHICH CAN ALSO PREVENT GERMS AND DUST FROM OUTSIDE TO A CERTAIN EXTENT FROM THE CONCEPT OF DISTANCING TO CONNECTING.

THIS WORK WAS CHOSEN AS A LIGHTWEIGHT STEEL STRUCTURE THAT WAS EASY TO INSTALL. THE MAIN STRUCTURE, WHICH IS A SKELETON STRUCTURE, WAS CHOSEN AS A WIDE FLANGE STEEL AND DESCENDED AS A STEEL CHANNEL DOWN TO THE IMPORTANCE OF LOADING AND REDUCING THE WEIGHT OF THE STRUCTURE. THE STRENGTH APPLIED TO STRENGTHEN THE STRUCTURE IS BRACING BY USING A LIGHTWEIGHT CARBON STEEL PIPE. ANOTHER DESIGN THAT AFFECTS THE LOAD DESIGN IS THE LIFTING OF SPACE AND, DUE TO THE LOW ARCHITECTURAL FOOTPRINT, A CANTILEVER STRUCTURE IS REQUIRED TO MINIMIZE COLUMNS DOWN TO THE GROUND. MUST BE INSTALLED TO TRANSFER FORCE TO THE STRUCTURE PROPERLY. AND ANOTHER IMPORTANT REASON TO CHOOSE STEEL STRUCTURE IS THAT STEEL STRUCTURE IS ENVIRONMENTALLY FRIENDLY BECAUSE STEEL HAS A CIRCLE IN USE THAT CAN BE USED FOR BOTH REUSE AND RECYCLE, THUS BECOMING ANOTHER IMPORTANT REASON TO CHOOSE STEEL IN DESIGN. AND IT TAKES INTO ACCOUNT MANY FACTORS, BOTH ENVIRONMENTAL AND ENVIRONMENTAL FACTORS, TO ENCOURAGE A BUILDING OR ARCHITECTURE TO BE ABLE TO TAKE THESE MATTERS INTO ACCOUNT AND LET THIS WORK REPRESENT THEM.

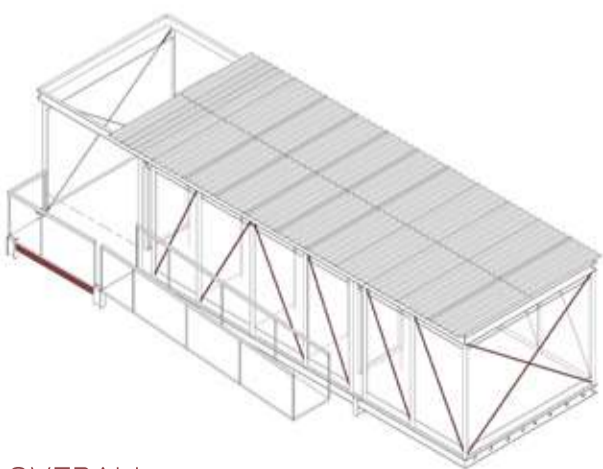
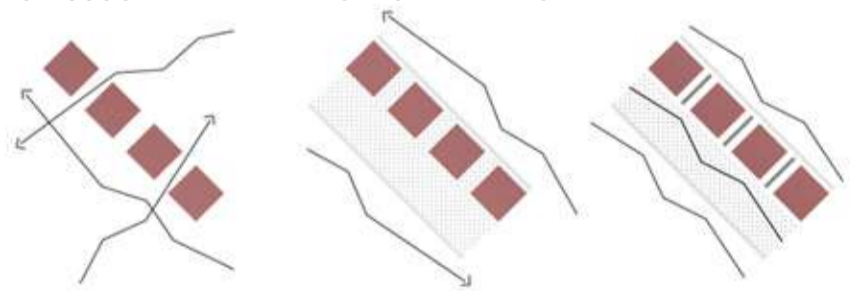

OVERALL

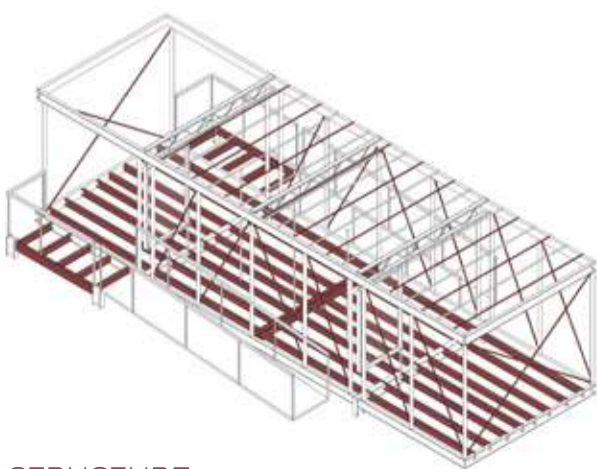

STRUCTURE

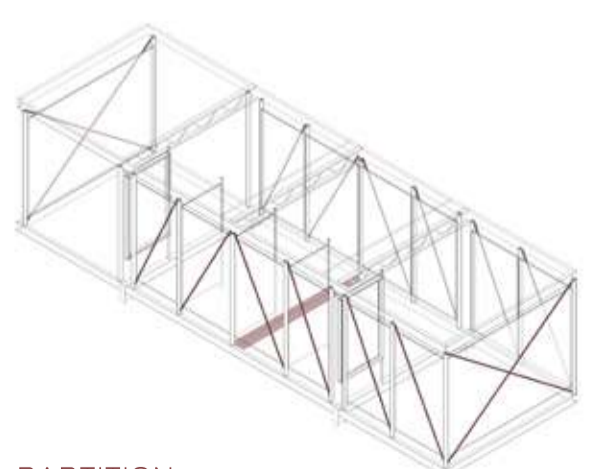

PARTITION

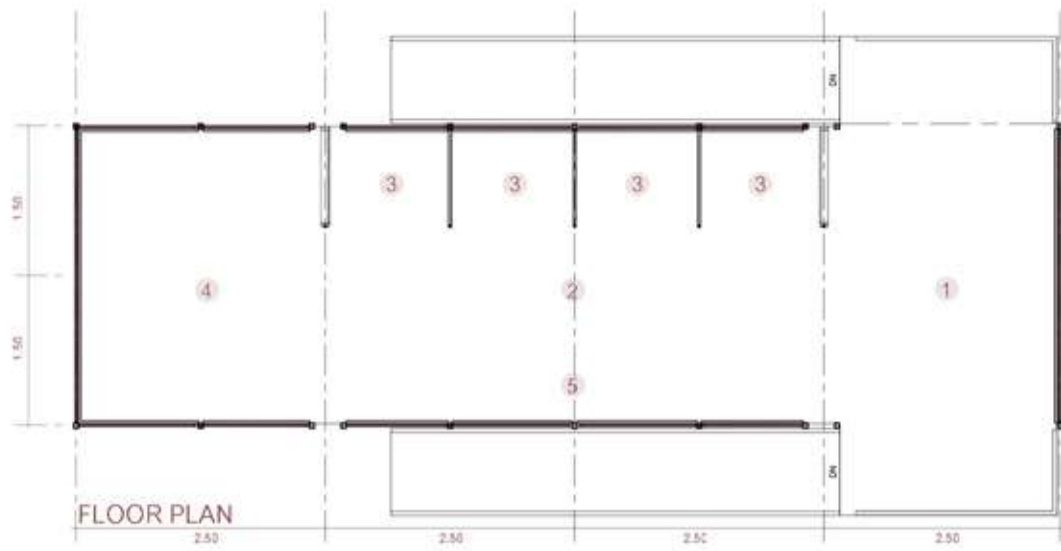

- PROGRAM
 (1) ENTRANCE, SKYLIGHT
 (2) CIRCULATION
 (3) SINGLE
 (4) GROUP
 (5) OPEN PLANE

THE DESIGNER SEES THIS BUS STOP AS A DESIGN WORK THAT SHOULDN'T BE TOO UNIQUE, BUT THOSE IDENTITIES OR IDENTITIES DEPEND ON THE PEOPLE WITHIN THE COMMUNITY WHO WILL DETERMINE WHAT THIS WORK LOOKS LIKE. FOR EXAMPLE, THERE WILL BE LABELS OR ARTWORK TO MAKE EACH ONE DIFFERENT. IT IS ALSO A PLACE FOR THE EXPRESSION OF PEOPLE IN THE COMMUNITY WHO HAVE A STORY TO BE PRESENTED TO THE SOCIETY. NO MATTER WHAT THE FINAL LOOK IS, THE DESIGNERS CONSIDER IT IMPORTANT TO GIVE US A GLIMPSE OF WHERE THOSE COMMUNITIES ARE GOING.

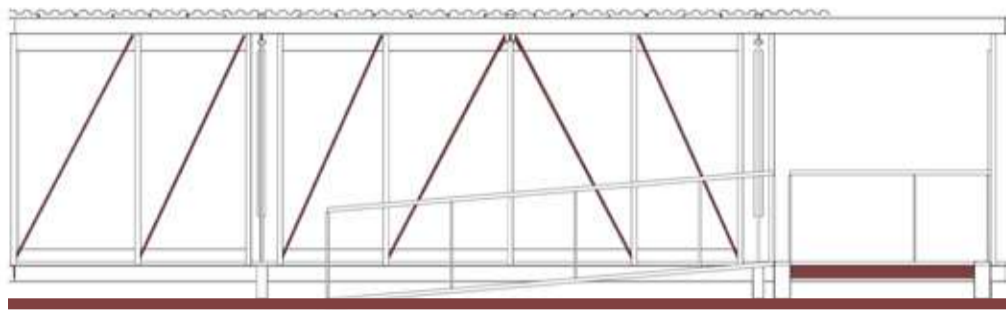

ELEVATION A

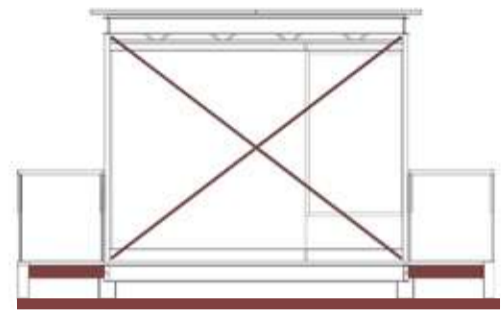

ELEVATION B

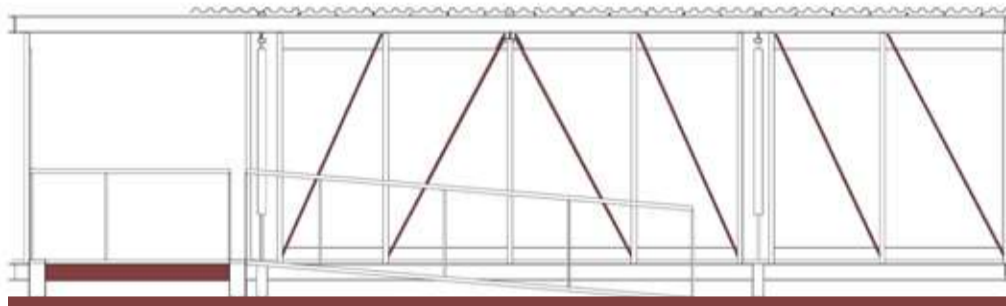

ELEVATION C



ELEVATION D

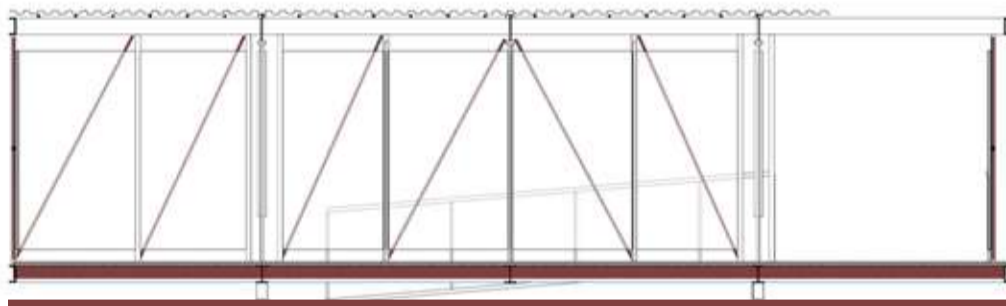

SECTION A

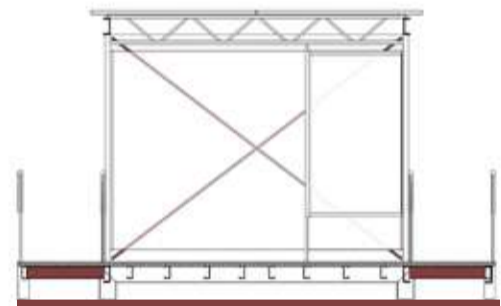

SECTION B

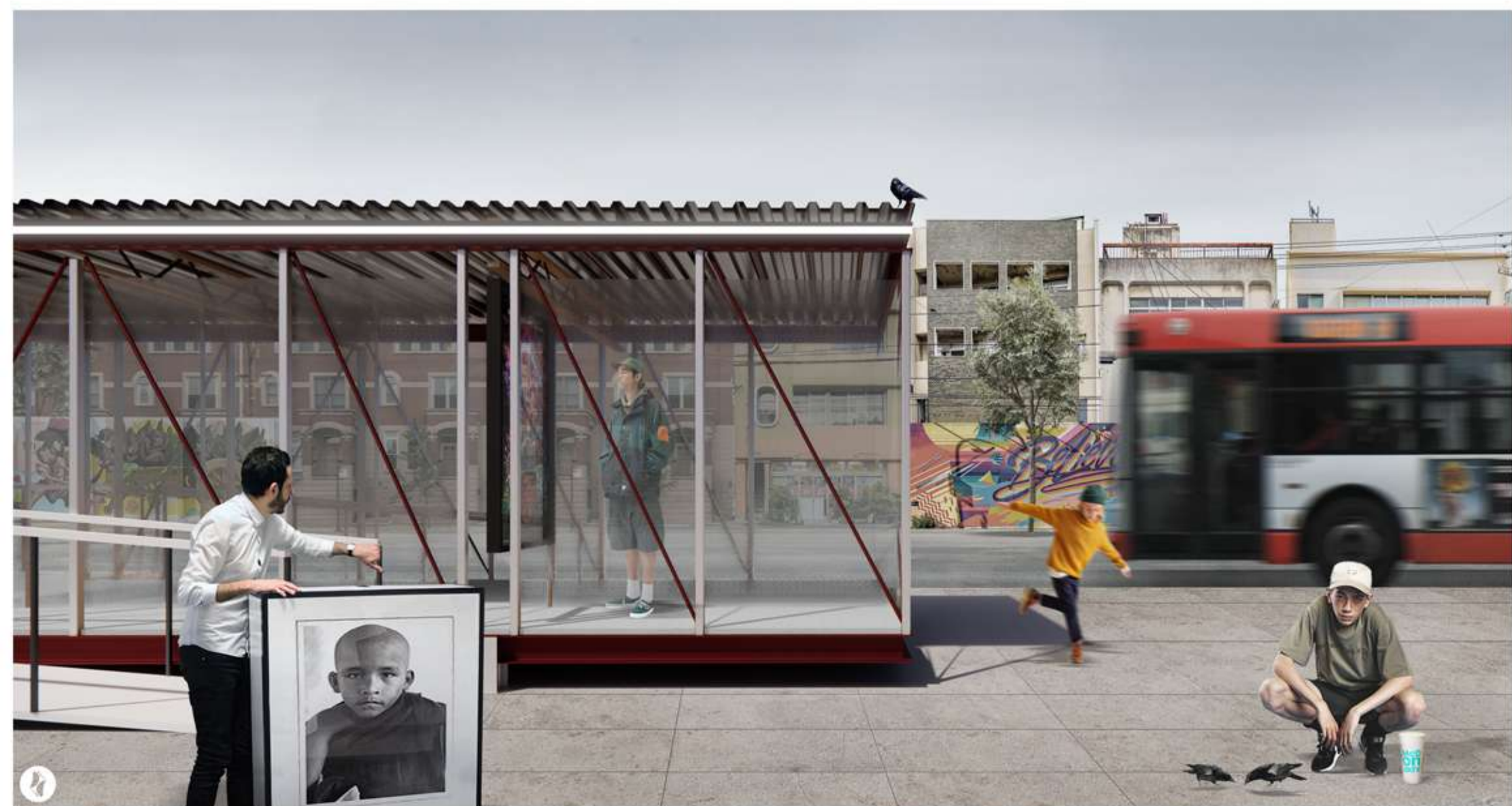

BOULDER LAND

YOUNG ARCHITECTS COMPETITIONS



PROJECT INSPIRATION CONCEPT



In the midst of a snow-covered valley, you and your companion travel to your destination. Suddenly, a blizzard and a gusting cold wind blew violently. To keep the warmth of the body you hide behind a large pile of rocks that will shield you and your friends, but wait for the storm to pass. Suddenly the sky opened up. The winter wind is lighter appeared as the northern lights in the midst of the clear sky is a sign of the passing of obstacles and being the light of the beginning of the journey

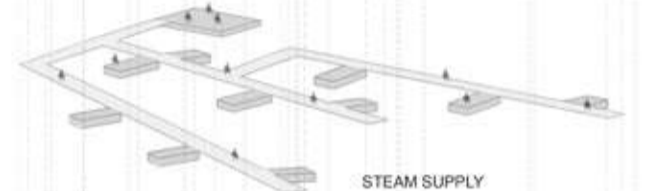
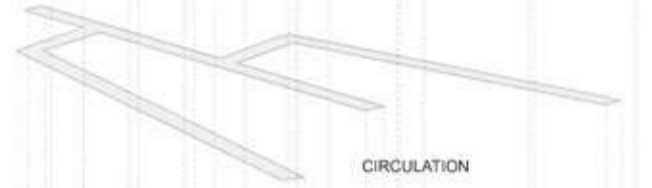
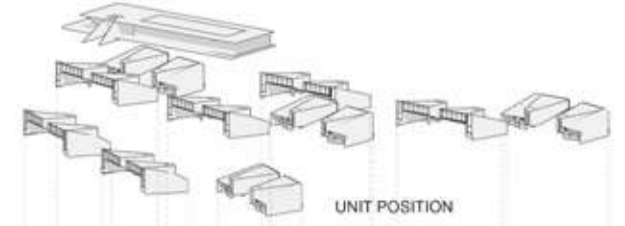

DEVELOPMENT IDEA

The building's layout opens up different perspectives to allow residents to experience a variety of feelings in a limited space and consistent with their activities within the residence.

The bedroom opens up to panoramic, panoramic and high views to overlook the distant pine trees and city views.

The living room opens up to a narrow and high view for a warm and important feeling for family guests.

Area under the bedroom Open to accommodate activities to see the Aurora with the family in privacy.

The selection of materials reflects the care when the user sees the building to feel that it is harmonious and part of the environment, such as the choice of brutalist architecture material in the design.

Overall, the building caters to contextual awareness and a special living experience. In order to impress the users who have used the building perfectly.

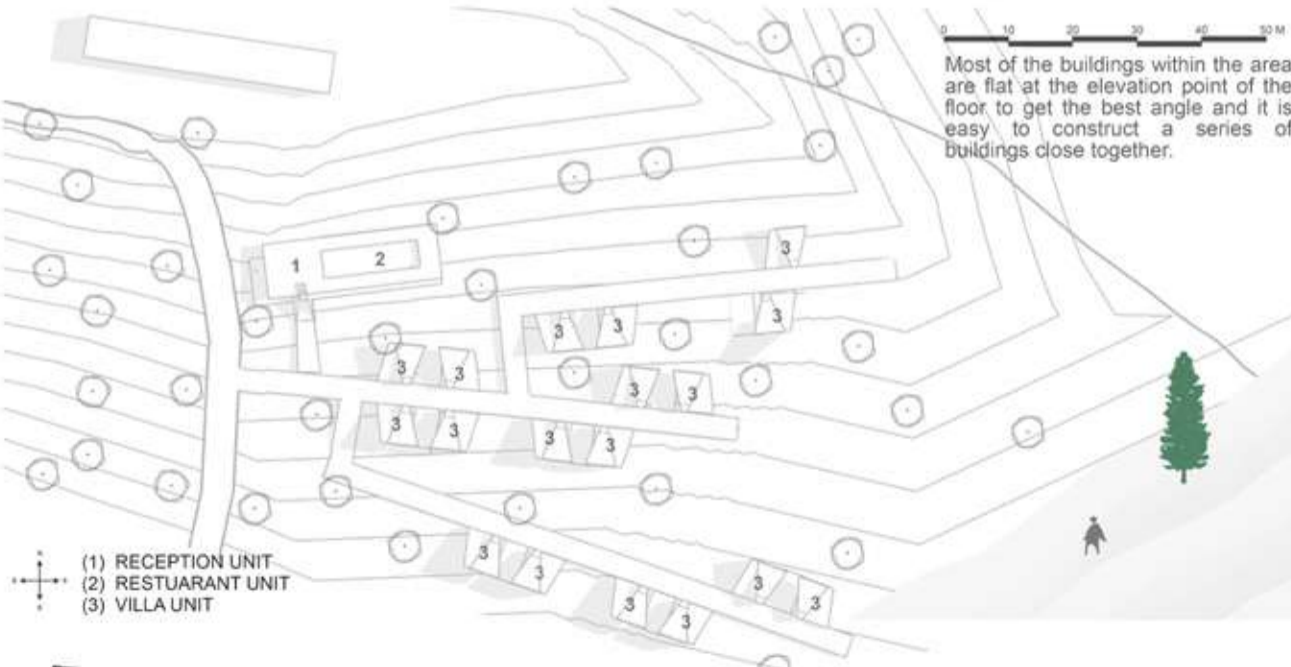
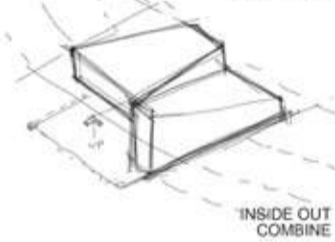
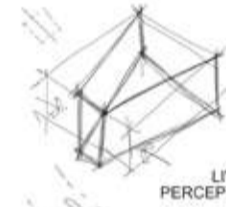
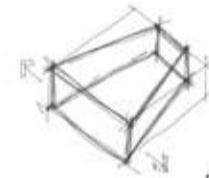

The placement of buildings pays attention to the perspective of each building, provided that the buildings must not obscure each other's visibility.

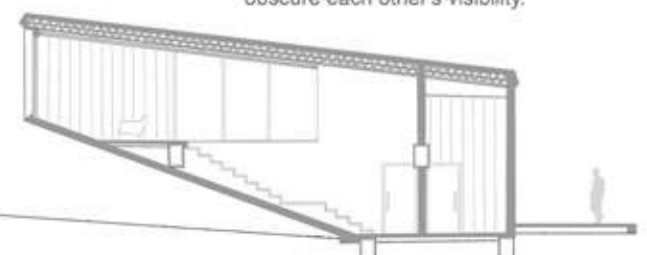
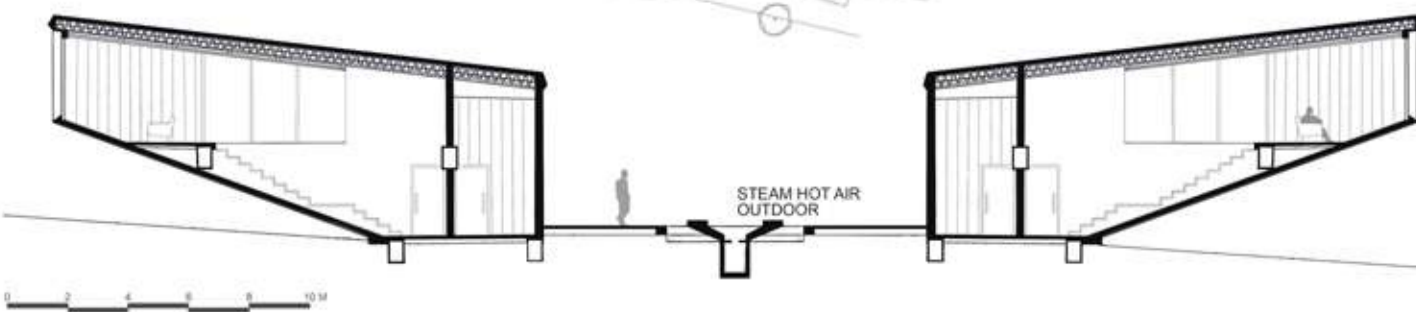

Pocket garden design. / Walailak University.
Sufferer shelter. / Galaxy, far far away.
Missing hill. / Janglone Mountain, Nakhon si Thammarat.
Childhood study base. / Backyard.

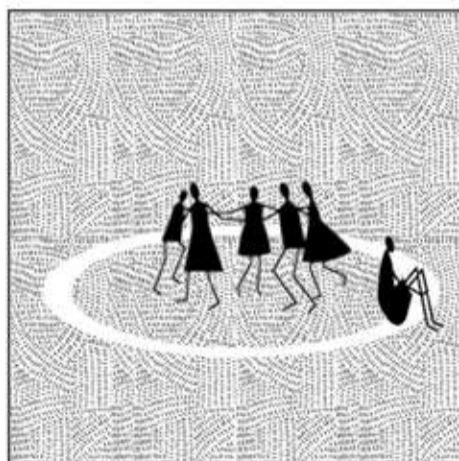
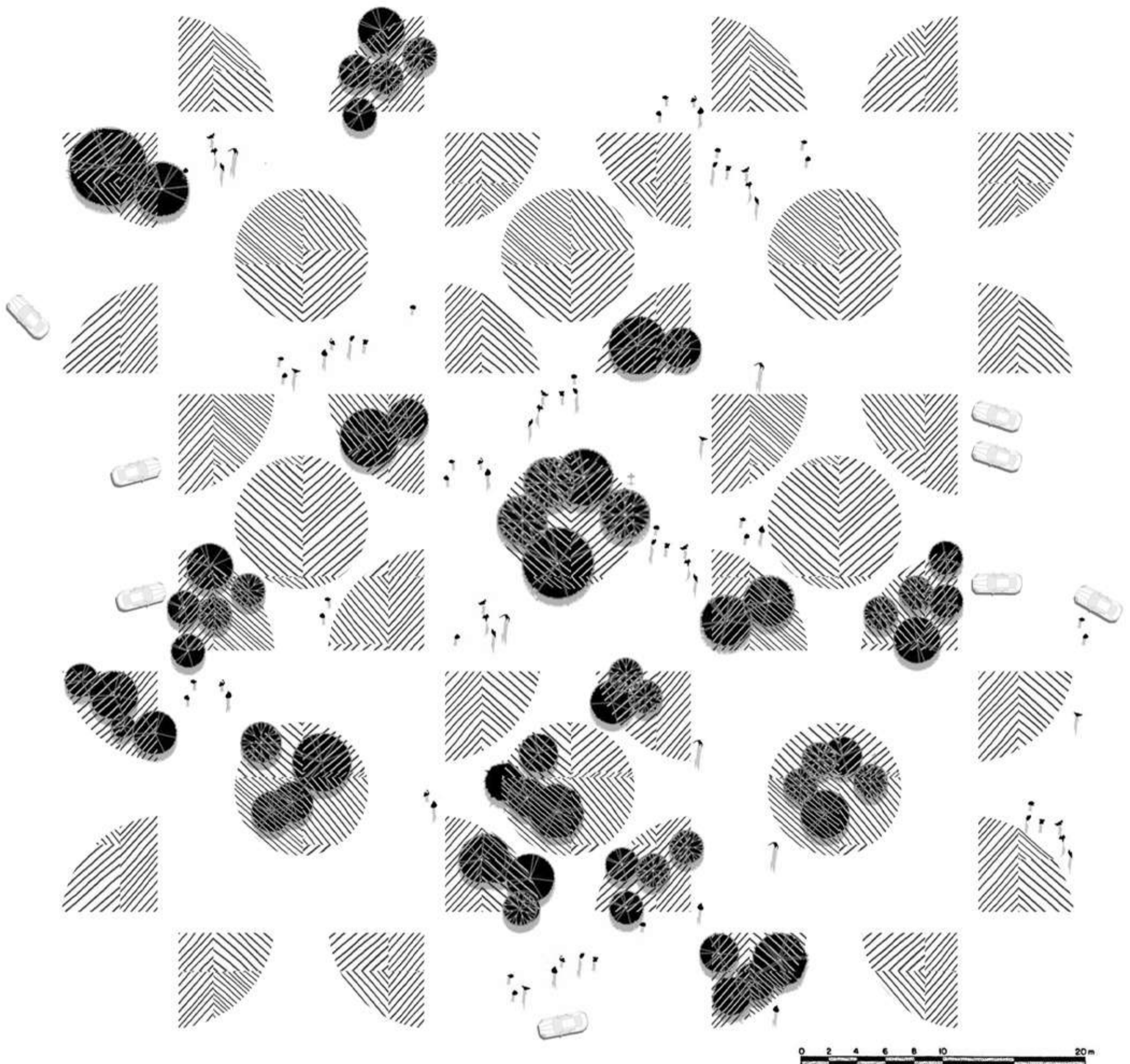

IN A SITUATION WHERE PEOPLE AVOID GROUPING WITH OTHERS IF IT IS NECESSARY TO GO WITH A GROUP OF PEOPLE, THE BEHAVIOR OF PEOPLE WILL COME OUT ON THE EDGE OF THE GROUP, GENERALLY STANDING AT A DISTANCE, TRYING NOT TO PARTICIPATE AS MUCH AS THEY SHOULD.



THE EDGE OF SPACE WILL BE A PLACE FOR THE NEXT GENERATION OF SOCIETIES, BECAUSE JOINING THE MASSES IS PUTTING THEMSELVES AT RISK RATHER THAN PARTICIPATION, INCREASING SOCIAL DISTANCE.



THE DESIGN AVOIDS DIRECT PENETRATION INTO THE AREA AND TAKES UP MOST OF THE EDGE AREA FOR THE PEOPLE TO USE IT. AND THE CENTER AREA WILL BE THE STAGE CLEAR AREA FOR PEOPLE WHO HAVE ACTIVITIES THAT REQUIRE A WIDE AREA TO BE USED BY OTHER USERS LOOKING FROM THE EDGE OF THE AREA.

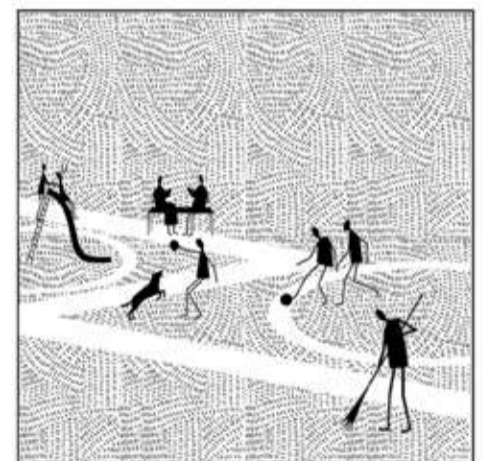

THEREFORE, THE KEY AREA IS THAT ALL EDGES AND EDGES ARE INTERCONNECTED TO TRANSFER PEOPLE TO ANOTHER AREA AND THE PATHS BETWEEN THEM WILL SHOW AREAS AND ACTIVITIES, AND THE ROUTE NEEDS MORE OPTIONS THAN JUST ONE WAY. LET PEOPLE NOT GET TOO CLOSE TO EACH OTHER.

STARBOY SUFFERER SHELTER

STARBOY SUFFERER SHELTER

THE WAR BETWEEN THE NEW REPUBLIC AND THE FIRST ORDER LEADS TO THE EVENTS OF THE FIRST ORDER USING THE STAR KILLER TO DESTROY THE REPUBLIC'S CAPITAL AND FLEETS. CAUSING MANY PLANETS TO BE DESTROYED THIS CAUSED MANY RESIDENTS OF THE CITY TO LOSE THEIR HOMES IN LARGE NUMBERS, CAUSING THE GROUP TO BECOME VICTIMS OF THE DISASTER. WHO WANT TO FIND A NEW PLANET TO LIVE IN

AN INDISPENSABLE NECESSITY IS TEMPORARY ACCOMMODATION, SO THIS PROJECT IS DESIGNED TO DESIGN TEMPORARY SHELTERS FOR VICTIMS WHO NEED TEMPORARY ACCOMMODATION TO LIVE DURING THE TREMORS.

THE PAVILION FOR THE VICTIMS OF THE DISASTER WAS REMOVED WITH A THOUGHT THAT WAS REMOVED FROM THE SPACECRAFT TRAVEL AT LOW SPEED. DESIGN EACH PIECE AS THE LAST MODULE WHICH IN ONE MODULE CONTAINS IRON AND CANVAS THE TASK IS TO PULL THE CANVAS FROM THE IRON AND ASSEMBLE A LARGER UNIT. WITH THE TECHNIQUE OF PULLING AND THE DETAILS AT THE JOINTS MAKE IT POSSIBLE TO QUICKLY SPREAD AND STORE THE PAVILION READY FOR DISASTER AND CAN SAVE THE LIVES OF THE VICTIMS QUICKLY.

MOREOVER, THE SPACE RESULTING FROM THE COMBINATION OF EACH UNIT IS HIGHLY FLEXIBLE. THIS MAKES IT POSSIBLE TO CREATE A WIDE RANGE OF SPACES AND APPLICATIONS WITHIN THE ARCHITECTURE.

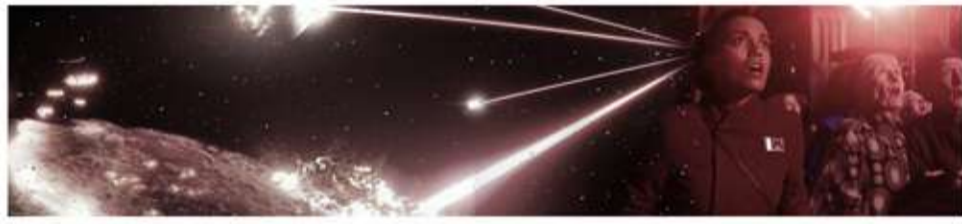
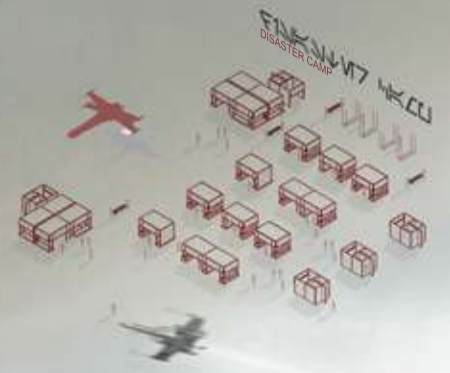

THE WAR BETWEEN THE NEW REPUBLIC AND THE FIRST ORDER LEADS TO THE EVENTS OF THE FIRST ORDER USING THE STAR KILLER TO DESTROY THE REPUBLIC'S CAPITAL AND FLEETS. CAUSING MANY PLANETS TO BE DESTROYED THIS CAUSED MANY RESIDENTS OF THE CITY TO LOSE THEIR HOMES IN LARGE NUMBERS, CAUSING THE GROUP TO BECOME VICTIMS OF THE DISASTER. WHO WANT TO FIND A NEW PLANET TO LIVE IN

AN INDISPENSABLE NECESSITY IS TEMPORARY ACCOMMODATION, SO THIS PROJECT IS DESIGNED TO DESIGN TEMPORARY SHELTERS FOR VICTIMS WHO NEED TEMPORARY ACCOMMODATION TO LIVE DURING THE TREMORS.

THE PAVILION FOR THE VICTIMS OF THE DISASTER WAS REMOVED WITH A THOUGHT THAT WAS REMOVED FROM THE SPACECRAFT TRAVEL AT LOW SPEED. DESIGN EACH PIECE AS THE LAST MODULE WHICH IN ONE MODULE CONTAINS IRON AND CANVAS THE TASK IS TO PULL THE CANVAS FROM THE IRON AND ASSEMBLE A LARGER UNIT. WITH THE TECHNIQUE OF PULLING AND THE DETAILS AT THE JOINTS MAKE IT POSSIBLE TO QUICKLY SPREAD AND STORE THE PAVILION READY FOR DISASTER AND CAN SAVE THE LIVES OF THE VICTIMS QUICKLY.

MOREOVER, THE SPACE RESULTING FROM THE COMBINATION OF EACH UNIT IS HIGHLY FLEXIBLE. THIS MAKES IT POSSIBLE TO CREATE A WIDE RANGE OF SPACES AND APPLICATIONS WITHIN THE ARCHITECTURE.



SHelterFUNCTION

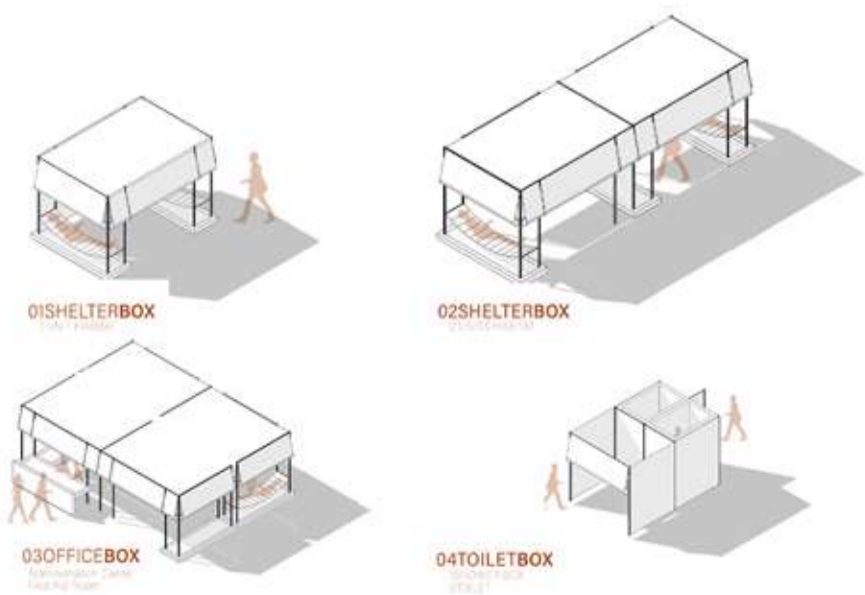

PACKAGE

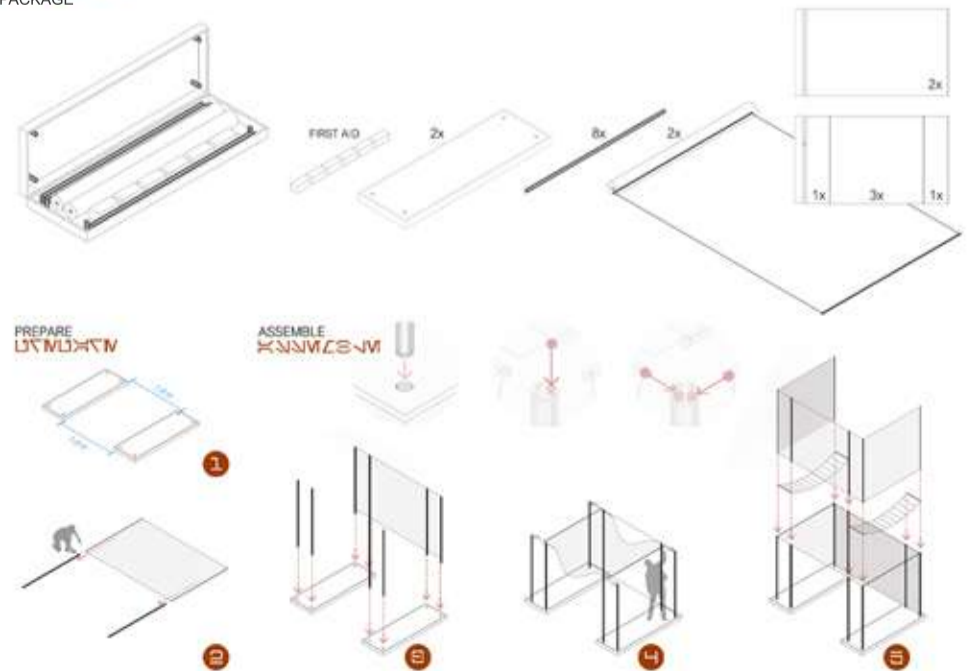

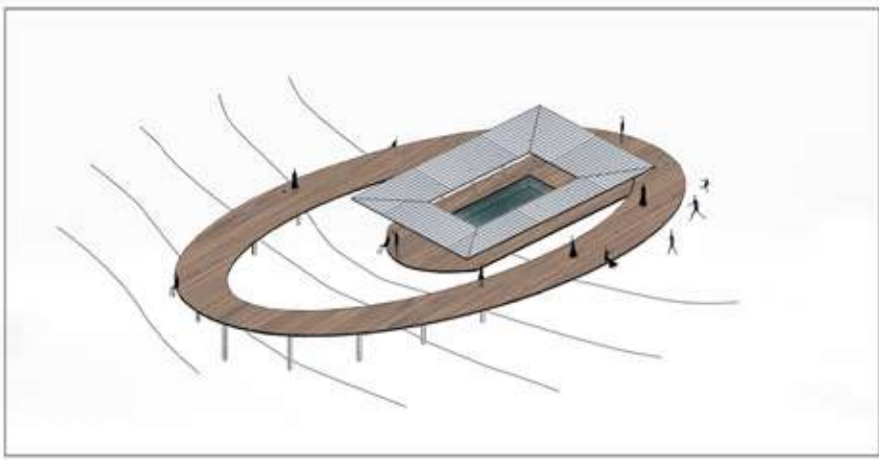

MISSING HILL / JANGLONE MOUNTAIN

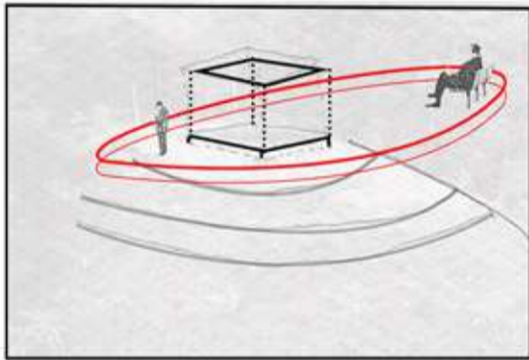
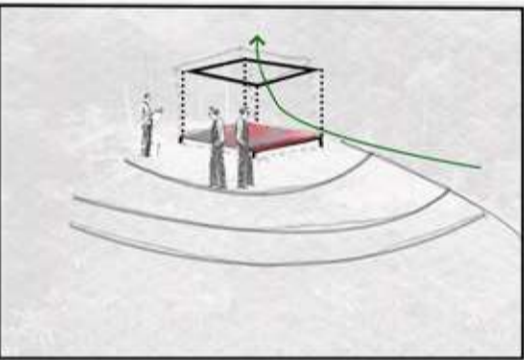

DESIGN CONCEPT

It starts from a hill with a pond reflecting the sky. by the concept of designing By studying the context and drawing a slope line Then select a slope line, pull it up and turn it around. To become a viewpoint by choosing materials that can be found in the area. and can be easily constructed such as wood, bamboo, zinc Designed to have a small contact area with the soil and change the shape of the building. and wooden floors except grooves make water and sunlight make Plants or living things below can live the same way as before.

The building was designed for Wind and sunlight can reach all parts of the building in order to reduce the use of electricity. In addition, the roof is angled towards the pool. to collect rainwater In the original well that already exists In addition, the construction process and materials can be found in general, using simple techniques in construction. Can also be built Local construction materials and techniques Maintenance or adjustments are easy to implement and fit perfectly into the context.



PLAN

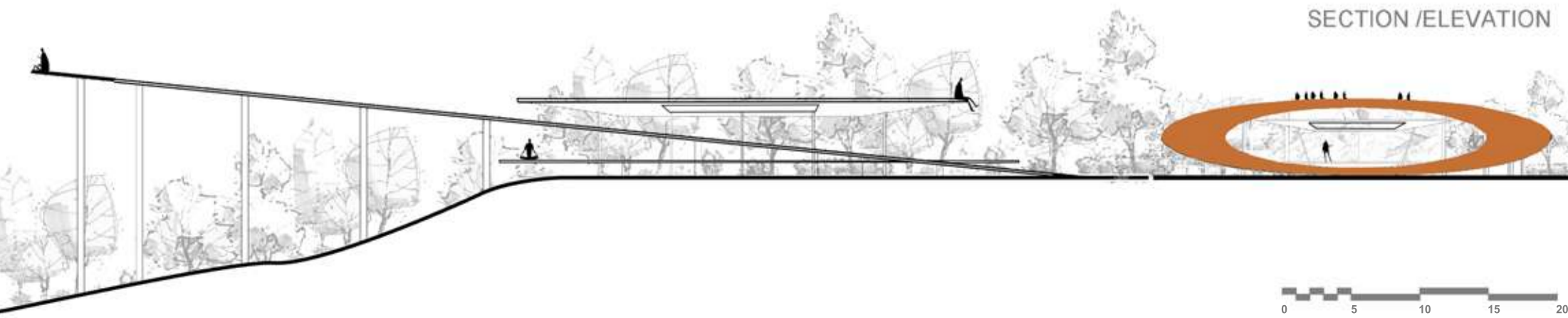

SECTION /ELEVATION

CHILDHOOD STUDY BASE



INSPIRATION

The project was inspired by the designer's childhood story. At that time, having a secret base was fun and exciting, like being in another world. To invite friends and show them the secret base is cool for a child of that age. And on days of family trouble, having a place to hide makes a child feel safe in his own space.

IDEA CONCEPT

Therefore, it has become a design idea that, in the future, **studying and working at home is a safer and less risky** way to go to school. It would be interesting to have a secret school base in your home. And try to imagine the secret base that we have been using since childhood until we became teenagers. We would have had a very memorable childhood experience.

DESIGN SOLUTION

The backyard is probably a play area outside of the house for many children, so it's a perfect location for our secret base. And the fenced area is like a border and a good location for us. We design it as a hideout base and take the time to add to the imagination as much as we want. However, the decorations and the color choices will change as we grow up.

FUTURE EDUCATION

In the future, schools may not be used as educational spaces in the old ways. Schools would be reduced roles, so it wouldn't come as a surprise that families would invest in creating learning spaces for their children within the boundaries of their homes. Separating the home area from the study area for children encourages children to adjust well and understand how to use the space at home and the learning area so children can reduce confusion and stress.

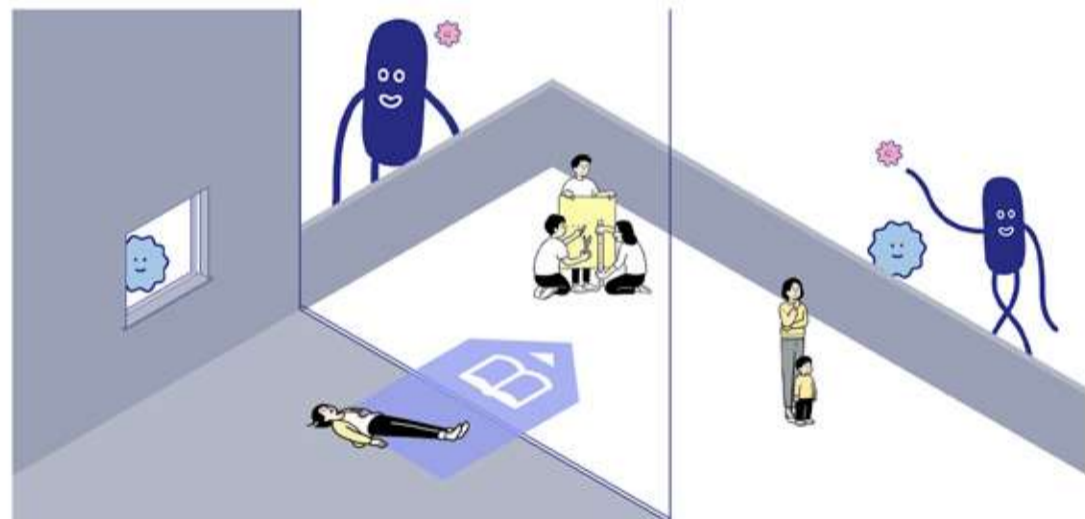

POSSIBILITY

Home education can be done from kindergarten to high school, and some colleges are already able to support homeschooling. Some families let their children study in this way because they can control the quality and environment. In the design concept, the school will be the center of group activities, such as sports, meetings, and lessons at home.

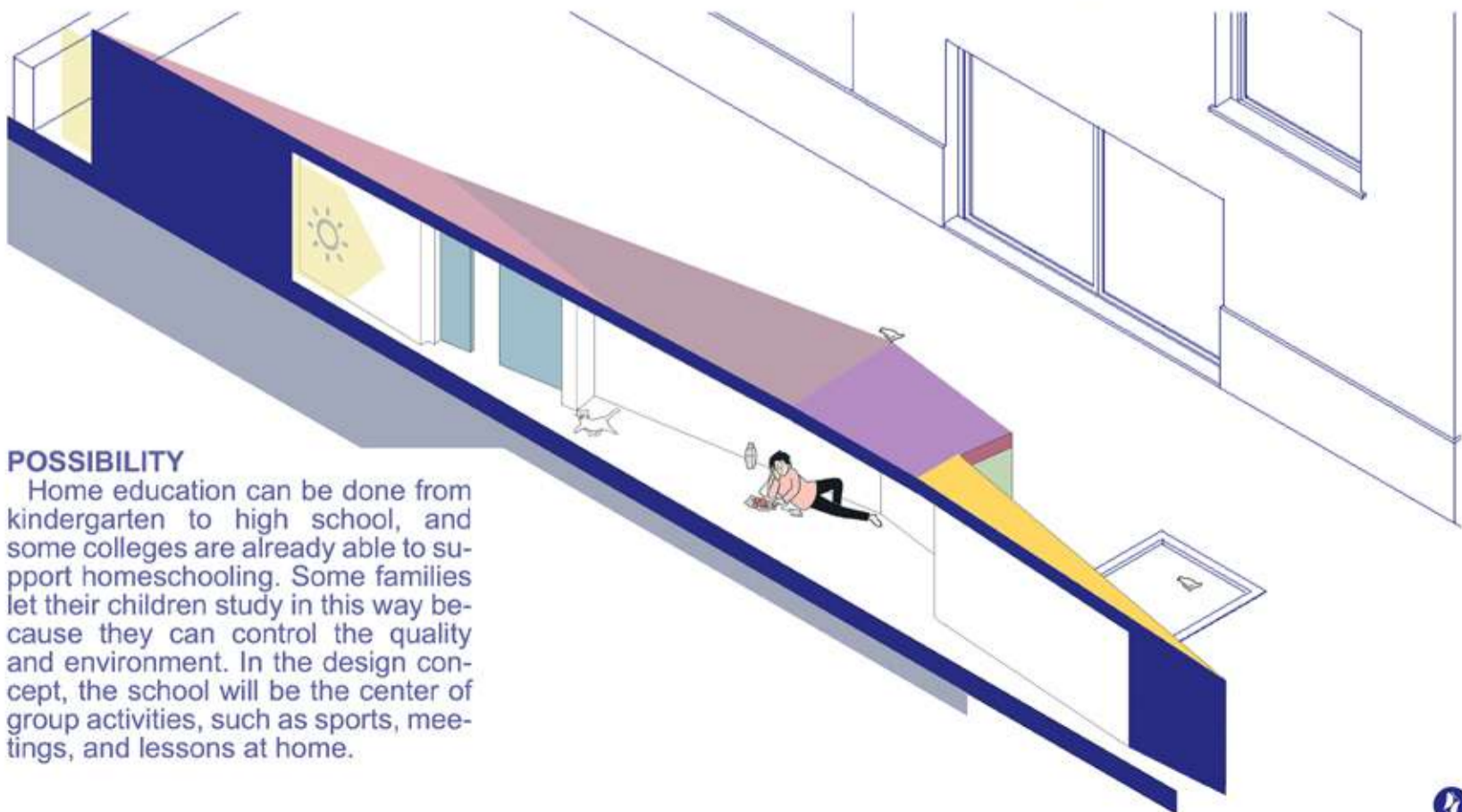

PASUN PATHAN/THAILAND
+66 91 8241438
pasun.design@gmail.com

CONTACT