

Frank Lee

李一锋

Portfolio

2016-2020

FRANK LEE

Part 2 Architectural Assistant

DETAILS

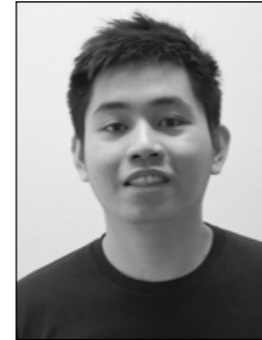

franklee.arch@gmail.com

MY: +60197908613

Nationality : Malaysian
Date of Birth : 18-05-1994

SKILLS

Proficient in: Basic in:

Rhinoceros	Unreal Engine
Sketchup	Grasshopper
Lumion	Processing
Autocad	Vray
Photoshop	Revit
Lightroom	3ds Max
PremierPro	
Indesign	
MSoffice	

LANGUAGE

English
Mandarin
Malay

REFERENCES

Available upon request

EDUCATION

2018-2020 (MArch)

University of Kent

Master of Architecture

2013-2016 (BSc. (Arch))

Taylor's University

Bachelor of Science (Honours) in Architecture

2012-2013

Limkokwing's University

Foundation in Built Environment

PROFILE

Architecture had become part of my daily dose of medicine to fulfilled my inner enthusiasm in architecture. I always seeking for more opportunity to learn and try different things that could provide me in understanding in architecture. I realized that caring could be my unique characteristic that provide me to think of how architecture could affect the humanity and environmental.

Who? Why? What? How?

Those words is always appeared in my mind everyday since i believe it would be very important to have self critical thinking to achieve something that you had never think and ask for.

FUTURE I AM READY.
FRANK LEE,

EXPERIENCES

2016 Sept-2017Oct

OV Arch Lab

Part I Asistant Architect

OV Arch Lab is a small-scale architectural practice, focusing on local project. I was involved in a range of projects such as high-rise service apartment, landed housing, renovation projects and competition. I was mostly handling projects from schematic design to authority submissions.

2016 Sept-Oct

Committee Member

Rumah' 16, architectural graduate exhibition

I was the key member in design and construction team of the exhibition. I played substantial role by being a team player and collaborated well with others to ensure the amazing delivery of our design before the deadline.

2016 Jan-Mar

DC Architect

Intern

As an intern during my academic year internship programme, i had taken part in preliminary conceptual design in designing landed housing and had also involved in a few client meeting with my seniors.

CONTENT

M.Arch

- 01** *The Pavilion of "Shift"*
 - 02** *The Twist of The Galaxy*
 - 03** *Holloway Road Performing Art Centre*
 - 04** *Riverside Country Park Geologist Retreat House*
-

Competition

- 05** *The Spirit of Amber: The KABIN*
-

Practices

06

M.Arch

Master in Architecture

2018-2020

01

THE PAVILION OF 'SHIFT'

This pavilion is another experiment of how digital configuration could create interesting pavilion for the public in a park. In this pavilion, you would be able to choose between private and public spaces, whereas the core of the pavilion is able to become a playground with different hierarchy of levels. In short, it is one pavilion with multiple ways of interacting which is fit for different human needs.

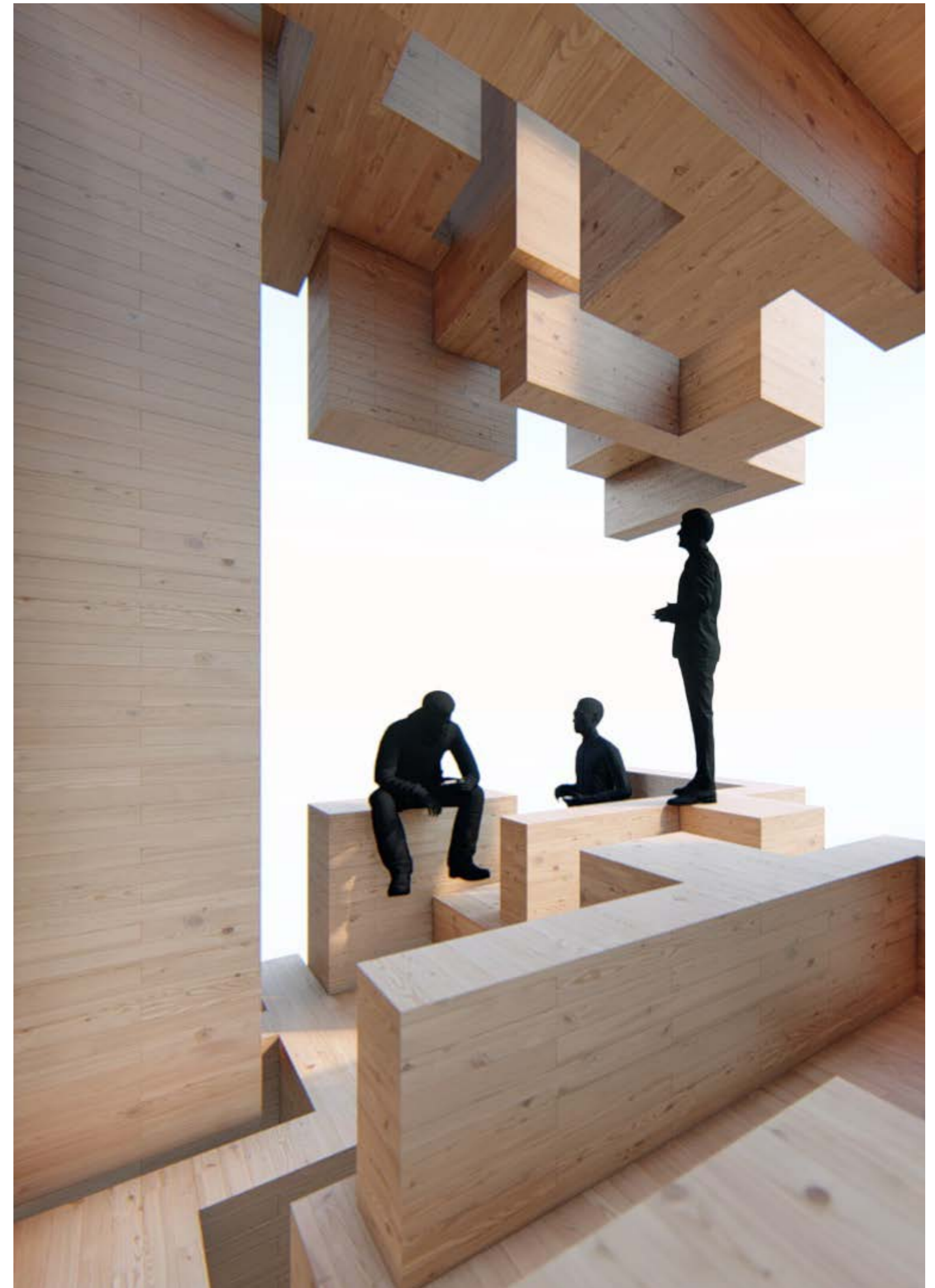
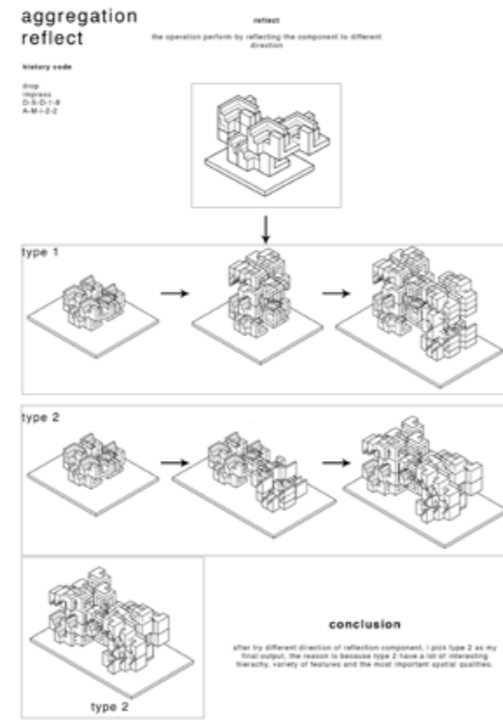

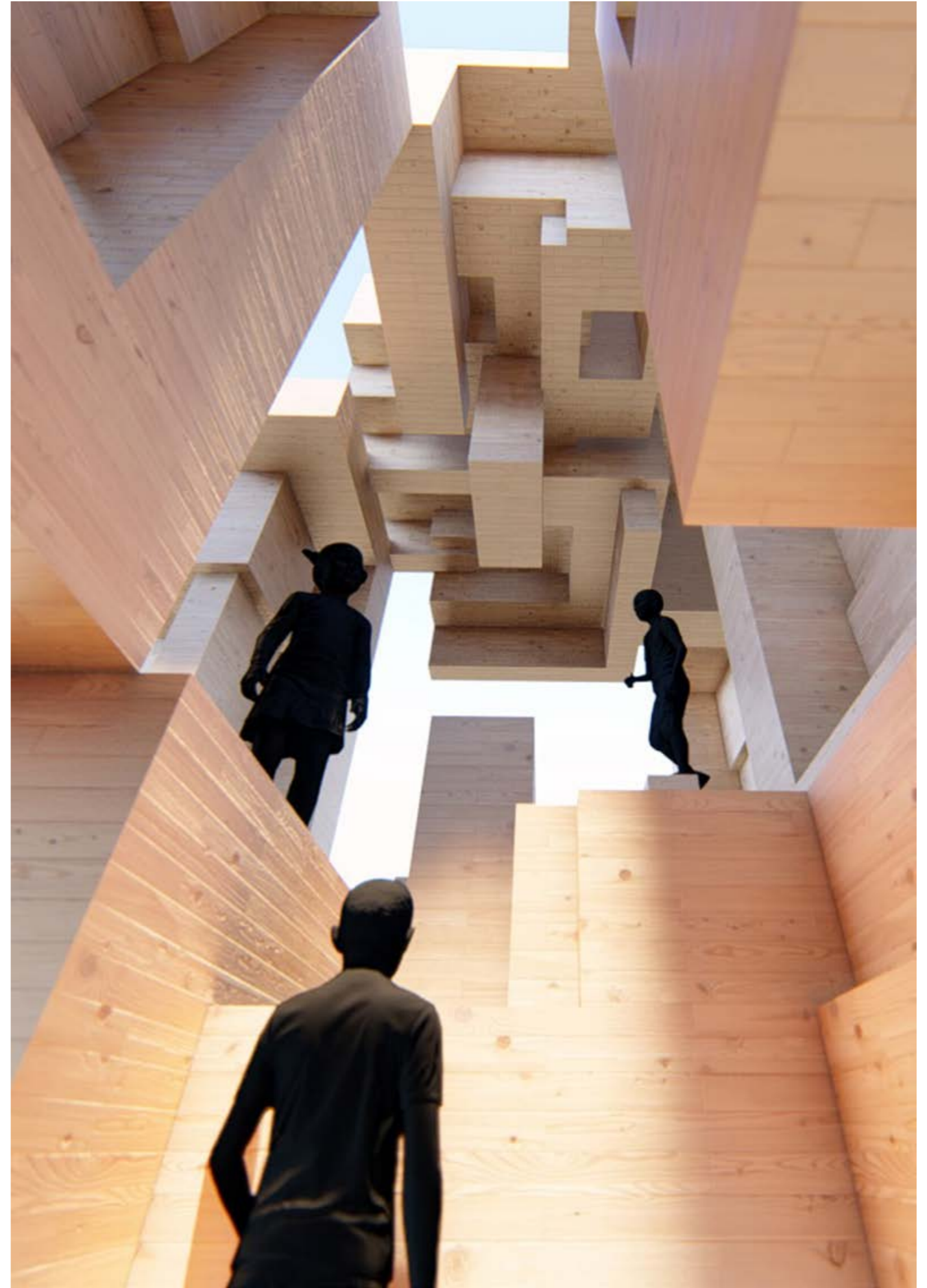



02

THE TWIST OF THE GALAXY

This project is an experimental and theoretical project. When you are living in the galaxy, you need different ways of exploring spaces. In order to create interesting and unimaginable spaces, digital means are the best way to explore possibilities of space in architecture. The experiment of this task starts with a few basic primitives that will aggregate during the process. For example, a chef will put different ingredients into a pot and each ingredient would produce different outcome. Whereas in this project, software like rhinoceros and grasshopper is the pot and the ingredient including primitives and verbs.

Note: This is an early exploration which does not have a conclusive and resolved architecture. The same methods are applied in the later works in the portfolio which produce resolved architecture.

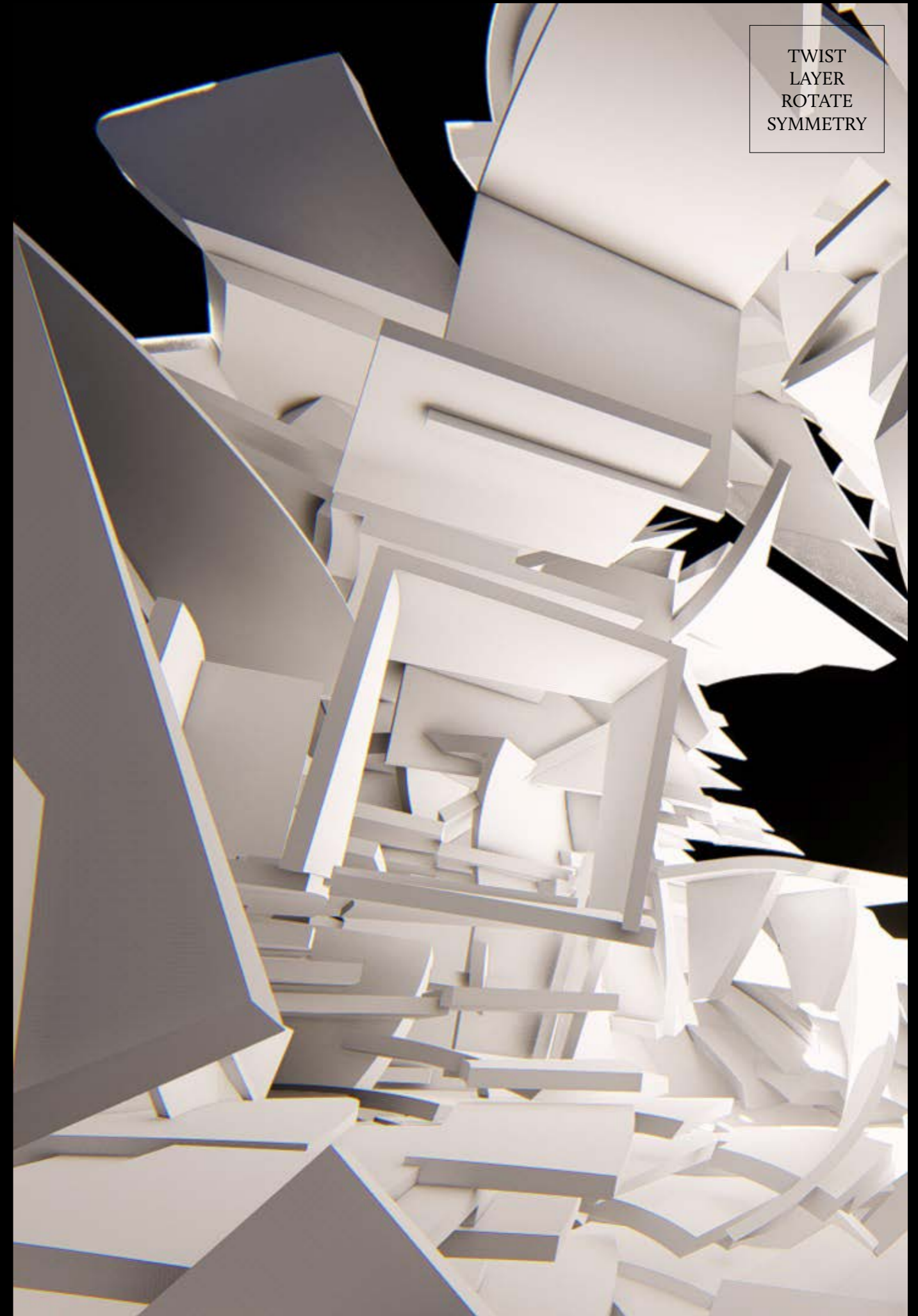
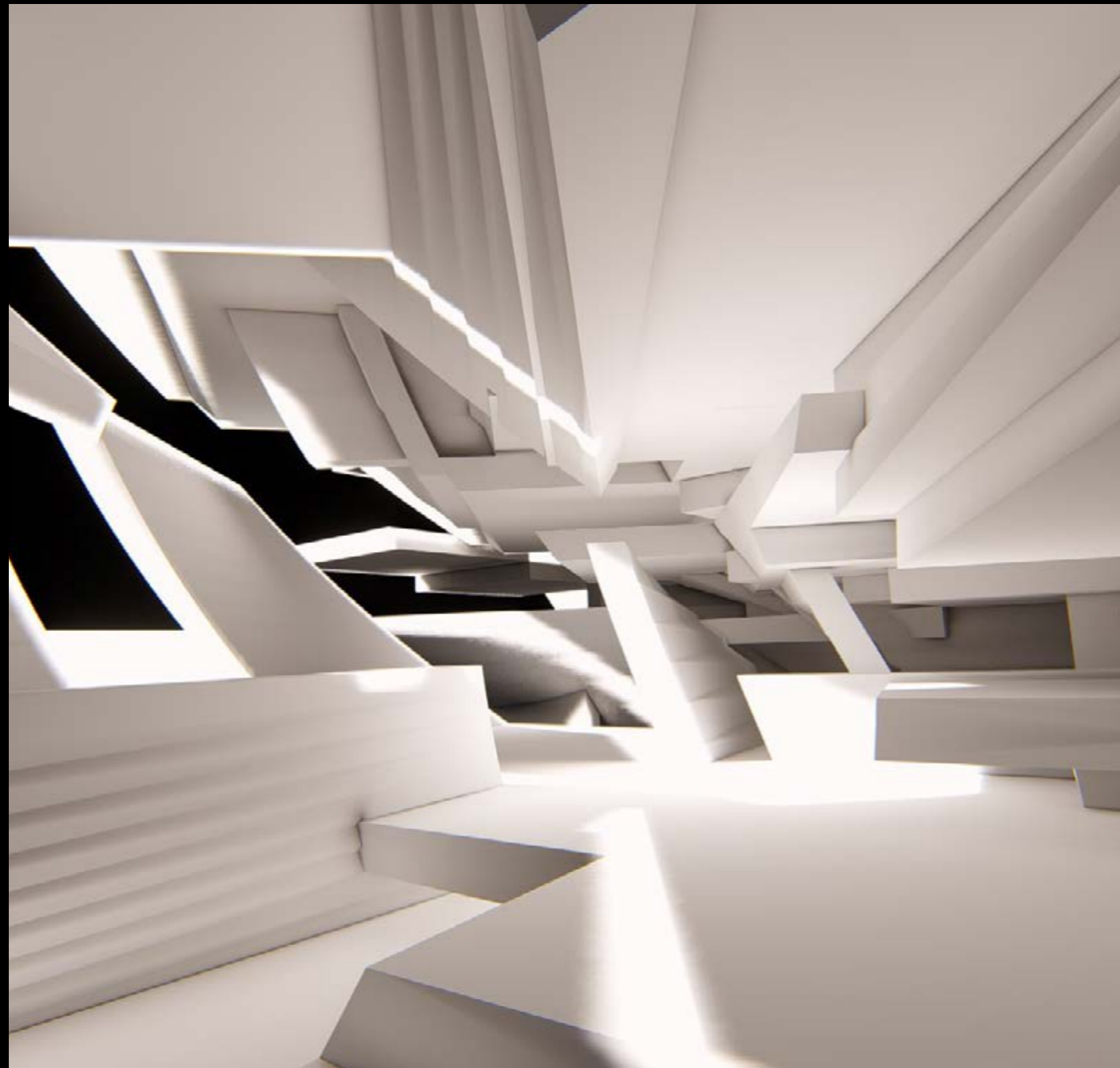

TWIST
LAYER
ROTATE
SYMMETRY

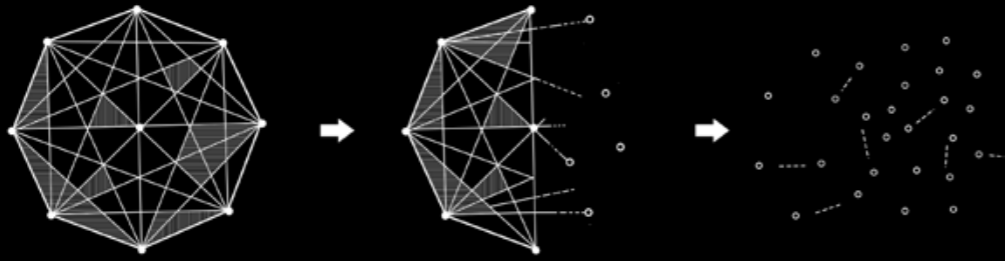

ENTROPY

Low - Medium - High

When entropy is high, often interpreted as the degree of disorder or randomness in the system.



- Low Entropy - Original state



- Medium Entropy - Shape Disorder



- High Entropy - Disappear

SECOND LAW OF THERMODYNAMICS

In thermodynamics, a parameter representing the state of disorder of a system at the atomic, ionic, or molecular level; the greater the disorder the higher the entropy.



- State 1 - Outside In

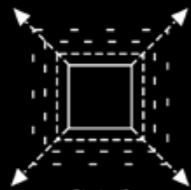

- State 2 - Inside Out

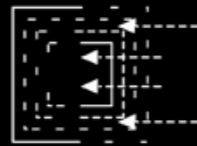

- State 3 - Right to Left

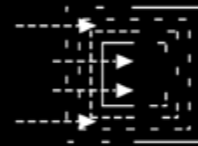

- State 4 - Left to Right

EXPERIMENT

(State 1) Heat transfer through outside environment to the inner core, and (State 2) heat transfer coming out from inner core to the outside environment ; (State 3) Heat transfer from right side to left side, and (State 4) heat transfer coming from left side to right side.

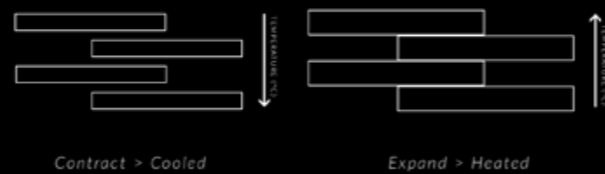

RULE OF ASSEMBLY

Thermal expansion and contraction through heat transfer. Materials expand or contract when subjected to changes in temperature.

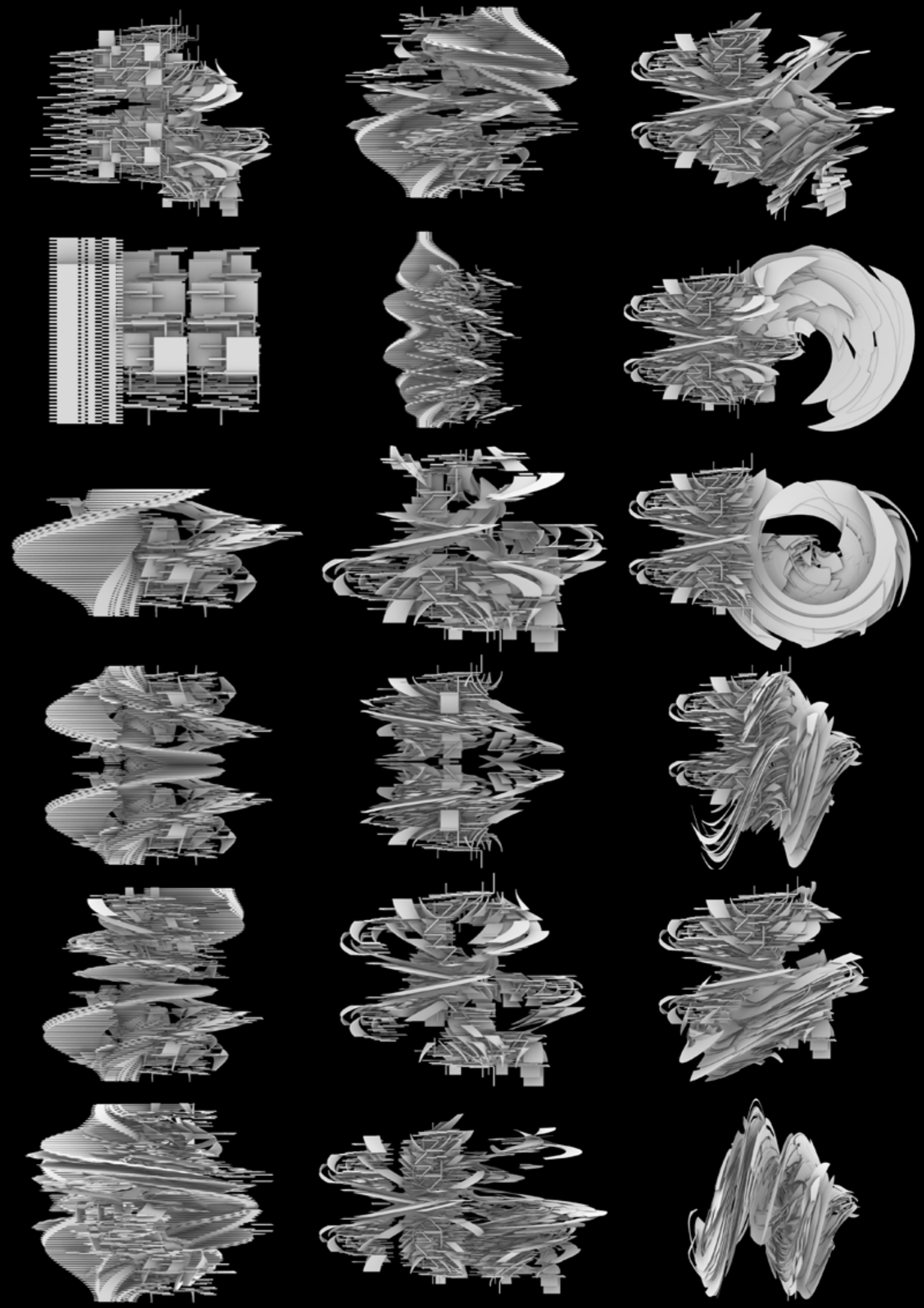

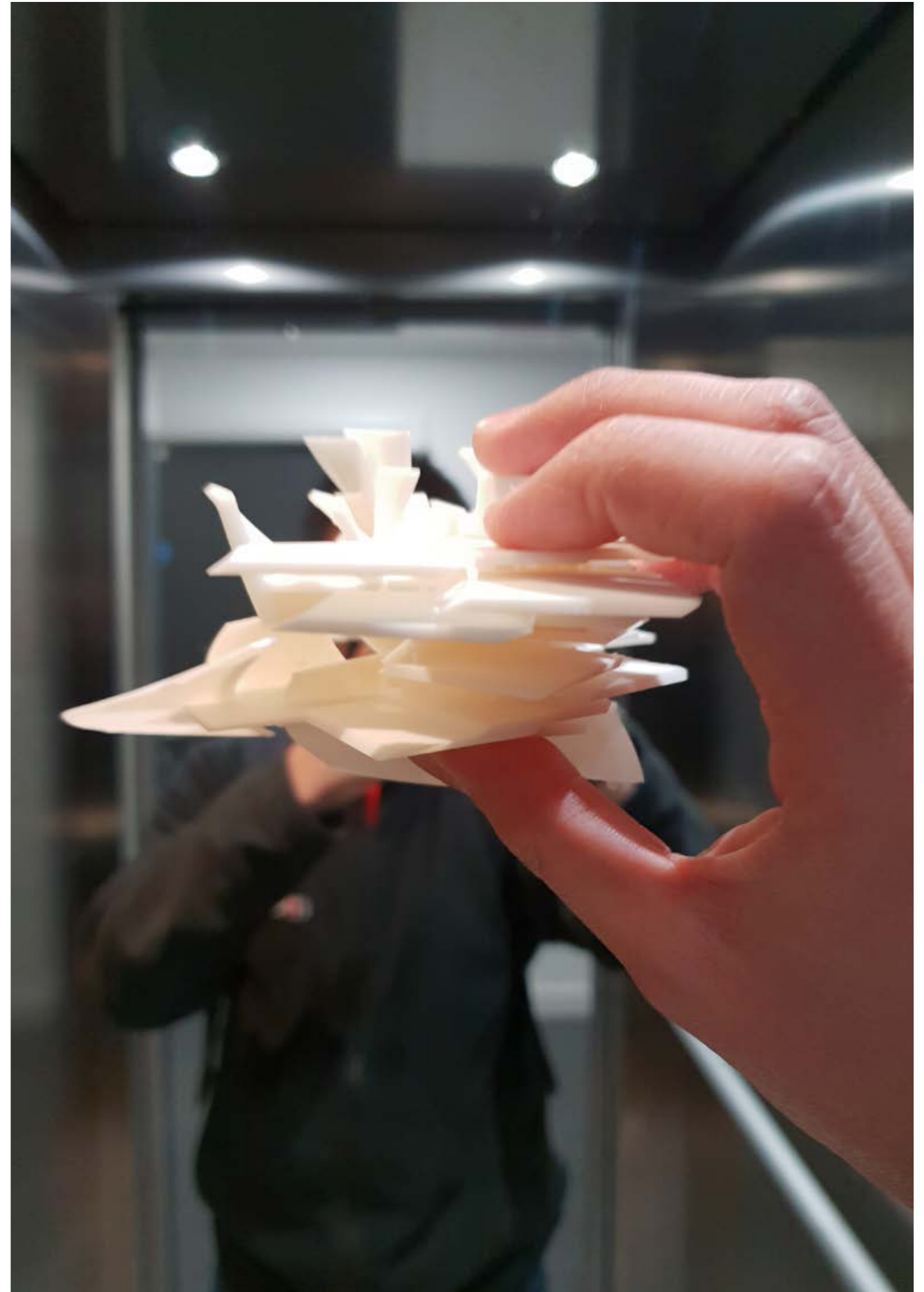

03

London Holloway Road Performing Art Centre

Holloway Road Performing Art Centre is an extension of National Youth Theatre. The concept of this project is to revitalize the existing cinema by separating the building into two and creating an in-between gathering space for public usage. Besides, it will also allow them to experience the history of the place through the new intervention.

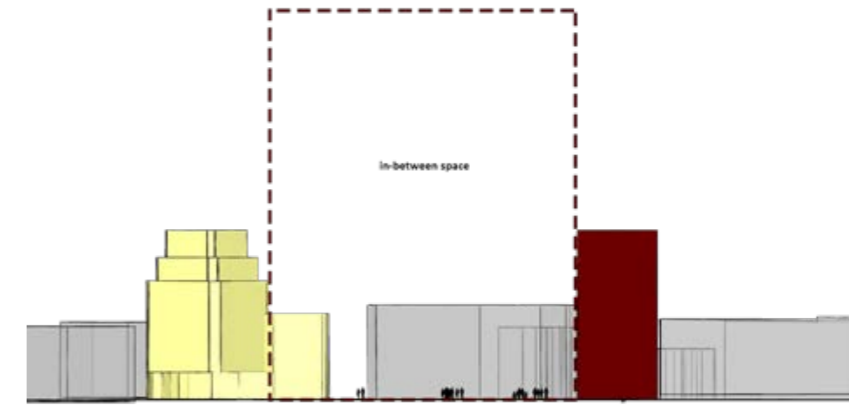



04

Riverside Country Park Geologist Retreat House

It is a retreat house designed for a geologist with gallery and public spaces. The idea for the house is to reflect the lifestyle of a geologist. The wall that grows between the gallery and public spaces is to create a division that detaches the user from the surrounding environment and appreciate the nature.



Experiencing the integration of

Artificial and Natural Environment

The forest is a beautiful nature. By forming spaces using solid and semi-transparent wire mesh wall, a space of transition between nature and architecture is created. This is intentionally created by the geologist for the visitors to appreciate nature.



05 PRACTICES 2016-2018

The Spirit of The Amber “THE KABIN”

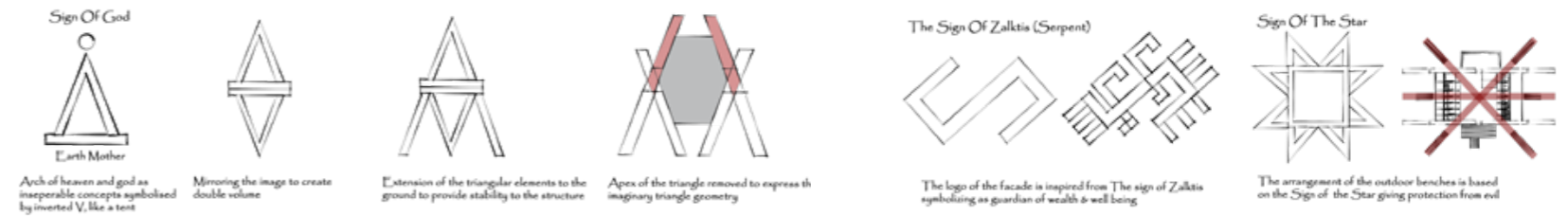

Our fascination with the latvian mythology and its symbols has carved a deep impression an inspiration to showcase the elements of latvia's heritate. The juxtaposition of 3 significant latvian symbol forms the main components in this concept and translates itself into, “The Kabin.”

This concept intends to adapt for different terrains by using 2 pairs of timber rafters forming the main structural framework for The Kabin. At the same time, the formation of these rafters signifies the latvian symbol of god represented by the series of triangles above the horizontal baseline (earth-mother).

This 45 sq/m cabin is elevated for easy visibility and provides some deterrent from the wild animals. The floor layout is simple with dedicated spaces for sleeping, dining and casual activities. Alternating steps to the loft above extends to function as a lounge bench with slopping back rest.

The loft space is another dedicated sleeping area. Hammock spaces are designed to provide some therapeutic sleeping experience and social interaction below. This level can access to the outdoor deck for views from the rear of The Kabin.

Outdoor benches provide a rest area for trekkers. These benches are arranged in the formation symbolising the Sign of the Star, signifying the protection from evil.



06 PRACTICES 2016-2018

CONTAINER HOTEL PROPOSAL

Sungai Buloh , Malaysia



06 PRACTICES 2016-2018

SERVICE APARTMENT (CONDOMINIUM) PROPOSAL

Damansara Height, Malaysia





A Retreat House for Geologist

Blending architecture artificial space with the nature environment, visitors could be detach from the environment while entering to the public space. An outdoor space that could speak for the geologist.

M.Arch Stage 4 Final design project

2020 ©franklee