

# ARCHITECTURE PORTFOLIO

Selected works | 2013 - 2020  
-by Aniket Risbud

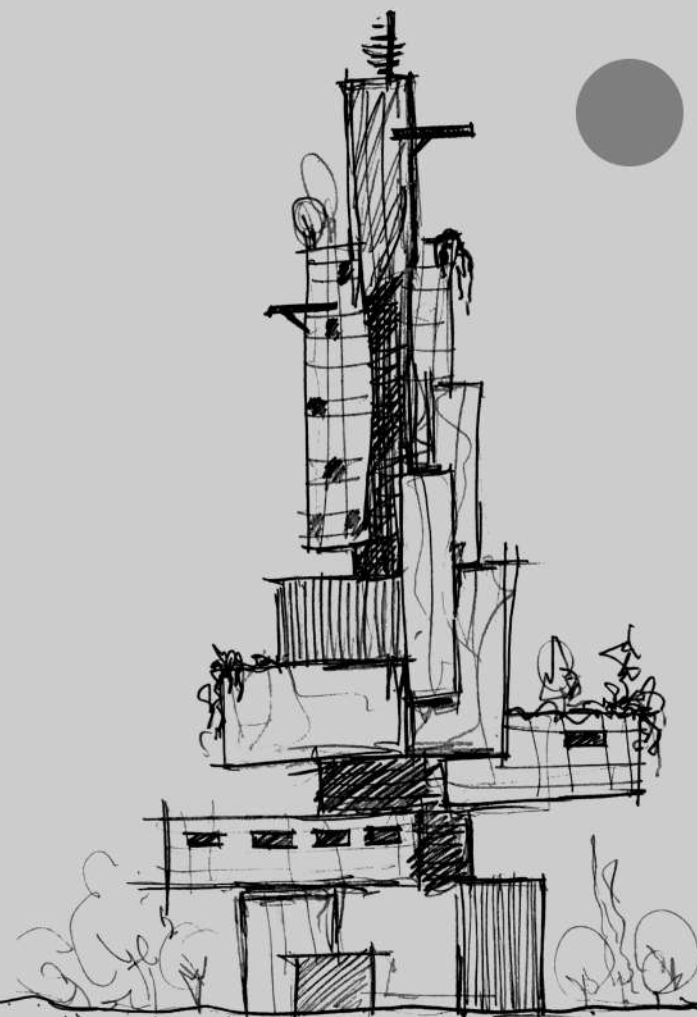

# CONTENTS

## Professional work

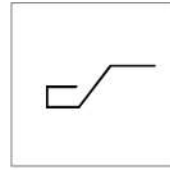

Residential Villa,  
Chandigarh

01

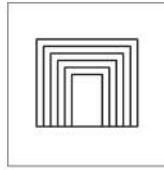

PSS Banquets,  
Tenkasi

03

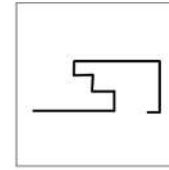

Elpro Cinemas,  
Pune

05

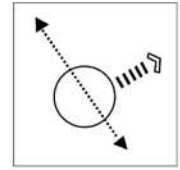

Convention center,  
Jabalpur

07

---

## Academic work

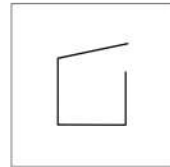

Urban Nomads,  
Housing module for  
construction workers

09

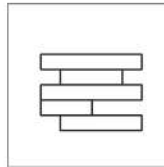

Social Housing,  
Mulund

11

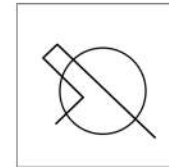

Art and Cultural Center,  
Mumbai

13

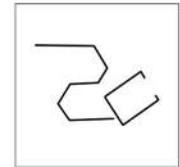

Weekend Residence,  
Badlapur

15

---

## Miscellaneous

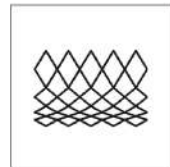

Commercial Plaza,  
Mumbai

17

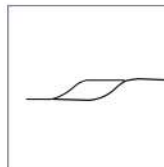

Parel Terminus,  
Mumbai

19

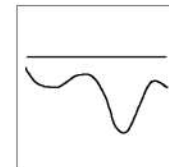

Lockdown Challenge  
Competition

21

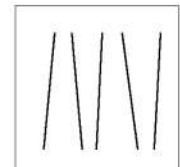

Tube Conceptual Design  
Competition

23





## Residential Villa

Devra Architects

Project type: Residential  
Location : Chandigarh  
Site Area : 210 sq.m  
Year : 2020

Through the entrance, a hanging white box- study room welcomes the visitor, designed in a contemporary architectural style. The massiveness of the design is reduced by using full-height transparent glass. In addition, the laser-cut metal screens fixed on the glass help to filter the harsh southern sun rays. The cantilevered roof is clad with a wooden finish high pressurized laminate (HPL) that enhances its aesthetical value.





The arrangement of functional spaces with minimum circulation passages helped to fulfill the client's brief in such a small footprint. The essence of the master bedroom's elegance lies in its right choice of materials and color palette. The highlighter tile- Granos Tobacco from Simpolo collection blends with the overall design language of the washroom.



GROUND FLOOR PLAN

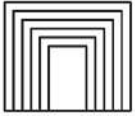

## PSS Tenkasi Cinemas

Arris Architects

Project type: Interior

Location : Mumbai

Site Area : 1165 sq.m

Year : 2018

The facade of the multiplex is designed in Glass reinforced concrete (GFC) panels. The fluted entrance portal is the focal point of the design with an emphasis on the carefully located up and down throw warm wash lights.



VIEW OF PSS TENKASI CONCESSION LOBBY

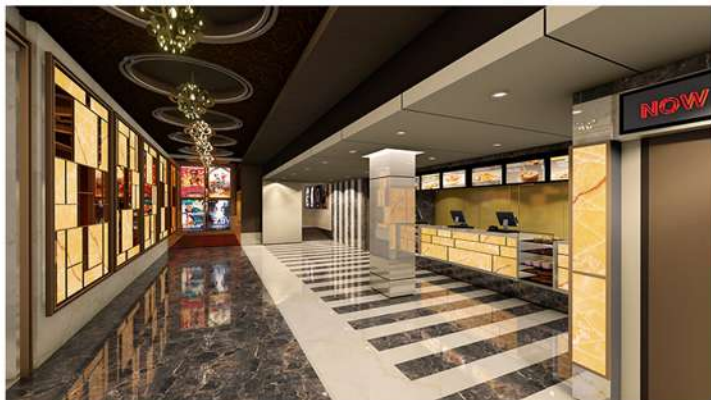
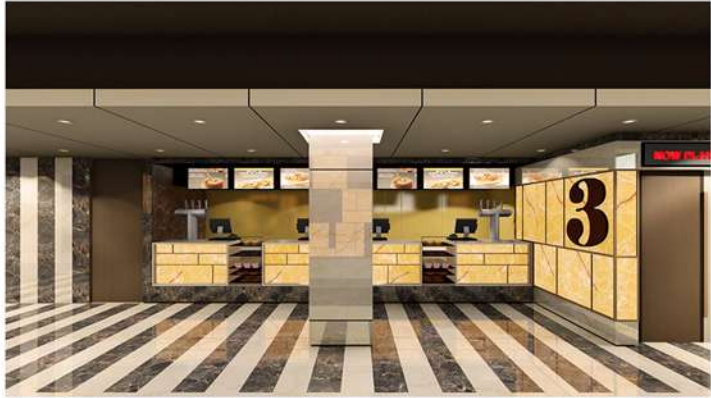

FLOOR FINISH

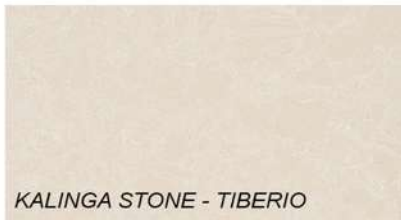

MATERIAL FINISHES

WALL FINISH



CEILING FINISH



MATERIAL PALETTE FOR PSS TENKASI CONCESSION LOBBY

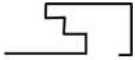

# Elpro Cinemas

Arris Architects

Project type: Interior- Arris Architects

Location : Pune

Site Area : 1365 sq.m

Year : 2018

The interior of the Concession lobby is based on an eclectic theme. The design has stuck to a neutral color palette and used a few accent colors such as magenta pink and antique gold as to bring in the worldly vibe.

Parametric chandelier, backlit bulkhead clad with alabaster sheets, an array of inclined false ceiling strips are some of the key features of the design.







View of the video wall and the seating lounge (at 'X')



View of the concession counters and parametric chandelier (at 'Y')



View of the ladies washroom (at 'Z')

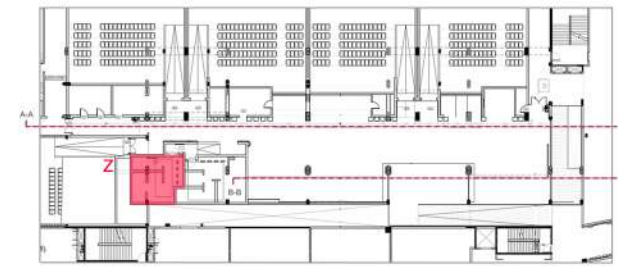
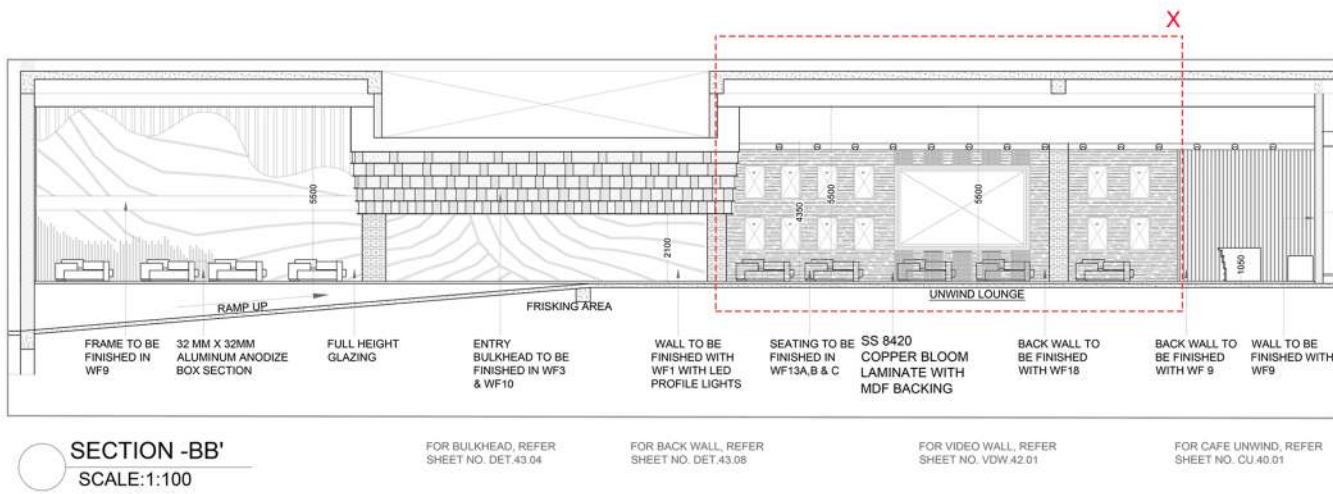
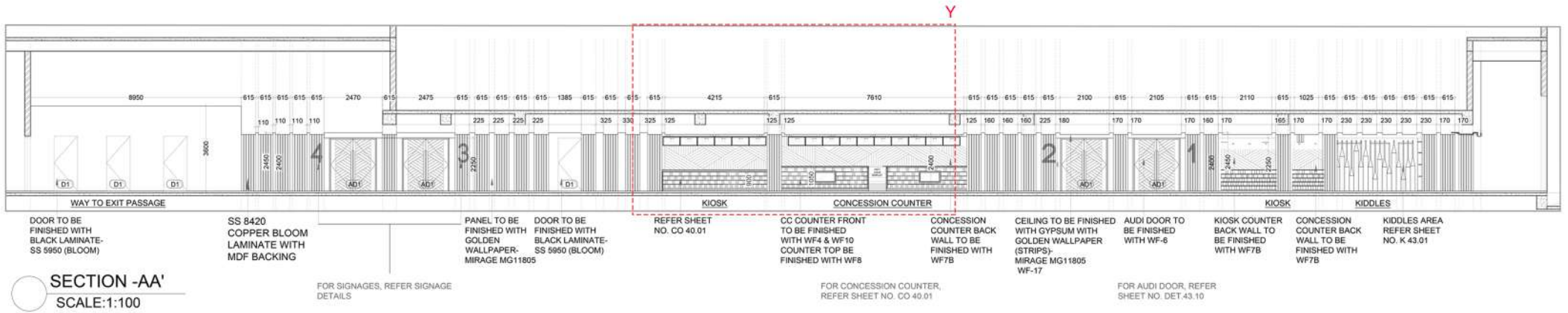

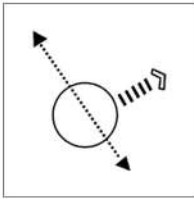

## Convention center

Ranjit Singh Associates

Project type: Competition

Location : Jabalpur

Site Area : 6000 sq.m

Year : 2017

The motto behind proposing a convention center is to make smart city Jabalpur- a cultural hub.

The primary design concept is to connect the existing greenway to the pedestrian pathways. The design is based on two pillars of Sustainability and Creating a civic space for the people of Jabalpur.

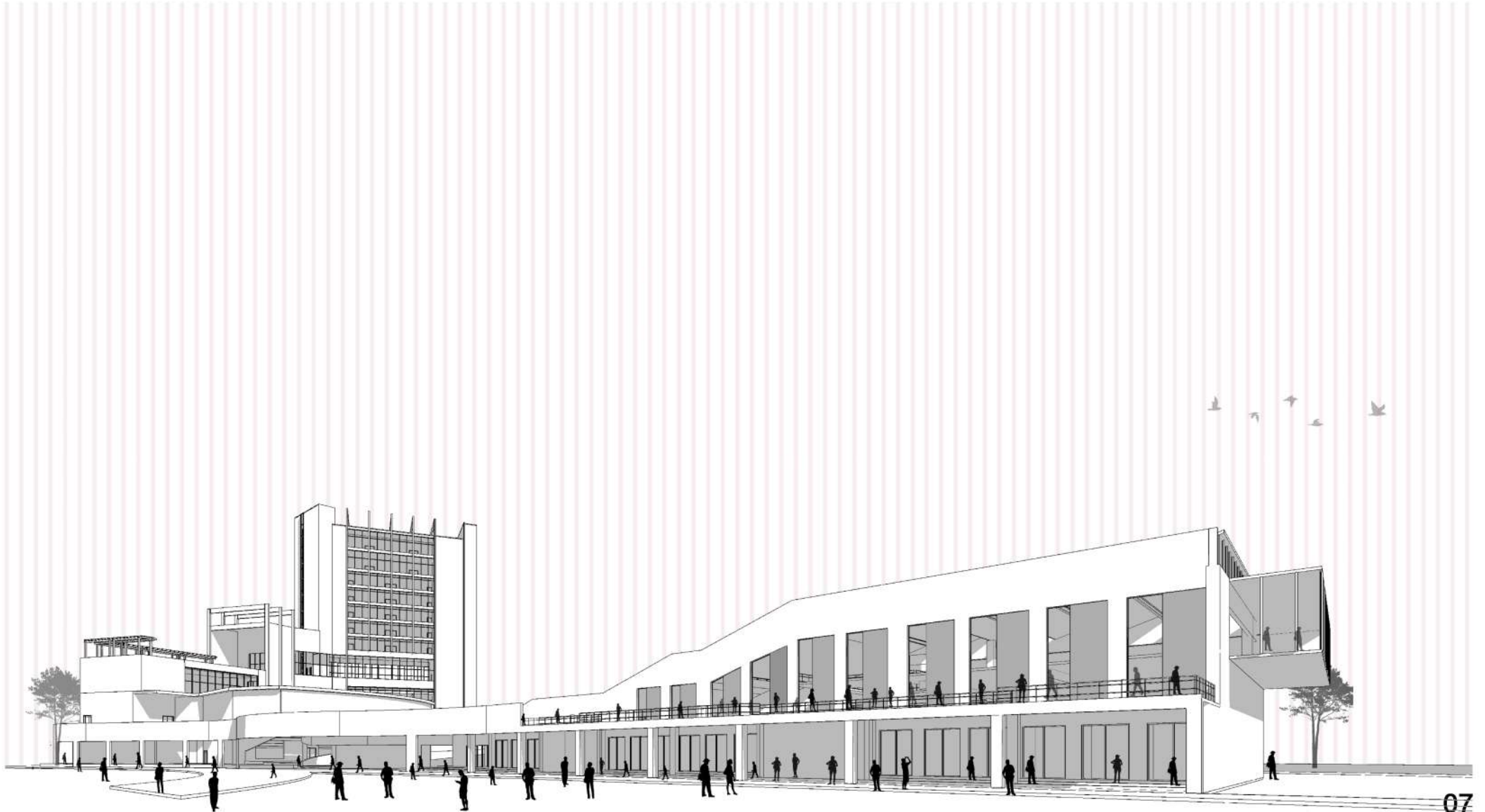

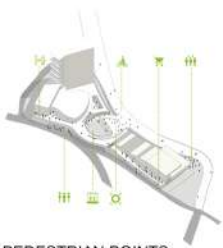

PEDESTRIAN POINTS



VEHICULAR CIRCULATION



PEDESTRIAN CIRCULATION



**WASTE MANAGEMENT**

Community urban farms create an eco system for the centre while promoting garden based education and use of organic produce on the premises.

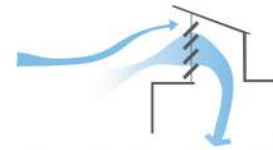

**PASSIVE COOLING BUILDING DESIGN**

Smart wind scoops designed to capture North- West cool winds withing courtyards and buildings.

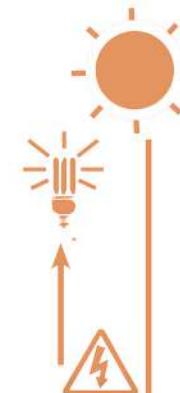

**ENERGY GENERATION**

Intergrated photovoltaic cells with canopies and building facades shall generate energy during the day and be connected to the smart grid.

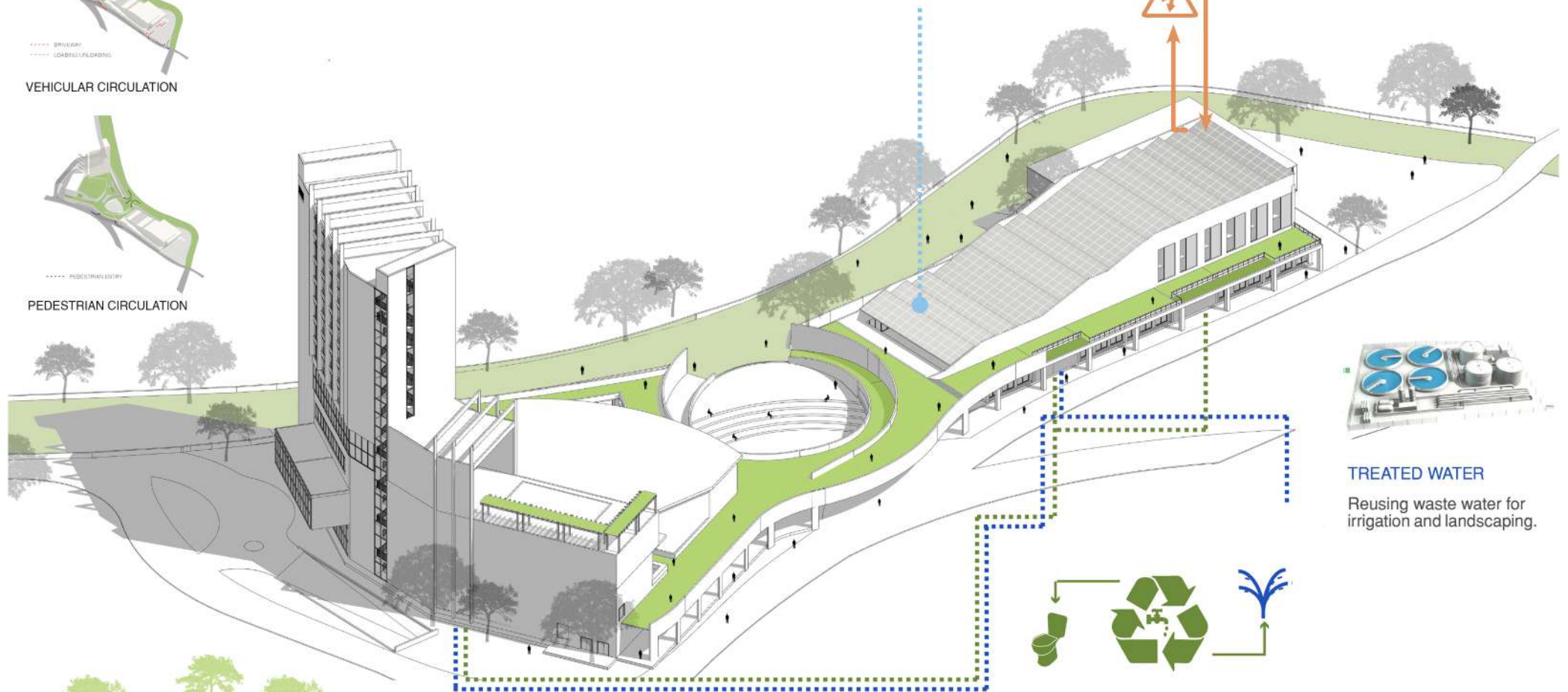

**TREATED WATER**

Reusing waste water for irrigation and landscaping.



**WASTE WATER MANAGEMENT**

Treated Water disinfected physically by micro filtration



Non Motorised Transit Section



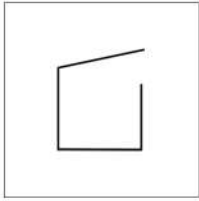

# Housing for On-site Migrant Construction Workers

Final year design dissertation | Saint Gobain Scholarship winning entry

Project type: Housing  
Location : Thane  
Site Area : 2250 sq.m  
Year : 2018

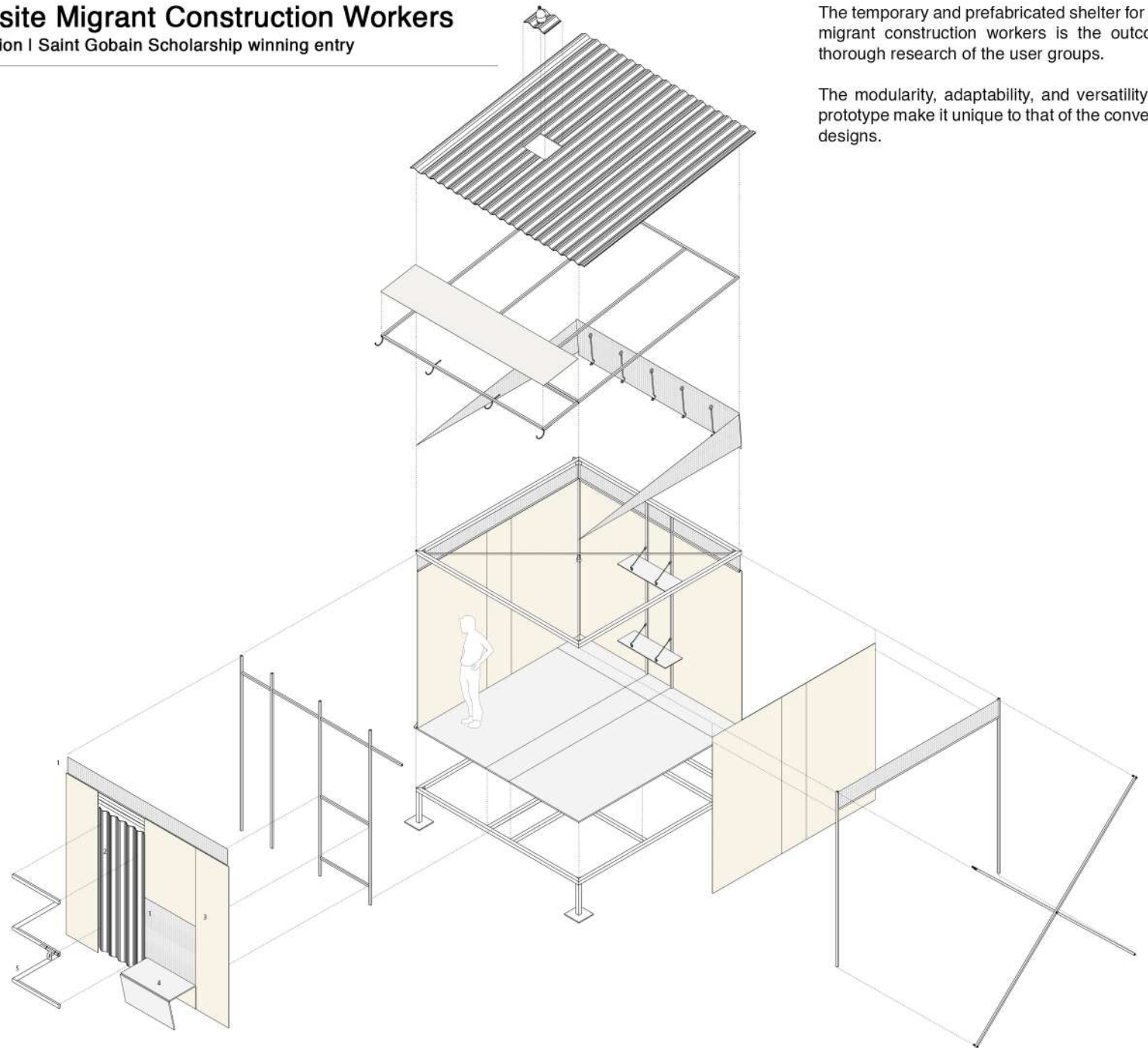

1. Geotextile - 2800 mm x 300 mm x 2 mm thk

2. Tetrapack roofing sheet (corrugated)  
2100 mm x 800 mm x 6 mm thk

3. Tetrapack wall panels  
2400 mm x 1200 mm x 6 mm thk

4. 19 mm thk. used shuttering marine  
plywood

5. M.S square box hollow section  
25 mm x 25 mm x 3 thk

The temporary and prefabricated shelter for on-site migrant construction workers is the outcome of thorough research of the user groups.

The modularity, adaptability, and versatility of the prototype make it unique to that of the conventional designs.

EXPLODED VIEW OF THE PROTOTYPE

## FORM EVOLUTION

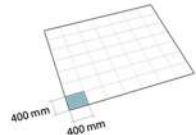

Grid of 400 mm x 400 mm

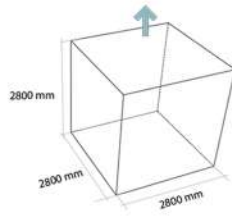

Extrude the plane of 2800 mm x 2800 mm



Addition of vertical supports



Vertical supports as a scissor joint



Additional flap for ventilation

## CONSTRUCTION STAGES



A standard size of truck can contain about 20 such units



Placing the telescopic MS stilts below the ground on flat strata

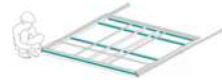

Framework of the prototype in its folded fashion

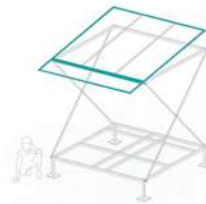

Opening the secondary flaps by means of MS pawan kadis



Fixing the door sheet and window cum bench to the framework

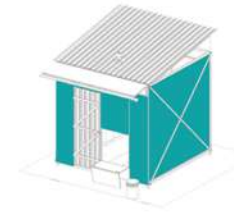

Fix the envelope (walling panels/fabric) to the framework

## VERSATILE PROTOTYPE

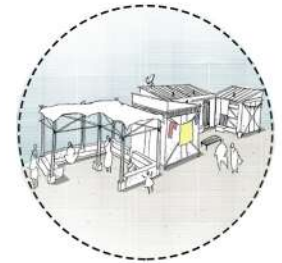

Cluster arrangement with communal kitchen

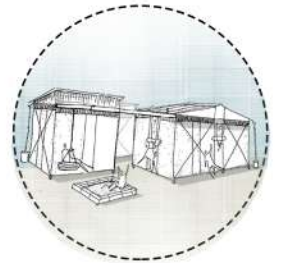

A Daycare center for construction worker's kids



A Subsidized canteen for construction workers

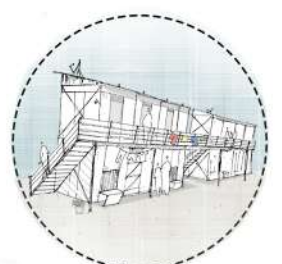

G+1 arrangement for compact sites

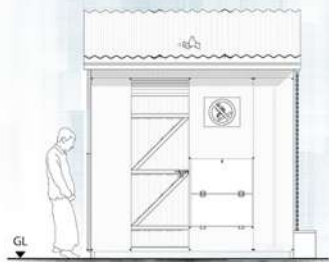

FRONT ELEVATION (1:20)



SECTION AA' (1:20)

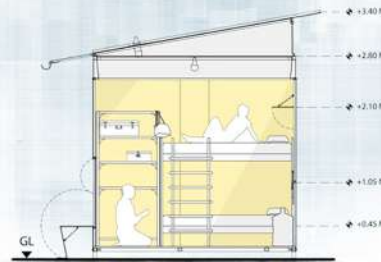

SECTION BB' (1:20)



REAR ELEVATION (1:20)

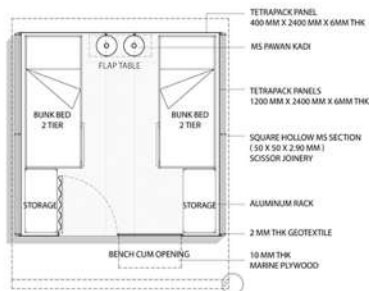

FURNITURE LAYOUT

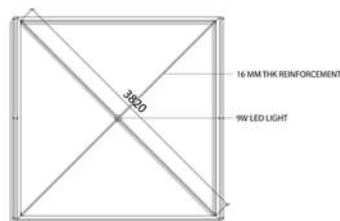

PLAN OF UPPER FRAME

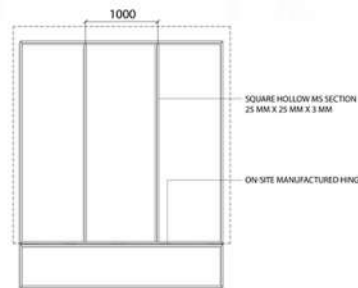

STRUCTURAL LAYOUT FOR ROOF

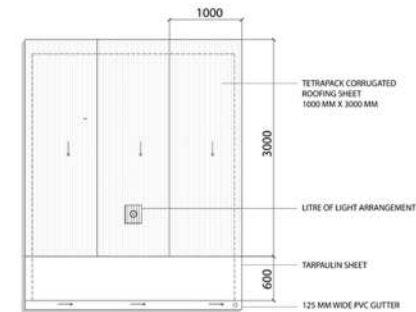

ROOF LAYOUT

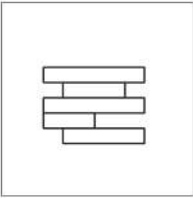

# Social Housing

Fourth year | Kohler Design Scholarship winning entry

Project type: Housing  
Location : Mulund  
Site Area : 2250 sq.m  
Year : 2018

The concept of solids and voids has been used in the overall design intervention. These voids define forms, and lend character to the building by giving pixelated motion. An attempt has been made to convert these voids as terrace gardens that can act as social interactive spaces.



KEY PLAN





TYPICAL BALCONY SECTION

The balconies are designed in an adaptable manner. An inbuilt planter bed made up of Ferro-cement helps to keep the building elevation intact.

The drain pipe for the planter bed is attached to that of the kitchen sink's drain to avoid an

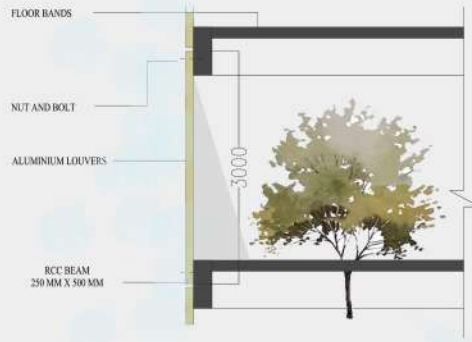

TYPICAL COURTYARD SECTION

Central courtyards formed amidst chunks of built mass act as breathing spaces.

It provides a space for social and visual interaction, thus encouraging Human to human interaction.



TERRACE LEVEL PLAN



MIG LEVEL FLOOR PLAN



LIG LEVEL FLOOR PLAN



LIG LEVEL FLOOR PLAN

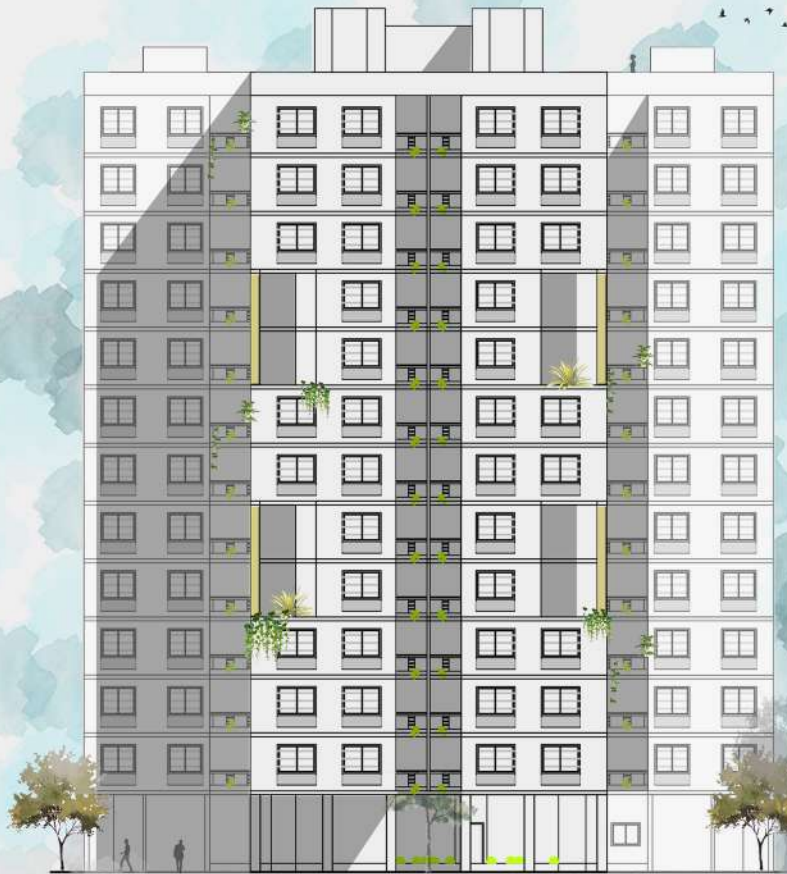

FRONT ELEVATION

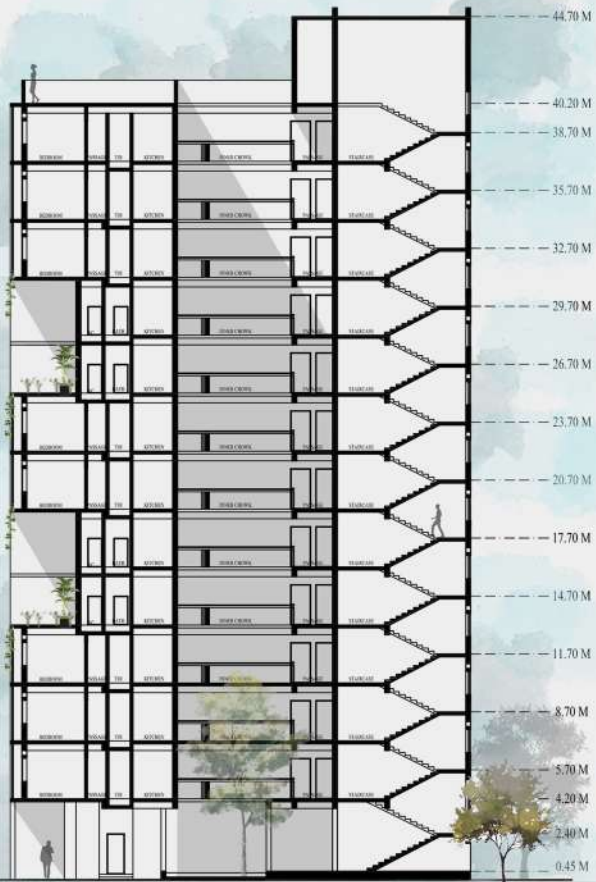

SECTION AA'



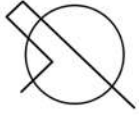

## Art and cultural center

Third year

Project type: Cultural  
Location : Fort, Mumbai  
Site Area : 900 sq.m  
Year : 2015

Mumbai, a city that never sleeps, also a hub of business centers, and has a great historical background. The site: GENERAL ASSURANCE BUILDING sits amidst a row of elegant historic buildings on the D.N.Road. The proposal attempts to enhance the art and culture of the city through a built space where modernity is emerging out from traditional architecture styles.

Grade of the building: IIA



**Conceptual sketches**



**Social impact**

An initiative like this will help in spreading the awareness about art and craft through people-people, people-artist, and artist-artist interactions.



**Diminishing the border**

Dry landscaped areas help to merge the indoor and outdoor spaces.



**Museum planning**

Planning is based on a fact- A strong sense of surprise can be created if the goal is suddenly revealed without warning.



**Platform for interaction**

Stepped seatings have been designed where the visitors can sit, mingle with each other and socialize.

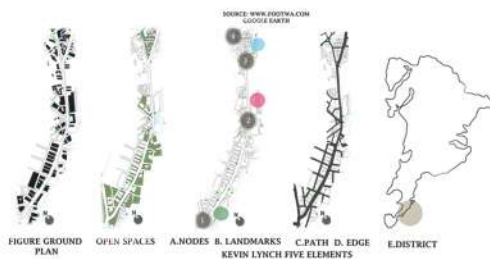

Urban planner Kevin Lynch's five principles have been taken into consideration to study site context.



The central staircase is designed in such a fashion that it will overlook into the central atrium. A free-flowing staircase is supported on a central stringer.

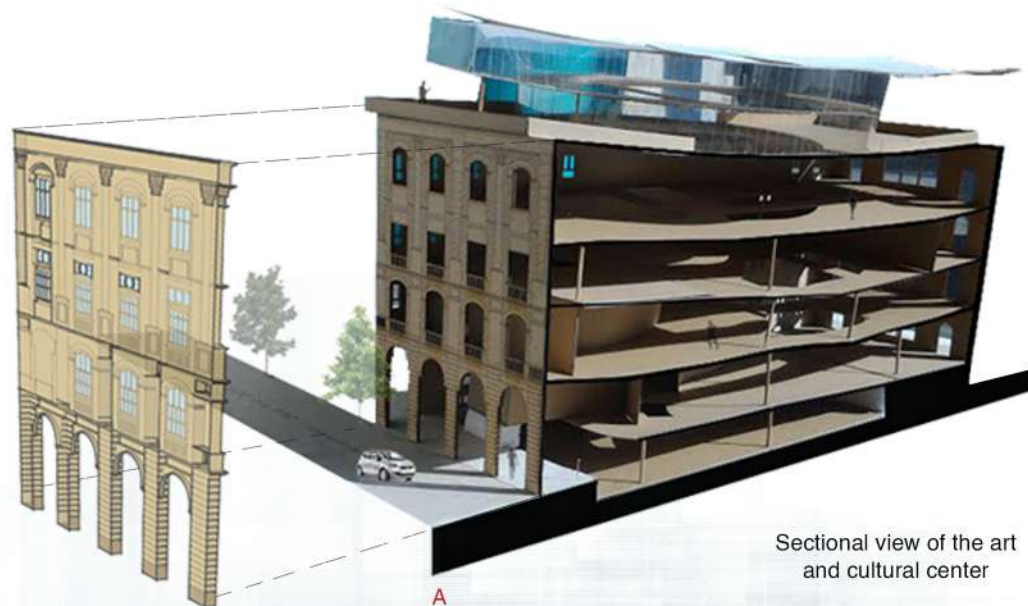

Sectional view of the art and cultural center

MEDIEVAL STYLE PLANNING

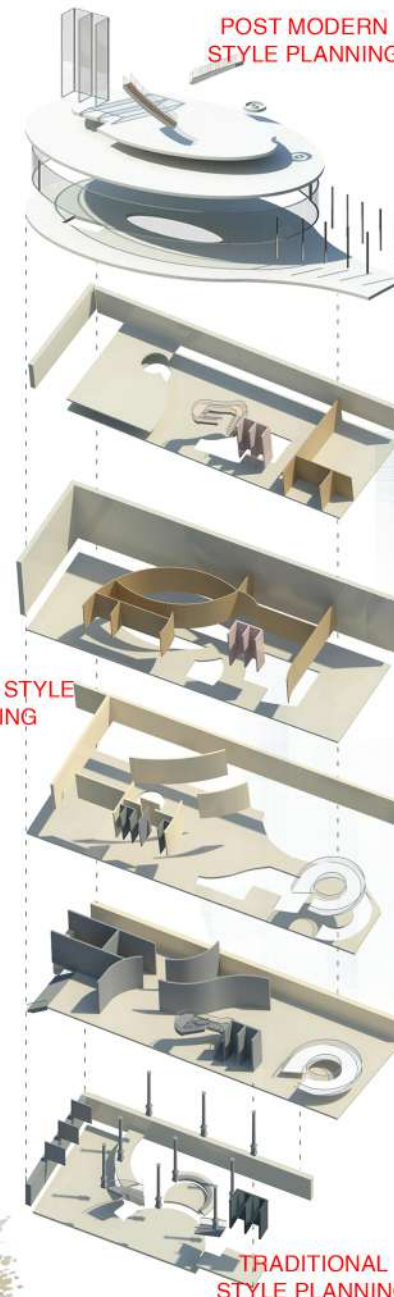

TRADITIONAL STYLE PLANNING

Exploded view of the floor plates

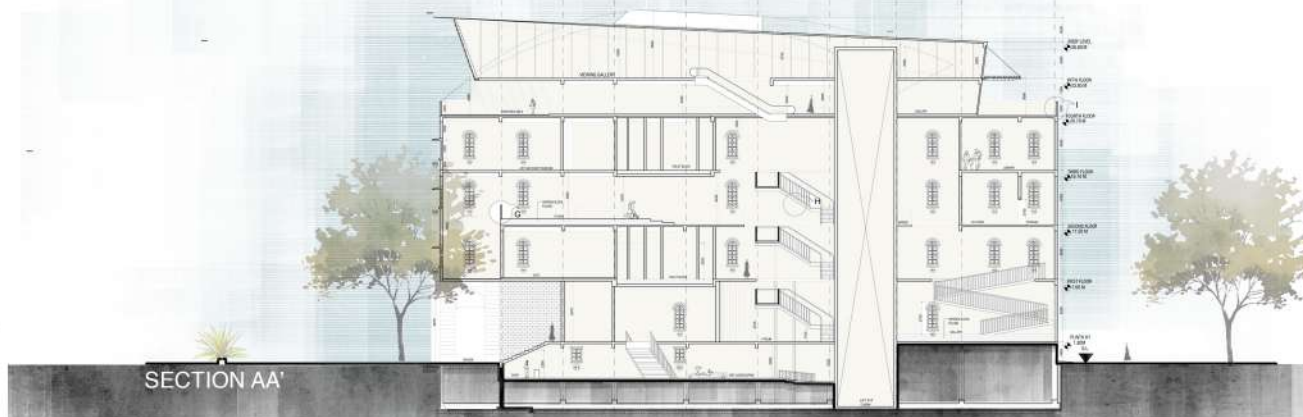

SECTION AA'

POST MODERN STYLE PLANNING

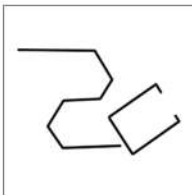

## Weekend residence

First year

Project type: Houses  
Location : Badlapur  
Site Area : 4000 sq.m  
Year : 2013

The design itself speaks about the client- fashion designer Neeta Lulla, abstract spaces in the bungalow with a traditional touch goes well hand in hand. The extended pergola from the roof creates a party area within. The residence is designed in such a way that every room is facing the Serene Ulhas River. The bedrooms have a covered deck overlooking the landscaping which merges with the surrounding topography.





Walk-in closet

Master bedroom

Meditation room

Lily pond

Guest bedroom

Indoor bar counter

Living room

Dining room

Powder room

GL

SECTION AA'

SECTION AA'

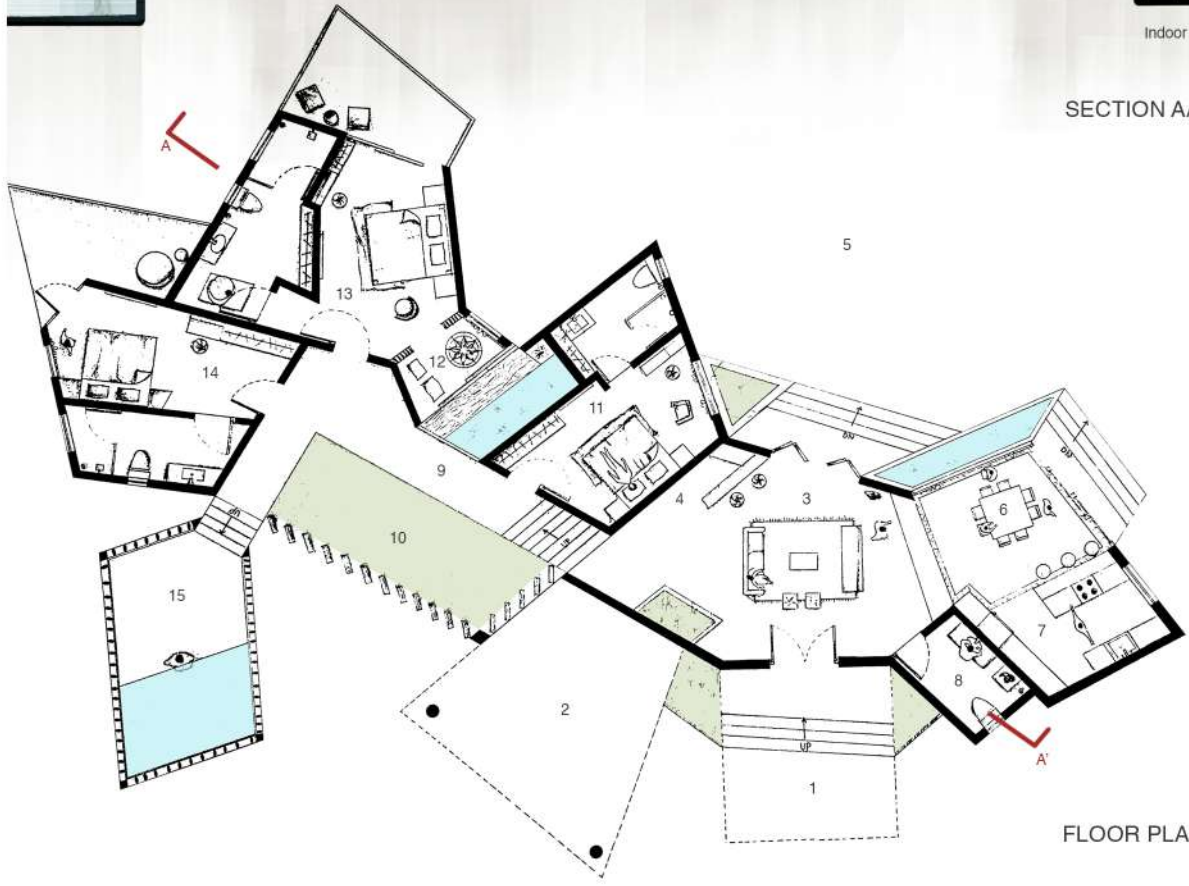

FLOOR PLAN

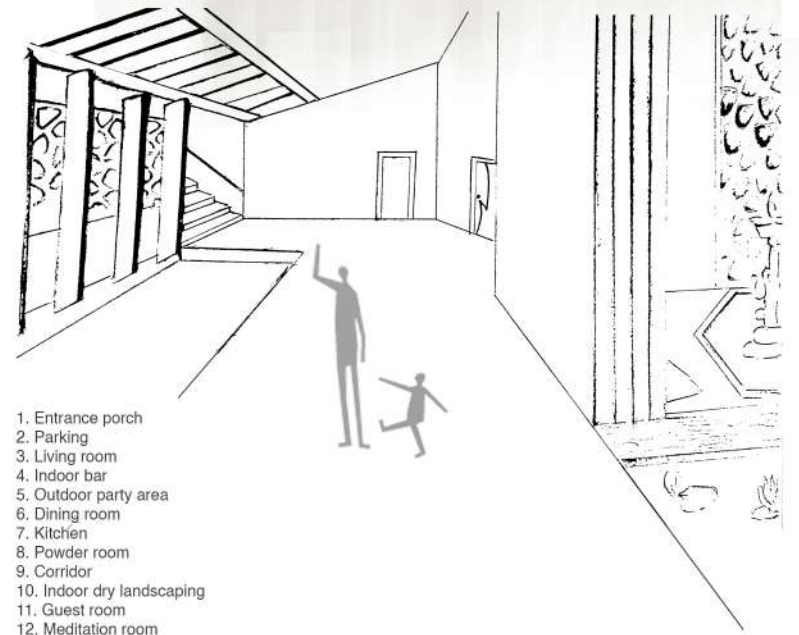

- 1. Entrance porch
- 2. Parking
- 3. Living room
- 4. Indoor bar
- 5. Outdoor party area
- 6. Dining room
- 7. Kitchen
- 8. Powder room
- 9. Corridor
- 10. Indoor dry landscaping
- 11. Guest room
- 12. Meditation room
- 13. Master bedroom
- 14. Daughter's room
- 15. Deck with a lap pool

Conceptual view of the corridor leading to the bedrooms and lap pool





## Commercial Plaza

Freelance

Project type: Commercial- Freelance

Location : Mumbai

Site Area : 1500 sq.m

Year : 2020

The glazed skin of the commercial plaza is draped with an automated metal screen. The screen slides along its Y-axis as per the sun orientation to minimize heat gain. The double heightened travertine cladded covered entrance frame and tapering columns act as a welcoming feature for the visitors.





FRONT ELEVATION



KEY PLAN

SECTION AA'

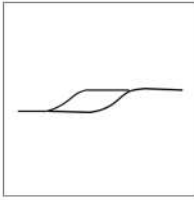

## Parel Terminus

Freelance | Sir J J College of Architecture Consultancy Cell

Project type: Transport  
Location : Parel  
Site Area : 7000 sq.m  
Year : 2016

Parel, which was once dominated by textile mills till the 1980s, morphed into a posh locality as part of the redevelopment of Mumbai mills. The area is now dominated by luxury skyscraper apartments, upscale restaurants, premium office space, luxury hotels, and boutiques.

The context of the site plays a vital role in the design process. The design is inspired by Fabric threads.

Features such as integrated services with structural members, activities under a single roof and Skylights, Louvers for natural light and ventilation makes it a more efficient design than a conventional railway station model.

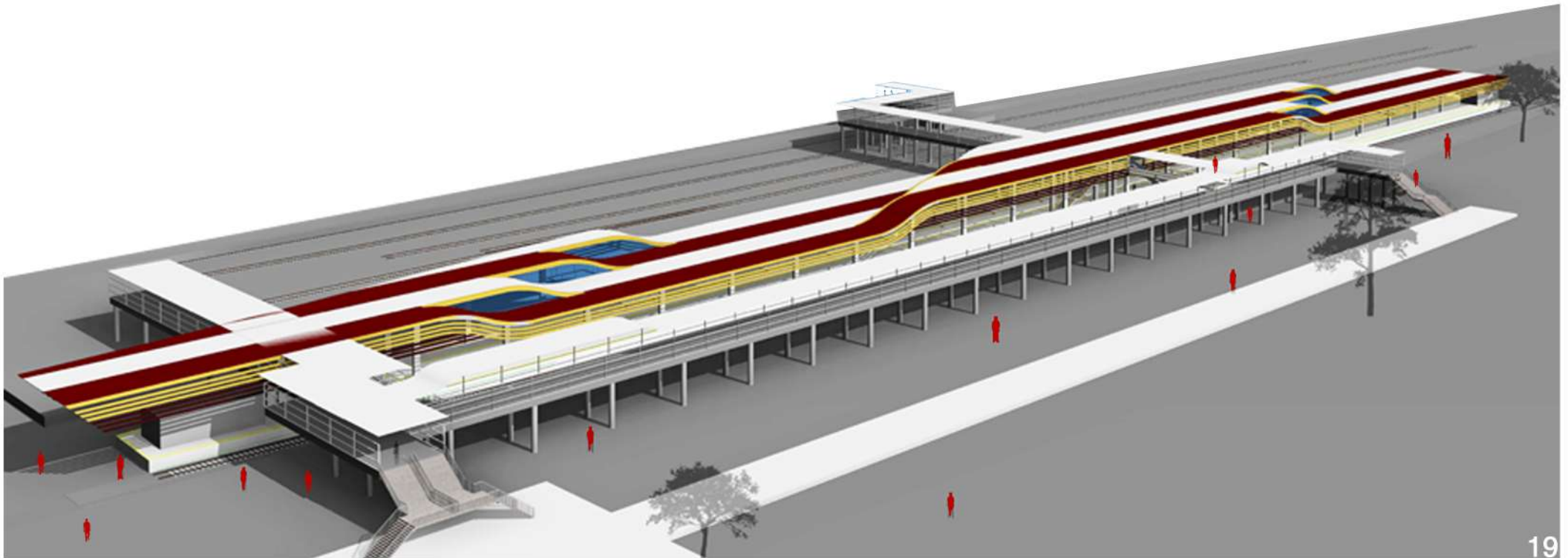



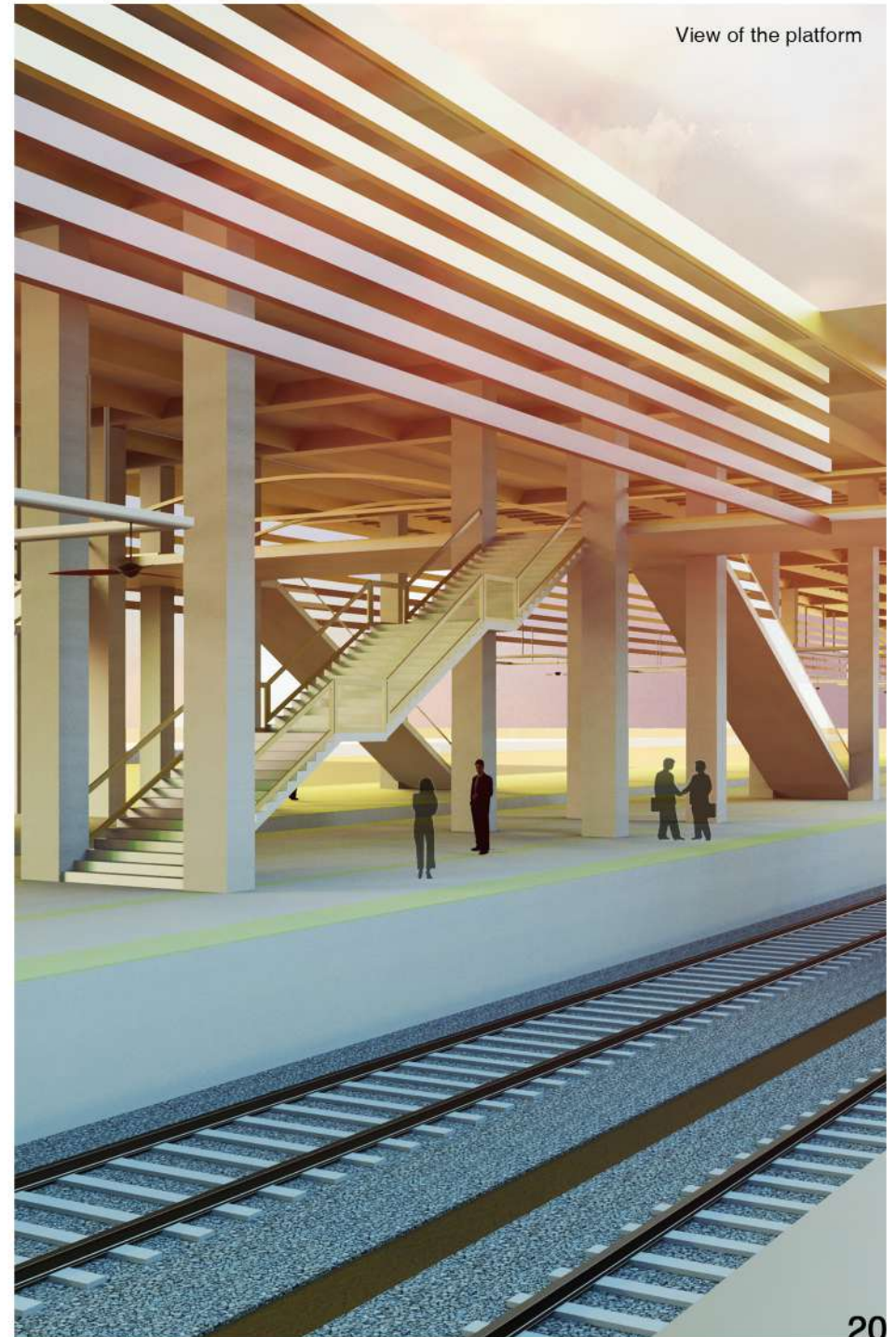
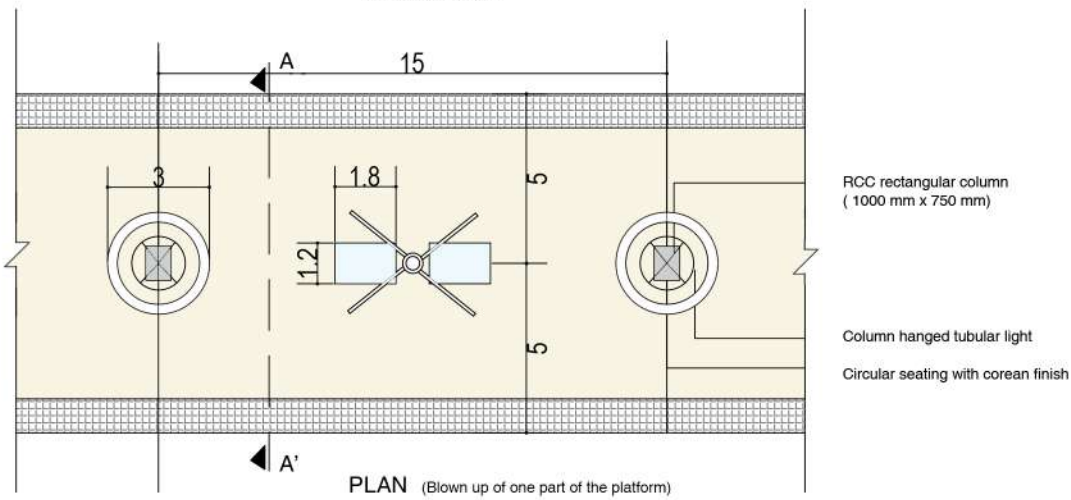
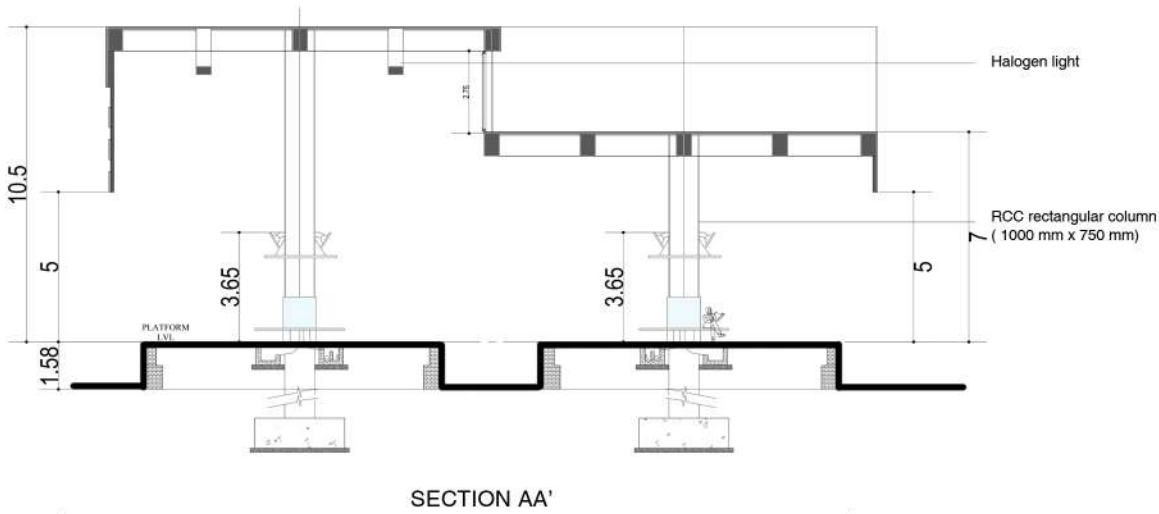
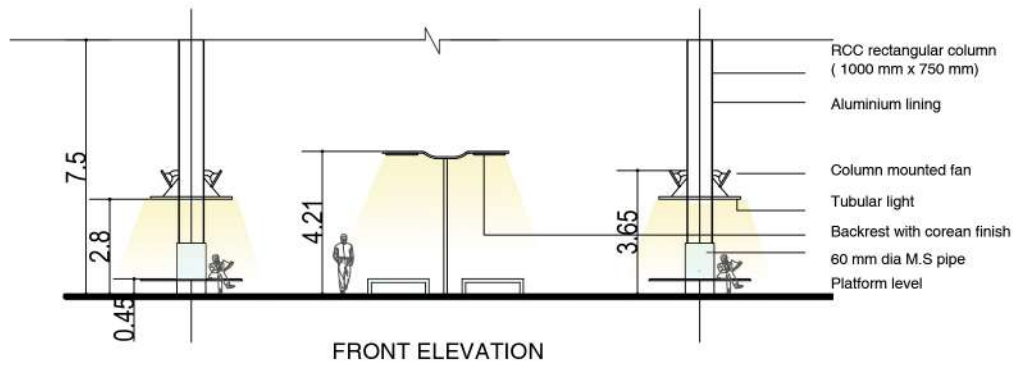

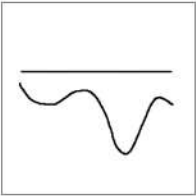

# Lockdown Challenge

Console Design- Dynosole

Project type: Furniture Design Competition

Location :-

Site Area :-

Year : 2020

Sleek looking, elegant, and exclusive! Display your antique collection or hide your secrets in its dramatic aesthetics. Dynosole will solve the storage needs of daily items like your car keys, newspaper, and even books. Let the console stand out in your entrance foyer or camouflage it with room's interior theme. An attempt has been made to achieve a simple and open-ended narrative by eliminating unnecessary, superficial components. The design speaks about beauty in a novel sense, not just cosmetic beauty.



## SPECIFICATIONS

Length X Width X Height

Big:  
1350 X 450 X 750 mm

Small:  
600 X 450 X 750 mm

As a seating:  
1350 X 450 X 450 mm

## LEGEND

1. 25 mm dia. MS hollow tube anodized to jet black
2. 10 mm thk polished teak wood plates
3. 30 mm dia. MS disc anodized in champagne gold
4. SS plugs finished in champagne gold polish

## DESIGN EVOLUTION



### Function

A flat surface to keep the daily needs and small storage space



### Proportions

Visual balance has been obtained with the golden spiral and ratio.



### Form

Humans surround themselves with beauty. Hence equal priority has given to form and function.



### Structural integrity

Inspired by the Danish furniture, the focus of the design is on its exposed joinery and details.

## CONSTRUCTION DETAILS

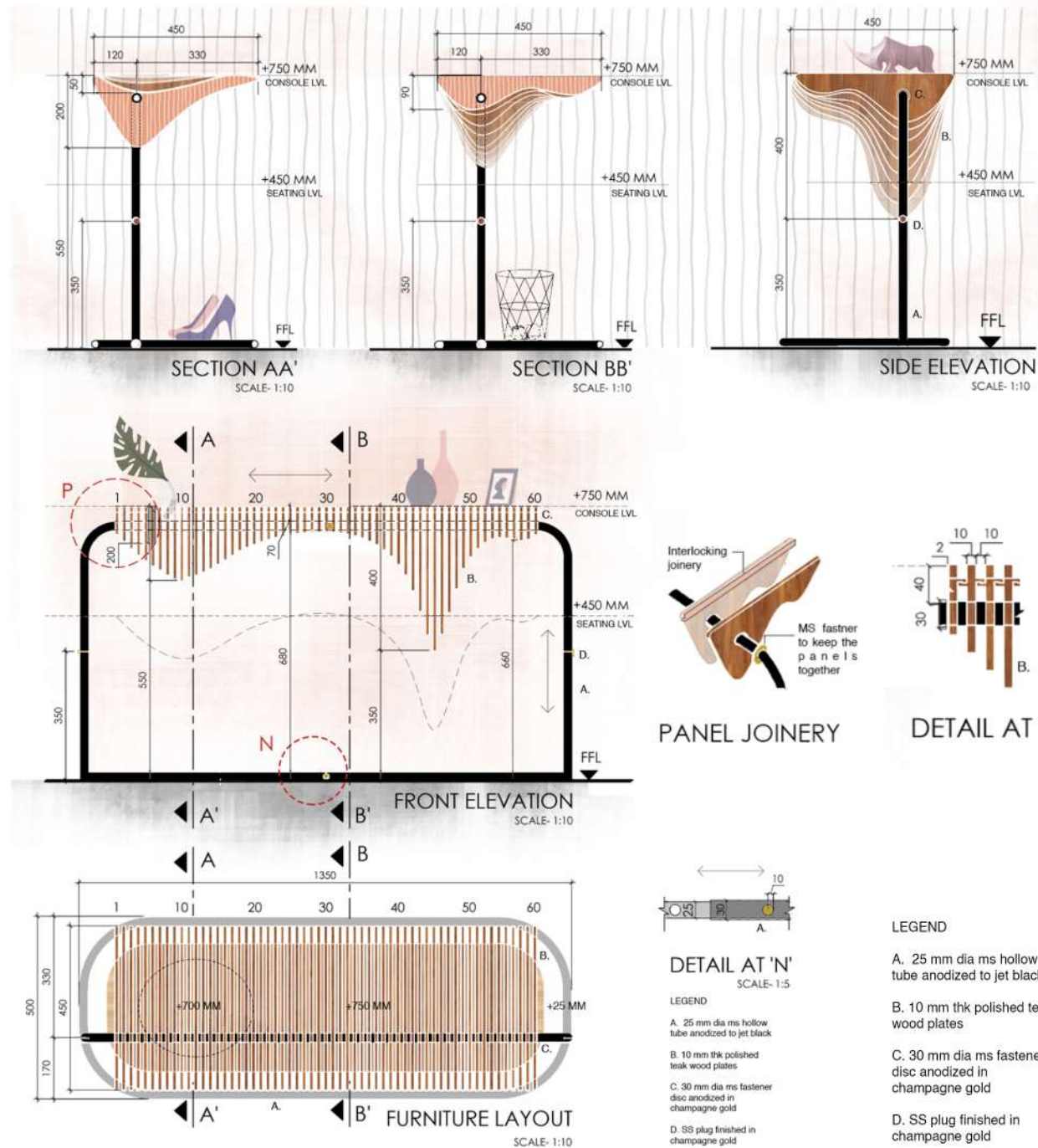

## AXONOMETRIC EXPLODED VIEW

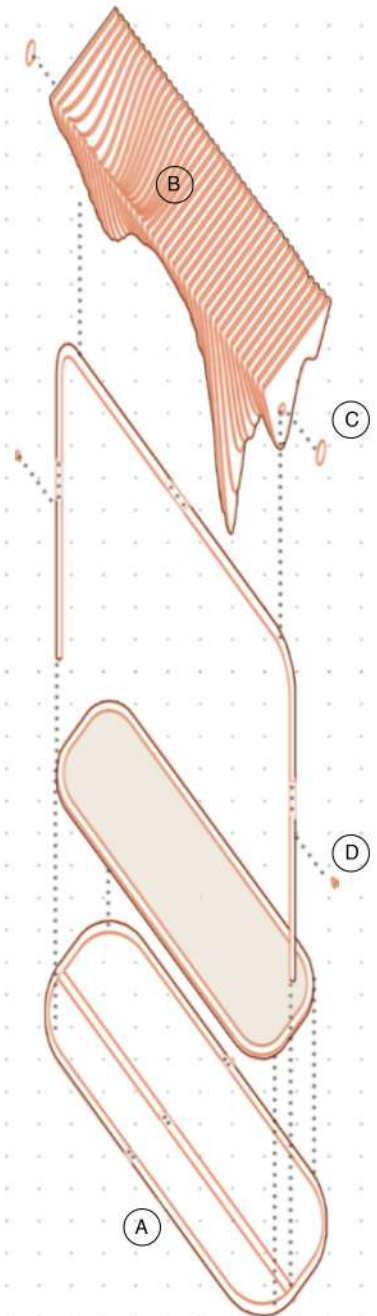

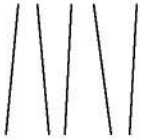

# Tube Conceptual Design Competition

## An Ephemeral Experiential Gallery

Project type: Public  
Location : Kunming, China  
Site Area : 2250 sq.m  
Year : 2020

The design focuses on the experiential architecture principles. The experiences and impressions are the driving forces that navigate the visitor through space. It also promotes socio-cultural activities and user interactions. It's a gallery of multisensory experiences where the human scale has given the utmost importance. The color palette inspired by the Chinese architecture not only shows respect to its context but makes the rigid edges of the passageway porous. This adaptable white forest would become the local identity of the area with personalized touches of the visitors.



# 6 Principles to a great public realm (Based on Jan Gehl and Lars Gemzoe Principles)

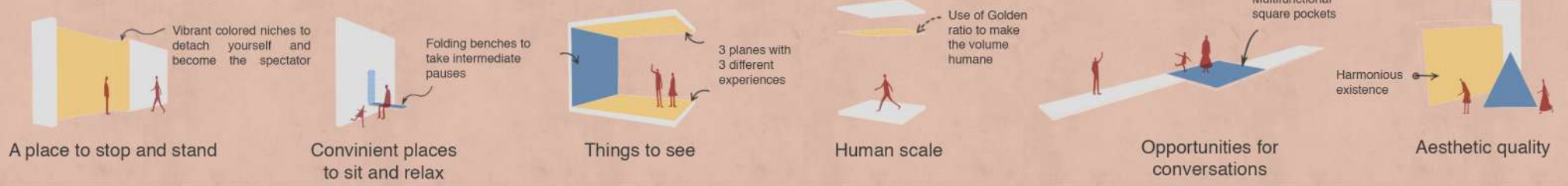

**Sensorial Experiences**

Natural Light Wells

Textures

Self Sustained

Soothing Sound

**Elements of placemaking**

Folding Benches

Hide and Seek

Reflections

Eyes on the passage

**Section AA'**

**Key Plan**

**Part Plan**

Thank you



Email: [aniketrisbud4@gmail.com](mailto:aniketrisbud4@gmail.com)  
Contact no. +91 8097529674