

REPORT

FOLIO



# SUTHIRA TUPTHAVEE

Address: 519/28 PrachaU-thit Rd., Thungkru, Thungkru,  
Bangkok, Thailand 10140

Telephone: 66 83 415 9492

E-mail: Suthira.ice@gmail.com

## EDUCATION BACKGROUND

2017 - 2022

Bachelor Degree in Architecture  
Second class Honours [Gpax: 3.31]  
School of Architecture and Design (SoA+D), Faculty of Architecture  
King Mongkut's University of Technology Thonburi (KMUTT).

2014 - 2017

High School  
Gifted (Science Math Program) [Gpax: 3.37]  
Satri Si Suriyothai School

## EXPERIENCE

2020

Architectural Intern at **OBA The Office of Bangkok Architects Co., Ltd.**  
Bangkok, Thailand.

July 2022 - Dec 2022

Architectural Intern at **Klongtom Heritage Company Limited**  
Bangkok, Thailand

## WORKSHOP & COMPETITIONS

2019

- **Boutique Hotel**  
Boutique Hotel organized by Anek Chongsathian business owner of Too fast Too sleep company limited.
- **CENTRAL WOMAN'S CORRECTIONAL INSTITUTION - SoA+D**  
A collaboration between ICRC (International Committee of Red Cross) and KMUTT project that design Woman' correctional institution in Thailand.  
This project is serective to show in ACCFA (8th Asian Conference of correctional Facilities Architecs and Planners).

2020

- **Melbourne Affordable Housing**  
The Melbourne Affordable Housing Challenge is part of Bee Breeders' Affordable Housing competition series. Run in partnership with ARCHHIVE BOOKS, this competition tasked participants with submitting innovative design proposals for mitigating Melbourne's affordable housing crisis.

2021

- **Re-image Hualamphong station Project**

This project assign to create new program/function for renovate Hualamphong station to present to Department of Thai Railway to renovate HLP station in the future. I be apart of team that analysis area and find the objective of renovatting thr HLP station before sepreate into the individual to create the building and space folloe the program that our group planed.

## CERTIFICATION

2020

The German Sustainable Building Council (DGNB)

2022

Klongtom Heritage on a mega investment project,  
The klongtom Heritage in Klongtom.Krabi Thailand

## SOFTWARE PROFICIENCY

### AutoCAD

●●●○○

Basis skill, know the tool and method of system, can do architecture drawing on the program.

### Revit

●●●○○

Basic skill of program, can build 3d up and do the architecture drawing on the program.

### SketchUp

●●●○○

Build 3d, Mass model for conceptual design,

### Rhino (Grasshoper)

●●○○○

Have been use to build up 3d, skin or facade of the building, Know a bit about the grasshoper code.(has been use on third year project)

### Lumion

●●●○○

Basis skill of render the perspective, video, put the material on 3d.

### Enscape

●●○○○

Basis skill of render the perspective, video, put the material on 3d.

### Photoshop

●●●○○

Photoshop the perspective, section, elevation, landscape in architect drawing

### illustrator

●●●○○

Collage, Conpeptual diagram, Poster, Page, Represent the analyse information through graphic,Info graphic, Branding design

### Indesign

●●○○○

Make project booklet, Presentation page,

## LANGUAGES

THAI

Native

ENGLISH

Upper intermediate



1



Thesis project  
co-associate with Safetist farm

2



Re-imagine Hualamphong

3

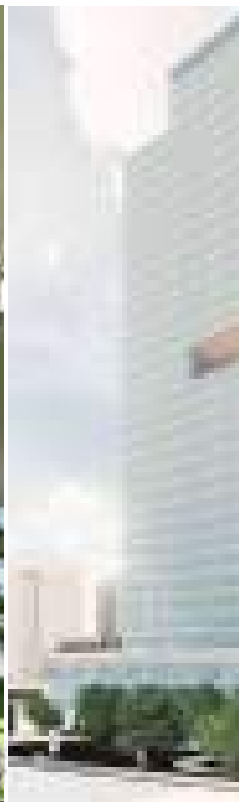

Multipurpose  
(Revit progr

Non-academic project  
Intern OBA | Intern KTH | etc.

4



Library Building  
(Learning)

5



School of Architecture and  
design (Bio school)

6

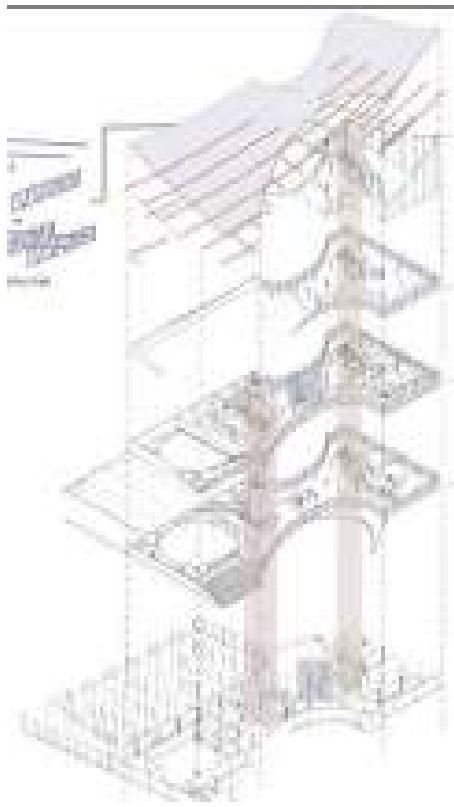

Community Cultural and  
Contemporary Art Center

7



Central Woman's correctional  
Institution



# Non-academic project

## Co-op program

During: 1st June - 30th September 2021



## Klongtom Heritage Project

During: 18th July - 17th December 2021



King's College International  
Education Project

**Description**

For project I assigned to draw and observe some detail from the sketch drawing on the other part of the building, the apartment and dormitory plan and 3D detail.

**Sun Shading**  
Modeling sun shading on the playground of the building to study the shadow on the outdoor play ground area.

**Construction Fence**  
As the construction site of the school they have to design the fence to cover the area, so I do the graphic design part follow section first.

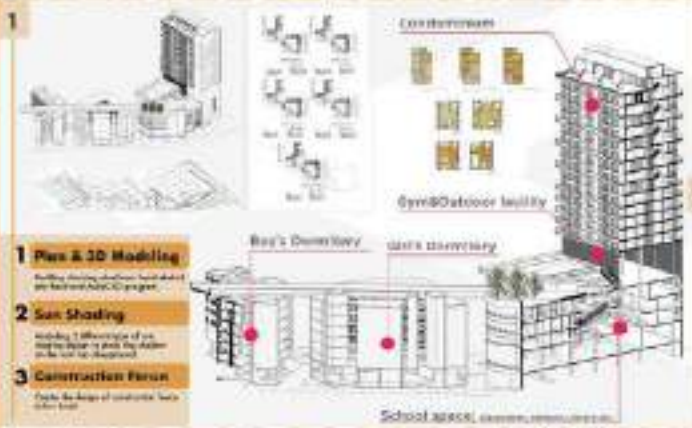

**1 Plan & 3D Modeling**

Building drawing observation, understand the building ABC, C, G, G, G, G.

**2 Sun Shading**

Modeling 3D shading of the playground to study the shadow on the outdoor play ground area.

**3 Construction Fence**

Plan & design of construction fence area first.



Sean Khun Suthira  
Residential Project

**Description**

3D Modeling the outdoor bathroom of the building and put the equipment and material on the model by deriving from the main building in the project.

**Front gate**  
design 3D schematic design of front gate. I use the research and send to contractor for design and building to make 3D.

**Lighting**  
Set the light on House model.



**1 Modeling 3D**

Modeling 3D of outdoor bathroom.

**2 Design Front Gate**

Do research and find reference to design front gate of house.

**3 Lighting**

Insert lighting light in the House follow gate.



Veranda Phubet  
Hotel resort Project

**Description**

This project I get involve per short term and get design to add some detail on 3D model and follow the final follow the design.



**Modeling 3D**

3D model and design in each building.

**Description**  
make 3D of the elevation part of the building and some detail for the drainage system outside of the building, the gas station, and the water on the landscape program.  
Drawing the detail in 3D model.



**3D model detailing**

Modeling 3D follow with site of elevation and part of the building, the gas station, and the water on the landscape program.

Banyan Valley Huayin  
Resort Project

**Description**

Adjusting master plan, starting with site 1:10 and 1:5000, then follow the sketch into CAD, after inside the block.

In each area, adjust some site of the road, cut lake and walk, then transfer each block area from top to bottom, and adjust detail on the golf course.  
Adjust the site of cut lake and walk, follow the master drawing and the site of road follow the site plan.



**1 Planning**

Full site plan and zoning.

**2 Photoshop**

Creating materials and texture.

Bangkok Beach Hotel  
Residential Project

**Description**

This project is the last project for internship program that I receive the management is more every style of work and use the program basic facility to let me design some detail on presentation.

**3D sitting on**  
Sketchup  
Photorealistic on rendering and 3D Diagrams required on photorealistic on presentation Diagram/Particular/Block plan/Units plan. All part and section the building and zoning the site.  
Study the structure system, AutoCAD drawing.



Study the structure system through the program the structure, 3D zoning system and material for facade design.

**Create Diagram**

To create the diagram part of the area.

**Creating plan**

To create zoning and material for facade design.

And 3D model follow the system.



# Klongtom Heritage

**Located** : W43C+FG6, Rural Alley, Huai Nam Khao, Khlong Thom District, Krabi 81120

The first project in Thailand that brings salty hot springs to supplement treatment with modern medicine. with a physiotherapist rehabilitation medicine physician and specialist doctors Join us in designing a health care and rehabilitation program. Combined with world-class service standards Responding to the mega-trend of holistic health care for people with health problems and people who are interested in sustainable health care to experience the magic of salty hot springs.

## For the project

We got assigned to concepting and visualizing the entire project; design thinking, consumer journey, architectural planning, and interior design was instrumental in moving the project forward and gaining international recognition from foreign investors and worldwide press.

## Site location



The area of site is located at the estuary topographic; Krabi has many character of topography



### Estuary Topography

The swamp forest and nature geography at Krabi

## Local-lifestyle, Art-Culture, Environment,



### Environment

Sea, Forest, Mountain, Swamp forest



### Architecture

Vernacular Architecture Ruan Thai Muslims in the Southside character



### Community

Buddhists, Thai-Chinese, Moken (sea gypsies), and Muslims.

### People/Lifestyle

Friendly and welcoming attitude. Traditionally Krabi's inhabitants worked in agriculture, fisherman

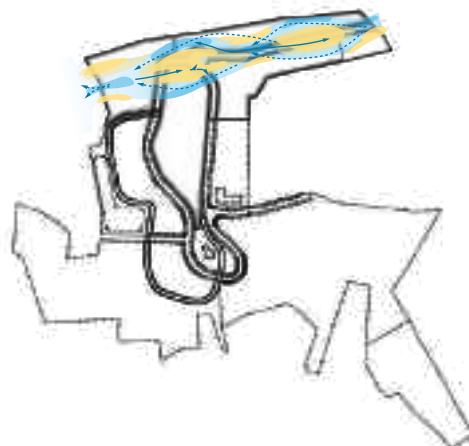

Use the character of Program and visitor Flow

## Program and zoning



Estuary Topog





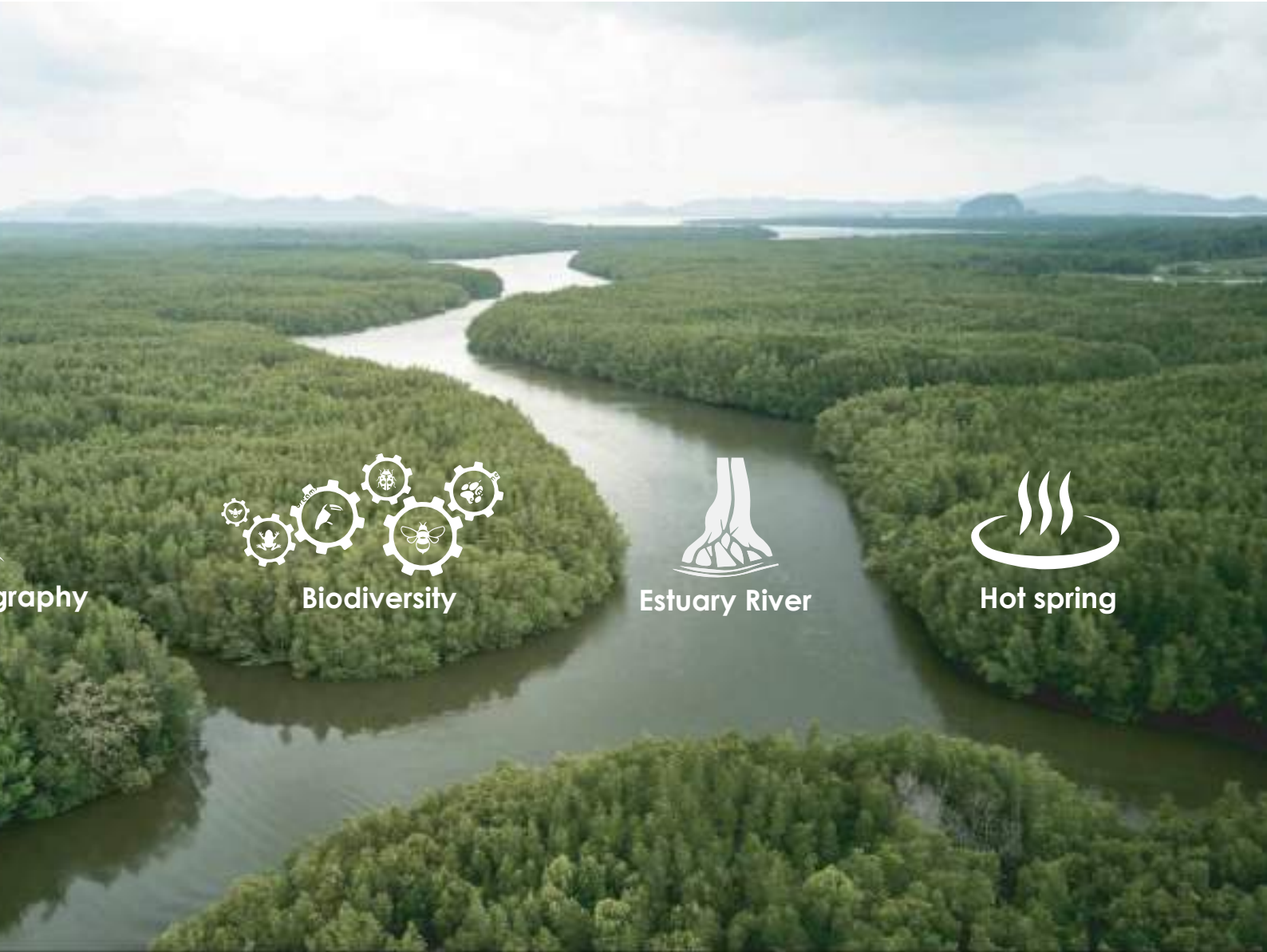

ography



Biodiversity



Estuary River



Hot spring



Waterpark zone

Commercial zone

Learning zone

**Three program zoning**  
All semi project inside the project



## Concept Diagram



### Krabi's environment

From main concept "WATER JOURNEY"  
 One of the beautiful character of krabi topography; **The estuary**  
 This inspire the design of the space and flow in the plot.

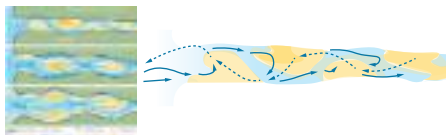

### Estuary topography

Topography; Analyse **the estuary topography character** the water flow and land meet to each other. Use this character for the design.

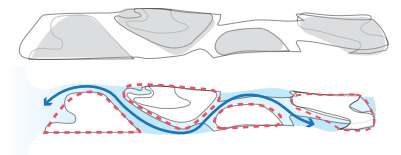

### The Flow and space

Topography; Analyse **the estuary topography character** how the water flow and land meet to each other. Use this character for the design.



## Learning zone

Area : 7,568 sq.m.

From Masterplan this plot is connect to the main entrance from main road so this plot is like welcom plot for visitor. Learning zone create for support visitor from outside. Almost of function are public open foe support all-day activity or member who live inside the project.

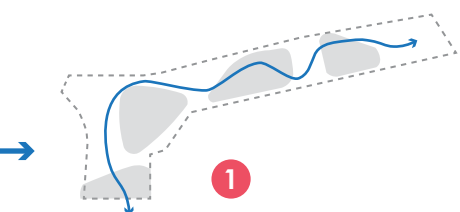

### Program and position

The position of the program and the space inside this plot was inspired by the nature of environment of krabi's topograghy



**Learning zone**

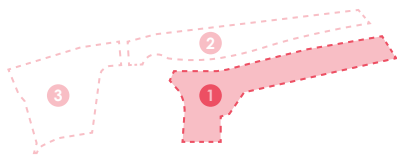

The welcome plot for the visitor where contain the visitor center(sale gallery) for group tha interested in the project also have the co-working space for digital nomad or member for work, class studio for parent who has kid in child care, and some outdoor activity like water playground and semi-farming where connect with the Medical plot.

**Learning zone**

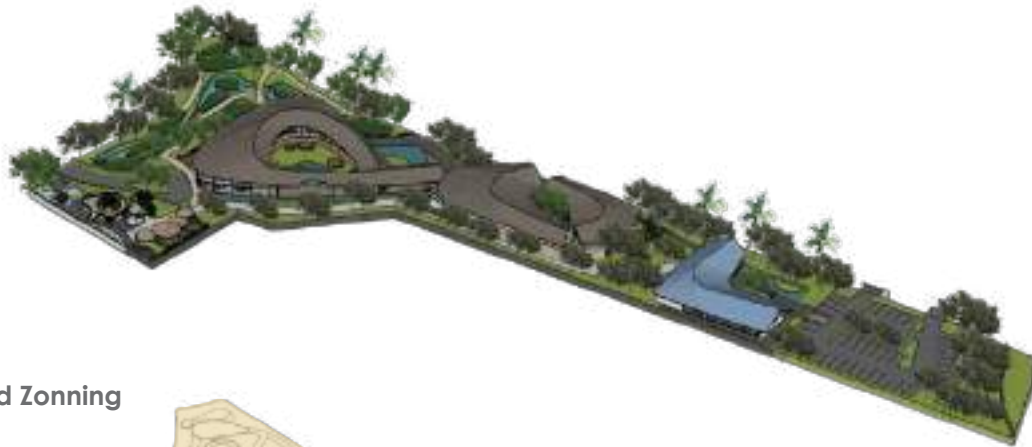

**Program and Zonning**

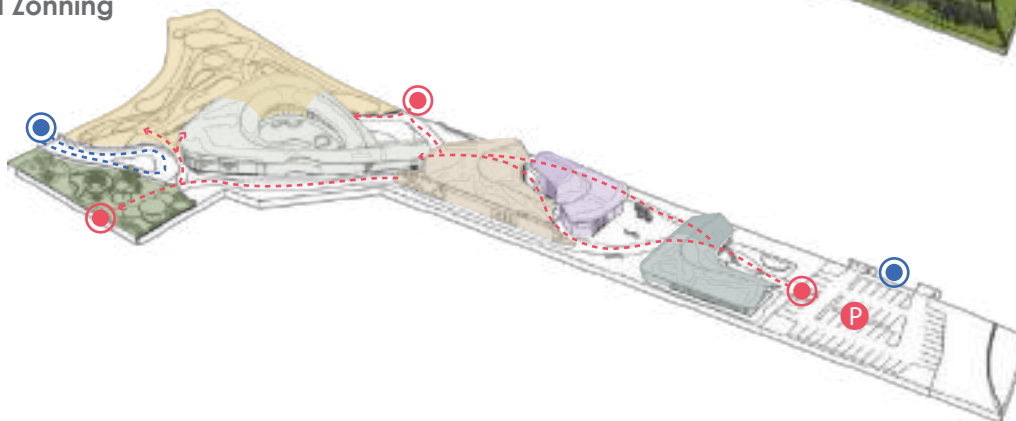

- Reception**  
Lobby area
- Cafe**  
where for support the parent
- Child care**  
Nursery/classroom for kid
- Sport zone**  
Mini golf course/Golf club/Indoor hiking
- Visitor path**
- Entrance**
- Parking lot**  
46 cars
- Studio**  
Could Kitchen/Open class
- Co-working space**  
Studio/Classroom/Workshop
- Outdoor water playground**  
Activities yard for kid + Farming
- Visitor center (Sale gallery)**
- Vehicle path**
- Vehicle Entrance**

Second floor plan



**Child care**  
conect path from lab to theater



**Meeting/ Showroom**  
conect path from lab to theater



**Golf club**  
conect path from lab to theater

First floor plan



**Entrance path**  
conect path from lab to theater



**Cafe & Co-working space**  
conect path from lab to theater



**Visitor middle courtyard**  
conect path from lab to theater



### Concept Diagram

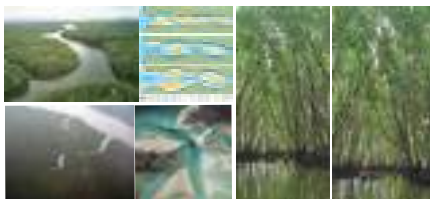

#### Krabi's environment

One of the charm of the krabi's environment is the Mangrove forest which full of beautiful abundant of tree.



#### Krabi's mangrove forest environment

The beauty of the environment where local people living with is the one that I want to represent this charm to traveler/tourist.



#### Camouflage

To generate the program to hamonize with the nature folloe the topography character.



## Commercial zone

Area : 9,829 sq.m.

Community and shopping area for the project. The aim of this plot create for the shopping activity also connect to the local activities at the outside of project be the place for hang around and experience.

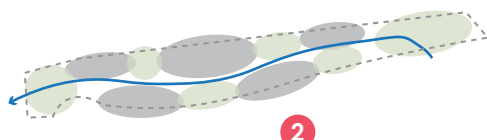

2

### Program and position

The position of the program was inspired by the nature of environment of krabi's topography combine with the camouflage concept to blen the program and building with the nature.



### Commercial

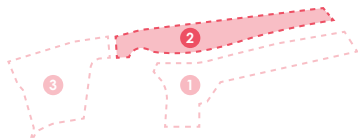

Character of this zone is has the river line at the middle of the plot come along with the building for give visitor can experiecne and feel the atmosphere of mangrove forest; from the topograpy that inspired

### Learning zone

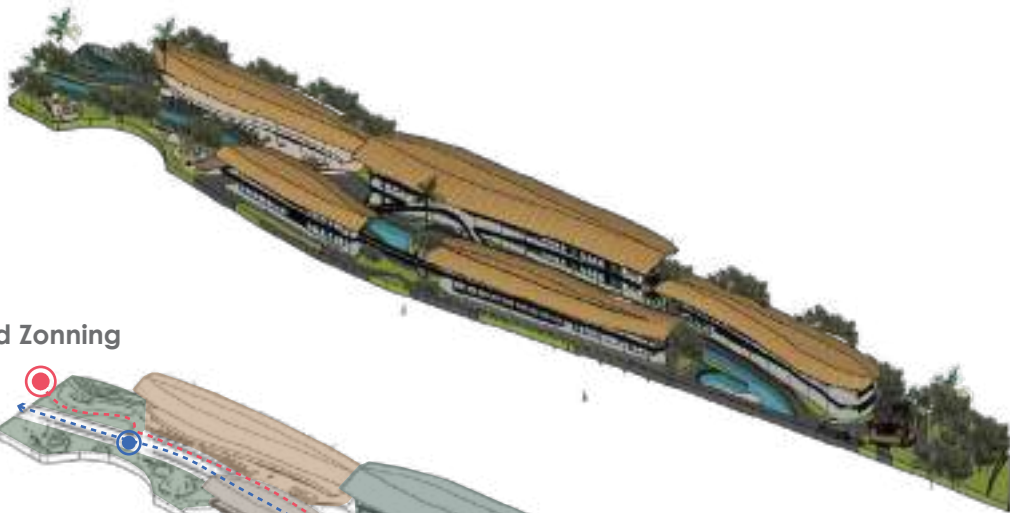

### Program and Zonning

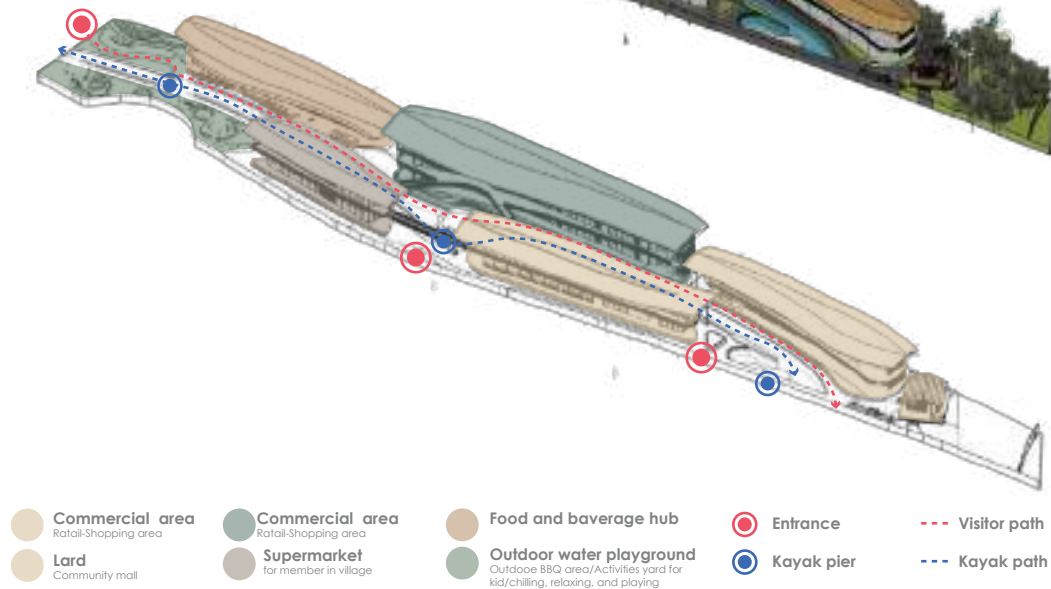





**Third floor plan**



**Second floor plan**



**First floor plan**

From Masterplan this plot is connect to the main entrance from main road and for support the visitor who come by their own `There has the parking lot for support the visitor



**Supermarket-Health hub**  
at second floor

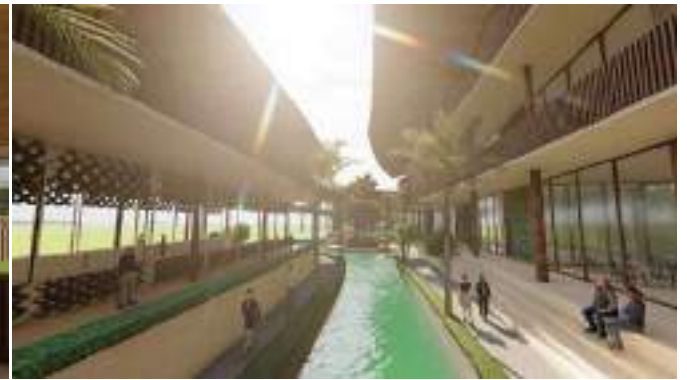

**Retail open market**  
Lard (community booth)



**Outdoor BBQ area**  
infront of food hub and next to supermarket



**Mini kid playground**  
Chilling area between recreation area and food hub



## Concept Diagram



### Krabi's mangrove forest environment

The beauty of the environment where local people living with is the one that I want to represent to traveler/tourist

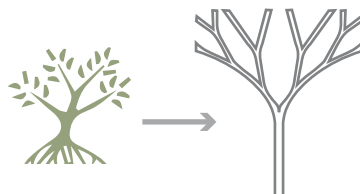

### Character of mangrove tree

Use the character of the tree for the



### Pattern

Apply the pattern to use in design



## Waterpark zone

Area : 20,048 sq.m.

Active recreation space for relax, play, and exercise the program in this zone create for support the Active water activity; hot spring swimmonf pool, water sport, artificial sea, Water relaxing; Onsen, and Recreation space, arcade, game&sport simulator, cafe, and mini-theater.

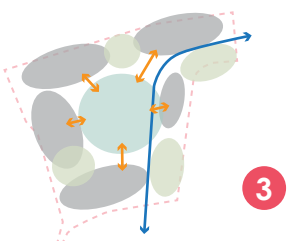

### Program and position

Generate main program at the center of the plot to connect the other easily.



## Waterpark

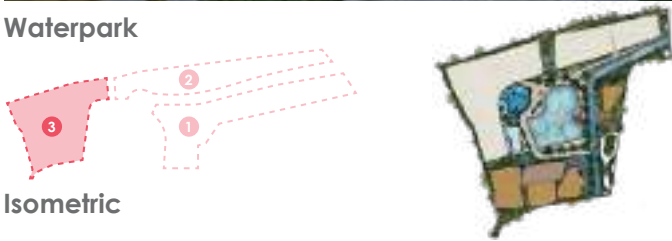

## Isometric



This plot has the river line continue from the commercial plot the visitor can continue kayaking from plot to other plot. Main activities of this plot is water activities both of indoor and outdoor. This plot also contain other recreation activities support every generation and family.

## Three main building



1 Swimming pool + KTH Seaside



2 Recreation space



3 Salt hot spring onsen

## Program and Zonning

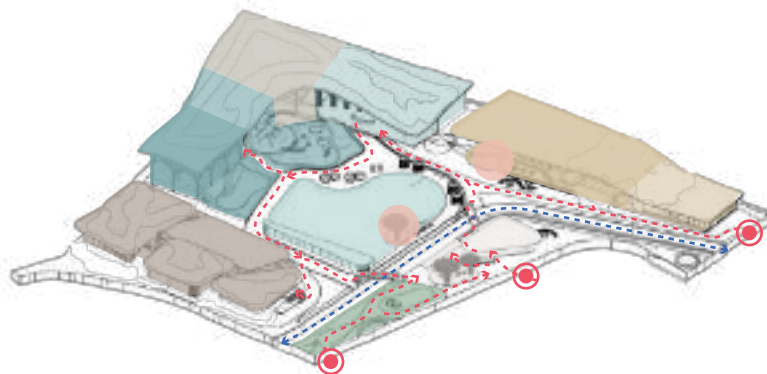

- Recreation space  
Arcade
- Waterpark  
Reception/ Changing room
- Waterpark  
Indoor and outdoor adult pool
- Waterpark  
Water sport / Flow rider
- Bar  
Poolbar/ Semi-outdoor open bar
- Park
- - - Visitor walk-in path
- Recreation space  
Sport and Game Simulator/ Mini-theater
- Waterpark  
Kid pool indoor and outdoor water playground
- Waterpark  
KTH seaside
- Onsen (salt hot spring)  
private/public onsen
- Reception
- Entrance
- - - Visitor Kayaking path



First floor plan



Second floor plan



Recreation space

Program next to the commercial zone



Sport and game simulator

One of many programs inside the recreation building



Salt hot swimming pool

Indoor adult pool next to kid pool and KTH seaside



Salt hot swimming pool

Indoor adult pool next to kid pool



Reception and Changing room

conenct path from lab to theater



Onsen

Plubic and private

# 2 | Food and agriculture

37/1 Khlong Mon-Wat Bua Pan, Thung Khru Subdistrict, Thung Khru District, Bangkok 10140  
 Thesis Project  
 Area : 6,347 sqm

REDUCING OF GREEN AREA IN BANGKOK

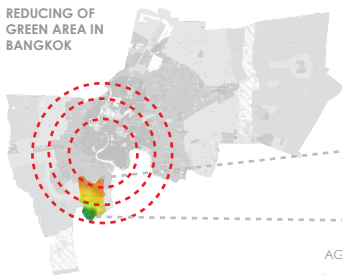

**THUNGKRU District**

Thung kru district is the one district that green area is rescuing

Located at Green Land use area in the past, the area of Thung Khru It is an open plain, lowland with many water sources. suitable for cultivation People are engaged in agriculture, gardening, and are skilled in basketry.



Historical of landuse



Along the canal lifestyle



Agriculture



Orchard

**AGRICULTURE ISSUE**



**FOOD SECURITY**

Contaminated food and food security  
**Food supply chain**  
 Deliver the product from farm to the consumer are using time and take many steps before arriving to the consumer which makes food product is got more contaminated and wasting.



**Super food & Food supply chain transparency to personal food supply**

Consumers have begun to focus on nutritious, standardized, safe and clean food and some have even started small-scale farming in the city.



**Social Structure**

Social structures that tend to be more about health, well-being and safety.



**Work-life balance**

Since lockdown situation make everyone daily life changed



SAFetist farm The sustainable agriculture lifestyle, Model of Agriculture community and learning resources for agriculture community and consumer for agriculture community and consumer

**SAFetist farm: Social enterprise model**

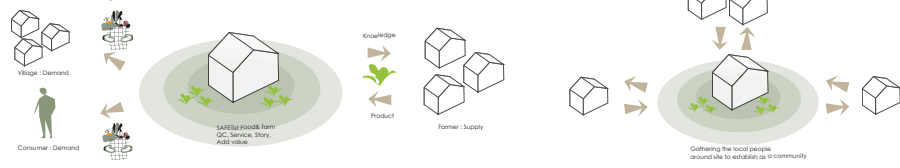

**Now**  
**Start**

All first is for find the place far produce the safety food for themselves and friend next when farm start to stable and enough for them then expand to another and develop to the business which can support they and community

**Agriculture**  
 Organic vegetable farm.

**Food**  
 Source of organic food. Food security.

**Learning**  
 Place for everyone and every age can come to learn or exchange knowledge about agriculture, activity which close to the nature and lifestyle along the canal.

**Tourist Attraction**  
 Ecotourism of the agriculture and lifestyle along the canal the spot of nature attraction and activity which close to the nature.

**Community**

Gathering local people around site to establish as a community for supporting from government organization. Onsite be the model of community which gathering different style of people but have the also - Be the model of the community.  
 - Develop and support each other in term of agriculture and exchange the knowledge.  
 - Support the local product and business  
 - Develop to Green economic  
 - Develop a community based on 3 things that the community already has.  
 Traditional way of farming having knowledge from farming way of life along the canal

**SUSTAIN DEVELOPMENT**  
 Green Economy  
 Sustainability of food, farm, and community enterprise  
 New model of the community. Environment friendly

Now around site area still do the agriculture and have the lifestyle along the canal.

# CONCEPT

All program and function are connected and related with the farm area, be like the farm area is intermediary which link every part together the activity and living area. Harmonize every part with nature and farmland.



Co-Living/sustainable living

Agriculture/Farmland

Activity



Create the place where people can access as an organic food resource and a natural traveling attraction for relaxation and education. The place represents a new agricultural lifestyle, in term of life sustainability and the preservation of agricultural lifestyle. This place supports the fact that local people are living in harmony with nature.



Place where people can access directly through the organic food resource



The nature travel attraction for relaxing and learning resource for children



Represent another style of agriculturist life-style; in term of life-sustain, new model



Conserve the agriculture occupation and community economy/ society in area.

## Life-style



Life-sustain, Self-reliant



Along the canal lifestyle



Produce food by their own



Management create alternative energy: Biogas, Solar energy, Water treatment

## USER & PROGRAM ANALYSIS

Onsite member



Safetist farm member



Volunteer

Time:



Character: Living at site  
Take care the Farm and business

Visitor



Tourist/Visitors  
Everyone and everyone



Children in community



Organization



Local people

Time:



Character: Come to visit, learning, playing, Relaxing, and Shopping

In addition to being a learning resource for children a prototype of a sustainable lifestyle

**Boat trip along the canal**  
Supporting local product and organic food

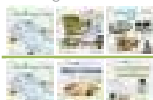

Wasted and Food wasted management  
, Separate waste, zero waste

**Agriculture along the canal lifestyle**

Organic food and farm  
Fertilization, Enzyme fermentation product from fruit

**Co-living** Reuse, recycle material represent life sustain with agriculture



**Alternative energy**  
Biogas  
Reuse wasted water  
Solar system

Farm activity, planting, exploring farm and nature, kayaking, Chick&Duck

## Various safetist farm projects under green economy concept

**Co-living** Lead and gathering local people to set up community for government support develop economy of community. Model for community



**Agriculture along the canal lifestyle**

Organic food and farm  
Business: Safetist basket, Farm visit

**Learning through experience**

Planting, training event, fishing, cooking, kayaking, exploring, etc

**Tourist attraction**

Natura attraction for urban people. Farm visit and Farm business



**Farm system**

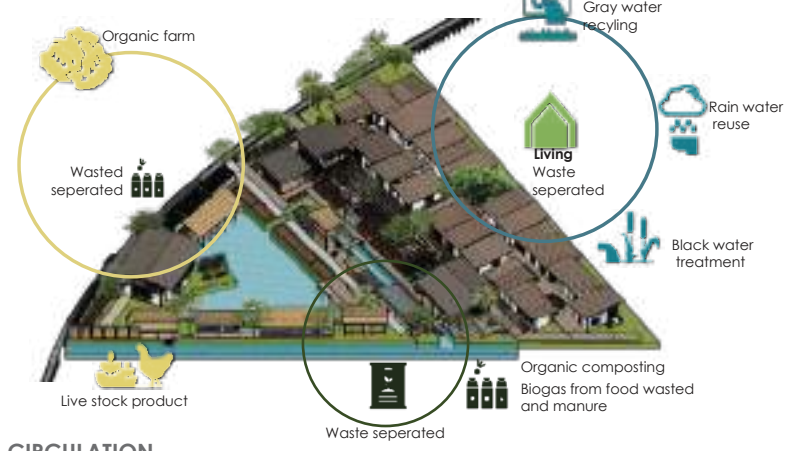

**Farm zoning**



**CIRCULATION**

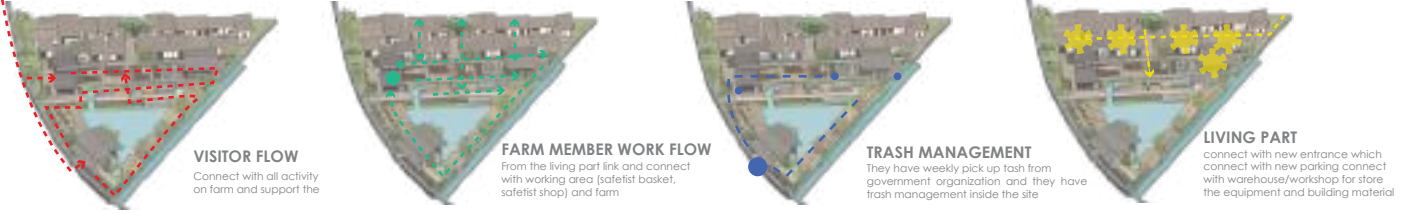





### Co-Living Concept



### Co-Living Requirement

- Share common space together, different style of people living together
- Build according to the user
- Focus on outdoor space to get people to come out and do activities rather than staying in the house.
- Combine between new and reuse materials

**Keywords:** Local material/ secondhand material, eco village, represent along the canal lifestyle, flooding area, and self-build.

**Unit type:** According to the member who gathering and living together, the number is 30 members  
 20 Housing; have three family (3-4 member/house) and seventeen single members.

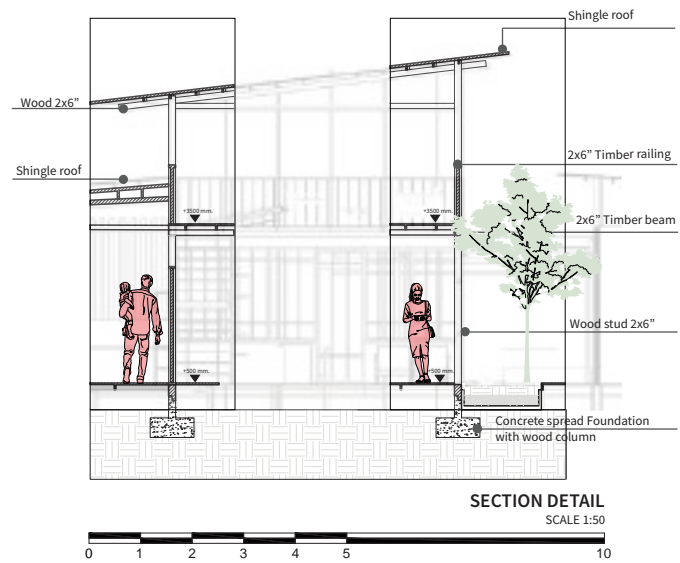

# Re-imagine Hua lamphong 3

**Hua lamphong** ; Rong Muang, Pathum Wan, Bangkok 10330  
 Fourth Year Project  
 Total Area : 171,330 sqm.

Re-imagine Hua lamphong divide on four member



From collecting data for site analysis the area around Hua Lamphong Railway Station shows that the area around Hua Lamphong is mostly communities and schools. Most of the people around Hua Lamphong are students and local vendors.

As reflected to our concept " TO TRAIN " meaning for training in order to training the local vender in that area to be more good potential in business term and want to providing space for training and give the knowledge for students. In the other hands another " TO TRAIN" means to commemorate Hua Lamphong is the first train railway station in Thailand



**PROJECT : COMMEUNITY CENTER**  
 BLUR BOUNDARY  
 CHIDCHAYA DETCHALOEMWONG



**PROJECT : LEARNING CENTER**  
 Reimage Depot building  
 SUTHIRA TUPHAVE



**PROJECT : COMMERCIAL ZONE**  
 Reimage outdoor plaza next to HLP station  
 NATTAPUT PANUWADAHRD



**PROJECT : TRANSITION SPACE & RETAIL**  
 RE : BORN HLP  
 PLOYPIM MEKPHAT

## CONCEPT : TO TRAIN

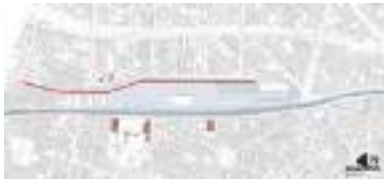

CONCEPT : In past Hualamphong have been important with people around site and be like center of civilization, when the train came they make the business around sit grow up that attract many people, then they have many grow around site also school and university and around this site connect with travel spot to attract all traveler and student for hang out, They use HLP to pass to other.



Learning center : from many school and university around site(also for the other student who come with train) we decided to create the learning center at the middle of site for BIS student and student from the outside, and at the middle they can link to the material district(wongwain 22) for their project



Learning space : for the middle to back of site will be education hub Interchange space : for the middle to front of site will be education hub Axis point of our program & linear gallery The program that start with the BIS school for people who want to start their own business can learn and start from this school and we are also have learning center for support their research and product have exhibition hall be the space that student can show their work and event in head part we make to be like retail for people who pass



Learning space : for the middle to back of site will be education hub



### New Building

Learning center, Workshop, Fablab, Digital/Audio/visual Lab Studio, Research area

### Old Building

1. Depot Building 6432 sqm.
2. Police office



## DESIGN CONCEPT :

New learning center at HLP we want to be the space that people can use for think, work, and train or practice new skill by this place can support every activity and each activity can interact to each other. This learning center will support the new program like BIS or DITP which is the study program for who interesting production with business.

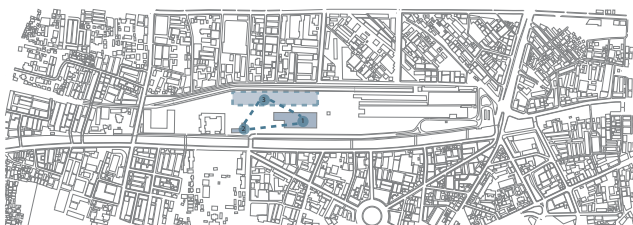

Form of new building



Form of depot structure

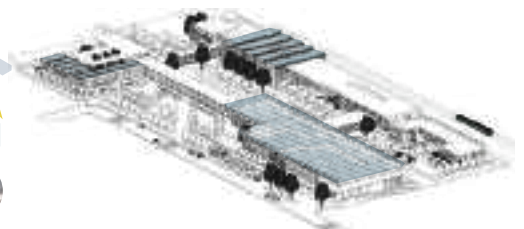

## HLP Learning center part

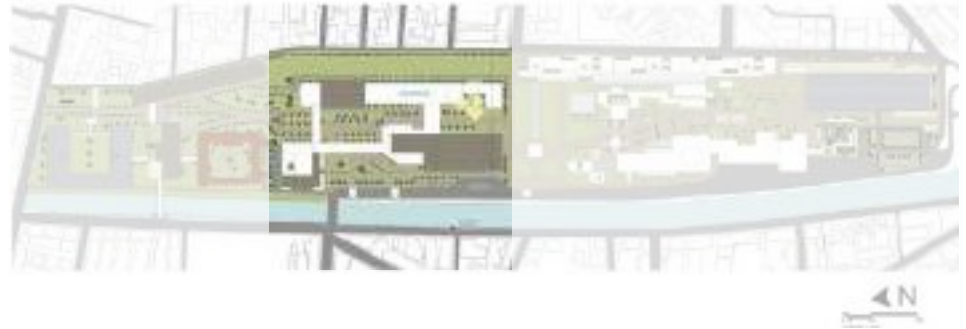

Place to support student from BIS School and other student who came to use , be like place to think, learn, work and facilitate different type of learning with interaction between activity include function like workshop, studio, idea/Fab lab, technology for production of their project and exhibition area for show case student project. Also convince to the community around site that they can bring their work/material to promote and show inside the space also sell them in material store for outside people and teach them in workshop area this program inside the building will support all of student, outside people, people in community to grow up together.

## Program

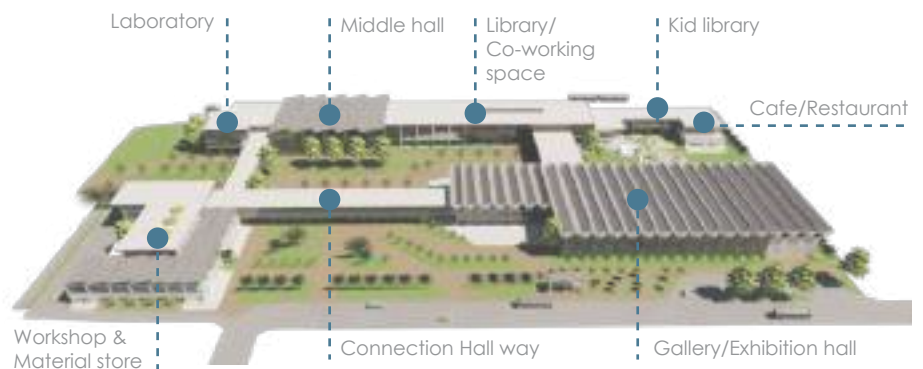

### FROM TARGET/ USER

BIS School

### Activity

Do Research  
Work on their project

### Program

Library  
Computer/Internet  
Media Lab

SCHOOL/COLLEGE student

Study/Learning  
Working space

Fab Lab  
Workshop

Start up

Working space

Design studio  
Audio/Visual Production studio

Company

Rent office  
Work

Meeting room  
Auditorium  
Theater

Worker/Officer

Work

Technology Lab  
Digital Learning Lab

Traveler/Tourist

Hangout travel

Gallery  
Exhibition hall

Family with Kids

Rest/Learn

Kid out/indoor space  
Kid library

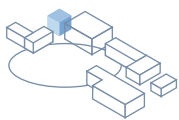

**Laboratory Space**

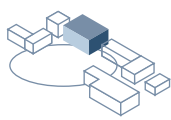

**Middle Hall**

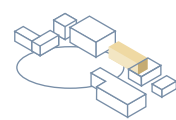

**Learning Space**

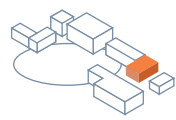

**Co-working space**



**Learning Lab**  
Learnind and laboratory space



**Outdoor courtyard**  
Middle outdoor green space for hangout



**Co-working space**  
This zone are connect with the gallery



Outdoor green space



**Middle Hall**  
Middle area between the learning lab and theater



**Middle Hall**  
for gathering space can see the train track railway



**Co-working space**  
The area for working, reading, and learning space



for gathering space can



**Reading space**  
conenct with the bridge to workshop



**Reading space**  
conenct path from lab to theater



**Theater**  
This zone are connect with the gallery



Connect with

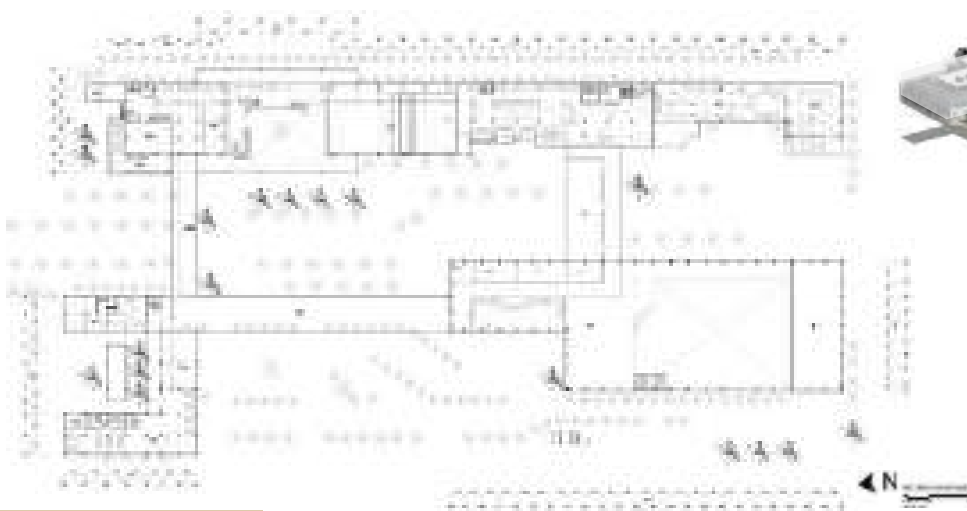

**Second floor plan**

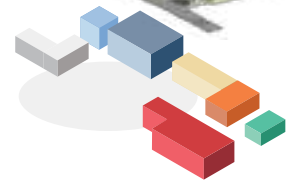

**Isometric**



**Laboratory Space**

Computer/Internet  
Technology Lab  
Audio  
Visual Production studio  
Digital Learning Lab



**Middle hall**

Connection part between Lab  
with learning space



**Learning space**

Design studio Co-working space  
Theater Classroom  
Gallery Meeting room  
Library Auditorium



**KID ZONE**

Kid out/indoor space  
Kid library



**Chill out/  
Hang out space**

Restaurant  
Cafe

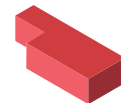

**Exhibition Hall**

Exhibition hall



**Workshop/Fablab**

Media Lab Wood Workshop  
Fab Lab Plastic Workshop  
Material store Working area  
Printing room Rooftop  
Metal Workshop

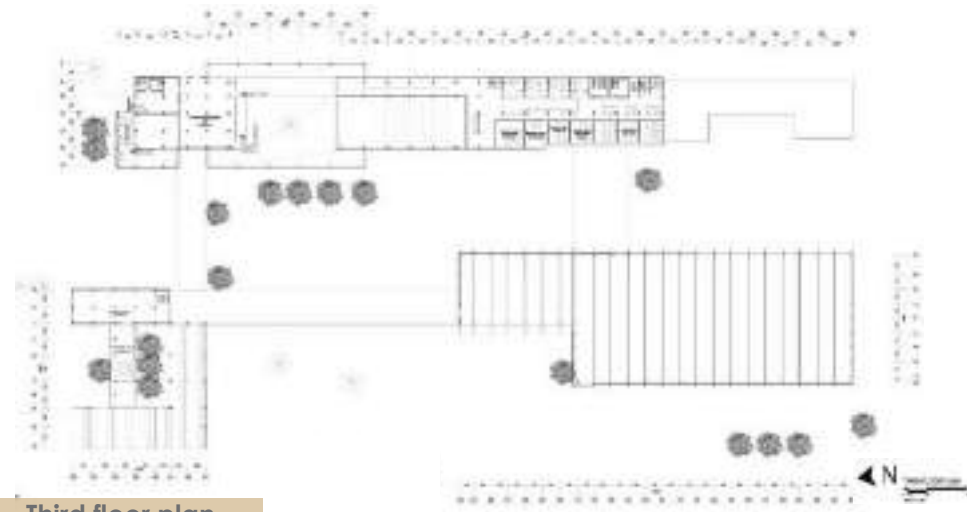

**Third floor plan**



**Kid zone**

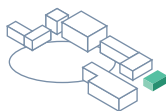

**Chill/  
Hang out  
space**

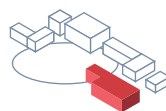

**Exhibition  
Hall**

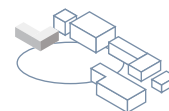

**Workshop/  
Fablab**



**Outdoor courtyard**  
for kids outdoor activities



**Outdoor courtyard**  
Middle outdoor green space for hangout



**Exhibition hall**  
Space for exhibit the artwork or project



**Meeting room**  
For meeting



**Kid Library**  
see the train track railway



**Connection path**  
between art gallery and co-working space



**Front connection path**  
Space for exhibit the artwork or project



**Front terrace**  
Relaxing space



**Middle path**  
with the other part of project



**Cafe & Restaurant**  
the relax and waiting space for parent and family



**Bus stop**  
New bus stop in front of art gallery



**Workshop**  
The ground floor workshop space

# 4

## Multipurpose building

Multipurpose building bangkok

Summer course Project

Area : no require

The project is use for studying the revit program. Work on group.

Levit program (summer course)

Studying to draw plan, build up 3d, section, detail section untill manage the information into the paper





Additional from architecture drawing which there also have another detail like; units plan, detail



The section of the building on the layout

The section of the building on the layout

Plan, section and iso  
cafe program inside

## Exterior and Interior perspective



**Drop off**

In front of the building near by the cafe



**Reception**

Front reception of the building



**Cafe & restaurant**

At ground floor next to co-working space



**Terrace of unit**



ail section, 3D building of design furniture or decorated furniture and facade

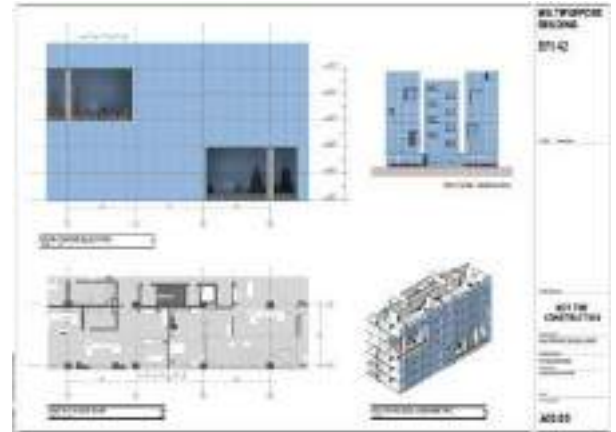
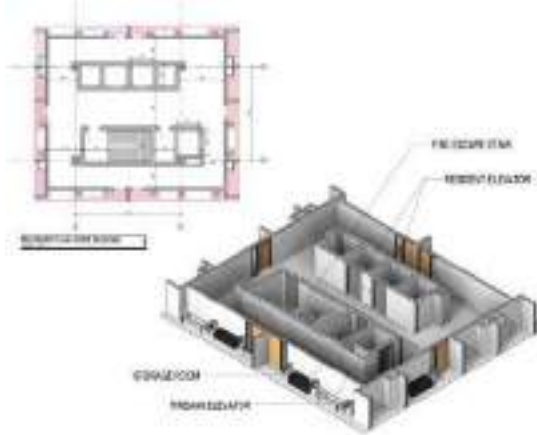

ometric section of the the building.

Main stair and core lift of the building with isometric section

Plan, Elevation and isometric section of unit.



**Retail**  
Retail/shopping area



**Co-working space**  
for visitor at ground floor



**Rental Office space**  
The relax zone for member



**Library**  
Space for member

# Bio School

School of Architecture and Design 2050,  
Bangkhuntian

49 Soi Thian Thale 25, Bang Khun Thian-Chai Thale Road,  
Bangkok 10150  
Third Year Project  
Area : 10,000 SQ.M.

Bio school project is the project that we look forward in the future of architecture school that what should be in next 50 years by use the biomimicry in design and create them by grasshopper we study and also design the curriculum to manage the program in the building.

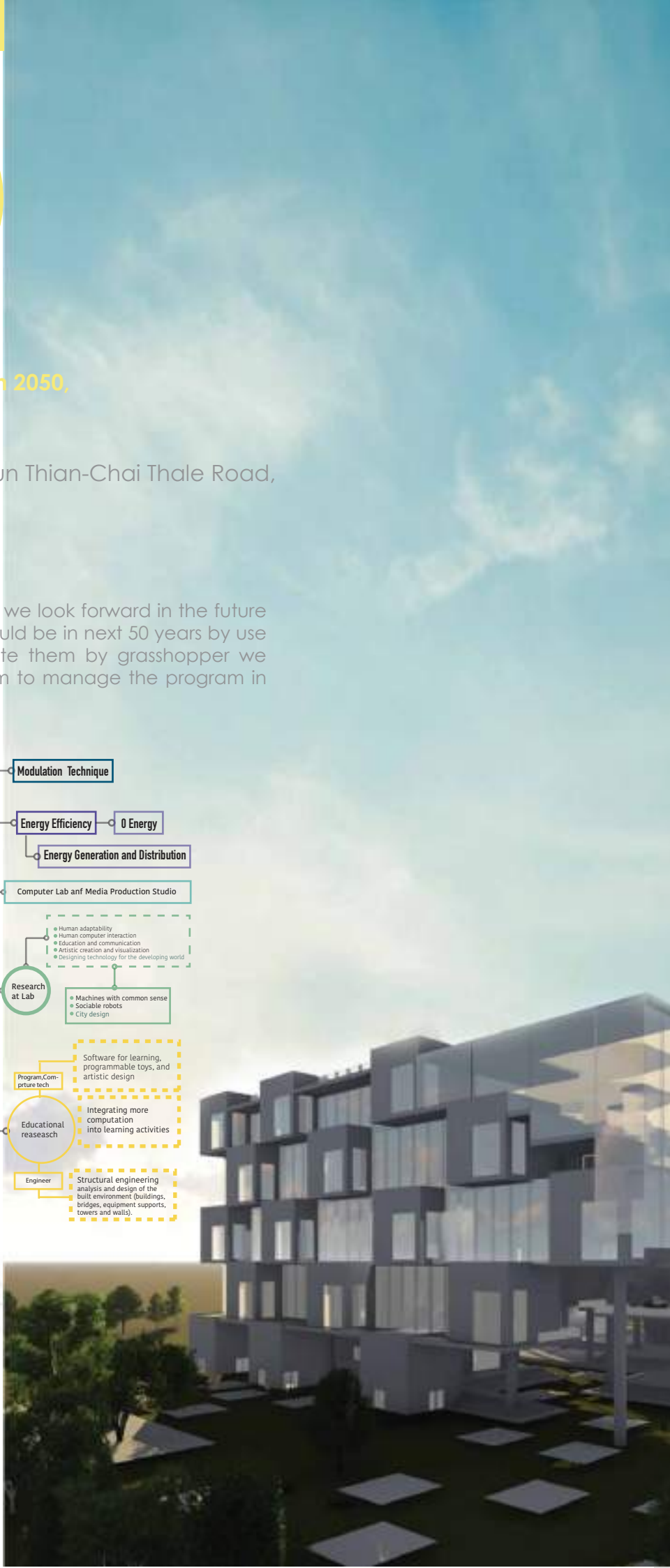
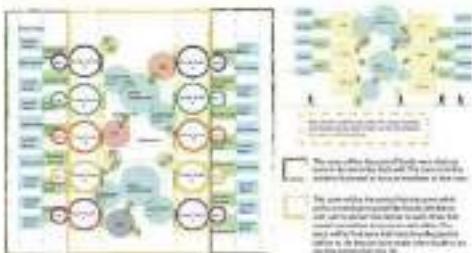
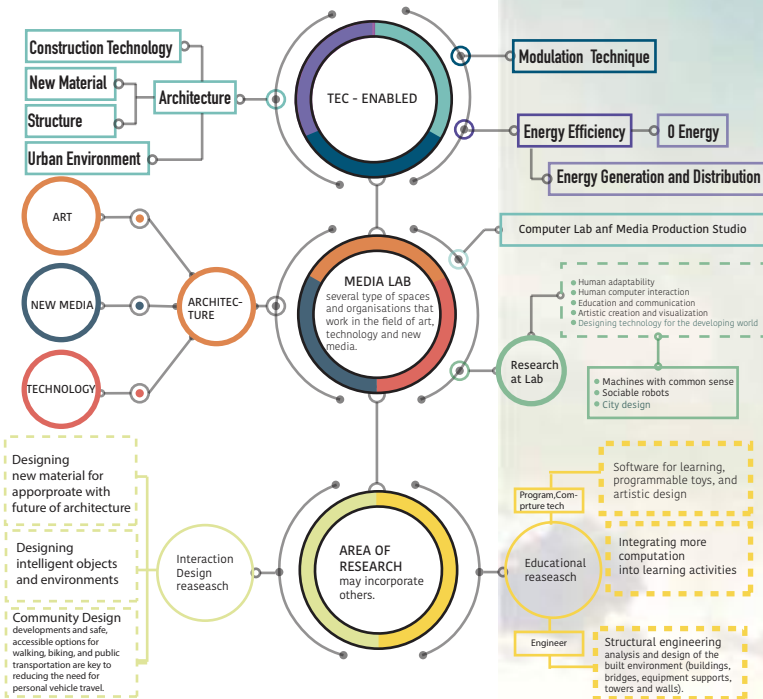

## ARCHITECTURE SCHOOL DIVIION / VISION

In the future, Technology will become more important and necessary for living life. The invention of new technologies are create for support convenience of living. In term of architecture do not have just architecture or building but include environment. Technology for architecture shoul add technology in cuuricury for develop architecture for respond environ-ment or involve material or construction for support architect in the future.



## BIOMIMICRY : Chameleon structure of colour changing

Chameleons can quickly change their appearance in response to tempera- ture, environment, and mood. The identified a key factor in their ability to do this: The chameleon can "TUNE" the distances between nanoscale crystals in their skin that reflect light, creating a spectrum of colors by focus on structure of cell that affect the result of color changing.

Cell Movement (color change)



3 Layers of cell under epidermis

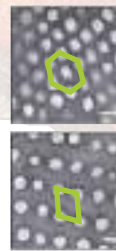

Cell moving when their emotion change

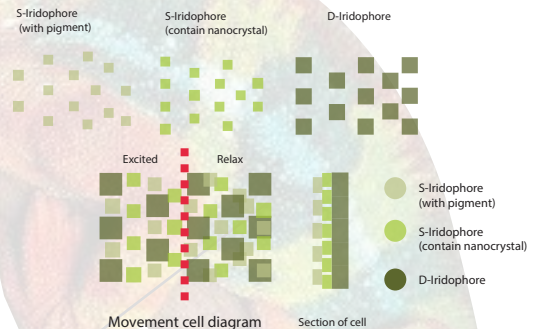

Decode the moment of cell moving to show how they generate and change distance between their when their emotion change. Show how different between cell in each layer and show charactor of all cell when they combined together and have function of each layer which coatain cell that work together to reflect the light out when their changing color. When the light come in the distance between will reflect and absorb some color of light make some color reflect out and mix with pigment of top layer will show the color at skin. Working together like architecture with each lab to create new technology for support the architecture in the future

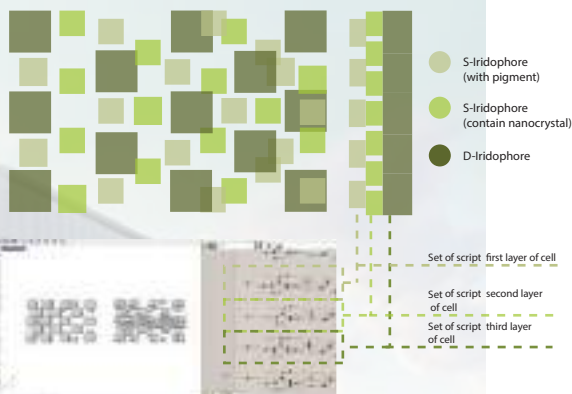

## Grasshopper script

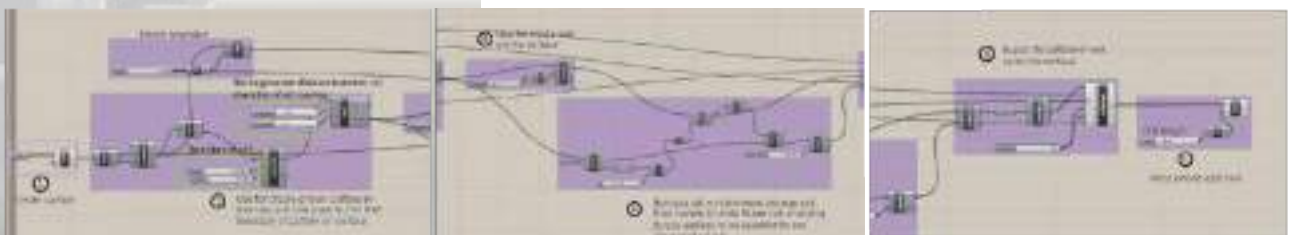



## Building diagram



New campus building at site with building context that divide zone follow activity (active and relax) which excited (old campus and laboratory) and relax (Dormitory and Open area near outside of campus)



Create axis that divide in two part follow zoning before to use in biomimicry logic (Movement of cell follow mood of chameleon).



Biomimicry of cell moving that move follow the at-tractor form site and put the layer of cell to create the form of building



Lift it up to open space under the building and create new path for let student can walkthrough to the other building, and create new gathering area for student and make they can see activity in side.



Final outcome which be the new campus at site that have program and function from curriculum that join together .

Form side analysis

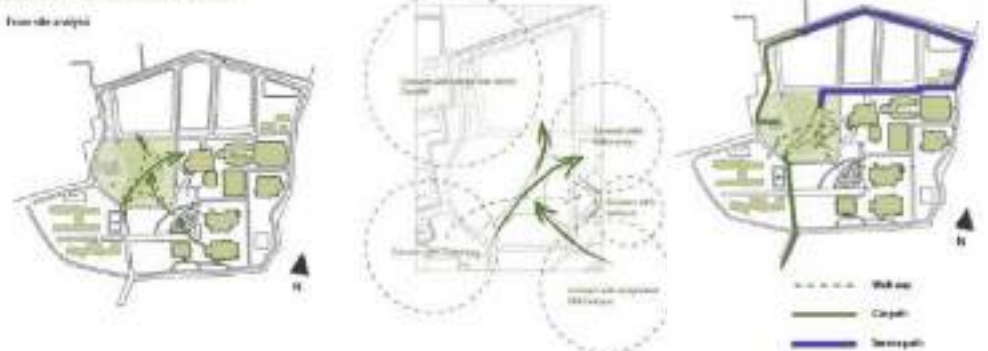

## Building program

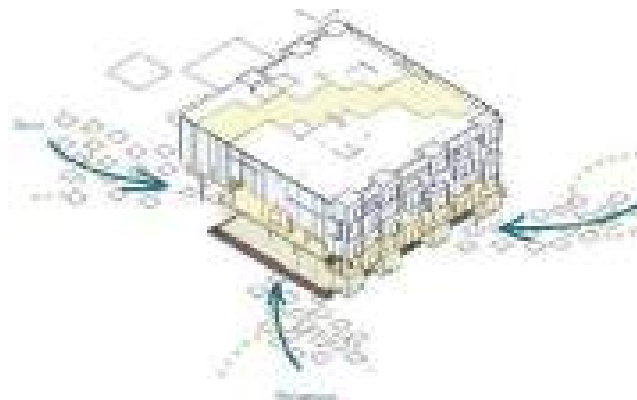

## Axonometric



- Lift and stair from underground to first floor
- Lift and stair from first floor to fourth floor
- Room cell
- The middle hall area the area for student exhibition event





**MASTERPLAN**

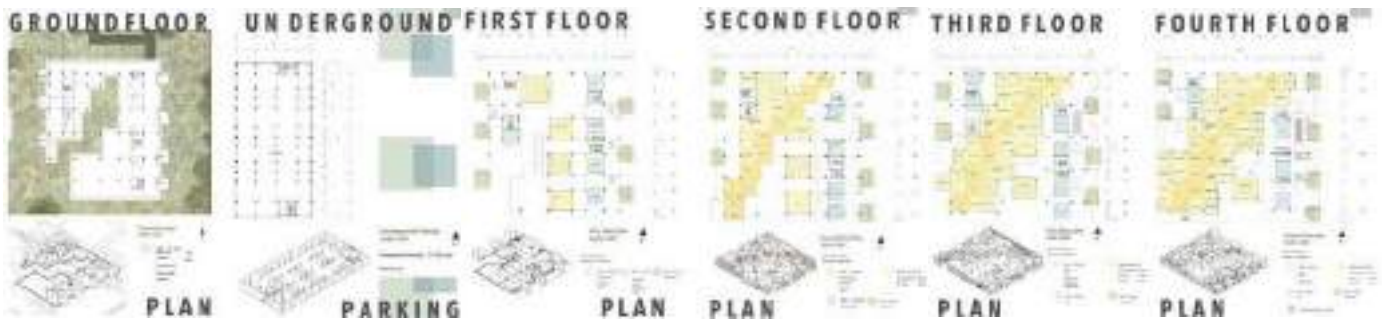

# C ommunity l tural and ontemporary Art Center



The Chaipattana Foundation and Suan Luang Rama VIII area  
next to Rama VIII Bridge Chao Phraya River, Bangkok  
Third Year Project  
Area : 12,000 sqm.

CCCAC project is the project that we learned to design the museum, gallery, art space include the public space for community around the site. We analyse the user, site, to create program and space for everyone.

The square shaped building was inspired from shape of the community building in order to preserve the characteristic of surrounded building. In additions, the new idea is added by using a shape of sphere to design our building and landscape in order to break out grid lines and to build the new route which makes people to experience freedom in the sphere of influence.



**ICONIC AT SITE**  
Rama VIII Bridge is icon of this location and have many community around this location.

**VOID AT RAMA VIII BRIDGE**  
From structure of bridge there have some void from sling that they use to hang the bridge. We use this point to play with our building design.

**FORM OF BUILDING**  
Create form of the building by use the character of the icon in context to get along and don't disturb iconic of the site.

**Fit with void**  
Perspective from ground will see the top of the building fit with the void from the bridge.  
The form of the building which follow with void from the bridge.

**PEOPLE AND COMMUNITY CONNECTIVITY**  
Use the museum to improve the connectivity of community with outside.

**NEW PLAZA FOR COMMUNITY**  
Cut off two side of building to make plaza for new gathering and activity area.





**DESIGN CONCEPT "FULLFILL"**  
 Combine from 2 conceptual model



**Sphere influence**  
 Use the direction of cycle of the sun path at our site to make the sphere shape to direct the space and landscape at site.

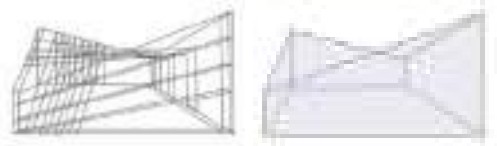

**Fit in**  
 The Rama VIII bridge inspires the idea of creating a shape that would perfectly combine with the shape of sling structure in order to the museum and the bridge from our building.



**CONCEPT "FULLFILL"**

The square shaped building was inspired from shapes of the community buildings in order to preserve the characteristic of surrounded building. In addition, the new idea is added by using a shape of sphere to design our building and landscape in order to break out of grid lines and to build a new route which makes people to experience freedom in the sphere of influence.

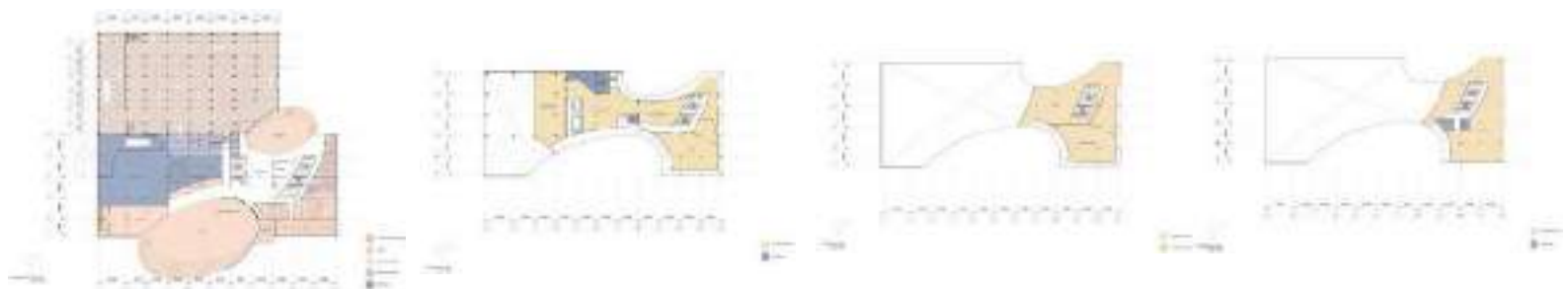
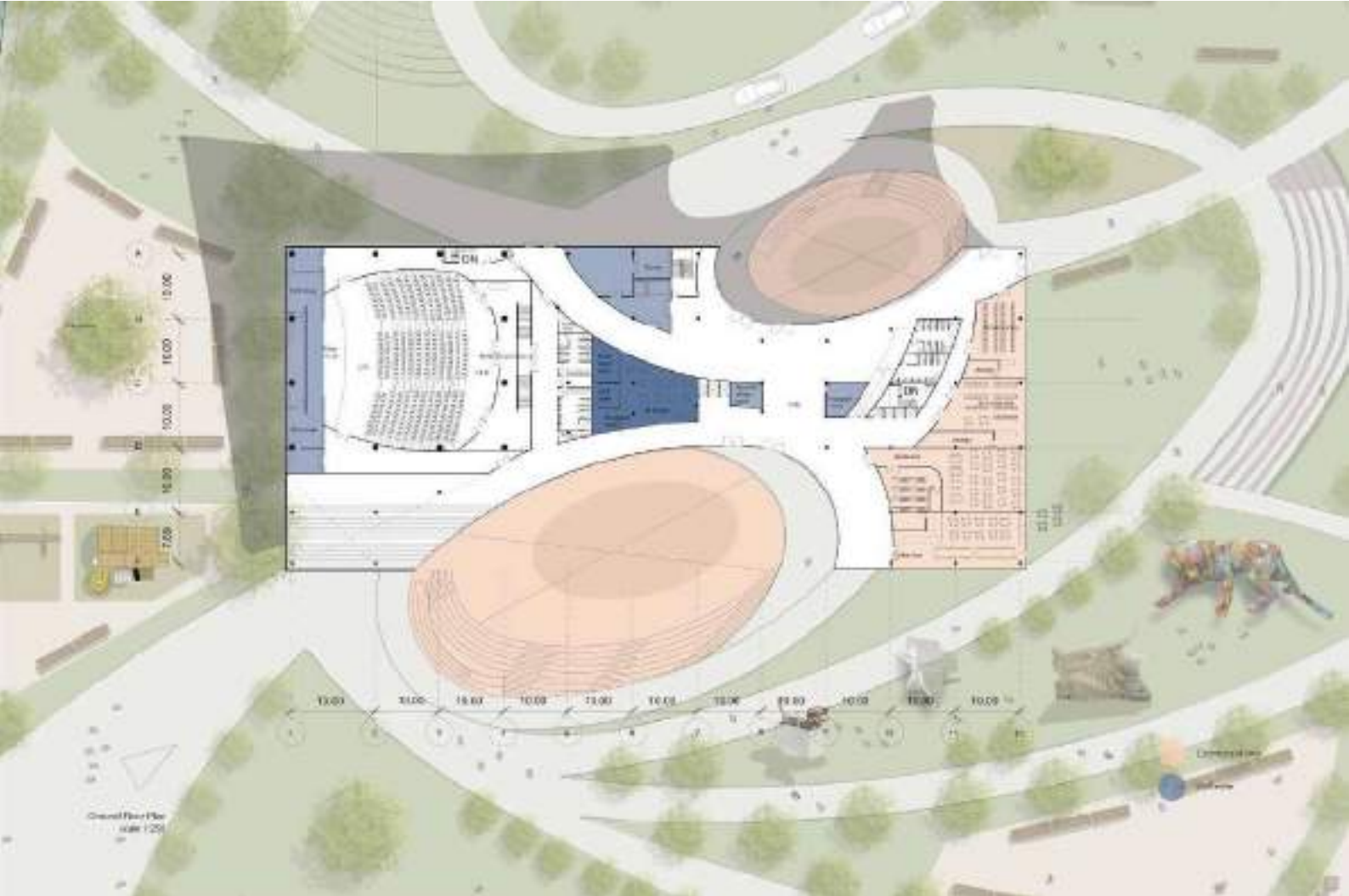

**Elevation**



**Interior perspective**

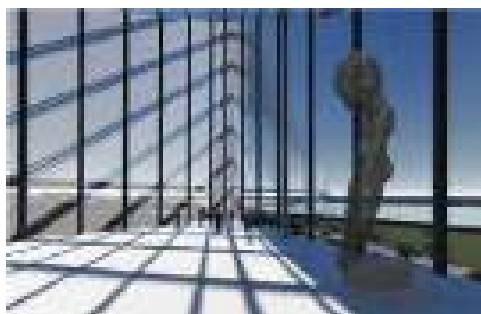

**Fourth floor Exhibition hall**  
The space where visitor ability to see the outside river and the rama viii bridge view.

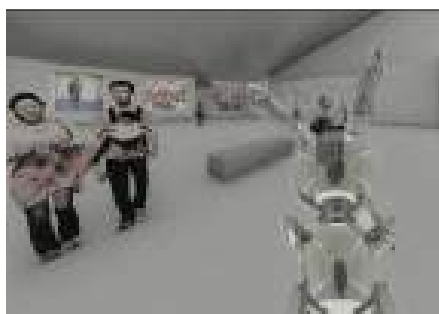

**Exhibition hall/Art gallery**  
The space where exhibit the artwork.



**Hall way**  
The ramp main path for visitor to pass to the other room and other floor.



# Axonometric

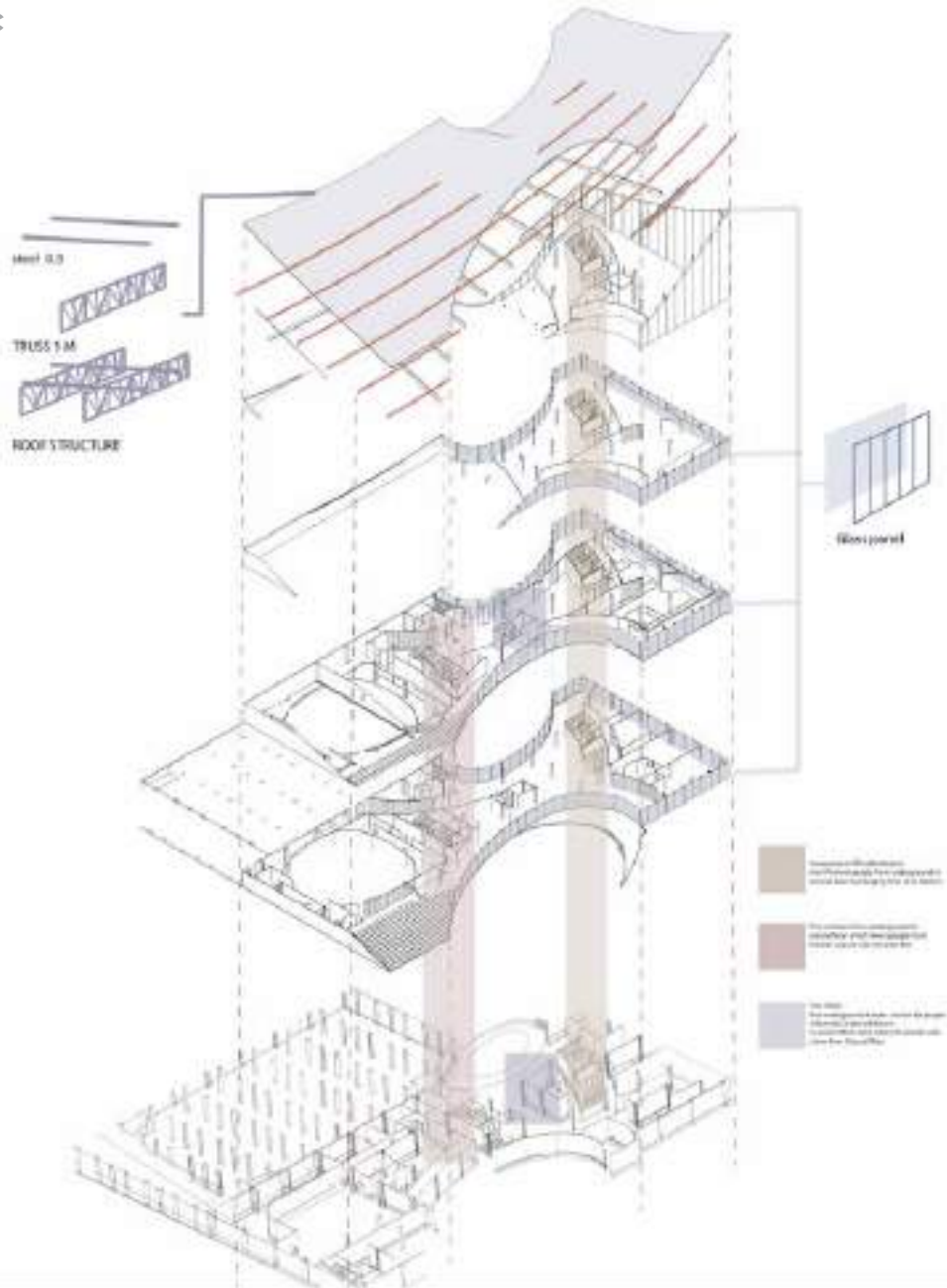

# The space



**Museum** Main building area is located at a center of our site we open underground and ground floor to be public space open for every visitor. The program are common for our community activity and be the gathering area for local people and visitor from outside.

**Outdoor plaza** The oval space in front of our museum that near the river it can be gathering area and it is the flexible area for program like outdoor exhibition, seating, gathering area, and concert.

**Parking entrance** From the back side where next of the community and the road behinds. This entrance are directly to the underground parking and suitable for the truck which contain the stuff for exhibit and service.

**Drop off** For the visitor who come by their car or service car the can entrance from the road behind access to the underground parking or drop in front of the museum entrance.

**Sculpture garden** The outdoor sculpture area for exhibit the huge sculpture or put some art event to lead people before the visitor got into the museum.



**Sport field** From site analyse we created the sport field for support their need located at the walk entrance side. The visitor can access to the field easily and not bother the museum make this side be the lively area and nice welcome to lead people into side.

**Skateboard area** Nowadays this activity is become more popular and under the rama vii bridge we found people come to play a lot so we create this space for support and attract people. Be the place like suitable for practice and play even have some sport event at this place.

**Playground area** We have many primary school for kid around site so this playground area is for the activity space for children around us for they can spend their time and school can create the school event and activity here.

**Outdoor multipurpose yard: The Weekend market** The multipurpose outdoor yard in front of the river side not far from the walk entrance this area can use for any event and the weekend market activity; open the opportunity for local people or vender can join in our place.

**New Pier and outdoor amph seating/walling area** At the river side we create new pier for support the people who came from boat this is the route that visitor can join that other tourist attraction after finished visit the museum.



# 7

## Central Woman's Correctional Institution

Central Women Correctional Institution,  
Department of Corrections  
33/3 Ngamwongwan Road, Ladyao, Chatuchak,  
Bangkok 10900

Second Year Project

Area : 2,000 sqm.

We want to support inmate to improve by themselves by use green space and activity by use nature to create an environment for motivation mood and emotional also be the plantation area for train inmate to have occupation by activity.

To create the program that can help inmate can improve, take care themselves and have a job after they left from correctional, we decide to use nature and the activity like **hydroponic** to teach them. After they have ability to do something when they left.

This program also find therapy the inmate that they can done on something and got proud of themselves when it success.



## Inspiration of the development

We got inspire from circlelife of butterfly. According to research the important point for motivate of butterfly to process of improvement. The environment is important; nice, friendly, and atmosphere we generated the greenspace into every part of inmates routine lifestyle like work, relax space



## Zoning

- Inmate room
- Work Space/Plantation
- Middle courtyard

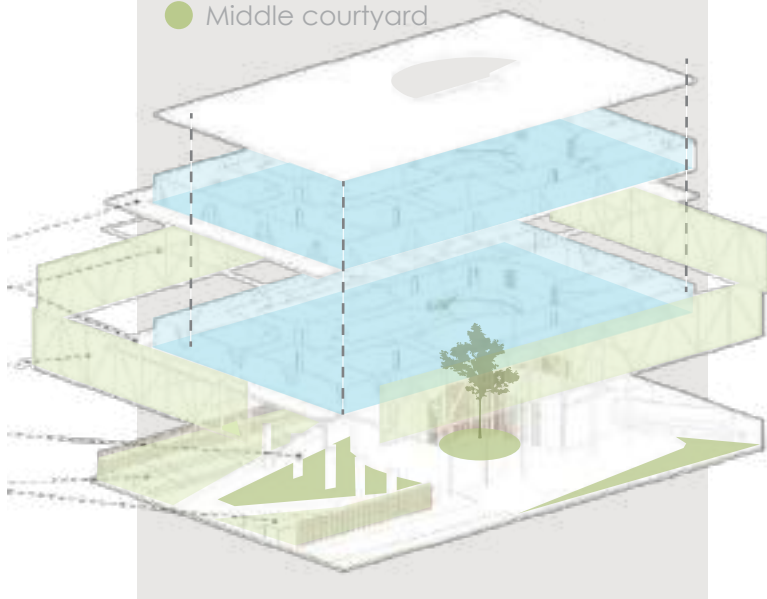

## Environment



## Activity

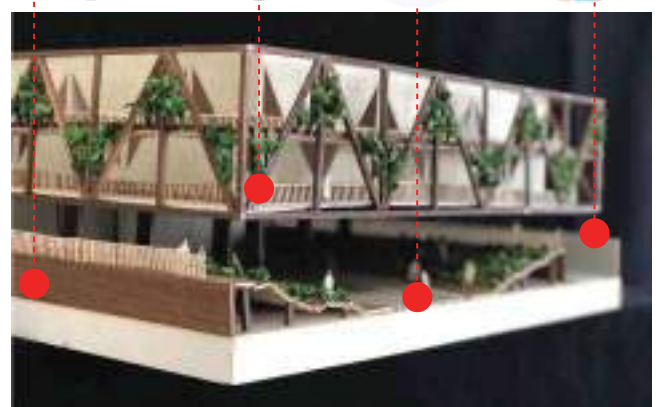
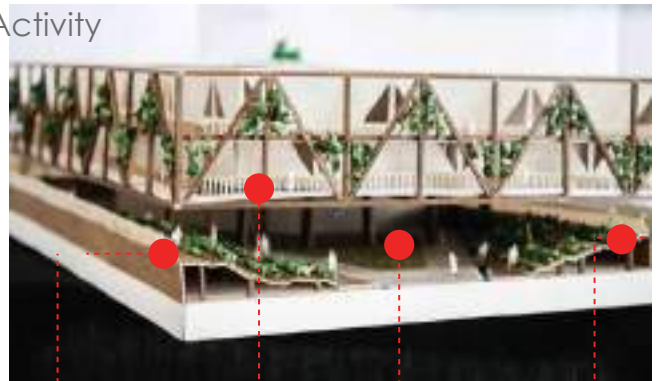

Hydroponic; the east adaptation planting for grow the vegetable which can use in collection and export to outside.



### Third floor plan

At this floor is contain 12 inmate's cell, 1 guard room, 1 bathroom and 1 locker room. Working area at the terrace outside is allow for inmates to work just daytime.

- Inmate room
- Work Space
- ⬅️ Exit to working zone

Inmate room



### Second floor plan

At this floor is contain 11 inmate's cell, 1 guard room, 1 bathroom and 1 locker room. Working area at the terrace outside is allow for inmates to work just daytime.

- Inmate room
- Work Space
- ⬅️ Exit to working zone

Guard room

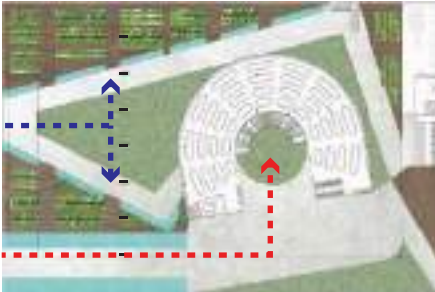

### First floor plan

At ground floor contain the middle canteen, working area, and courtyard for inmate activity in daytime.

- ⬅️ Entrance for work
- ⬅️ Entrance for inmate inside

Canteen



Our project got selected to be the one of many project that interview with a day magazine

Our project got selected to be the one of many project that present at 8th Asian Conference of correctional Facilities Architects and Planners

## a day

**a day** 10 000

**WIPU "Agenda Prison"**

... ..





# confirm letter

and certification from program that applies.

A21/029

October 5, 2021

To whom it may concern,

This is to certify that Miss Suthira Tuphave was an intern at The Office of Bangkok Architects Co., Ltd. From 1<sup>st</sup> June – 30<sup>th</sup> September 2021 as an Assistant Architect. She has performed her skill in Architect Design with competent and hardworking character.

Should you have further inquiries please feel free to contact our office.

Sincerely yours,



(Mr. Waroon Limpchalerm)  
Executive director  
B. Arch. Chulalongkorn University, Bangkok  
M. Arch. Pratt Institute, Brooklyn, New York



KLONGTOM  
HERITAGE

Klongtom Heritage Company Limited  
24/1 Watchara Road,  
Pak Nam Subdistrict, Mueang Krabi District,  
Krabi Province 81000

28<sup>th</sup> December 2022

To Whom It May Concern:

I would like to take this opportunity as CEO of Klongtom Heritage Company Limited to recommend **Miss Suthira Tupthavee** as an impressive candidate that will greatly impact and contribute to your organization.

**Miss Suthira Tupthavee** from the **School of Architecture and Design King Mongkut's University of Technology Thonburi (KMUTT)** spent the last five months starting on the 18<sup>th</sup> July 2022 - 17<sup>th</sup> December 2022 working closely on the mega investment project, The Klongtom Heritage project in Klongtom, Krabi.

She was tasked with concepting and visualizing the entire project site based that aims to establish itself as a world leading wellness destination. Miss Suthira's input in design thinking, consumer journey, architectural planning and interior design was instrumental in moving the project forward and gaining international recognition from foreign investors and worldwide press.

I have been thoroughly impressed by Miss Suthira's attitude and work ethic during her time with the Klongtom Heritage Project. She has done an excellent job and has shown great skills in creative thinking, technical understanding and strategic thinking that has greatly impacted our project. She is an extremely diligent colleague, organized, courteous and enthusiast co-worker who consistently demonstrated seriousness and ability to achieve targets and meet tight deadlines, displaying a strong dedication and commitment to excellence.

**Miss Suthira Tupthavee** has my wholehearted and unequivocal support in his search for new career opportunities. I am confident that she will devote herself to a position with your organization with a high degree of diligence.

Please do not hesitate to contact me for any further information.

Sincerely,



Mr. Wichai Poolworasuk  
CEO

Klongtom Heritage Company Limited



# CERTIFICATE OF COMPLETION

THE FOLLOWING CERTIFICATE IS PRESENTED TO

*Suthira Tupthavee*

*For completing her internship with Klontom Heritage Company Limited between  
18th July 2022 - 17th December 2022 on a mega investment project,  
The Klontom Heritage in Klontom, Krabi Thailand.*

  
**Wichai Poolworakul**  
CEO

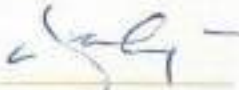

  
**Kabir Singh Saluja**  
Mentor

THANK YOU

**Suthira Tupthavee**

Architecture Graduated portfolio

519/28 Pracha-Uthit Rd., Thungku,  
Thungku, Bangkok, Thailand 10140

E-mail : [Suthira.ice@gmail.com](mailto:Suthira.ice@gmail.com)

Tel : 66 83 415 9492