

# อาคารหอพักแพทย์

File Architecture Structure Steel Precast Systems Insert Annotate Analyze Massing & Site Collaborate View Manage Add-Ins Enscape™ Modify

Modify Select Wall Door Window Component Column Roof Ceiling Floor Curtain System Curtain Grid Mullion Railing Ramp Stair Model Text Model Line Model Group Room Room Separator Tag Room Area Area Boundary Tag Area Wall Vertical Dormer By Face Shaft Opening Datum Work Plane Show Ref Plane Viewer

Properties {3D - athibbadee.ch}

3D View

3D View: {3D - athibbadee.c} Edit Type

Graphics

View Scale	1 : 100
Scale Value 1:	100
Detail Level	Fine
Parts Visibility	Show Original
Visibility/Graphi...	Edit...
Graphic Display ...	Edit...
Discipline	Coordination
Show Hidden Li...	By Discipline
Default Analysis...	None
Sun Path	<input type="checkbox"/>

Extents

Crop View	<input type="checkbox"/>
Crop Region Vis...	<input type="checkbox"/>
Annotation Crop	<input type="checkbox"/>
Far Clip Active	<input type="checkbox"/>
Far Clip Offset	304800.0

Properties help Apply

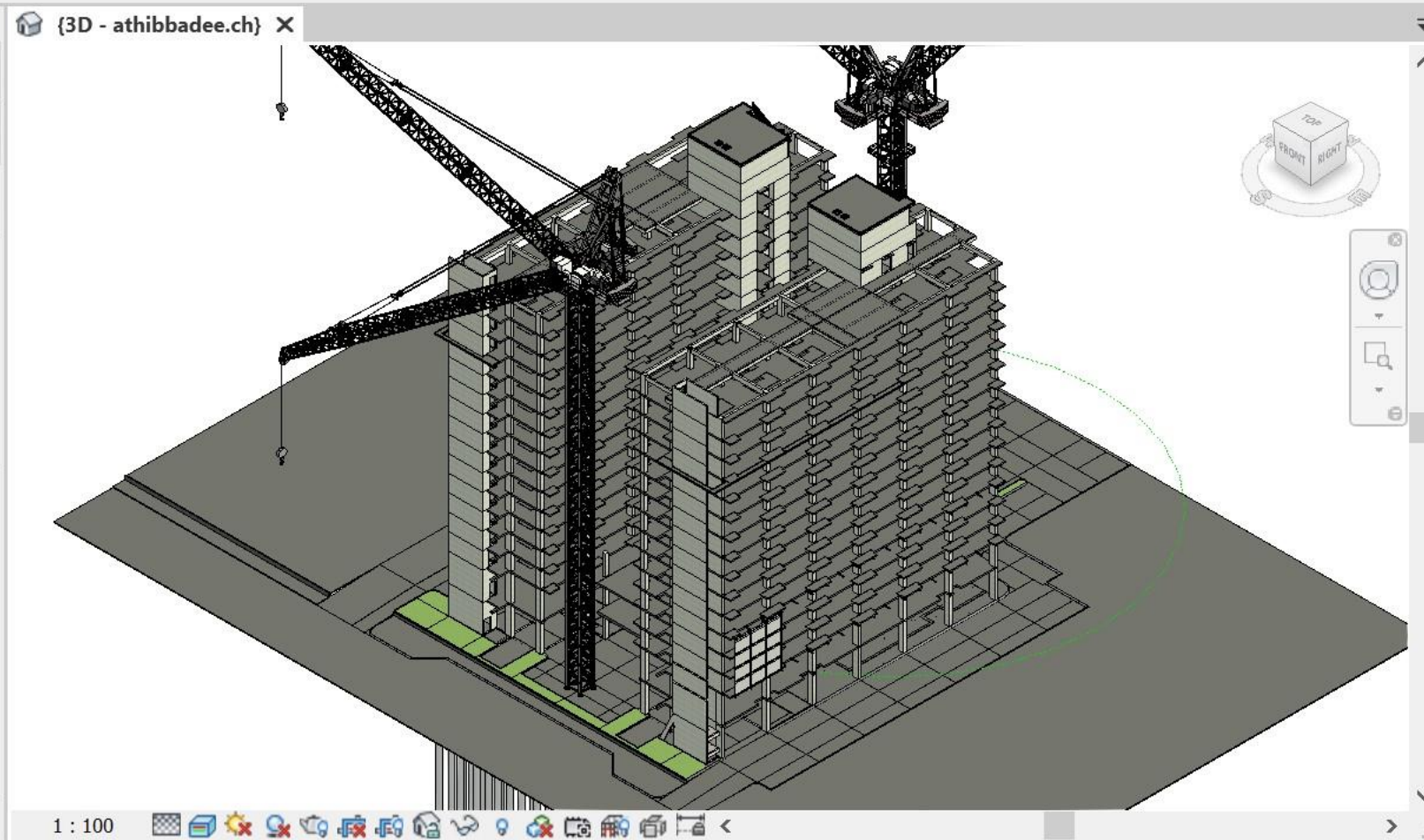

Project Browser - 135SU-ST-หอพัก...

Views (all)

- Structural Plans (Footing Data)
  - F60-1 Plan
  - F80-1 Plan
  - F80-2 Plan
  - F80-5 Plan
  - ผังเสาเข็ม (ส่วนที่2)
  - ผังเสาเข็ม(ส่วนที่1)
  - ผังเสาเข็ม(ส่วนที่3)
  - ผังเสาเข็ม(ส่วนที่4)
  - ระดับพื้นถึงเก็บน้ำ (A3)
  - แบบขยายCORE STIAR ST-1
  - แบบขยายCORE STIAR ST-2
  - แปลนฐานรากและเสา (Colour
  - แปลนพื้นที่ชั้นที่ 1 (A3)
  - แปลนพื้นที่ถึงเก็บน้ำ (เลขที่เสา
- Structural Plans
- Floor Plans
- Ceiling Plans
- 3D Views
  - 3D View 1
  - 3D View 2
  - 3D-F60-1
  - 3D-F80-1

# Mock UP งานระบบ Restroom King Bridge/One Bangkok

The screenshot displays a BIM software interface with the following components:

- Ribbon Menu:** Contains tabs for File, Architecture, Structure, Steel, Precast, Systems, Insert, Annotate, Analyze, Massing & Site, Collaborate, View, Manage, Add-Ins, Enscape™, and Modify. The Architecture tab is active, showing tools for Wall, Door, Window, Component, Column, Roof, Ceiling, Floor, Curtain System, Curtain Grid, Mullion, Railing, Ramp, Stair, Model Text, Model Line, Model Group, Room, Room Separator, Tag Room, Area, Area Boundary, Tag Area, Wall, Vertical, Dormer, Opening, Datum, and Work Plane.
- Properties Panel:** Shows the 3D View properties for the selected view. It includes a 3D View icon, a dropdown for the view name, and an Edit Type button. The Graphics section includes View Scale (1 : 100), Scale Value (1: 100), Detail Level (Fine), Parts Visibility (Show Original), Visibility/Graphi... (Edit...), Graphic Display ... (Edit...), Discipline (Coordination), Show Hidden Li... (By Discipline), Default Analysis... (None), Sub-Discipline, and Sun Path (checkbox). The Extents section includes Crop View (checkbox), Crop Region Vis... (checkbox), Annotation Crop (checkbox), and Far Clip Active (checkbox).
- Project Browser:** Shows the project structure for SN\_Restroom Ki... It includes Views (Discipline), Coordination, Module, 3D Views, Sheet, Electrical, and another Sheet. The 3D Views list includes 0LA Design Conc, 0UR Design Conc, 0WC Design Conc, 3D-LA Module wi, 3D-LA Module-FI, 3D-UR Module L, 3D-UR Module-FI, 3D-WC Module w, 3D-WC Module-F, LA2-SN only, UR4-SN only, and WC2-SN only.
- 3D View:** The main workspace shows a 3D model of a building structure with a restrooms system. The model is rendered in a wireframe style, showing the structural frame and the restrooms system components. The view is titled {3D - athibbfirst}.
- Status Bar:** Shows the current view scale (1 : 100), the workset name (Workset1 (Not Editable)), and the main model name (Main Model).

# โรงเรียนสุทรขุน Full Slat 850 ตัว

The image displays the Autodesk Revit software interface for a 3D architectural model of a school building. The main window shows a perspective view of a long, low-profile building with a dark, full-slat roof. The building is supported by a series of columns and has a ramp on the right side. The interface includes a ribbon at the top with various toolsets: File, Architecture, Structure, Steel, Precast, Systems, Insert, Annotate, Analyze, Massing & Site, Collaborate, View, Manage, Add-Ins, and Modify. The Properties panel on the left shows the current view is a 3D view with a scale of 1:50. The Project Browser on the right lists the model's structure, including views and sections. The bottom status bar shows the current view scale and the main model name.

**Properties Panel (3D View):**

- 3D View: {3D}
- 3D View: {3D}
- Constraints
- View Set
- Graphics
- View Scale: 1 : 50
- Scale Value: 1: 50
- Detail Level: Fine
- Parts Visibility: Show Original
- Visibility/Grap...: Edit...
- Graphic Displa...: Edit...
- Discipline: Coordination
- Show Hidden ...: By Discipline
- Default Analys...: None
- Show Grids: Edit...
- Sun Path:
- Extents
- Crop View:
- Crop Region ...:

**Project Browser - ฟาร์มสุทร.rvt**

- Views (SCG)
- ???
- A0\_GENERAL NOTE
- A1\_FLOOR PLAN
  - Floor Plan: A1\_FL\_02
  - Floor Plan: system plan
  - Floor Plan: แปลนพื้นคอกเลี้ยง
  - Floor Plan: แปลนพื้นคอกเลี้ยง Cop
  - Floor Plan: แปลนหลังคา
  - Section: S2 พื้นส่วนน้ำ
  - Section: Section 12
  - Section: TL-01
  - Section: TRUSS-01
  - Section: ขยาย "1"
  - Section: ขยาย "2"
  - Section: ขยาย "3"
  - Section: ขยาย "4"
  - Section: ขยายรั้วระหว่างคอก
  - Section: ขยายรั้วรางเสาดอาหาร
  - Section: ขยายราง COOLING PAE
  - Section: ขยายราง COOLING PAE
  - Section: ขยายรางน้ำ "7"
  - Section: ขยายรางน้ำ "8"
  - Section: ขยายส่วนน้ำ "5"

**Status Bar:** 1 : 50 Main Model

# CJ Express Standard Module

**File** Architecture Structure Steel Precast Systems Insert Annotate Analyze Massing & Site Collaborate View Manage Add-Ins Enscape™ Modify

**Modify** Wall Door Window Roof Curtain System Railing Model Text Room Area Wall Level Show  
Component Ceiling Curtain Grid Ramp Model Line Room Separator Area Boundary Shaft Vertical Ref Plane  
Column Floor Mullion Stair Model Group Tag Room Tag Area By Face Opening Grid Set Viewer  
Select Build Circulation Model Room & Area Datum Work Plane

**Properties** {3D - athibbfirst} 3D View

3D View: {3D - athibbfirst} Edit Type

Constraints	
View Set	

Graphics	
View Scale	1 : 100
Scale Value	1: 100
Detail Level	Fine
Parts Visibility	Show Original
Visibility/Graphi...	Edit...
Graphic Display ...	Edit...
Discipline	Coordination
Show Hidden Li...	By Discipline
Default Analysis...	None
Sun Path	<input type="checkbox"/>

Dimensions	
Duration	
Activity	
Planned Start	

[Properties help](#) Apply

1 : 100

**Project Browser - CJE\_AR\_2021.rvt**

- Views (SCG)
  - ???
- A0\_GENERAL NOTE
  - Drafting View: A0\_GN\_1
- A1\_FLOOR PLAN
  - Floor Plan: A1\_FL\_01
  - Floor Plan: A1\_FL\_01\_IN
  - Floor Plan: A1\_FL\_02
  - Floor Plan: A1\_FL\_RF
  - Floor Plan: A1\_FL\_W/C
  - Floor Plan: A1\_Site
- A2\_ELEVATION
  - Elevation: A2\_EL\_01
  - Elevation: A2\_EL\_02
  - Elevation: A2\_EL\_03
  - Elevation: A2\_EL\_04
- A3\_SECTION
  - Section: A3\_SC\_A
  - Section: A3\_SC\_B
  - Section: A3\_SC\_W/C1
  - Section: Section 1
  - Section: Section 2
  - Section: Section 3

Click to select. TAB for alternates. CTRL adds. SH Workset1 (Not Editable) Main Model Editable Only

# Family Parameter Solar Cells

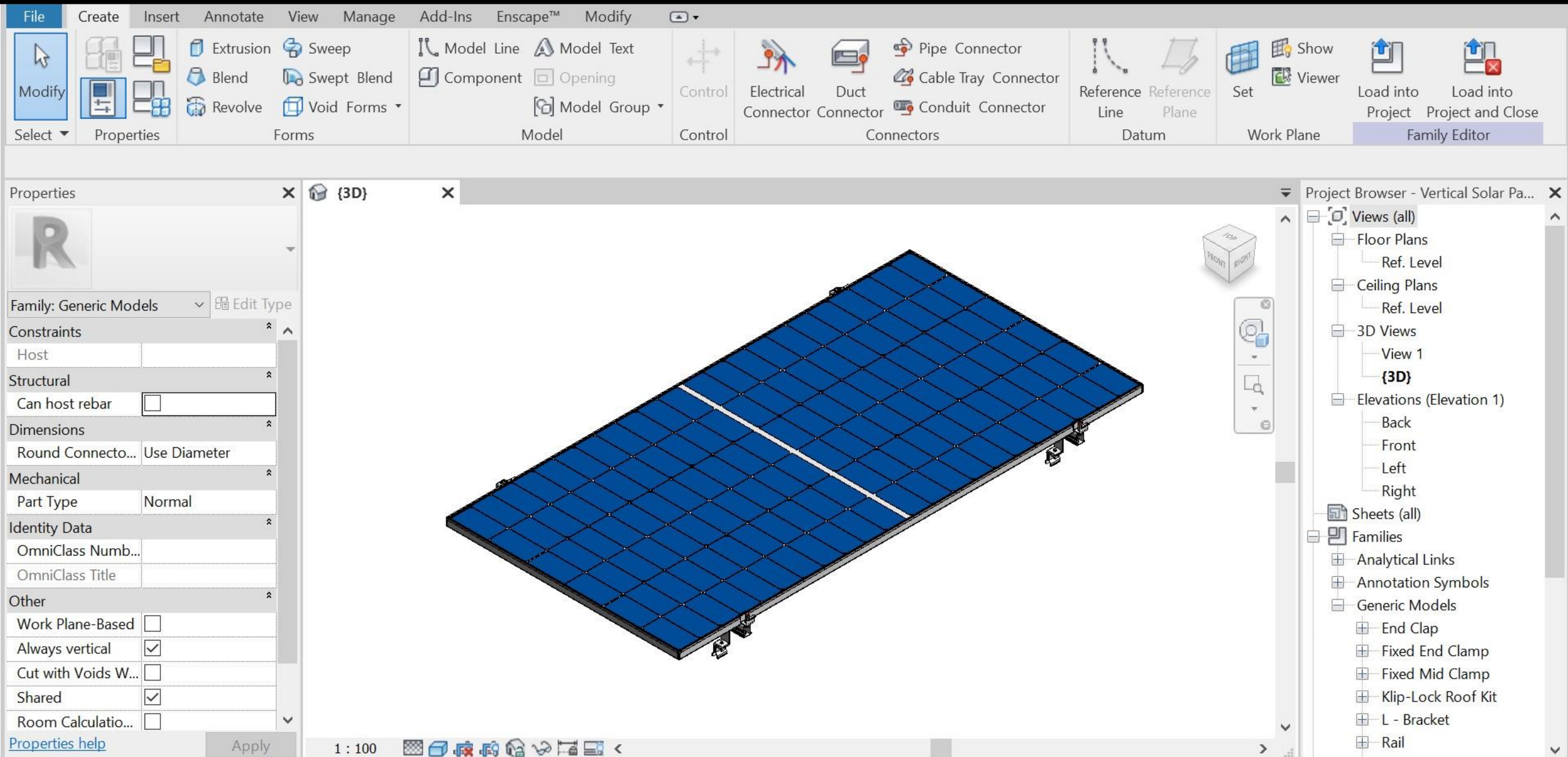

Click to select, TAB for alternates, CTRL adds, SHIFT un:

