

# THAI ARCHITECTURE PORTFOLIO

*Pathompat Mekbenchapivat*  
*tilis9083@gmail.com*  
*B.Arch | Chulalongkorn U*

# T

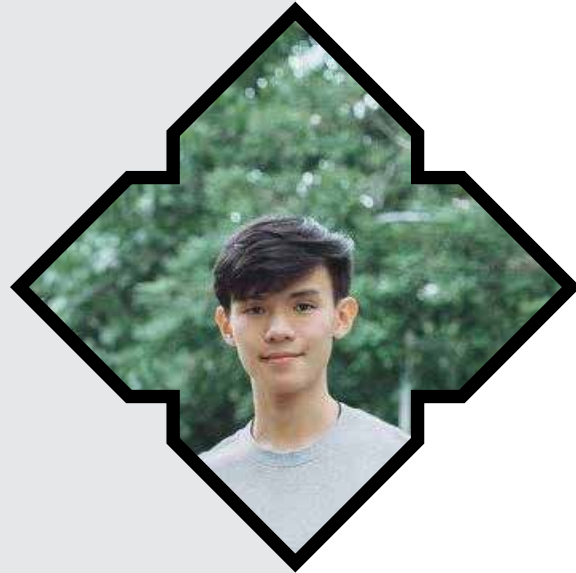



## PATHOMPAT MEKBENCHAPIVAT

### ABOUT ME

*I am a contemporary Thai architecture student from Chulalongkorn University. The reason why I chose this career path because Thai architecture is not only the important country's cultural legacy, but it is also suitable for tropical climates. However, Thai architecture is being replaced by Modern architecture nowadays and I've got a feeling that this worthy art will disappear from Thailand someday. In my opinion, I, as a Thai citizen, determine to be a person who conserve and develop Thai architecture in order to suit this and the future generation's lifestyles.*

### PERSONAL INFORMATION

Name *Pathompat Mekbenchapivat*  
Date of Birth *29/01/1996*  
Nationality *Thai*  
Address *39/452 Soi.10/1D Precha Village Bangkraw  
Bangphli Samutprakarn 10540*  
TEL. *(+66)95-116-5294*  
Email *tilis9083@gmail.com*  
Web *www.issuu.com/tilismekbenchapivat*

### EDUCATION

2008 - 2013 ● *High School*  
*Assumption Collage Samutprakarn, Samutprakarn, Thailand*  
2014 - 2019 ● *Bachelor of Architecture*  
*Chulalongkorn University, Faculty of Architecture,  
Bangkok, Thailand*

### WORKSHOP

2017 *Light Asia Bangkok*  
*Wat Pathum Wanaram, Pathum, Bangkok, Thailand*

### INTERNSHIP

2018 *Bunnag Architect International Consultants*  
*Resort Planning | Architecture | Interior Architecture*

### SKILL

Software /Physical

<i>Hand Drafting</i>	●●●●●●
<i>Autocad</i>	●●●●●●
<i>Revit</i>	●●●●○
<i>Photoshop</i>	●●●●●●
<i>In design</i>	●●●●●●
<i>Sketch up + Vray</i>	●●●●○
<i>3Dsmax + Vray</i>	●○●○●○
<i>Lumion</i>	●●●●●○

### Languages

Thai *Native Languages*

English *Intermediate*

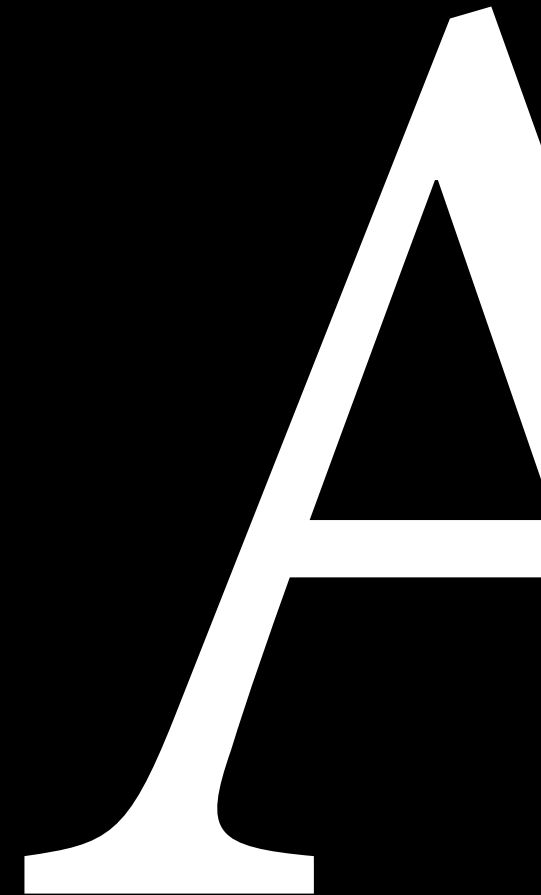

# TABLE OF CONTENTS

*Selected Works*  
2017 -2019

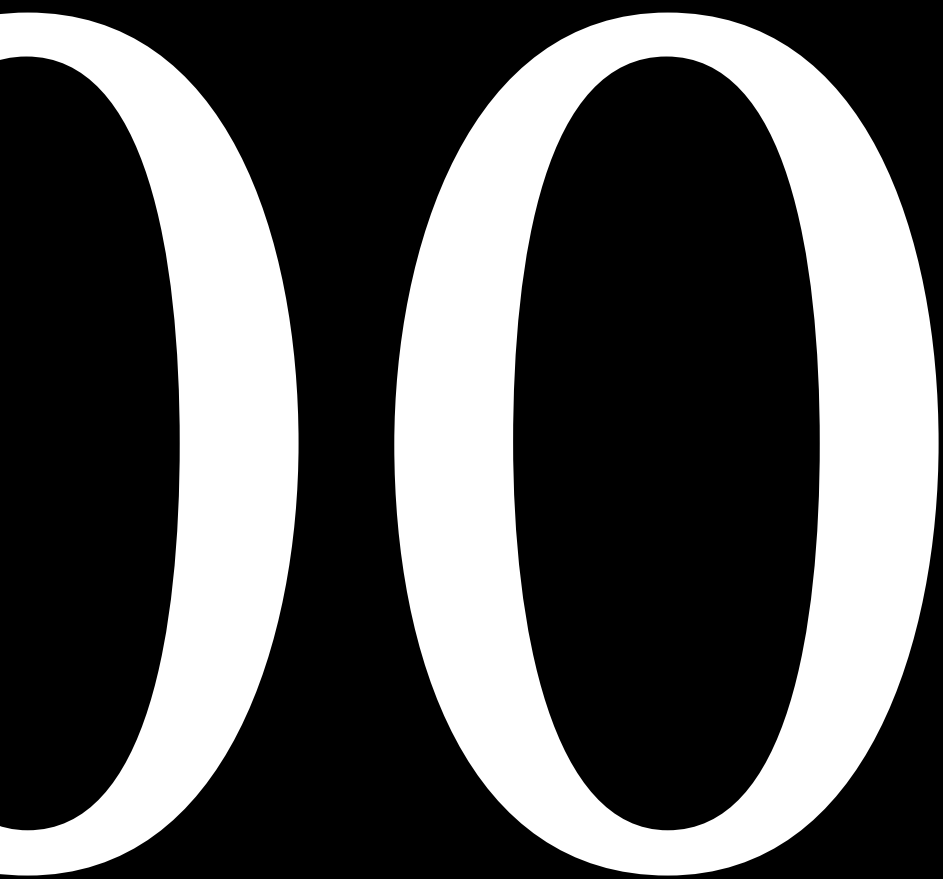

## 01

---

LIGHT  
ASIA  
BANGKOK

---

## 02

---

GENTAL  
MONSTER  
FLAGSHIP  
STORE

---

## 03

---

DOMESTIC  
PASSENGER  
TERMINAL  
OF  
BURIRAM  
AIRPORT

---

01

01

**LIGHT  
ASIA  
BANGKOK**

*TYPE | Workshop 2017*

*LOCATION | Bangkok, Thailand*

*TUTOR | Dan Foreman  
ARUP (Singapore)*

*It is a workshop about lighting in Thai architecture with a lighting professor from Singapore*

*The concept is to bring a teaching of the Buddha about concentration, respect and merit to make people who see Phra Chedi feel well prepared for the spiritual meditation by designing a lighting by using purple and yellow light because in the past purple color represents symbolically of Buddha teaching and yellow color represents a holy place in Buddhism. We use 4 types of luminaries to create a dynamic movement of shades and shadows to make a peaceful environment.*



**TEACHING  
OF  
BUDDHA**  
*Concept Design*





*Exterior Perspective from Hor Klong*



*Layout of the Phra Chedi*



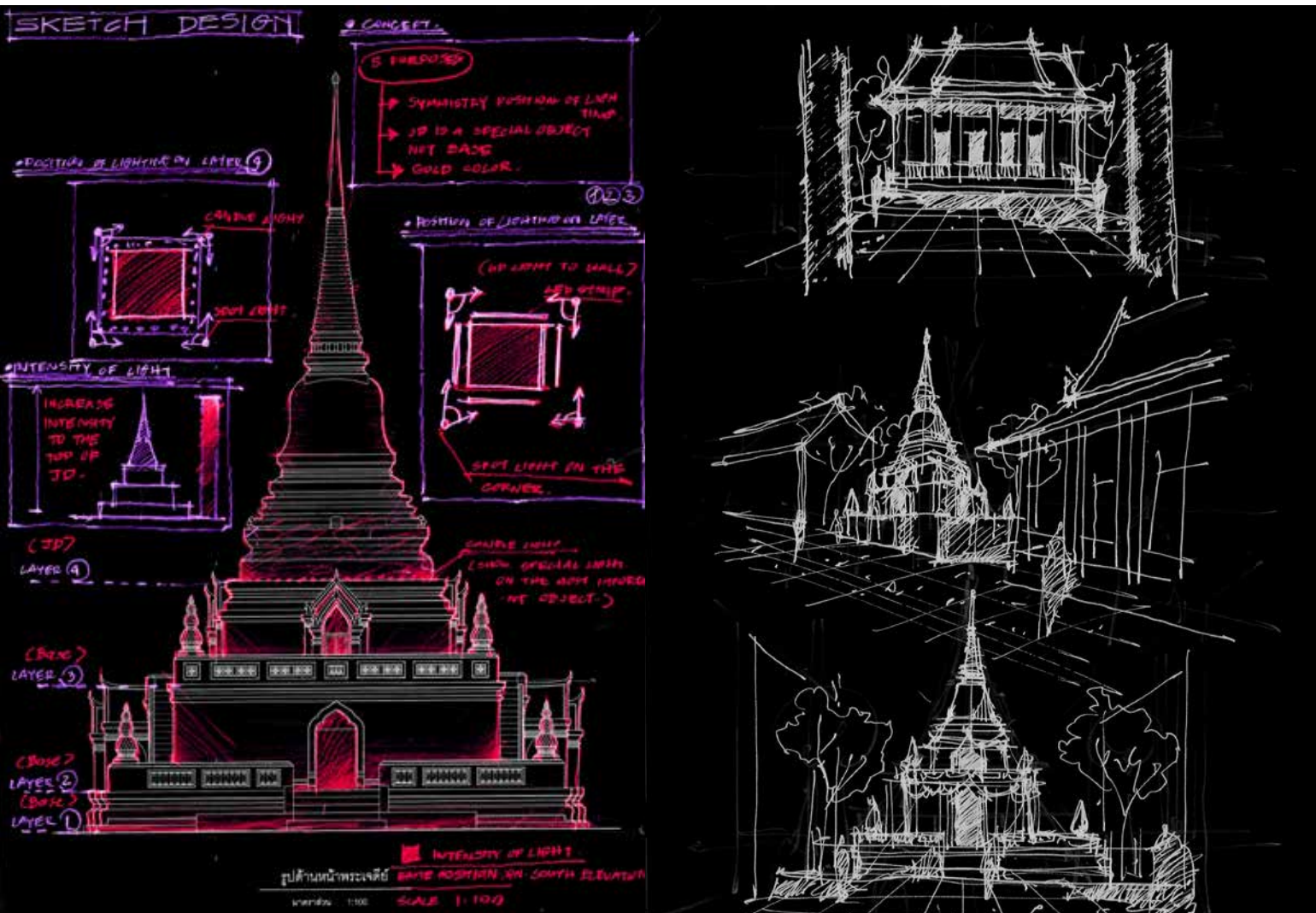

Sketch Design

**LIGHTING SCENES 1**  
PURPLE-YELLOW  
ENLIGHTENESS  
SPIRITUAL MEDITATION



**LIGHTING SCENES 2**  
YELLOW-YELLOW  
MEDITATION  
PEACEFUL



**LIGHTING SCENES 3**  
WARM WHITE-YELLOW  
HOLY PLACE



PLAN / ELEVATION



PLAN / ELEVATION

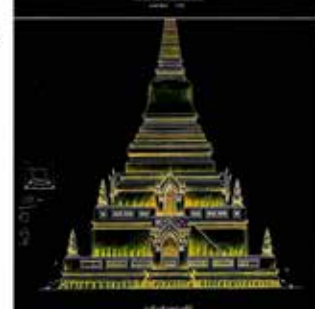

PLAN / ELEVATION



Schematic Design

# WAT PATHUM WANARAM MOCK UP

WE HAVE BEEN TRY USING MANY COLOURS, SET ANGLE, AND CHANG POSITION OF THE LIGHT SOURCES TO FIND THE PERFECT COMBINATION THAT REPRESENT OUR CONCEPT. FROM EXPERIMENT, WE DECIDED TO USE PURPLE AND YELLOW TO REPRESENT THE PEACE AND RESPECT. WE SET THE ANGLE OF THE LUMINAIRE PARALLEL TO THE WALL TO AVOIDED THE EXCESS LIGHT ON THE WALL AS SAMEAS THE POSITION OF THE LIGHT SOURCES. THE TWO COLOURS WE USED COME FROM THAI BELIEVE. SINCE IN THAI, CANDLE SYMBOLIZED WORSHIP AND PURPLE MEANS CONCENTRATION.

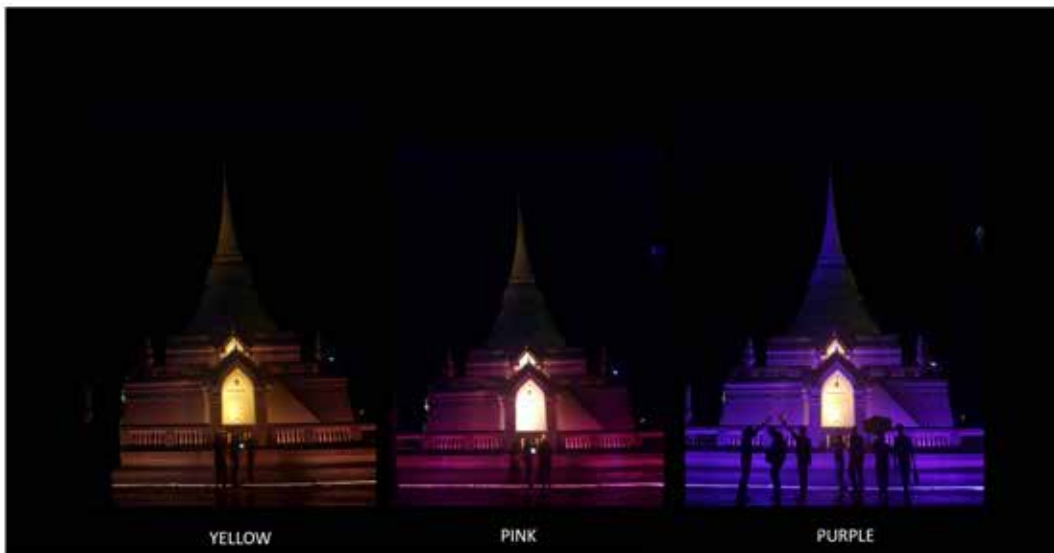
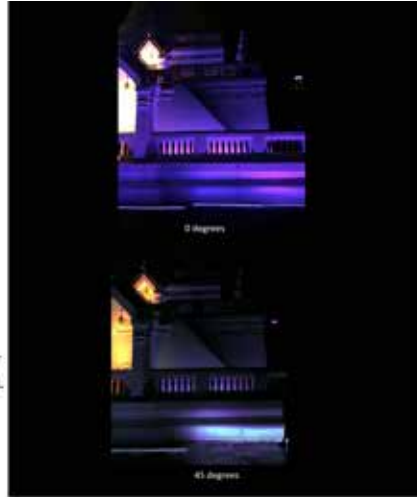

*Mock up Design*

		<h2>TECHNIQUES AND DETAILS</h2>	
		<p>WE USE 30 DEGREES LIGHT TO SHINE ON THE TOP OF THE PHRA CHEDI THAT'S THE MOST IMPORTANT PART OF THE PHRA CHEDI</p> <p>WE USE 10 DEGREES LINEAR GRAZER LIGHT TO SHINE SMEAR UP OF THE PHRA CHEDI WALL BECAUSE LINEAR GRAZER LIGHT CAN SHINE MORE SPACE THAN OTHERS. ALL SO ITS SHOW THE HORIZONTAL LINE OF THE PHRS CHEDI THAT REPRESENT THE PEACE.</p> <p>WE USE 12 DEGREES NARROW BEAM LIGHT TO SHINE THE INNER GATE OF THE PHRA CHEDI TO CONNECT THE BOTTOM MIDDLE AND THE TOP ALL TOGETHER.</p>	
<h3>SPECIFICATION</h3> <p>OUTDOOR FLOODLIGHT WITH WIDE BEAM OPTIC OPTIC : 30° COLOR TEMPERATURE : RGB LED POWER : 52 W CONTROL TYPE : DIMMABLE</p>	<h3>SPECIFICATION</h3> <p>SURFACE MOUNTED LINEAR GRAZER OPTIC : 10° COLOR TEMPERATURE : RGB LED POWER : 14 W CONTROL TYPE : DIMMABLE</p>		<h3>SPECIFICATION</h3> <p>OUTDOOR FLOODLIGHT WITH NARROW BEAM OPTIC OPTIC : 12° COLOR TEMPERATURE : RGB LED POWER : 55 W CONTROL TYPE : DIMMABLE</p>

*Techniques and Details*



02

02

**GENTAL  
MONSTER  
FLAGSHIP  
STORE**

*TYPE | Interior Project 2017*

*LOCATION | Bangkok, Thailand*

*It is a sunglasses and eyewear  
flagship store in Emporium depart-  
ment store and the designer brand  
that constantly develops itself under  
the philosophy of “innovation high-  
end experiments”.*

*The concept is bringing out an  
identity of the country to make peo-  
ple who get inside this store inter-  
ested and enjoy shopping more by  
designing the interior like a Thai  
art gallery by using a form and or-  
nament of unique traditional Thai  
architecture combined with Modern  
architecture exquisitely.*

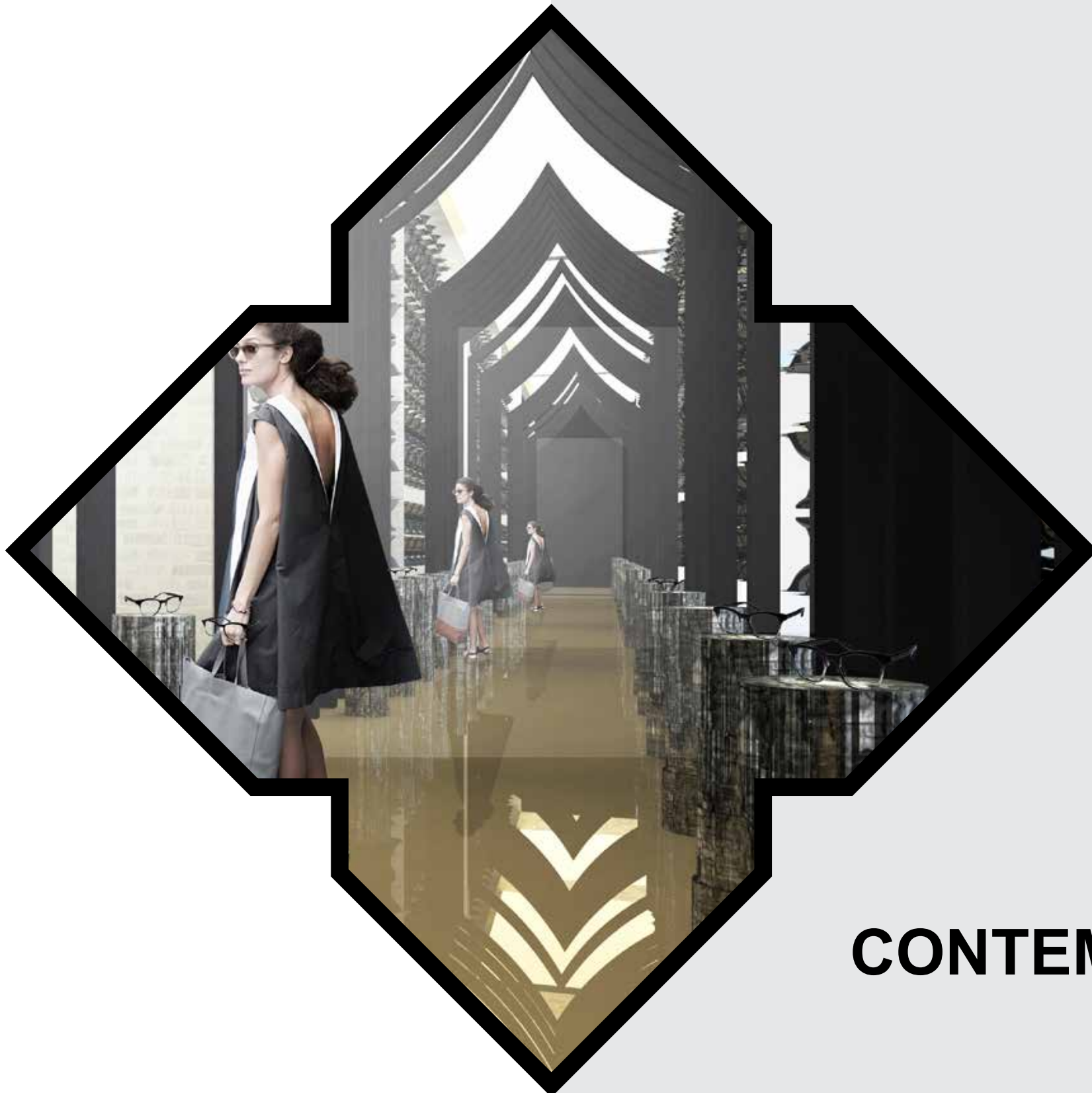

**CONTEMPORARY  
THAI  
GALLERY**  
*Concept Design*



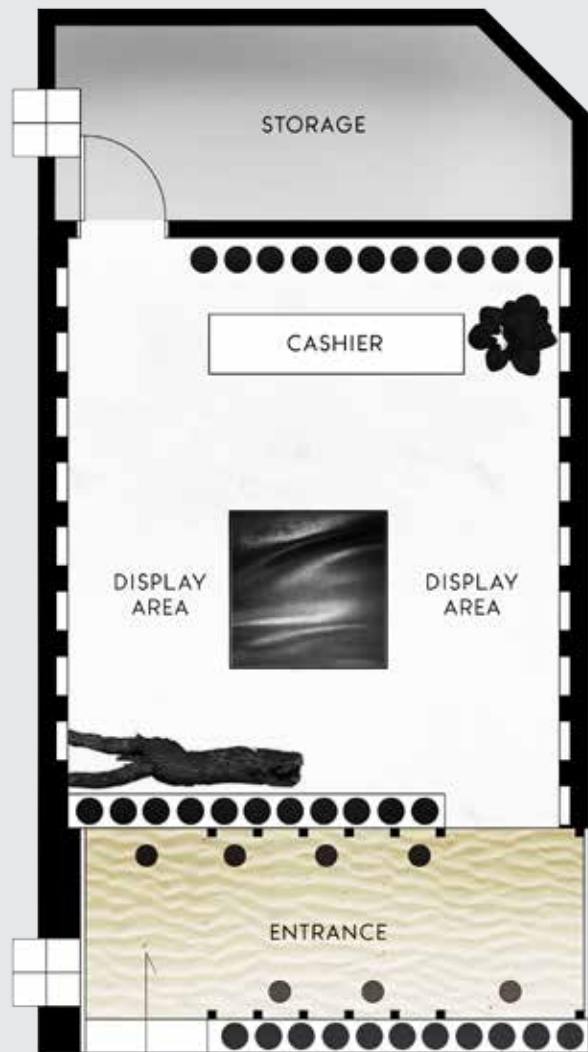

*Plan F1*



*3D Section Isometric*



*Interior Perspective from the entrance*



*Exterior Perspective from the entrance*



*Interior Perspective form the display arro*



05

# DOMESTIC PASSENGER TERMINAL OF BURIRAM AIRPORT

TYPE | Functional Project 2019

LOCATION | Buriram, Thailand

*It is a building of domestic passenger terminal that can change function to international airport during charter flights from the foreign country landing to Buriram airport. The function is flexible because Buriram province is a popular place for the tourist around the world this place have a lot of global event e.g., Moto GP 2018*

*The concept was to simulate the atmosphere of the castle of light in the believer of Cambodia in the past in order to make people who come to this building feel like traveling back in time to the past of the Buriram province's history*

*The castle of light was a transportation building and a Buddha image shrine on the royal route in the past that is a building for tours to stop before going to another place like an airport terminal and respect Buddha image to make them feel safe during travel.*



**THE CASTLE OF LIGHT**  
*Concept Design*

03





- |   |  |
|---|--|
| 1 บ้านพักเจ้าหน้าที่<br>STAFF HOUSE                               | 10 ลานจอดรถ คลังสินค้า<br>WAREHOUSE PARKING                  |
| 2 คลังเชื้อเพลิง<br>FUEL DEPOT                                    | 11 อาคารสำนักงานเขตปลอดอากร<br>CUSTOMS OFFICE                |
| 3 โรงเรียนการบิน<br>AVIATION TRAINING CENTER                      | 12 สำนักงาน<br>IMMIGRATION OFFICE                            |
| 4 ลานจอดอากาศยาน โรงเรียนการบิน<br>AVIATION TRAINING CENTER APRON | 13 ศูนย์ซ่อมบำรุง อากาศยาน<br>IMMIGRATION OFFICE             |
| 5 สถานีดับเพลิง<br>FIRE STATION                                   | 14 อาคารแปดสีสินค้าปลอดอากร<br>AIRCRAFT MAINTENANCE FACILITY |
| 6 หอบังคับการ<br>AIRBORNE CONTROL TOWER                           | 15 คลังสินค้าปลอดอากร ระยะยาว<br>LONG-TERM CUSTOMS WAREHOUSE |
| 7 ลานจอดอากาศยาน พาณิชย์, ส่วนบุคคล และขนส่งสินค้า<br>APRON       | 16 อาคารประกอบ และซ่อม<br>MAINTENANCE FACILITY               |
| 8 รางอากาศยาน<br>RUN WAY  | 17 ลานแสดงสินค้า<br>EXHIBITION YARD                          |
| 9 คลังสินค้า<br>WAREHOUSE   |  |
- เส้นทางเข้า-ออกหลักโครงการ  
MAIN ENTRANCE CIRCULATION  
● พื้นที่ออกแบบโครงการ  
DESIGN AREA



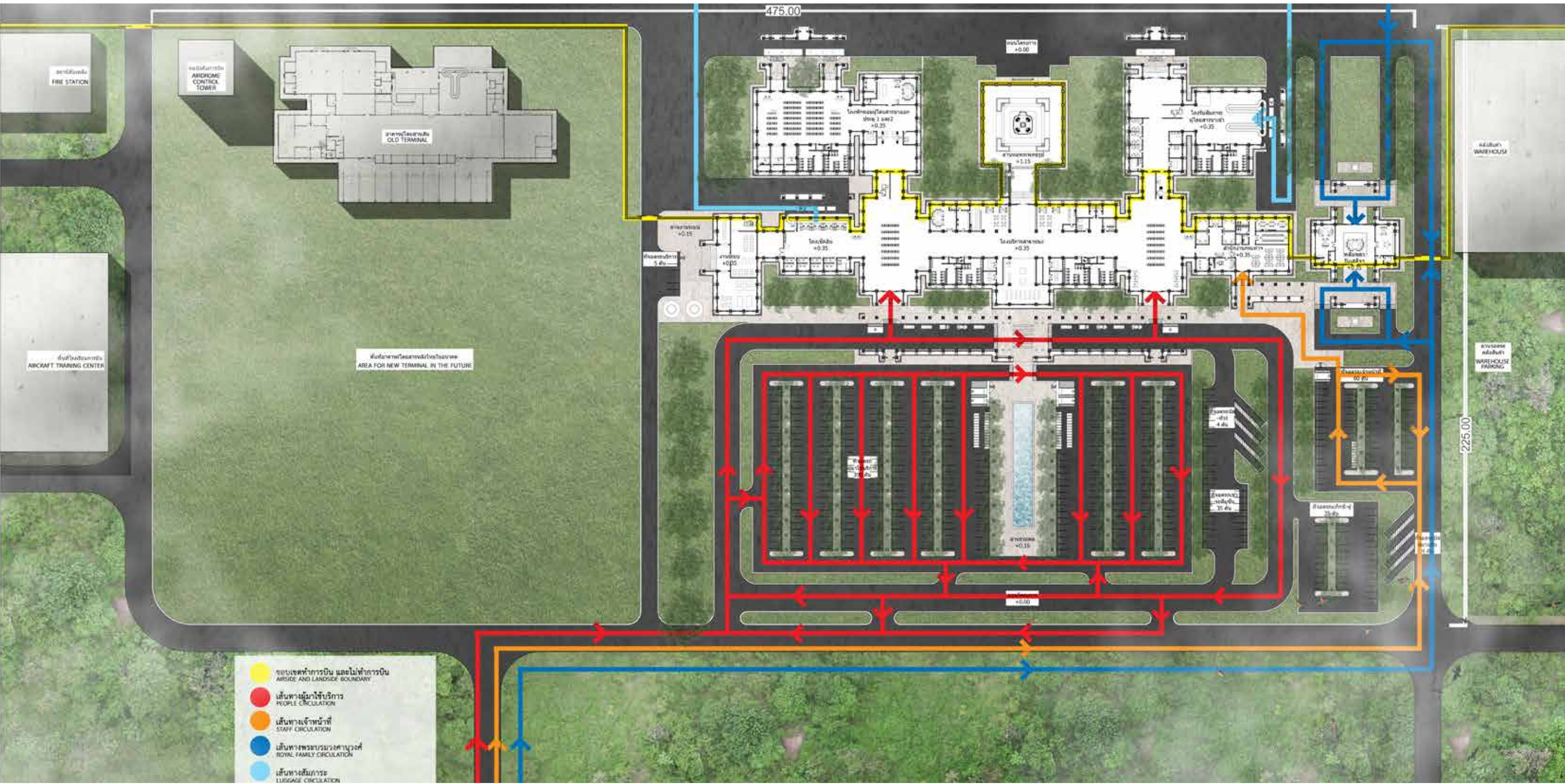

- ขอบเขตท่าอากาศยาน และไม่ท่าอากาศยาน  
AIRSIDE AND LANDSIDE BOUNDARY
- เส้นทางผู้ใช้บริการ  
PEOPLE CIRCULATION
- เส้นทางเจ้าหน้าที่  
STAFF CIRCULATION
- เส้นทางพระบรมวงศานุวงศ์  
ROYAL FAMILY CIRCULATION
- เส้นทางสัมภาระ  
LUGGAGE CIRCULATION

Layout











Side 1



Side 2

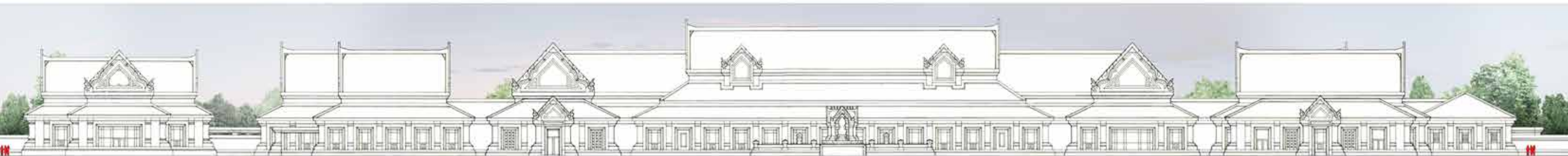

Side 3



Side 4





Section A

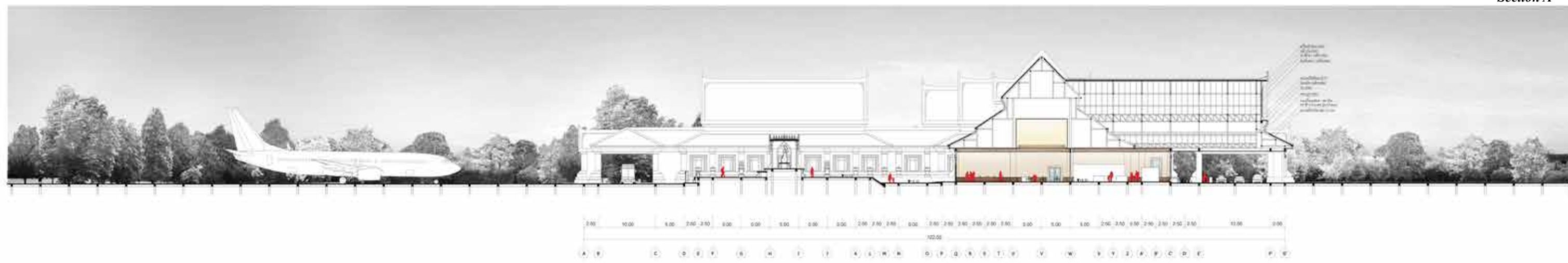

Section B



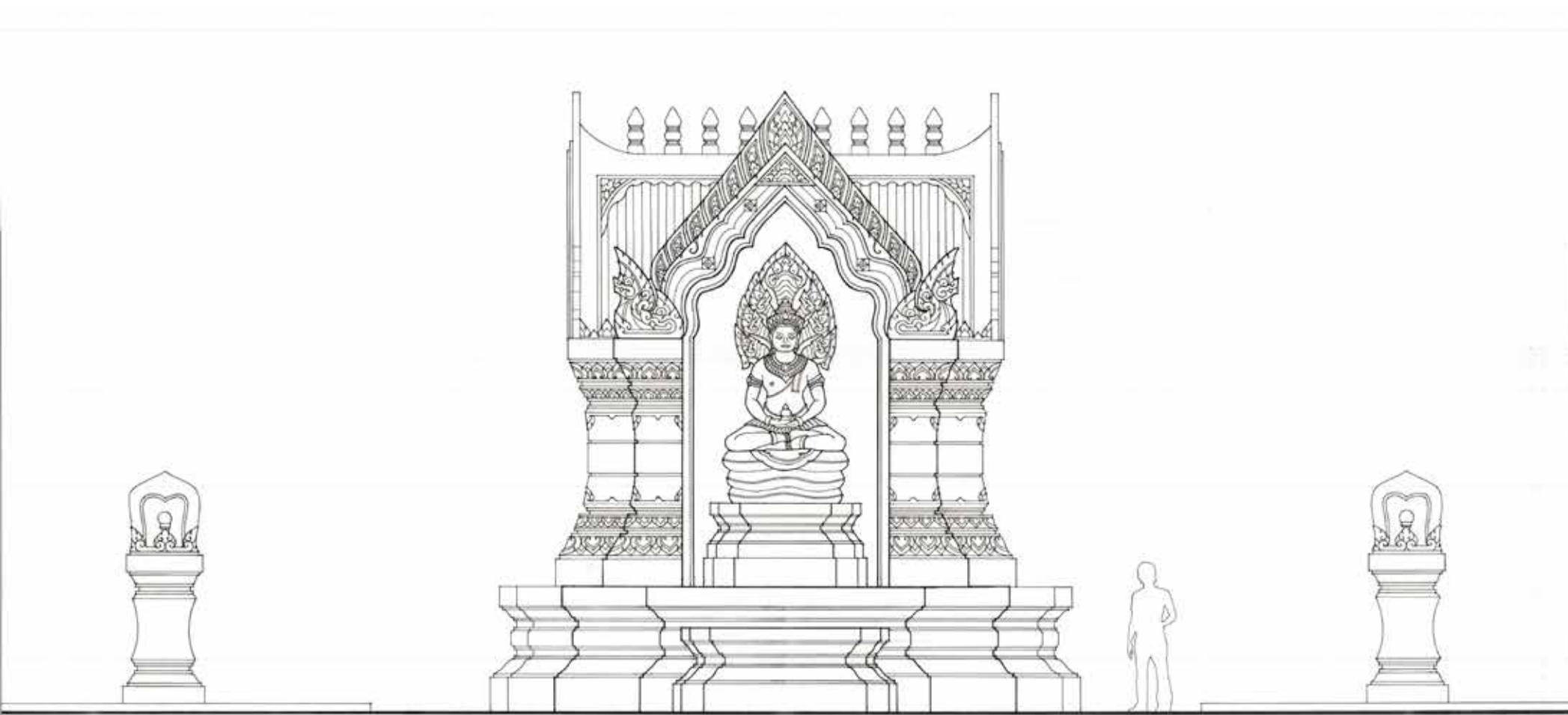

*The Buddha Image Shrine Side 1*

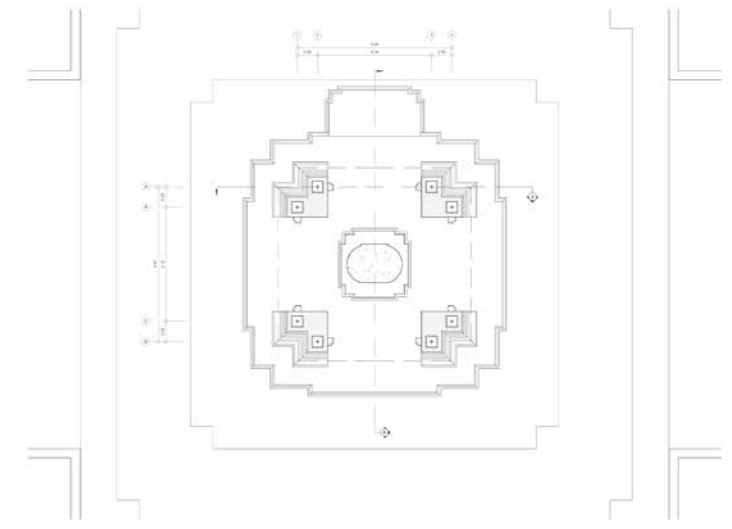

*The Buddha Image Shrine Plan*

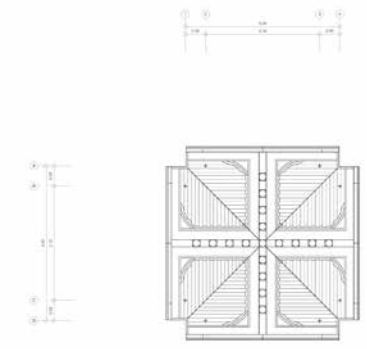

*The Buddha Image Shrine Roof Plan*

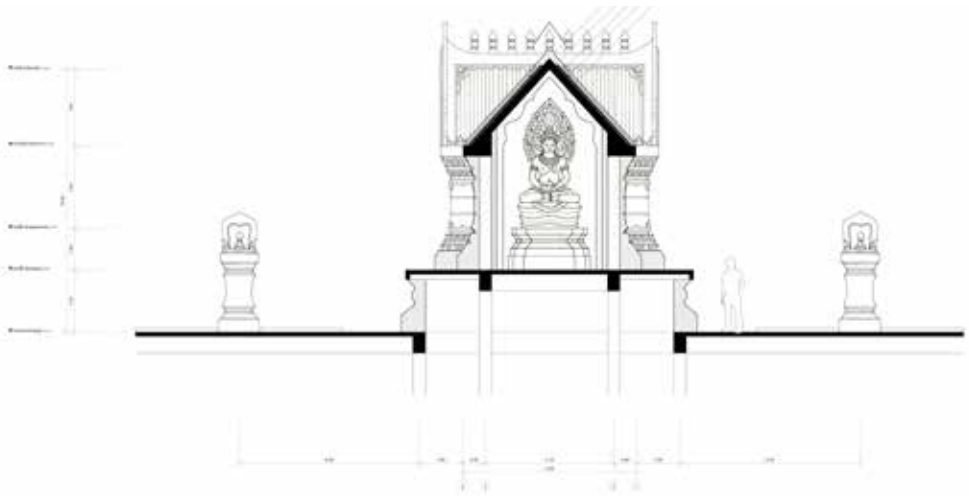

*The Buddha Image Shrine Section A*

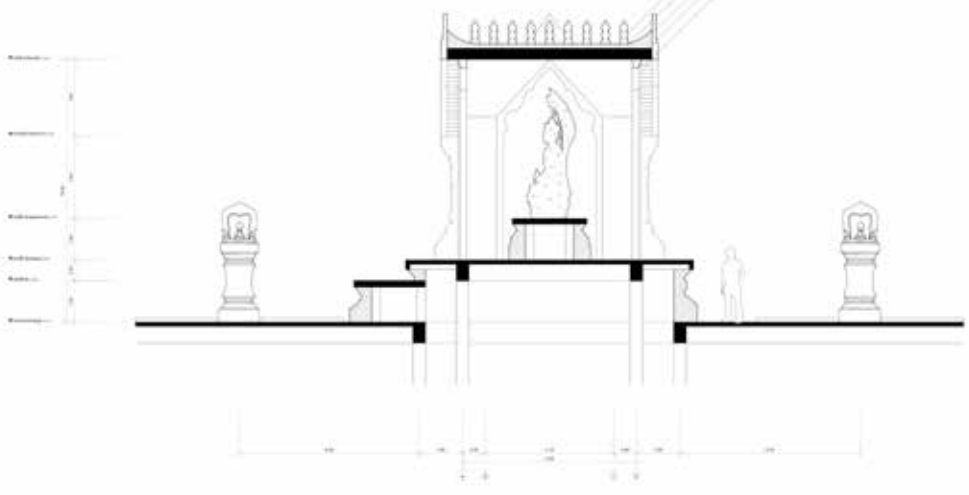

*The Buddha Image Shrine Section B*

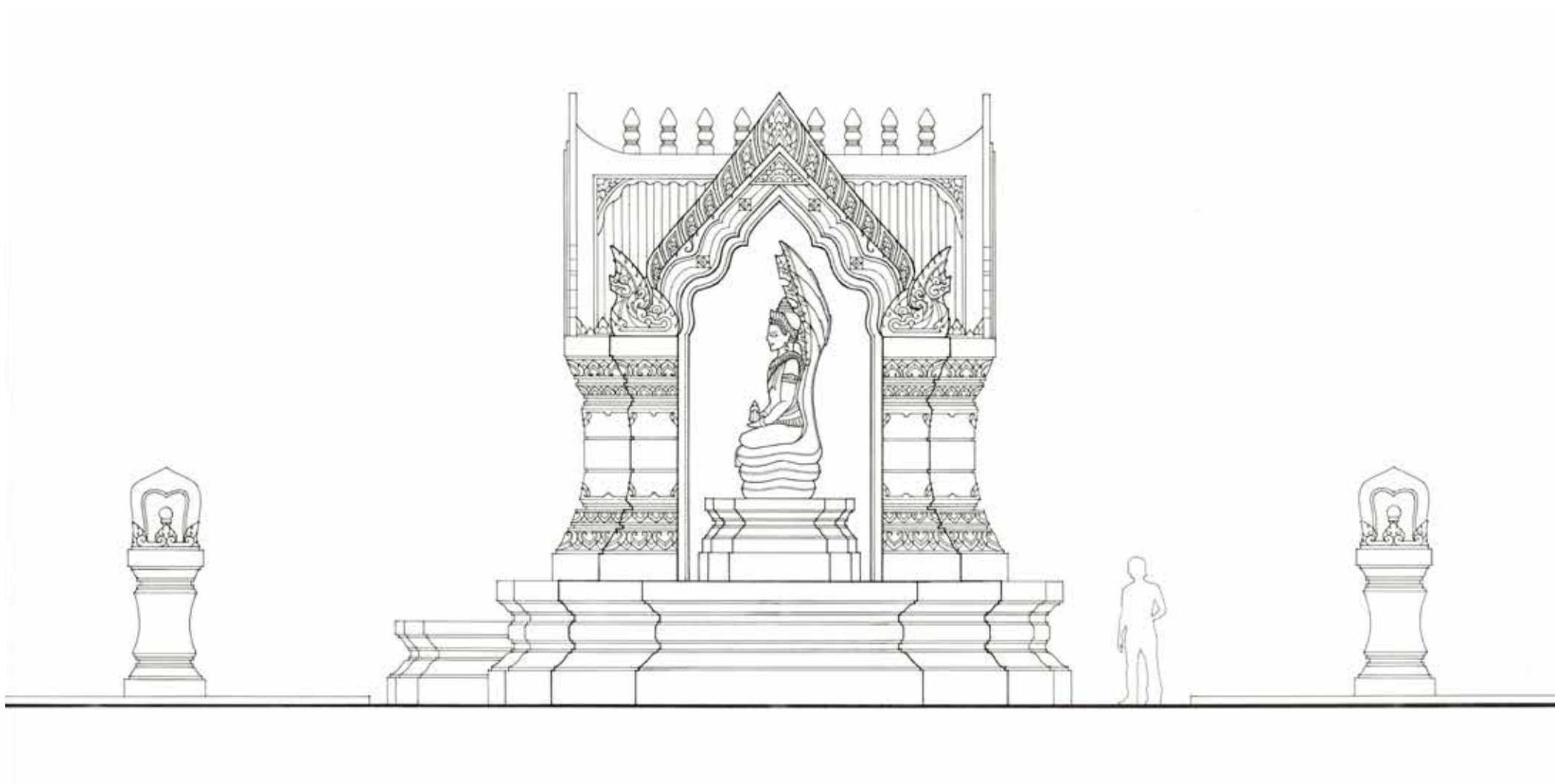

*The Buddha Image Shrine Side 4*





*Exterior Perspective from the sky*



*Exterior Perspective from the sky*



*Exterior Perspective from the sky*





*Exterior Perspective from the main entrance*



*Exterior Perspective from the main entrance*



*Exterior Perspective from the apron*





*Exterior Perspective from the royal family lounge*



*Exterior Perspective from the apron*



*Exterior Perspective from the royal family lounge*





*Exterior Perspective from the Buddha image shrine*



*Exterior Perspective from the Buddha image shrine*



*Exterior Perspective from the Buddha image shrine*



*Interior Perspective from the service hall*



*Interior Perspective from the thai-smile lounge*



*Interior Perspective from the arrival hall*



# PHI- NAT

THANK YOU

FOR YOUR  
CONSIDERATION

